

RECEIVED  
JUN 01 2021

# T.7S. R.2W. Section 21, W.M.



17 | 16  
20 | 21

Eyre  
DLC 73

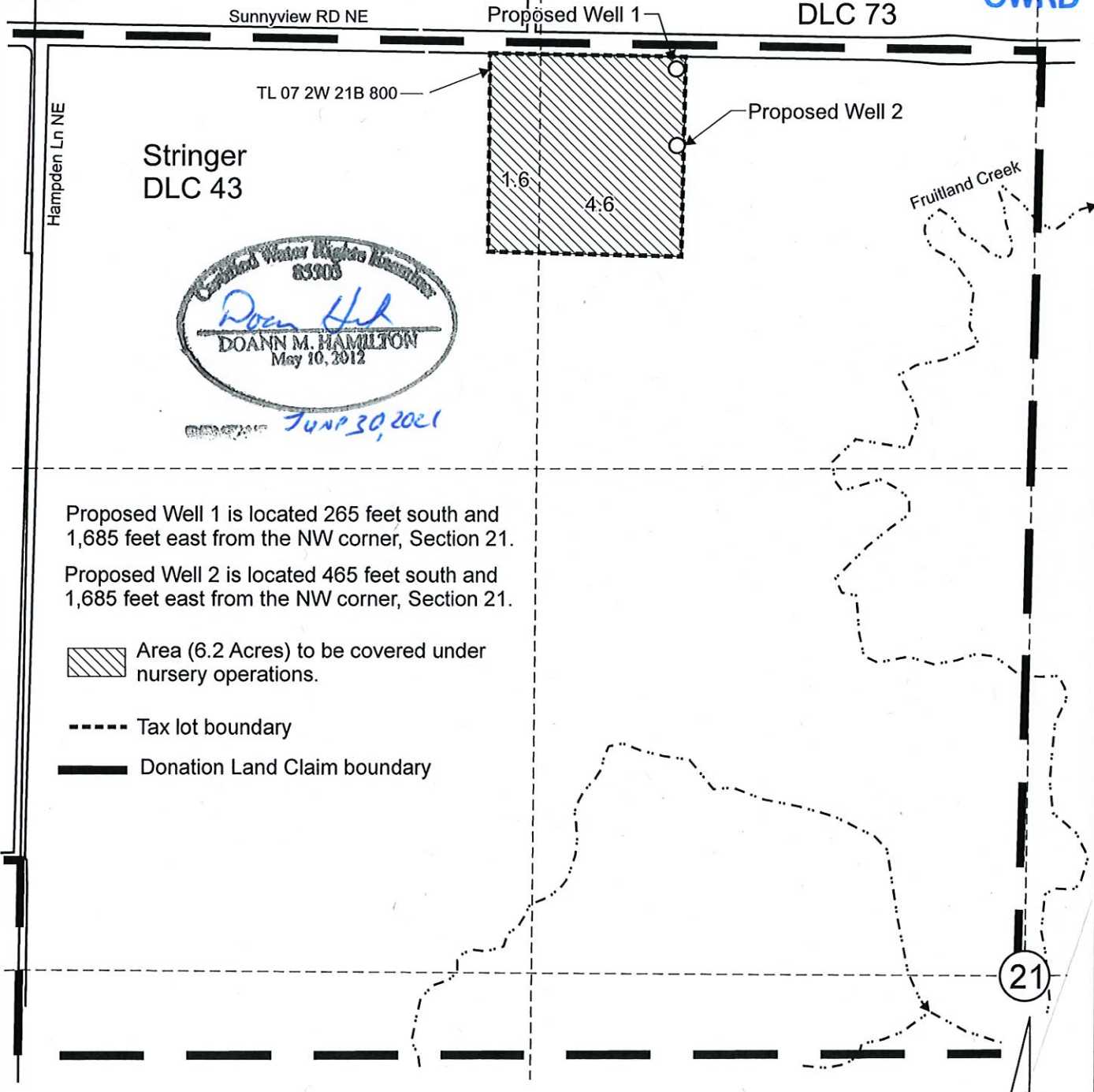
OWRD



Proposed Well 1 is located 265 feet south and 1,685 feet east from the NW corner, Section 21.  
 Proposed Well 2 is located 465 feet south and 1,685 feet east from the NW corner, Section 21.

-  Area (6.2 Acres) to be covered under nursery operations.
-  Tax lot boundary
-  Donation Land Claim boundary

Scale: 1" = 400'



This map was prepared for the purpose of identifying the location of a water right only and is not intended to provide legal dimensions or location of property ownership lines.

## Water Right Application Map

Weston Stadel  
T.7S. R.2W. Section 21, W.M.

Pacific Hydro-Geology Inc.

04/2021

Stadel\WG\WAppMap.cdr