

Application No. 73135

Permit No.
APPLICATION MAP

RECEIVED

JAN - 7 1983

WATER RESOURCES DEPT.
SALEM, OREGON

IN THE NAME OF SCOTT RIDLE

SECTIONS 28 & 33, TOWNSHIP 27 SOUTH, RANGE 14 WEST, W.M.

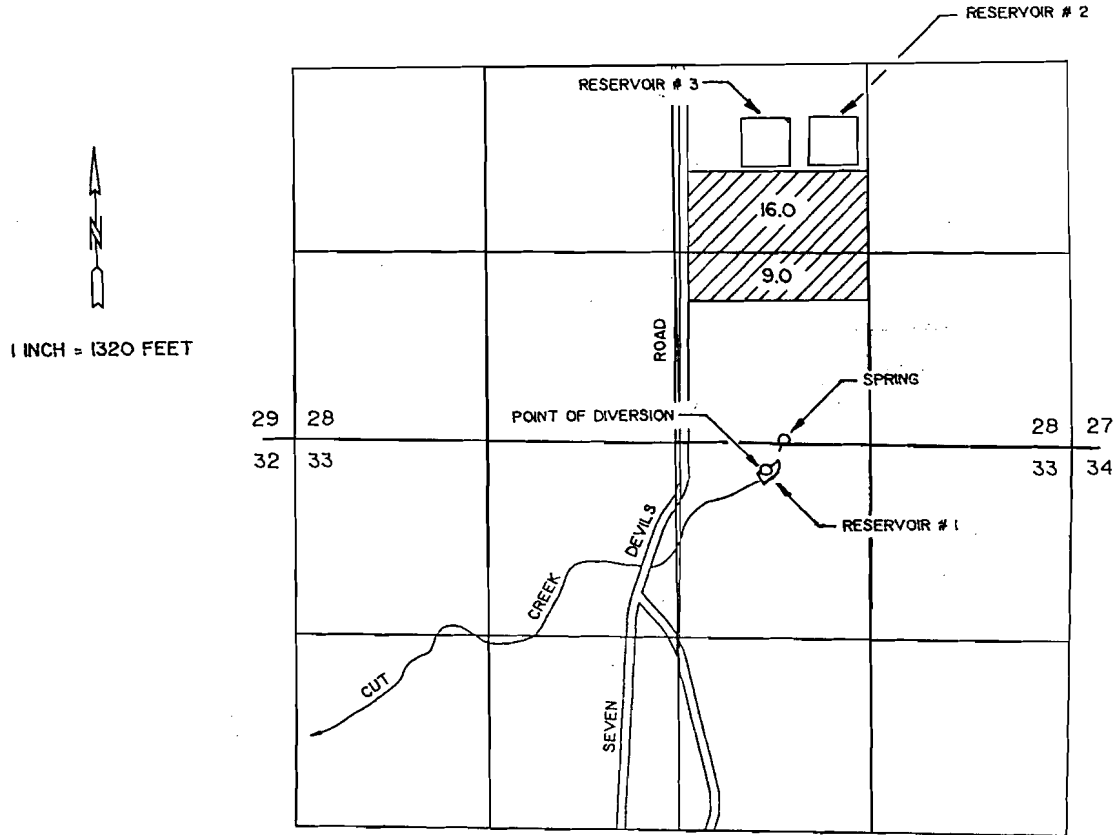

THE POINT OF DIVERSION IS TO BE LOCATED 160 FEET SOUTH AND 3240 FEET EAST FROM THE NORTHWEST CORNER OF SECTION 33, BEING WITHIN THE NW 1/4 OF THE NE 1/4 OF SECTION 33, TOWNSHIP 27 SOUTH, RANGE 14 WEST, W.M., COOS COUNTY.

THE PURPOSE OF THIS MAP IS TO IDENTIFY THE LOCATION OF THE WATER RIGHT. IT IS NOT INTENDED TO PROVIDE INFORMATION RELATIVE TO THE LOCATION OF PROPERTY OWNERSHIP BOUNDARY LINES.

