

Name MACOMBER'S, INC.
 By _____
 Address Riley, Oregon 97758

Application No. G G 4430
 Permit No. G G 4174
 Certificate No. 59667

FEEES PAID

| Date | Amount | Rec |
|----------|-----------------------|-----|
| 6-5-68 | 10.00 | |
| 6-5-68 | 10.00 | Fr |
| 12-11-73 | 1.50 \$1 Cert. Fee | 3 |

Stream Index, Page No. 12-83
A pond - Not a well

FEEES REFUNDED

| Date | Amount | Ch |
|------|--------|----|
| | | |

Date filed June 5, 1968
 Priority June 5, 1968
 Action suspended until October 1, 1968
 Returned to applicant _____
 Date of approval February 14, 1969

ASSIGNMENTS

| Date | To Whom | Address | Volume |
|------|---------|---------|--------|
| | | | |

CONSTRUCTION

Date for beginning February 14, 1970
 Date for completion October 1, 1970
 Extended to _____
 Date for application of water October 1, 1971
 Extended to _____

REMARKS

0.38 cfs from a well (Chicahominy Creek) (Silver Creek) for the irrigation of 30.
OCT 1 2 1971 CARD FOR C

PROSECUTION OF WORK

Form "A" filed _____
 Form "B" filed Complete
 Form "C" filed Nov 1, 1971

FINAL PROOF NOV 28 1973

Blank mailed _____
 Proof received _____
 Date certificate issued DEC 28 1973

Form C

IMPORTANT—This form is a notice to the State Engineer that permittee is ready to make **final proof** to the extent to which the water has actually been applied to the intended use under the terms of the permit. Permittee is cautioned that Certificate of Water Right will be issued based on the extent of the quantity and use as determined by the **final proof** inspection and survey which will be made in response to the filing of this Form C.

NOTE: In the case of an irrigation permit, this Form C should not be mailed to the State Engineer until all of the land described in the permit, which it is intended to irrigate under this permit at any time, has actually been irrigated. Fill out, detach and mail to the State Engineer, Salem, Oregon 97310, when all of the water has been applied.

Application No. G 4430

NOTICE OF COMPLETE APPLICATION OF WATER TO A BENEFICIAL USE

I, Macomber's, Inc., the holder of Permit No. G 4174

do appropriate the public waters of the state of Oregon, completely applied the waters to a beneficial use in accordance with the terms of said permit, on the 30th day of June, 1969

Remarks: Partial application completed with no other intended at present.

IN WITNESS WHEREOF, I have hereunto set my hand this 29th day of October, 1971

Macomber's Inc. by Chas. F. Macomber, Pres.

(Signature of Applicant)

Riley, Oregon 97758

(Address)

NOV 1 1971
STATE ENGINEER
SALEM OREGON

T. 23 S. R. 27 E. W. M.

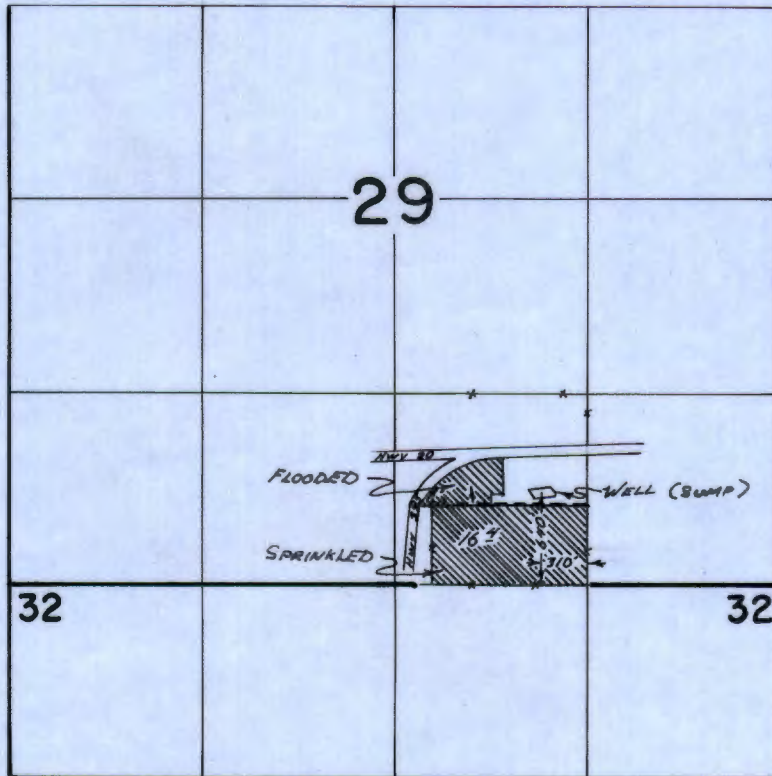

FINAL PROOF SURVEY
UNDER

Application No. *G-2430* Permit No. *G-4177*
IN NAME OF

MACOMBER'S, INC.

Surveyed *Aug. 26* 19*72*, by *R. G. MUCKEN*

RECEIVED

DEC 11 1973

STATE ENGINEER
SALEM, OREGON

STATE OF OREGON

COUNTY OF HARNEY

Proof of Appropriation of Water

MACOMBER'S INCORPORATED

97758

of **Riley**
has applied beneficially the waters of
a well

, State of **Oregon**

a tributary of **Chicahominy Creek (Silver Creek)**
irrigation of **16.4 acres**

for the purpose of

under Permit No. **G-4174** of the State Engineer, and that the use of said waters has been completed under the terms of said permit; that the priority of the right dates from **June 5, 1968**

that the amount of water for the purposes aforesaid, has been actually beneficially used in the amount of

0.21 cubic foot per second

or its equivalent in case of rotation, measured at the point of diversion from the stream. The point of diversion is located in the **SW $\frac{1}{4}$ SE $\frac{1}{4}$, Section 29, T. 23 S., R. 27 E., W. M., 640 feet North and 310 feet West from the SE Corner, SW $\frac{1}{4}$ SE $\frac{1}{4}$.**

The amount of water used for irrigation, together with the amount secured under any other right existing for the same lands, shall be limited to **one-eightieth** of one cubic foot per second per acre, or its equivalent for each acre irrigated and shall be further limited to a diversion of not to exceed **3 acre feet per acre** for each acre irrigated during the irrigation season of each year;

and shall conform to such reasonable rotation system as may be ordered by the proper state officer.

A description of the place of use under the right, and to which such right is appurtenant, is as follows:

**16.4 acres SW $\frac{1}{4}$ SE $\frac{1}{4}$
Section 29
T. 23 S., R. 27 E., W. M.**

I have read the above and foregoing proof of appropriation of water; I know the contents thereof, and that the facts therein stated are true.

IN WITNESS WHEREOF, I have hereunto set my hand this 10th day of December

1973



Macomber's Inc.

SW 1/4 SE 1/4, SECTION 29,

TOWNSHIP 23 S. RANGE 27 EAST U.M.

HARNEY COUNTY, OREGON

Application No. G-4430
Permit No. G-4174

Mag. Dec. 19° 30'

RECEIVED
JUN 25 1968
STATE ENGINEER
SALEM, OREGON

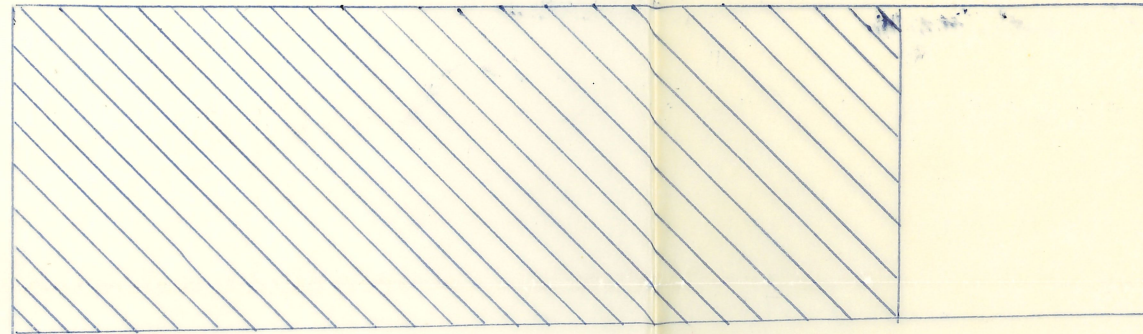

US Highway No 20

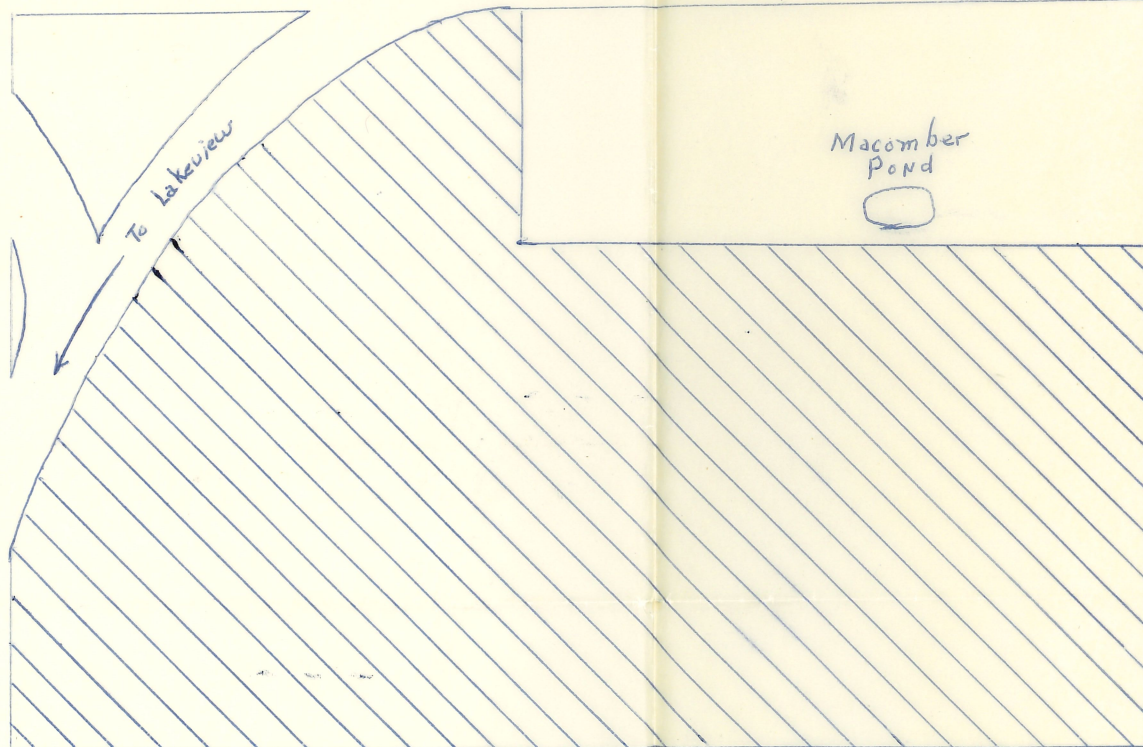

Scale 1" = 220'

MAP NO. 2

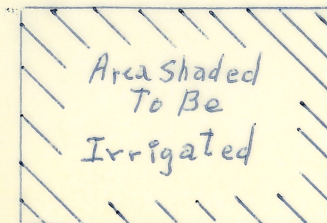

File No. G-4430

November 28, 1973

Macomber's Inc.
Riley, OR 97758

Gentlemen:

Enclosed is the final proof in connection with the incomplete water right represented by your permit number G-4174.

The data contained in the proof, which is based on an inspection and survey of your project made by a representative of this department, defines the extent to which your water right has been completed within the terms of your permit. The proof should be dated and signed by you and returned to this office.

Upon receipt of the proof, properly executed and accompanied by the statutory recording fee of \$1.50, a certificate of water right will be issued confirming the right thereunder and, after being recorded in the county records, will be forwarded to you.

Very truly yours,

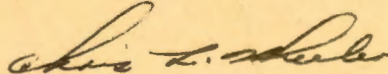

CHRIS L. WHEELER
State Engineer

Form 117

Enclosure

The enclosed map may be retained for your own records.

**STATE
ENGINEER**

WATER RESOURCES DEPARTMENT

1178 CHEMEKETA STREET N.E. • SALEM, OREGON • 97310 • Phone 378-3739

Macomber's, Inc.
Riley, OR 97758

November 8, 1971

G-4430

Gentlemen:

This will acknowledge receipt of your notice to the effect that complete application of water has been made under permit No. G-4174.

Pursuant to your report and in line with the general practice of this office, a survey will be made at a later date.

After this survey, proof may be made and certificate issued covering the actual use of water as found by the engineer. In case of irrigation, any lands described in the permit that have not been irrigated will be automatically eliminated from the water right.

In the meantime, the permit which you hold will be valid evidence of the water right in question so long as you continue to use the water.

Very truly yours,

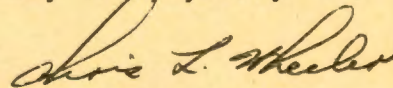

CHRIS L. WHEELER
State Engineer

Form 128

reo

February 26, 1969

G-4430

Macomber's, Inc.
Riley
Oregon 97758

blueprint.

G-4430, permit No. G-4174 with a

G-4430

July 15, 1968

Macomber's Inc.
Riley
Oregon 97758

Gentlemen:

This will acknowledge receipt of your returned application
No. G-4430 and transparency map.

This application is now in satisfactory form for approval
by issuance of a permit.

Very truly yours,

CHRIS L. WHEELER
State Engineer

By
Larry W. Jebousek
Assistant

LWJ:ks

June 20, 1968

Macomber's Inc.
Riley.
Oregon 97758

Gentlemen:

This will acknowledge receipt of your application for a permit to appropriate 350 gallons of water per minute from a sump type well for the irrigation of 30 acres, two maps, and the additional fee of \$10 for which our receipt No. 9362 is enclosed. Your application has been filed and numbered G-4430.

This application is in satisfactory form, with the exception that the map submitted is not on transparent tracing paper. A tracing of the map submitted on the proper paper will be satisfactory.

I am returning the application and Map No. 2 for completion. The application is endorsed so that in order to retain its date of priority, it must be returned on or before August 20, 1968.

Very truly yours,

CHRIS L. WHEELER
State Engineer

By
Larry W. Jebousek
Assistant

LWJ:dlw
Enclosures

May 22, 1968

Macomber's Inc.
Riley
Oregon 97758

Gentlemen:

This will acknowledge receipt of your application for a permit to appropriate 350 gallons of water per minute from a pond type well for the irrigation of 30 acres, a map, legal description, and the fee of \$10 for which our receipt No. 9016 is enclosed. This application can not be filed because there is insufficient fees to do so. An additional \$10 filing fee is required.

The required map must be submitted in the form of a reproduceable transparency. The specific 30 acres to be irrigated must be designated on the map. A tracing of the map submitted showing this information would be satisfactory.

The \$10, which you submitted, has been placed in an open account in your name, and will be applied to this application, when returned to this office.

I am herewith returning your application and data.

Very truly yours,

CHRIS L. WHEELER
State Engineer

By
Larry W. Jebousek
Assistant

LWJ:dlw
Enclosures

5161

No. _____

_____ Check _____ M.O. _____ Cash

- _____ Surface
- _____ Reservoir
- ✓ _____ Ground Water
- _____ Transfer
- ✓ _____ Tracing
- _____ Prints
- _____ Plans
- _____ Copying
- _____ Property Description
- _____ Spring Description
- _____ Small Dam Data
- _____ Ex. Time Per.)
- _____ Assign. Per.)
- _____ Cert. Rec. Fee, Per.) _____

Specs
P 4

Contractors
Exam _____
License _____

Operators
Exam _____
License _____

RECEIVED
MAY 16 1968
Other

STATE ENGINEER
SALEM OREGON

SW 1/4 SE 1/4, SECTION 29,
TOWNSHIP 23 S. RANGE 27 EAST W.M.
HARNEY COUNTY, OREGON

RECEIVED
MAY 16 1968
STATE ENGINEER
SALEM OREGON

Mag. Dec. 19° 30'

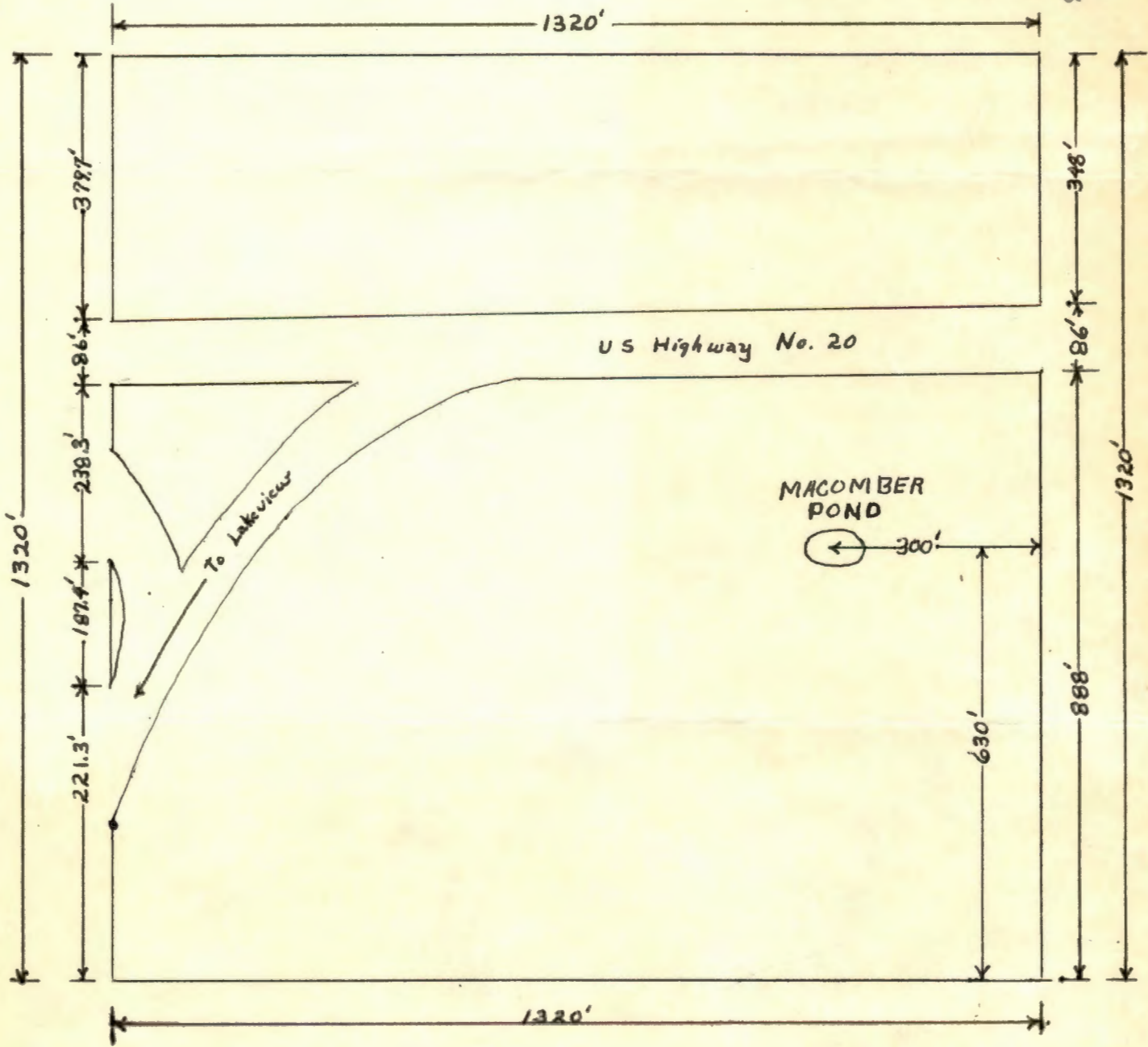

Scale 1" = 220'

Application No. G-4430
Permit No.

RECEIVED
JUN 5 1968
STATE ENGINEER
SALEM OREGON

RECEIVED
JUN 5 1968
STATE ENGINEER
SALEM OREGON

RECEIVED
MAY 16 1968
STATE ENGINEER
SALEM OREGON

SW $\frac{1}{4}$ SE $\frac{1}{4}$; Section 29, Township 23S, Range 27 East W.M.
Harney County, Oregon

Application No. G-4430
Permit No.

C-form only partially completed

DRAFTED
T. PAUL

Abstract of Permit No. G-4174

Application No. G-4430 ✓ Certificate No.

Name **Masomber's, Inc.** ✓

Address **Riley, Oregon** ✓

Source of water supply **A well** ✓ **9975B**

Use **Irrigation of 16 1/2 ac** ✓

Point of diversion **640' N E 310' W** ✓

Number of acres **16 1/2** ✓

630' N. x 300' W. from SE cor. SW 1/4 SE 1/4, being within SW 1/4 SE 1/4, Sec. 29, T. 23 S., R. 27 E., W. M., county of Harney ✓

1972-M
8-26-72
R. S. M.

DESCRIPTION OF LAND TO BE IRRIGATED OR PLACE OF USE

| Twp. | Range | Sec. | NE 1/4 | | | | NW 1/4 | | | | SW 1/4 | | | | SE 1/4 | | | |
|------|-------|------|--------|--------|--------|--------|--------|--------|--------|--------|--------|--------|--------|--------|--------|--------|--------|-----------|
| | | | NE 1/4 | NW 1/4 | SW 1/4 | SE 1/4 | NE 1/4 | NW 1/4 | SW 1/4 | SE 1/4 | NE 1/4 | NW 1/4 | SW 1/4 | SE 1/4 | NE 1/4 | NW 1/4 | SW 1/4 | SE 1/4 |
| 235 | 27E | 29 | | | | | | | | | | | | | | | | |
| | | 29 | | SW 1/4 | | | | SE 1/4 | | | | | | | | | | 16 1/2 ac |

Priority date **June 5, 1968** ✓

Amount of water **.21** ✓ **0.35 c.f.s.** ✓

Time limit to begin construction **February 14, 1970** ✓

Time limit to complete construction **10-1-70** extended to _____ extended to _____

Time limit to completely apply water **10-1-71** extended to _____ extended to _____

Remarks: This appropriation shall be limited to 1/80th of one cubic foot per second or its equivalent for each acre irrigated and shall be further limited to a diversion of not to exceed 3 acre feet per acre for each acre irrigated during the irrigation season of each year; and shall be subject to such reasonable rotation system as may be ordered by the proper state officer.

INFO: Mr. Moser

All in ~~the~~ ~~west~~ portion N. of rd.

The N part consisting from the rectangular field S. of road is flooded, rest is gotten by wheel line, as flooded by subbing. Holds water level eye in ditch.

WELL - a sump approx 12' deep

PUMP - CORNELL Q.D. CENTER 2 1/2" X 2"

MOTOR - CENTURY 10 H.P @ 3500 R.P.M

PIPE - 900' - 5" ALUM MAIN
1000' - 4" WHEEL LINE

HEADS - 27 5/32 X 0 ALL MAX

DITCH - 1" BOTT, 2 1/2' TO A 1" DEEP
SLIGHTLY UPHILL

USE - HAY & ALFALFA.

TIE - S.E. Cor S.W. 1/4 S.E. 1/4 sec. 29

8-26-72

F.E.

R. S. Moser

SW 1/4 SE 1/4, SECTION 29,

TOWNSHIP 23 S. RANGE 27 EAST W.M.

HARNEY COUNTY, OREGON

Application No. G-4430
Permit No. G-4174

Mag. Dec. 19° 36'

RECEIVED
JUN 25 1968
STATE ENGINEER
SALEM, OREGON

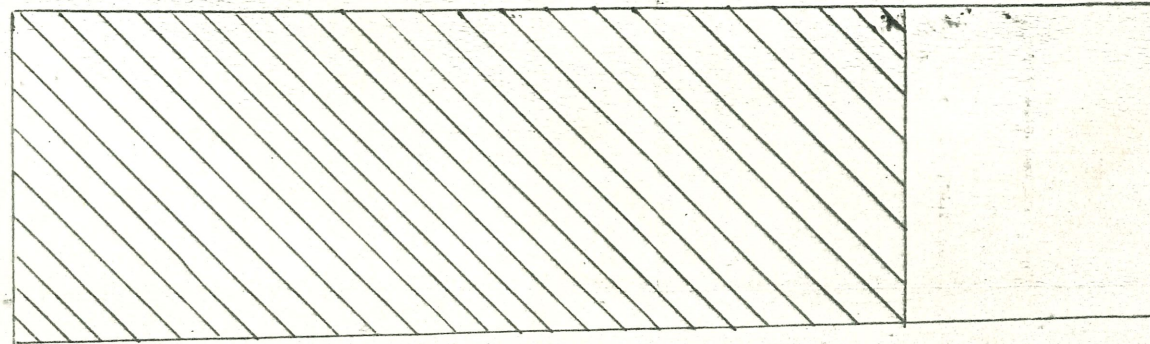

U.S. Highway No 20

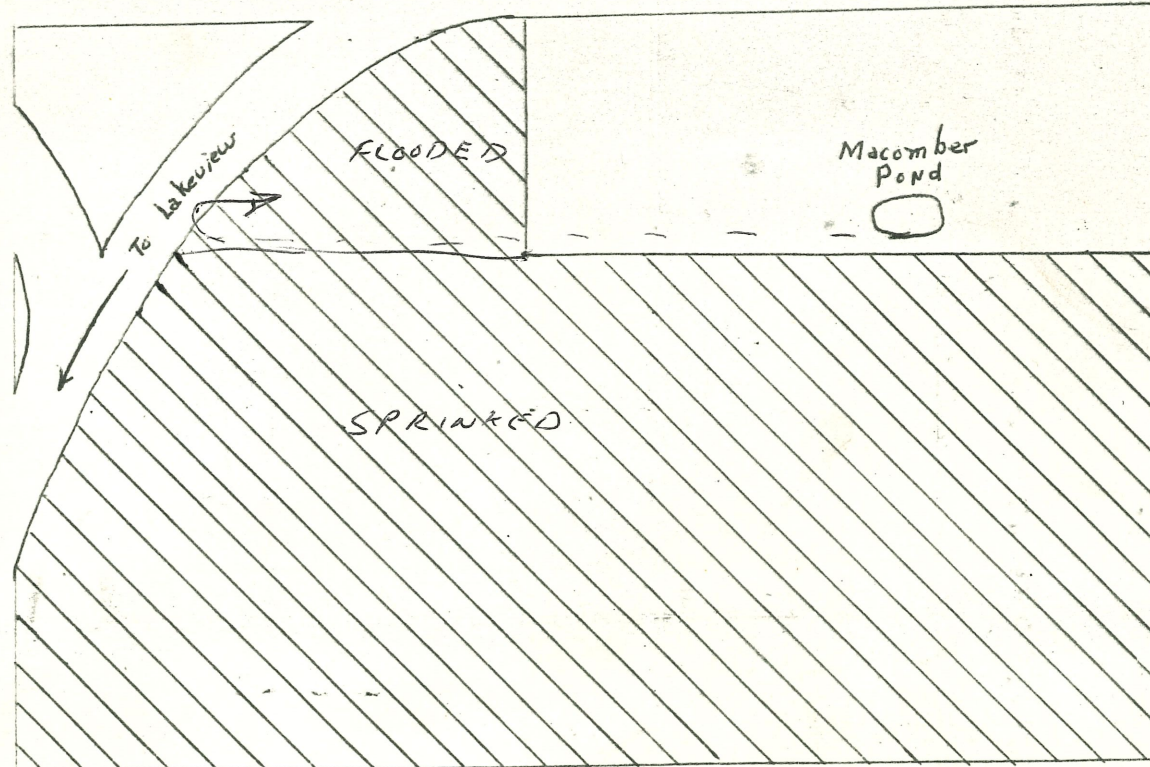

Scale 1" = 220'

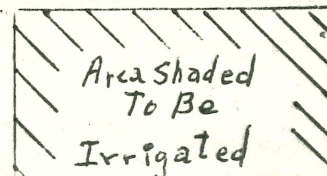

MAD NA 2

Distribute with surface water

Om 6/6/68