

ASSIGNED

Name Elsie Loveness
 By _____
 Address Star Route, Box 21-A
Malin, OR 97632

Date filed September 7, 1982
 Priority November 19, 1982
 Action suspended until 1/1/83

Return to applicant _____
 Date of approval DEC 20 1982

CONSTRUCTION

Date for beginning DEC 20 1983
 Date for completion OCT 1 1984
 Extended to _____
 Date for application of water OCT 1 1985
 Extended to _____

PROSECUTION OF WORK

Form "A" filed _____
 Form "B" filed _____
 Form "C" filed Completed

FINAL PROOF

Blank mailed DEC 15 1982
 Proof received _____
 Date certificate issued FEB 6 1983

Application No. G10804
 Permit No. G 9937
 Certificate No. 68137

Stream Index, Page No. 14-46

FEES PAID		
Date	Amount	Receipt No.
9-7-82	92.00	32714
FEES REFUNDED		
Date	Amount	Check No.

ASSIGNMENTS

Date	To Whom	Address	ph.	Volume	Page
12-24-72	not in use + Farm Credit Serv and	Box 148 K Falls 97601			
—	Malvin C. + Virginia K. Hardison	Box 148 K Falls 97601	ph (912) 365-0161	7	2719

REMARKS

T. 40 S., R. 12 E., W.M.

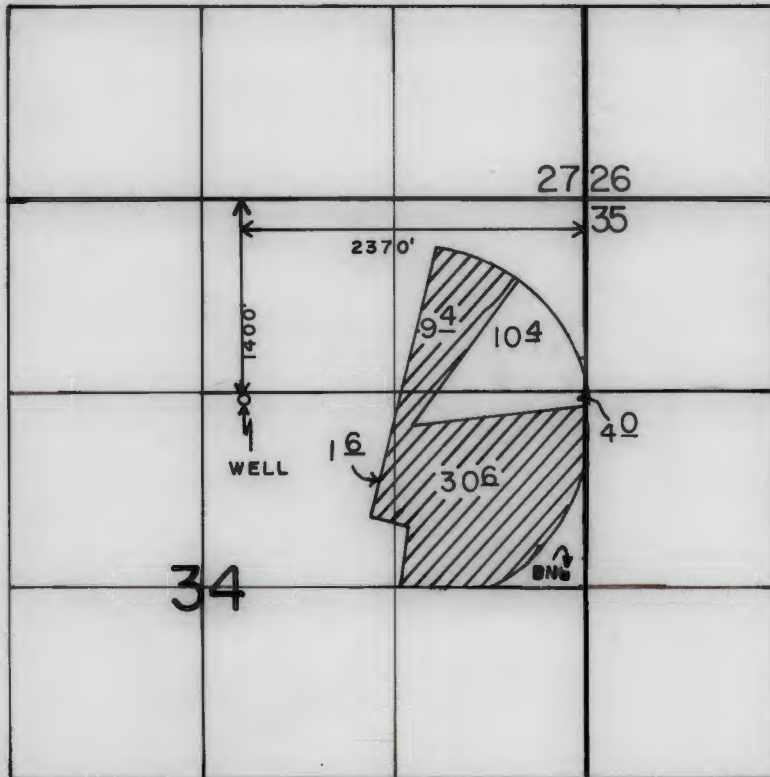

SCALE: 1" = 1320'

FINAL PROOF SURVEY UNDER

Application No. G-10804 Permit No. G-9937
IN NAME OF

NORTHWEST FARM CREDIT SERVICES, ACA
MELVIN C. & VIRGINIA K. HENDRICKSON

Surveyed OCT 17, 1992, by B.W. BISHOP

T. 40 S., R. 12 E., W.M.

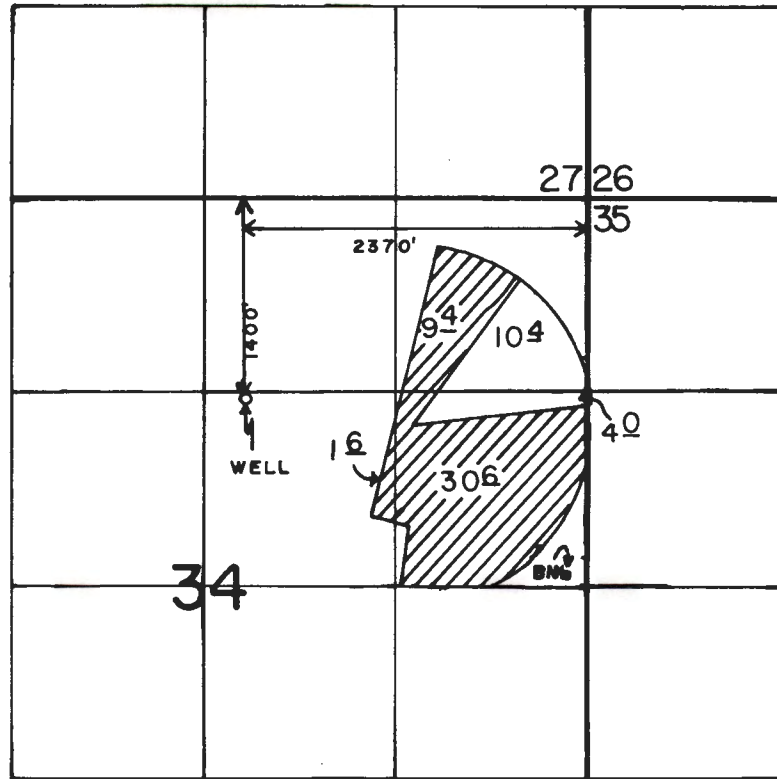

SCALE: 1" = 1320'

FINAL PROOF SURVEY

UNDER

Application No. G-10804 Permit No. G-9937
IN NAME OF

NORTHWEST FARM CREDIT SERVICES, ACA
MELVIN C. & VIRGINIA K. HENDRICKSON

Surveyed OCT 17, 1992, by B.W. BISHOP

MAY 11 1992

WATER

RESOURCES

DEPARTMENT

N O T I C E

Enclosed is a proposed certificate of water right and a map which illustrates the location of the right. The map and proposed certificate represent the extent water was used within the terms of the permit based upon a survey and inspection made by a representative of this department.

If you do not agree with the proposed certificate or the map, Oregon Administrative Rule 690-11-110 allows the permittee or landowner 60 days from the mailing date of this notice to petition the Department to reconsider the contents of the proposed certificate.

If you agree with the proposed certificate and map no response to this notice is required. Shortly after the 60 day period, the recorded certificate of water right will be mailed to you.

Our field examiner found a total of 58.7 acres claimed irrigated in connection with Permit No. G-9937 which exceeds the limit of 41.6 acres under the permit. If you intend to establish a legal water right for the additional 17.1 acres, you will need to determine the permitting requirements for your area.

The 17.1 acres overacreage is displayed on the map copy as an unhatched area. If this area is not located where you prefer it to be, please notify us as it may be possible to locate the area elsewhere on your lands.

cc: Del Sparks, Watermaster, District 17



3850 Portland Rd NE
Salem, OR 97310
(503) 378-3739
FAX (503) 378-8130

STATE OF OREGON

COUNTY OF KLAMATH

PROPOSED CERTIFICATE OF WATER RIGHT

THIS CERTIFICATE ISSUED TO

ELSIE LOVENESS
36121 STASTNY ROAD
MALIN, OREGON 97632

confirms the right to use the waters of A WELL in the LOST RIVER BASIN for IRRIGATING 41.6 ACRES.

This right was perfected under Permit G-9937. The date of priority is NOVEMBER 19, 1982. This right is limited to 0.52 CUBIC FOOT PER SECOND or its equivalent in case of rotation, measured at the well.

The well is located as follows:

SW 1/4 NE 1/4, SECTION 34, T 40 S, R 12 E, W.M.; 1400 FEET SOUTH AND 2370 FEET WEST FROM THE NORTHEAST CORNER OF SECTION 34.

The amount of water used for irrigation together with the amount secured under any other right existing for the same lands, is limited to a diversion of ONE-EIGHTIETH of one cubic foot per second (or its equivalent) and 3.0 acre-feet for each acre irrigated during the irrigation season of each year.

The use shall conform to such reasonable rotation system as may be ordered by the proper state officer.

A description of the place of use to which this right is appurtenant is as follows:

NE 1/4 NE 1/4	19.8 ACRES
SW 1/4 NE 1/4	1.6 ACRES
SE 1/4 NE 1/4	20.2 ACRES
SECTION 34	
TOWNSHIP 40 SOUTH, RANGE 12 EAST, W.M.	

In the event of a request for a change in point of appropriation, an additional point of appropriation or repair of this well, the quantity of water allowed herein together with any other right from this point of appropriation shall not exceed the capacity of this well at the time of perfection of this right.

The well shall be maintained in accordance with the General Standards for the Construction and Maintenance of Water Wells in Oregon.

The right to use water for the above purpose is restricted to beneficial use on the lands or place of use described.

G-10804.BWB



STATE OF OREGON
COUNTY OF KLAMATH
PROPOSED CERTIFICATE OF WATER RIGHT

THIS CERTIFICATE ISSUED TO

NORTHWEST FARM CREDIT SERVICES, ACA
PO BOX 148
KLAMATH FALLS, OREGON 97601

MELVIN C. AND VIRGINIA K. HENDRICKSON
6529 QUAIL CREEK ROAD
REDDING, CALIFORNIA 96002

confirms the right to use the waters of A WELL in the LOST RIVER BASIN for IRRIGATING 41.6 ACRES.

This right was perfected under Permit G-9937. The date of priority is NOVEMBER 19, 1982. This right is limited to 0.52 CUBIC FOOT PER SECOND or its equivalent in case of rotation, measured at the well.

The well is located as follows:

SW 1/4 NE 1/4, SECTION 34, T 40 S, R 12 E, W.M.; 1400 FEET SOUTH AND 2370 FEET WEST FROM THE NORTHEAST CORNER OF SECTION 34.

The amount of water used for irrigation together with the amount secured under any other right existing for the same lands, is limited to a diversion of ONE-EIGHTIETH of one cubic foot per second (or its equivalent) and 3.0 acre-feet for each acre irrigated during the irrigation season of each year. IN THE EVENT OF A REQUEST FOR A CHANGE IN POINT OF APPROPRIATION, AN ADDITIONAL POINT OF APPROPRIATION OR REPAIR OF THIS WELL, THE QUANTITY OF WATER ALLOWED HEREIN TOGETHER WITH ANY OTHER RIGHT FROM THIS POINT OF APPROPRIATION SHALL NOT EXCEED THE CAPACITY OF THIS WELL AT THE TIME OF PERFECTION OF THIS RIGHT.

The use shall conform to such reasonable rotation system as may be ordered by the proper state officer.

A description of the place of use to which this right is appurtenant is as follows:

NE 1/4 NE 1/4	9.4 ACRES
SW 1/4 NE 1/4	1.6 ACRES
SE 1/4 NE 1/4	30.6 ACRES
SECTION 34	
TOWNSHIP 40 SOUTH, RANGE 12 EAST, W.M.	

The well shall be maintained in accordance with the General Standards for the Construction and Maintenance of Water Wells in Oregon.

The right to use water for the above purpose is restricted to beneficial use on the lands or place of use described.

STATE OF OREGON

COUNTY OF KLAMATH

PROPOSED CERTIFICATE OF WATER RIGHT

THIS CERTIFICATE ISSUED TO

NORTHWEST FARM CREDIT SERVICES, ACA
PO BOX 148 MELVIN C. AND VIRGINIA K. HENDRICKSON
KLAMATH FALLS, OREGON 97601 6529 QUAIL CREEK ROAD
REDDING, CALIFORNIA 96002

confirms the right to use the waters of A WELL in the LOST RIVER BASIN for IRRIGATING 41.6 ACRES.

This right was perfected under Permit G-9937. The date of priority is NOVEMBER 19, 1982. This right is limited to 0.52 CUBIC FOOT PER SECOND or its equivalent in case of rotation, measured at the well.

The well is located as follows:

SW 1/4 NE 1/4, SECTION 34, T 40 S, R 12 E, W.M.; 1400 FEET SOUTH AND 2370 FEET WEST FROM THE NORTHEAST CORNER OF SECTION 34.

The amount of water used for irrigation together with the amount secured under any other right existing for the same lands, is limited to a diversion of ONE-EIGHTIETH of one cubic foot per second (or its equivalent) and 3.0 acre-feet for each acre irrigated during the irrigation season of each year. ~~PROVIDED FURTHER THAT~~ IN THE EVENT OF A REQUEST FOR A CHANGE IN POINT OF APPROPRIATION, AN ADDITIONAL POINT OF APPROPRIATION OR REPAIR OF THIS WELL, THE QUANTITY OF WATER ALLOWED HEREIN TOGETHER WITH ANY OTHER RIGHT FROM THIS POINT OF APPROPRIATION SHALL NOT EXCEED THE CAPACITY OF THIS WELL AT THE TIME OF PERFECTION OF THIS RIGHT.

The use shall conform to such reasonable rotation system as may be ordered by the proper state officer.

A description of the place of use to which this right is appurtenant is as follows:

NE 1/4 NE 1/4	9.4 ACRES
SW 1/4 NE 1/4	1.6 ACRES
SE 1/4 NE 1/4	30.6 ACRES
SECTION 34	
TOWNSHIP 40 SOUTH, RANGE 12 EAST, W.M.	

The well shall be maintained in accordance with the General Standards for the Construction and Maintenance of Water Wells in Oregon.

The right to use water for the above purpose is restricted to beneficial use on the lands or place of use described.

Abstract of Permit

Northwest Farm Credit
Srcs, ACA ph. 882.5551

and

Melvin C. + Virginia K. Hendrickson

This is to certify that I have examined APPLICATION G-10804 and do hereby grant the same SUBJECT TO EXISTING RIGHTS and the following limitations and conditions:

This permit is issued to **ASSIGNED** Elsie Loveness (formerly Micka) of Star Route, Box 21A, Mailn, Oregon 97632, phone 723-6611, one well

36121 STASTNY RD PH (916) 365-

Po Box 148, K Falls 97601

6529 Quail Crk. Rd.
Redding CA 96002

for the PURPOSE of **Irrigation**

that the PRIORITY OF THE RIGHT dates from **November 19, 1982**

and is limited to the amount of water which can be applied to beneficial use and shall not exceed **0.52 cubic foot per second**

measured at the point of diversion from the **well**, or its equivalent in case of rotation with other water users.

The well is to be LOCATED: **1,350 feet South and 2,333 feet West from the NE Corner of Section 24, being within the SW 1/4 NE 1/4, Section 34, Township 40 South, Range 12 East, WM, in the County of Klamath.**

A description of the PLACE OF USE under the permit, and to which such right is appurtenant, is as follows:

Township 40 South, Range 12 East, WM	Section 34	NE 1/4	NE 1/4	14.0 acres
		SE 1/4	NE 1/4	26.0 acres
		SA 1/4	NE 1/4	1.6 acres

The AMOUNT OF WATER used for irrigation, together with the amount secured under any other right existing for the same lands shall be limited to 1/80 of one cubic foot per second per acre, and shall be further limited to a diversion of not to exceed 3.0 acre-feet per acre for each acre irrigated during the irrigation season of each year, provided further that in the event of a request for a change in point of appropriation, an additional additional point of appropriation or repair of this well, the quantity of water allowed herein together with any other right from this point of appropriation shall not exceed the capacity of this well at the time of perfection of this right, and shall conform to such reasonable rotation system as may be ordered by the proper state officer.

The well shall be constructed in accordance with the General Standards for the Construction and Maintenance of Water Wells in Oregon. The works constructed shall include an air line and pressure gauge or an access port for measuring line, adequate to determine water level elevation in the well at all times. The permittee shall install and maintain a weir, meter, or other suitable measuring device, and shall keep a complete record of the amount of ground water withdrawn.

Actual construction work shall begin on or before **December 20, 1983**, and shall thereafter be prosecuted with reasonable diligence and be completed on or before October 1, 19 **84**.

Complete application of the water to the proposed use shall be made on or before October 1, 19 **85**.

Witness my hand this **20th** day of **December**, 19 **82**.

WATER RESOURCES DIRECTOR

This permit is for the beneficial use of water. By law, the land use associated with this water use must be in compliance with statewide land-use goals and any local acknowledged land-use plan. It is possible that the land use you propose may not be allowed if it is not in keeping with the goals and the acknowledged plan. Your city or county planning agency can advise you about the land-use plan in your area.

APPLICATION G-10804

PERMIT **G 9937**

41055-270-75R
10/17/90
02395-132
No Photo

Not Home
6-20-87

NFO: LOREN LOVENESE, HUSBAND, CURRENT ADDRESS: 36121 STASTNY RD, MAUN.
 CENTER PIVOT RUNS FULL CIRCLE. SE CORNER IS IRRIGATED USING HANDLING.
 WHEN IN SPUDS. AREA IN NE IS GRAZED. NOT IN NORMAL CROPS. HAS
 GOOD GRASS & WOOD COVER THIS DATE.

SOURCE: A WELL - MOST INFO UNK. DRILLED IN MID TO LATE 50's FOR
 RAY DRAKE. PUMP COVERS CASING. HAS AIRLINE

PUMP: LAYNE & BOULDER DDT 8" DISCHARGE MODEL #12 CM 1000 GPM @ 440' HD.

MOTOR: US MOTORS 125 HP @ 1800 RPM. SAID OUTPUT 1300 GPM.

D.P.E: 1220'± VALLEY CENTER PIVOT (LOW PRESSURE)
 SEVERAL THOUSAND FEET OF 3" LATERAL & PORTABLE MAINLINE

HEADS: PIVOT + UNK MAX LATERAL ROYAL COACH 5' RB 30 7/64 X 0

USE: IRRIGATION OF SPUDS, GRAIN & PASTURE

LIFT: ± 20' ROLLING TERRAIN.

T.I.E: 41035-278-75R

$$Q_{PUMP} = \frac{7.04 \times 15}{152.4} =$$

10/17/90
 Benjamin W. Bentley
 F.I.

$$Q_{LAND} = \frac{41.6^{1.6} AC}{\frac{1}{90}} = 0.52 CFS$$

$$Q_{PUMP} = \frac{(7.04)(125)}{152.4} = 5.77 CFS \quad SAID 1300 GPM = 2.89 CFS$$

$$Q_{HEADS} = \frac{1(900)}{450} = 2.0 CFS + RBS$$

$$Q_{LAND} = \frac{41.6}{90} = 0.52 CFS$$

T. 40 S., R. 12 E., W.M.

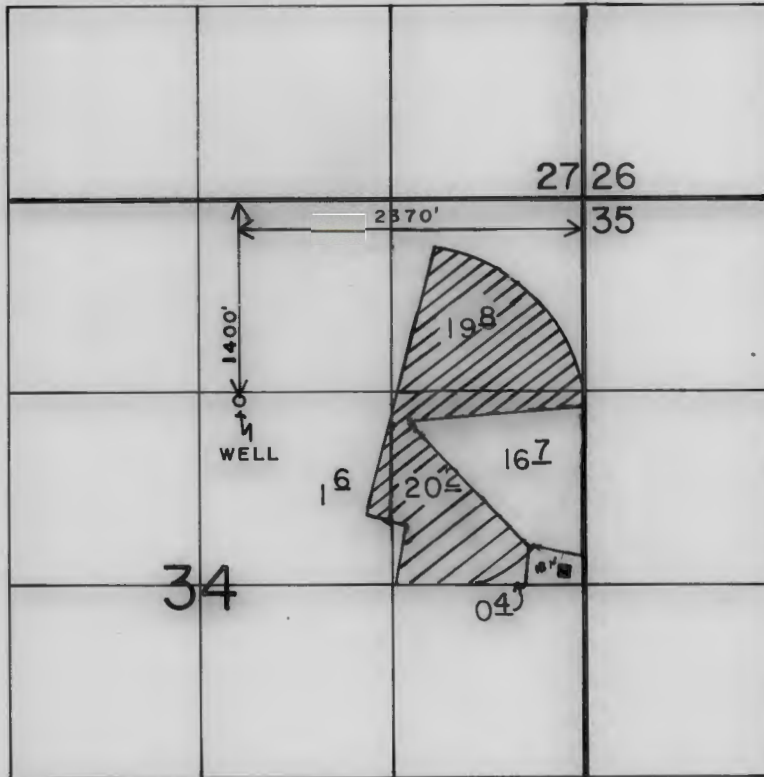

N
SUPERSEDED

SCALE: 1" = 1320'

FINAL PROOF SURVEY
UNDER

Application No. G-10804 Permit No. G-9937.....
IN NAME OF

..... ELSIE LOVENESS

Surveyed OCT. 10. 19.90, by B.W. BISHOP.....

Handwritten signatures and notes, including 'Elsie Loveness' and 'B.W. Bishop'.

T.40S.,R.12E.,W.M.

LISA called she got a call on this from the Land owner he
wants to now way 16 1/2 ac is out of draft Mr Loveness phone # is 723-6611

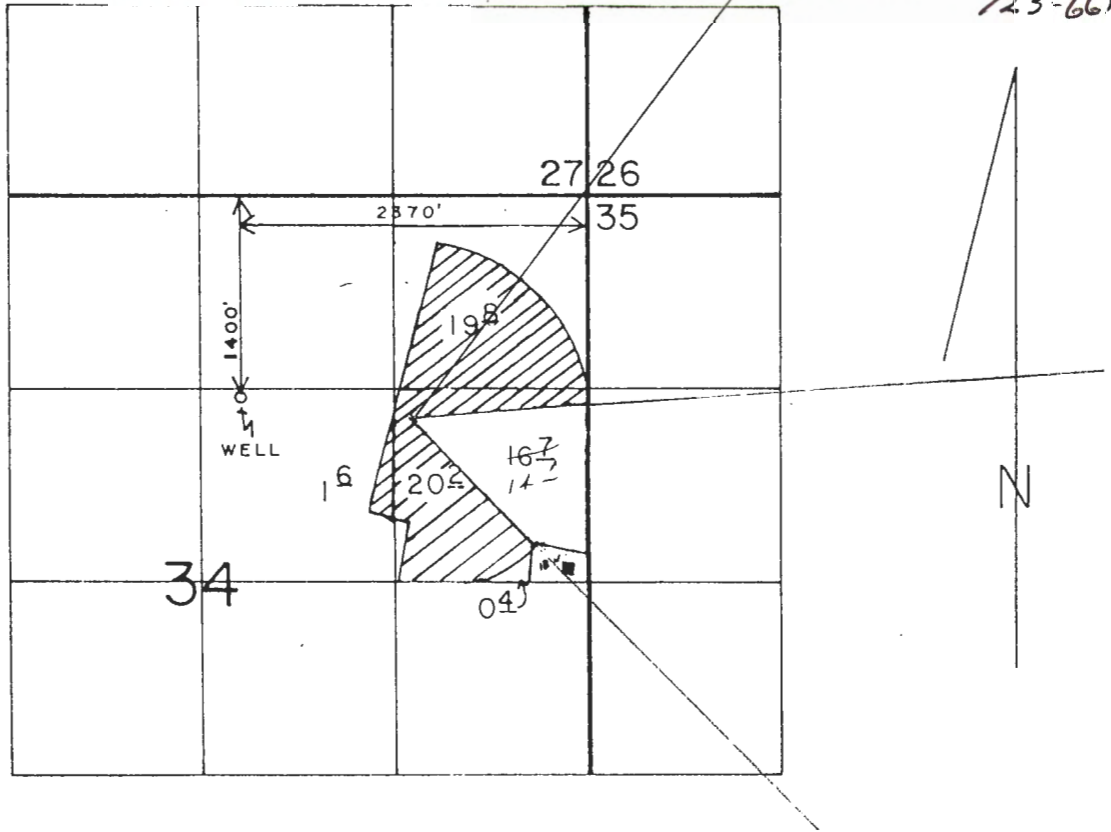

6/15/92 9:00 Am

SCALE: 1" = 1320'

Preliminary Draft
FINAL PROOF SURVEY
UNDER

Application No. G-10804 Permit No. G-9937....
IN NAME OF

ELSIE LOVENESS

Surveyed OCT. 10. 19.90, by B.W.BISHOP....

T40S. R12E.W.M.

RECEIVED

NOV 19 1982

WATER RESOURCES DEPT.
SALEM, OREGON

RECEIVED
SEP 7 1982
WATER RESOURCES DEPT.
SALEM, OREGON

Application No. G-10804
Permit No. G 9937

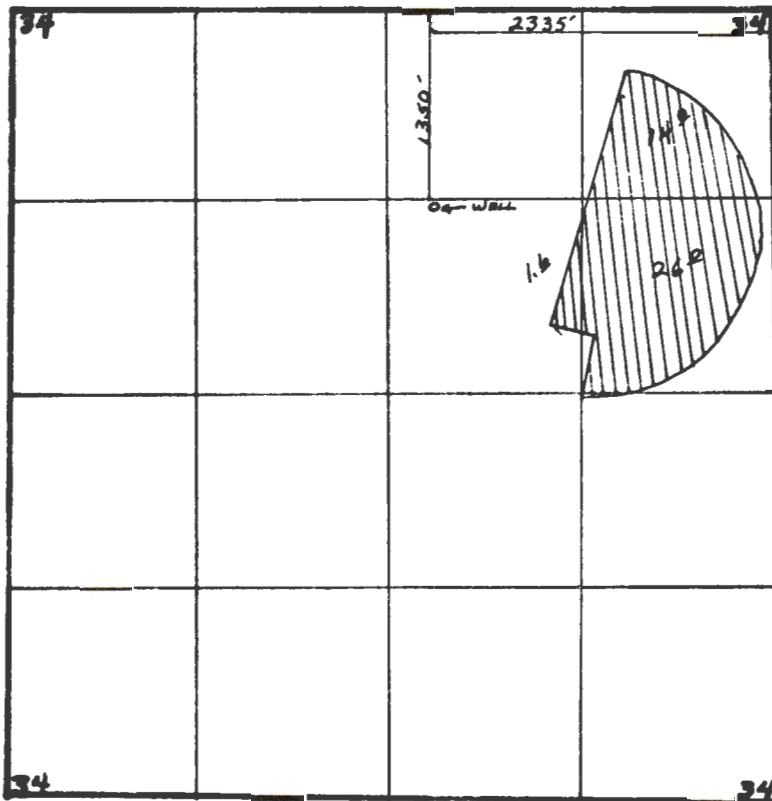

T40 S.R. 12 E.W.M.

West River Wells

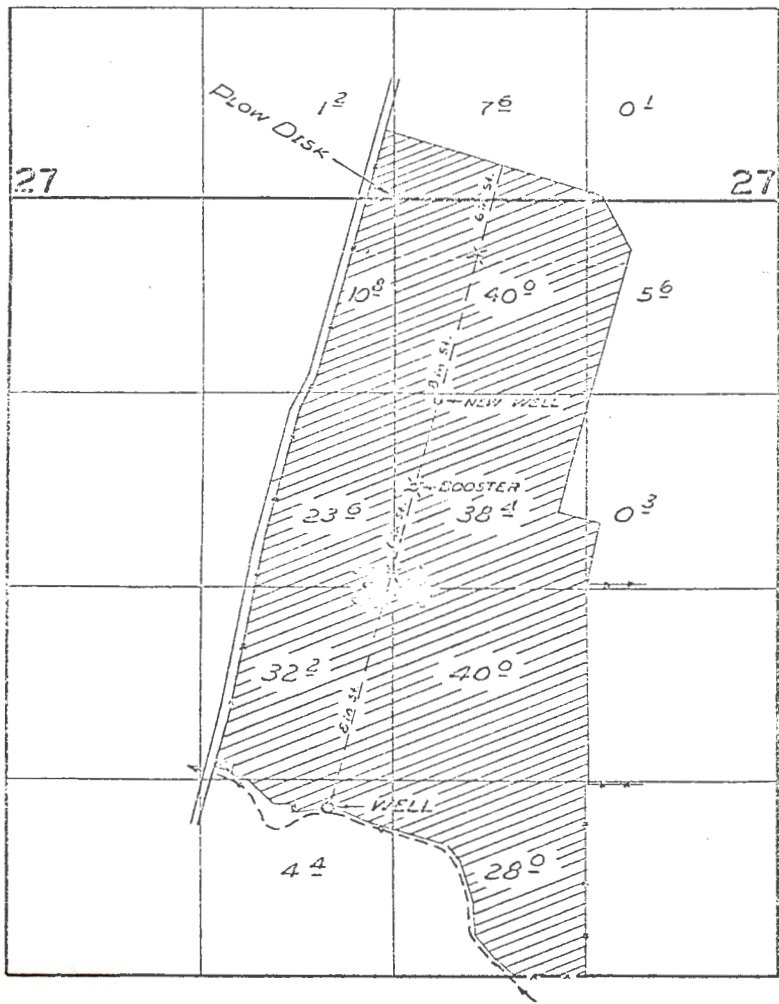

BOUNDARY SURVEY

WATER

Application No. U-393, Part No. U-361

of 1959

C. G. GROSS & MADELINE J. GROSS

Surveyed 20 Oct. 1959 by M. Bick

STATE OF OREGON
COUNTY OF KLAMATH

To: Ben Bishop
WM #11
From: Jake Szrame

PROPOSED CERTIFICATE OF WATER RIGHT

THIS CERTIFICATE ISSUED TO

ELSIE LOVENESS
36121 STASTNY ROAD
MALIN, OREGON 97632

confirms the right to use the waters of A WELL in the LOST RIVER BASIN for IRRIGATING 41.6 ACRES.

This right was perfected under Permit G-9937. The date of priority is NOVEMBER 19, 1982. This right is limited to 0.52 CUBIC FOOT PER SECOND or its equivalent in case of rotation, measured at the well.

The well is located as follows:

SW 1/4 NE 1/4, SECTION 34, T 40 S, R 12 E, W.M.; 1400 FEET SOUTH AND 2370 FEET WEST FROM THE NORTHEAST CORNER OF SECTION 34.

The amount of water used for irrigation together with the amount secured under any other right existing for the same lands, is limited to a diversion of ONE-EIGHTIETH of one cubic foot per second (or its equivalent) and 3.0 acre-feet for each acre irrigated during the irrigation season of each year.

The use shall conform to such reasonable rotation system as may be ordered by the proper state officer.

A description of the place of use to which this right is appurtenant is as follows:

NE 1/4 NE 1/4	19.8 ACRES
SW 1/4 NE 1/4	1.6 ACRES
SE 1/4 NE 1/4	20.2 ACRES
SECTION 34	
TOWNSHIP 40 SOUTH, RANGE 12 EAST, W.M.	

In the event of a request for a change in point of appropriation, an additional point of appropriation or repair of this well, the quantity of water allowed herein together with any other right from this point of appropriation shall not exceed the capacity of this well at the time of perfection of this right.

The well shall be maintained in accordance with the General Standards for the Construction and Maintenance of Water Wells in Oregon.

The right to use water for the above purpose is restricted to beneficial use on the lands or place of use described.

G-10804.BWB



NUMBER 89188

Check 10⁰⁰ NO _____ Cash _____

-
- Surface Application
 - Reservoir Application
 - Ground Water Application
 - Transfer Application
 - Power Claim
 - Hydroelectric Examination
 - Hydroelectric License
 - Copying
 - Assignment
 - Extension of Time
 - Other
 - P-6
 - Quadrangle
 - Basin
 - Protest
 - Constructors Examination
 - Constructors License
 - Adjudication

Jo:
Jon
Hook

G-10804

TO
JANET
A-OK

TO BOTH

SEND ORIGINAL TO

~~F.A.C.~~

F.C.S.

ATTN
M. JOHN

~~BE~~ ALONG w/ RECEIPT

AFTER LETTER SENT
BACK TO JAKE FOR
UPDATE ON PROPOSED
CERTIFICATE.

December 29, 1992

Farm Credit Services
Attn: M. John
PO Box 148
Klamath Falls OR 97601

REFERENCE: File G-10804

The assignment of Permit G-9937 from Elsie Loveness to Melvin C. and Virginia K. Hendrickson and you has been recorded in the records of the Water Resources Department.

Our records have been changed accordingly and the original is enclosed along with our receipt number 95423 covering the recording fee of \$10 you submitted.

Sincerely,

THOMAS E. SHOOK
Water Rights Specialist

TES:jh

Enclosure

cc: Melvin C. and Virginia K. Hendrickson
Elsie Loveness

*Name chg'd on PC
map to Ken to change*





Farm Credit Services

RECEIVED
DEC 24 1992
WATER RESOURCES DEPT.
SALEM, OREGON

900 Klamath Avenue
P.O. Box 148
Klamath Falls, Oregon 97601
503/882-5551 FAX 503/884-2074

December 22, 1992

Oregon Resources Department
3850 Portland Rd N.E.
Salem, OR 97310

RE: Water Permit Assignment

Dear Sirs:

Enclosed please find an Assignment of a Water Permit from Elsie Loveness to Northwest Farm Credit Services, ACA and Melvin C. & Virginia K. Hendrickson.

We are in the process of making a loan to Mr. & Mrs. Hendrickson and the permit is part of the collateral to secure this loan. We would therefore request copies of all correspondence be sent to both parties. I have enclosed a check in the amount of \$10.00 for this service.

If you should need any further information, please let me know. Thank you for your help and assistance in this matter. MERRY CHRISTMAS

Sincerely,

Margaret John
Operations Assistant

Enc.

STATE OF OREGON
COUNTY OF KLAMATH
PROPOSED CERTIFICATE OF WATER RIGHT

THIS CERTIFICATE ISSUED TO

ELSIE LOVENESS
36121 STASTNY ROAD
MALIN, OREGON 97632

confirms the right to use the waters of A WELL in the LOST RIVER BASIN for IRRIGATING 41.6 ACRES.

This right was perfected under Permit G-9937. The date of priority is NOVEMBER 19, 1982. This right is limited to 0.52 CUBIC FOOT PER SECOND or its equivalent in case of rotation, measured at the well.

The well is located as follows:

SW 1/4 NE 1/4, SECTION 34, T 40 S, R 12 E, W.M.; 1400 FEET SOUTH AND 2370 FEET WEST FROM THE NORTHEAST CORNER OF SECTION 34.

The amount of water used for irrigation together with the amount secured under any other right existing for the same lands, is limited to a diversion of ONE-EIGHTIETH of one cubic foot per second (or its equivalent) and 3.0 acre-feet for each acre irrigated during the irrigation season of each year. PROVIDED FURTHER THAT IN THE EVENT OF A REQUEST FOR A CHANGE IN POINT OF APPROPRIATION, AN ADDITIONAL POINT OF APPROPRIATION OR REPAIR OF THIS WELL, THE QUANTITY OF WATER ALLOWED HEREIN TOGETHER WITH ANY OTHER RIGHT FROM THIS POINT OF APPROPRIATION SHALL NOT EXCEED THE CAPACITY OF THIS WELL AT THE TIME OF PERFECTION OF THIS RIGHT.

The use shall conform to such reasonable rotation system as may be ordered by the proper state officer.

A description of the place of use to which this right is appurtenant is as follows:

NE 1/4 NE 1/4	9.4 ACRES
SW 1/4 NE 1/4	1.6 ACRES
SE 1/4 NE 1/4	30.6 ACRES
SECTION 34	
TOWNSHIP 40 SOUTH, RANGE 12 EAST, W.M.	

The well shall be maintained in accordance with the General Standards for the Construction and Maintenance of Water Wells in Oregon.

The right to use water for the above purpose is restricted to beneficial use on the lands or place of use described.

1
B

RECEIVED

JUN 17 1992

WATER RESOURCES DEPT.
SALEM, OREGON

June 15, 1992

Water Resources Department
3850 Portland Rd NE
Salem, OR 97310

REFERENCE: Application No. G-10804 and Permit No. G-9937

Attention: Jake Szramek

Dear Mr. Szramek

The survey that was done for the above named permit will not work as there is a large piece missing where the pivot irrigation system waters. I thought the survey Del Sparks helped me with in 1982 was fine. If I am indeed short 17.1 acres, I would like to work with you to remedy the problem.

Sincerely,

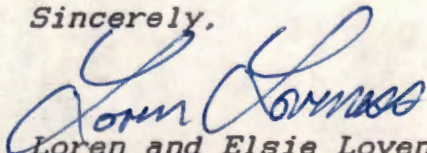

Loren and Elsie Loveness
36121 Stastny Rd.
Malin, OR 97632

T40S. R12E.W.M.

RECEIVED

NOV 19 1982

WATER RESOURCES DEPT.
SALEM, OREGON

RECEIVED
SEP 7 1982
WATER RESOURCES DEPT.
SALEM, OREGON

Application No. G-10804
Permit No. G 9937

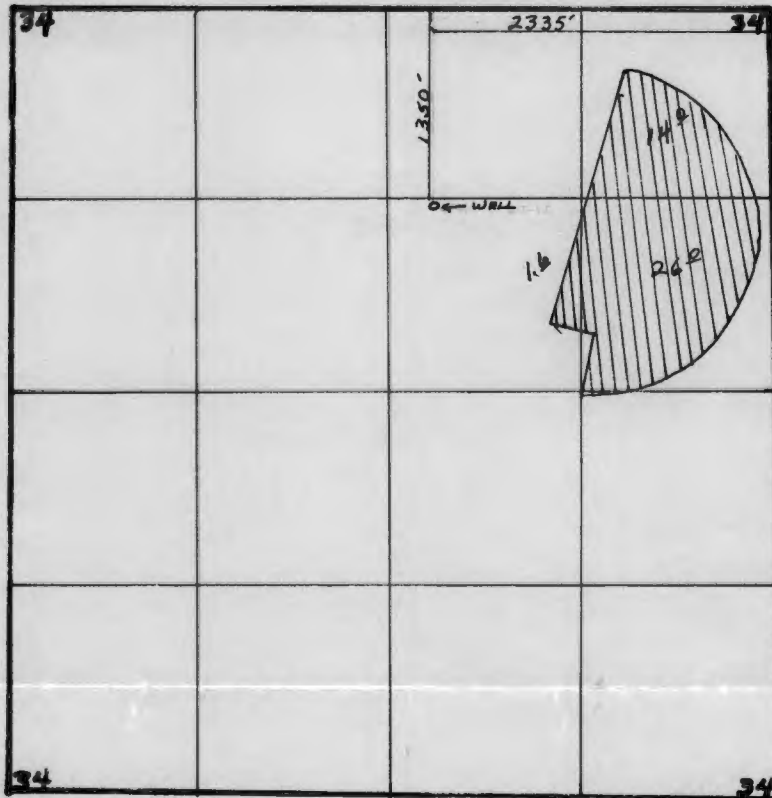

February 5, 1992

Elsie & Loren Loveness
36121 Stastny Road
Malin OR 97632

USER-ID: 8353

WATER
RESOURCES
DEPARTMENT

Dear Mr. & Mrs. Loveness,

With regard to the pump test requirements for the following wells and associated water rights:

POD-ID	Well	Application	Permit	Certificate	Status
18623	A Well	U-393	U-361	23704	Approved
21958	A Well	G-10804	G-9937	0	Exempt
22567	A Well	U-551	U-503	27010	Exempt

The Water Resources Department has reviewed and accepted the pump test results you submitted for POD-ID 18623. The Department requires no further testing of this well at this time. However, you will be required to submit a static water level measurement of the well on the ten-year anniversary of the test you conducted.

The Department has also reviewed your request for exemption for the additional wells listed above based on the results of the tested well. Our review indicates that the tested well and the wells proposed for exemption:

- . are located within a five-mile radius and
- . appear to be completed in the same water-bearing zone.

Therefore, the Department is granting the exemptions. This means that the additional wells need not be tested. This exemption is valid **only if all of the wells are owned by the same landowner.**

We appreciate your cooperation in this program. If you have any questions, please contact Sam Allison or Bill Ferber at the address below or by calling 378-8455.

Sincerely,

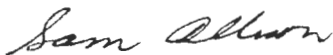

601 FRED LISSNER, Manager
Groundwater/Hydrology Section

cc: Water Rights Section



3850 Portland Rd NE
Salem, OR 97310
(503) 378-3739
FAX (503) 378-8130

TOWNSHIP 40 S. RANGE 12 E. W.M.

SECTION 34

NE				NW				SW				SE				APPLICA- TION NUMBER	PERMIT NUMBER	CERTIFI- CATE NUMBER
NE	NW	SW	SE	NE	NW	SW	SE	NE	NW	SW	SE	NE	NW	SW	SE			
TOTAL ACREAGE IN SUBDIVISION AS SHOWN ON GOVERNMENT PLAT																		
5 ⁶	40	38 ⁴	0 ²	10 ⁸				23 ⁶	32 ²			4 ⁴	40	28 ⁰		U-393	U-361	27304
5 ⁶	40 ⁰	38 ⁴	0 ³	10 ⁸				23 ⁶	32 ²			4 ⁴	40 ⁰	28 ⁰		SUPPL G-819	G-730	32079
																F-4879	G-3104	36540
				0 ¹												F-4879	G-3104	50383
				14 ⁰	9 ⁸	5 ⁶	3 ⁸									F-4879	G-36976	67628
14 ⁰	1 ⁶	26 ⁰														G-10804	G-9937	
												37 ⁴				G-11592	G-10650	67582
																G-12942	G-11518	

(SEE BACK OF CARD FOR PLAT OF SECTION)

December 28, 1982

Elsie Loveness
Star Route, Box 21-A
Malin, OR 97632

G-10804

G-9937



Water Resources Department

MILL CREEK OFFICE PARK

555 13th STREET N.E., SALEM, OREGON 97310

PHONE 378-3066 or
1-800-452-7813
(message line)

November 23, 1982

Elsie Loveness
Star Route, Box 21-A
Malin, OR 97632

Dear Ms. Loveness:

REFERENCE: File G-10804

Thank you for the return of your Application G-10804 now describing the proposed use of 1,300 gallons per minute of water from a well for agricultural irrigation and livestock water.

Ground water applications for stock watering purposes from a well do not require an application for permit from the Water Resources Department.

The beneficial use of ground water for the above exempted purpose constitutes a ground water right equal to that established by a ground water right certificate.

Your Application G-10804 appears in satisfactory form and will be placed with the group to be considered for approval by the issuance of the permit for irrigation use only.

Sincerely,

Stephen C. Brown
Senior Water Rights Examiner

SCB:tw

RECEIVED
NOV 19 1982
WATER RESOURCES DEPT.
SALEM, OREGON

November 18, 1982

Stephen C. Brown
Senior Water Rights Examiner
Water Resources Department
Mill Creek Office Park
555 13th Street N.E.
Salem, OR 97310

Dear Mr. Brown,

I am sorry about the delay in returning my completed application for a permit regarding my water rights. There was a delay in compiling the necessary information for completion of the application.

Enclosed please find my application along with the map.

Sincerely,

EL by
Elsie Loveness
Elsie Loveness
Star Rte. Box 21-A
Malin, OR 97632

EL/tla

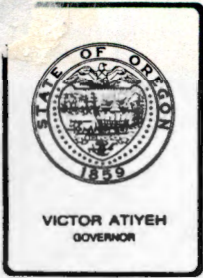

Water Resources Department

MILL CREEK OFFICE PARK

555 13th STREET N.E., SALEM, OREGON 97310

PHONE 378-3066 or
1-800-452-7813
(message line)

November 16, 1982

Elsie Loveness
Star Route, Box 21-A
Malin, OR 97632

Dear Ms. Loveness:

REFERENCE: File G-10804

Your Application G-10804 which was returned to you has not been received. It was endorsed so that in order to retain its priority date, it must have been received in this office on or before November 15, 1982.

Your application has lost its priority, but may be reinstated with a new priority date when it is again received.

Sincerely,

Stephen C. Brown
Senior Water Rights Examiner

SCB:jvm

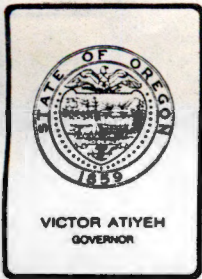

Water Resources Department

MILL CREEK OFFICE PARK

555 13th STREET N.E., SALEM, OREGON 97310

PHONE 378-3066 or
1-800-452-7813
(message line)

September 14, 1982

Elsie Loveness
Star Route, Box 21-A
Malin, OR 97632

Dear Ms. Loveness:

REFERENCE: File G-10804

Your Application G-10804 describing the proposed use of 1,300 gallons per minute of water from a well for agricultural use for 41.6 acres, along with the accompanying map, has been reviewed.

It will be necessary for you to complete Items 1, 4 and 5 describing the requested information regarding the well.

Agricultural use as described in Item 7 does not clearly define your intended use of water. If you intend to use the water for the irrigation of crops, you should enter "irrigation" in Item 7.

I am returning your application and map for correction and completion. Your application is endorsed so that in order to retain its priority date, it must be received in this office on or before November 15, 1982.

Sincerely,

Stephen C. Brown
Senior Water Rights Examiner

SCB:tw
enclosures



Water Resources Department
MILL CREEK OFFICE PARK
555 13th STREET N.E., SALEM, OREGON 97310

PHONE 378-3066
OR
1-800-452-7813
(message line)

September 9, 1982

Elsie Loveness
Star Route, Box 21-A
Malin, OR 97632

Dear Ms. Loveness:

REFERENCE: File G-10804

We have received your application for use of water for irrigation purposes along with supporting data and fees. Our Receipt 32714 is enclosed. Your application has been filed an assigned number G-10804.

Applications which are received in proper form for a permit, including maps, supporting data and fees, will receive a permit shortly after the mandatory 30-day waiting period. Applications which are defective, conflict with existing rights or require additional information will be reviewed in detail and will be returned for completion or correction within 45 days.

If your application is approved, the permit authorizing the project described in the application would be subject to prior rights and require that the well be constructed in accordance with the General Standards for the Construction and Maintenance of Water Wells in Oregon. The permit would also require that a weir, meter, or other suitable measuring device be installed, if required by the Watermaster, and a log be kept recording the amount of ground water withdrawals. If you have any questions regarding these provisions or the Well Standards, please contact this office.

Sincerely,

RALPH H. JACKSON, Supervisor
Application/Permit Section

RHJ:wpc

enclosure

2135B
2502B

COPY



Water Resources Department

Extension Service Building

3328 Vandenberg Rd, Klamath Falls, OR 97601 PHONE 882-2501, Ext. 233
& 883-7111

Application No. G-10804
Permit No.

June 29, 1982

Loren Loveness
Star Rt. Box 21A
Malin, OR 97632

Mr. Loveness,

I have gone over your application and made a few changes and a new map. Please look at it and if you agree with the changes and map, ink all penciled areas and send to Salem with the appropriate fees.

Del Sparks

Del Sparks
Watermaster, Dist. 17

RECEIVED
SEP 7 1982
WATER RESOURCES DEPT.
SALEM, OREGON

Application No. G-10804

Permit No.

STATE OF OREGON WATER RESOURCES DEPARTMENT

Application for a Permit to Appropriate Ground Water

RECEIVED

SEP 7 1982

WATER RESOURCES DEPT. SALEM, OREGON

I, Elsie Lovness (formerly Micka)

(Name of Applicant)

of Star Route Box 21A

(Mailing Address)

Malin

(City)

State of Oregon

97632

(Zip Code)

Phone No. (503) 723 6611

do hereby

make application for a permit to appropriate the following described ground waters of the State of Oregon:

1. The development will consist of irrigation of additional land from existing well

(Give number of wells, tile lines, infiltration galleries, etc.)

having a diameter of 10" and an estimated depth of 290 feet.

2. The well or other source is to be located 1350 ft. N and 2383 ft. W

(N. or S.)

(E. or W.)

from the NE corner of Sec 34

(Public Land Survey Corner)

(If there is more than one well, each must be described)

being within the SW $\frac{1}{4}$ of the NE $\frac{1}{4}$ of

Sec. 34 Tp. 40 S R. 12 E, W. M., in the county of Harney

3. Location of area to be irrigated, or place of use if use other than irrigation.

Township	Range	Section	List $\frac{1}{4}$ $\frac{1}{4}$ of Section	List use and/or number of acres to be irrigated
40 S	12 E	34	NE $\frac{1}{4}$ NE $\frac{1}{4}$	14 acres
40 S	12 E	34	SE $\frac{1}{4}$ NE $\frac{1}{4}$	26 acres
40 S	12 E	34	SW $\frac{1}{4}$ NE $\frac{1}{4}$	1 $\frac{1}{2}$

4. It is estimated that 290 feet of the well will require steel casing.

(Kind)

5. Depth to water table is estimated 255 Well drilled by John Van Meter

(Feet)

6. The amount of water which the applicant intends to apply to beneficial use is cubic feet per second or ...1300... gallons per minute.

7. The use to which the water is to be applied is ... agricultural irrigation and livestock water

8. If the flow to be utilized is artesian, the works to be used for the control and conservation of the supply when not in use must be described. N/A

9. If the location of the well, or other development work is less than one-fourth mile from a natural stream channel, give the distance to the channel and the difference in elevation between the stream bed and the ground surface at the source of development. N/A

10. DESCRIPTION OF WORKS

Include length and dimensions of supply ditch or pipeline, size and type of pump and motor, type of irrigation system to adequately describe the proposed distribution system.

120 HP Turbine well pump

50 HP Booster pump

1/4 mile + 8" PVC main line

1/4 mile + pivot irrigation system

11. Construction work will begin on or before N/A

12. Construction work will be completed on or before now complete

13. The water will be completely applied to the proposed use on or before now

14. If the ground water supply is supplemental to an existing supply, identify the supply and existing water right. water is being pumped from the existing northern well in Sec 34 (see previous page)

Application No. G-10804

Permit No.

Remarks:.....
.....
.....
.....
.....
.....
.....

This permit, when issued, is for the beneficial use of water. By law, the land use associated with this water use must be in compliance with statewide land-use goals and any local acknowledged land-use plan. It is possible that the land use you propose may not be allowed if it is not in keeping with the goals and the acknowledged plan. Your city or county planning agency can advise you about the land-use plan in your area.

Steve Lorenson
Signature of Applicant

This is to certify that I have examined the foregoing application, together with the accompanying maps and data, and return the same for..... correction and completion.....

In order to retain its priority, this application must be returned to the Water Resources Director with corrections on or before..... November 15....., 19 82.....

WITNESS my hand this 14th day of September, 19 82

James E. Sexson Water Resources Director

By *Stephen C. Brown*
Stephen C. Brown

RECEIVED
NOV 19 1982
WATER RESOURCES DEPT.
SALEM, OREGON

This instrument was first received in the office of the Water Resources Director at Salem, Oregon, on the 7th day of September, 19 82, at 8:15 o'clock A.M.

Application No. G-10804 Permit No.

PC
NCR

Permit to Appropriate the Public Waters of the State of Oregon

This is to certify that I have examined the foregoing application and do hereby grant the same, SUBJECT TO EXISTING RIGHTS INCLUDING THE EXISTING MINIMUM FLOW POLICIES ESTABLISHED BY THE WATER POLICY REVIEW BOARD and the following limitations and conditions:

The right herein granted is limited to the amount of water which can be applied to beneficial use and shall not exceed 0.52 cubic feet per second measured at the point of diversion from the well or source of appropriation, or its equivalent in case of rotation with other water users, from one

well

The use to which this water is to be applied is irrigation

If for irrigation, this appropriation shall be limited to 180 of one cubic foot per second or its equivalent for each acre irrigated and shall be further limited to a diversion of not to exceed 3 acre feet per acre for each acre irrigated during the irrigation season of each year;

and shall be further limited to a diversion of not to exceed 2.0 acre-feet per acre for each acre irrigated during the irrigation season of each year, provided further that in the event of a request for a change in point of appropriation, an additional point of appropriation or repair of this well, the quantity of water allowed herein together with any other right from this point of appropriation shall not exceed the capacity of this well at the time of perfection of this right, and shall conform to such reasonable rotation system as may be ordered by the proper state officer.

and shall be subject to such reasonable rotation system as may be ordered by the proper state officer.

The well shall be constructed in accordance with the General Standards for the Construction and Maintenance of Water Wells in Oregon.

The works constructed shall include an air line and pressure gauge or an access port for measuring line, adequate to determine water level elevation in the well at all times.

The permittee shall install and maintain a weir, meter, or other suitable measuring device, and shall keep a complete record of the amount of ground water withdrawn.

The priority date of this permit is November 19, 1982

Actual construction work shall begin on or before and shall thereafter be prosecuted with reasonable diligence and be completed on or before October 1, 1982

Complete application of the water to the proposed use shall be made on or before October 1, 1982

WITNESS my hand this day of....., 19.....

PAK S

STATE OF OREGON
COUNTY OF KLAMATH
PROPOSED CERTIFICATE OF WATER RIGHT

*Review
or
use
new
map*

THIS CERTIFICATE ISSUED TO

ELSIE LOVENESS
36121 STASTNY ROAD
MALIN, OREGON 97632

confirms the right to use the waters of A WELL in the LOST RIVER BASIN for IRRIGATING 41.6 ACRES.

This right was perfected under Permit G-9937. The date of priority is NOVEMBER 19, 1982. This right is limited to 0.52 CUBIC FOOT PER SECOND or its equivalent in case of rotation, measured at the well.

The well is located as follows:

SW 1/4 NE 1/4, SECTION 34, T 40 S, R 12 E, W.M.; 1400 FEET SOUTH AND 2370 FEET WEST FROM THE NORTHEAST CORNER OF SECTION 34.

The amount of water used for irrigation together with the amount secured under any other right existing for the same lands, is limited to a diversion of ONE-EIGHTIETH of one cubic foot per second (or its equivalent) and 3.0 acre-feet for each acre irrigated during the irrigation season of each year.

~~provided further that in the event of a request for a change in point of appropriation, an additional additional point of appropriation or repair of this well, the quantity of water allowed herein together with any other right from this may be point of appropriation shall not exceed the capacity of this well at the time of perfection of his right, and shall conform to such reasonable rotation system as may be ordered by the proper state officer.~~ Location of the place of use to which this right is appurtenant is as follows:

NE 1/4 NE 1/4	9.4 ACRES	✓
SW 1/4 NE 1/4	1.6 ACRES	✓
SE 1/4 NE 1/4	30.6 ACRES	✓

SECTION 34
TOWNSHIP 40 SOUTH, RANGE 12 EAST, W.M.

The well shall be maintained in accordance with the General Standards for the Construction and Maintenance of Water Wells in Oregon.

The right to use water for the above purpose is restricted to beneficial use on the lands or place of use described.

STATE OF OREGON
COUNTY OF KLAMATH
PROPOSED CERTIFICATE OF WATER RIGHT

THIS CERTIFICATE ISSUED TO

ELSIE LOVENESS
36121 STASTNY ROAD
MALIN, OREGON 97632

confirms the right to use the waters of A WELL in the LOST RIVER BASIN for IRRIGATING 41.6 ACRES.

This right was perfected under Permit G-9937. The date of priority is NOVEMBER 19, 1982. This right is limited to 0.52 CUBIC FOOT PER SECOND or its equivalent in case of rotation, measured at the well.

The well is located as follows:

SW 1/4 NE 1/4, SECTION 34, T 40 S, R 12 E, W.M.; 1400 FEET SOUTH AND 2370 FEET WEST FROM THE NORTHEAST CORNER OF SECTION 34.

The amount of water used for irrigation together with the amount secured under any other right existing for the same lands, is limited to a diversion of ONE-EIGHTIETH of one cubic foot per second (or its equivalent) and 3.0 acre-feet for each acre irrigated during the irrigation season of each year.

The use shall conform to such reasonable rotation system as may be ordered by the proper state officer.

A description of the place of use to which this right is appurtenant is as follows:

NE 1/4 NE 1/4	19.8 ACRES
SW 1/4 NE 1/4	1.6 ACRES
SE 1/4 NE 1/4	20.2 ACRES
SECTION 34	
TOWNSHIP 40 SOUTH, RANGE 12 EAST, W.M.	

Maintain
The well shall be ^{MAINTAINED} constructed in accordance with the General Standards for the Construction and Maintenance of Water Wells in Oregon.

The works constructed shall include an air line and pressure gauge or an access port for measuring line, adequate to determine water level elevation in the well at all times.

The ~~permittee~~ shall install and maintain a weir, meter, or other suitable measuring device, and shall keep a complete record of the amount of ground water withdrawn.