

Application for a Permit to Store Water in a Reservoir (Alternate Review) Application in the Name of Port of Portland

RECEIVED

Multnomah County

Township 1 North, Range 3 East (W.M.)

JUN 11 2021

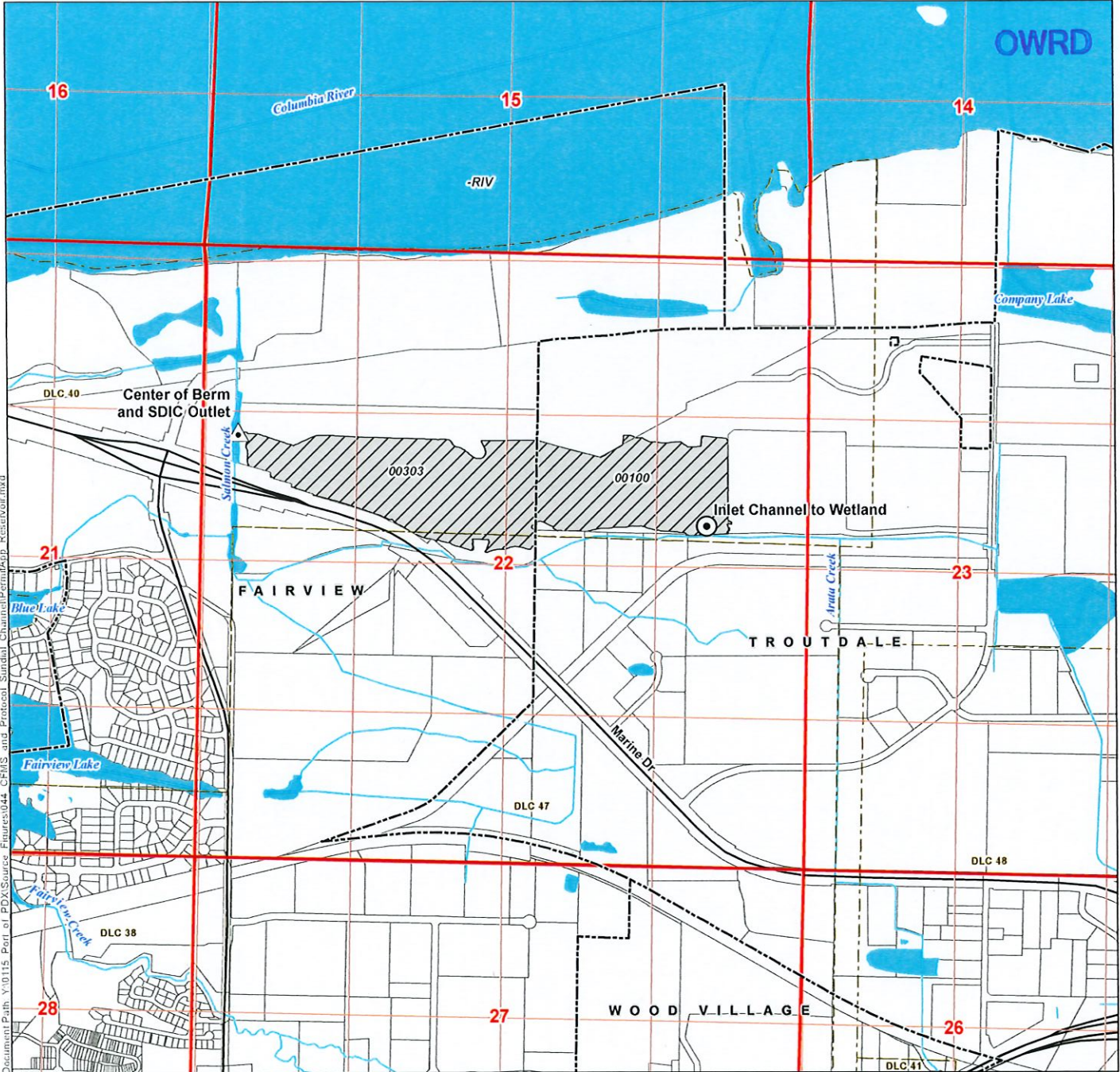

LEGEND

- ▲ Center of Berm and SDIC Outlet
- Inlet Channel to Wetland
- ▨ Place of Use (POU)
- Government Lot (GL)
- Donation Land Claim (DLC)
- City Boundary
- ⊕ Tax Lot
- Major Road
- ~ Watercourse
- Waterbody

DISCLAIMER

This map was prepared for the purpose of identifying the location of a water right only and it is not intended to provide legal dimensions or location of property ownership lines.

MAP NOTES

Date: December 16, 2020
Data Sources: USGS, BLM, METRO, ESRI

LOCATION DESCRIPTION

Center of Berm and SDIC Outlet
Located 1,610 feet South and 325 feet East from the NW corner of Section 22, Township 1 North, Range 3 East (W.M.)

Inlet Channel to Wetland
Located 2,440 feet South and 840 feet West from the NE corner of Section 22, Township 1 North, Range 3 East (W.M.)

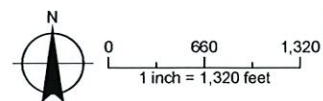

Document Path: Y:\0115_Permit\Port of Portland\Sundial_Channel\PermitApp_Reservoir.mxd

PLAN VIEW

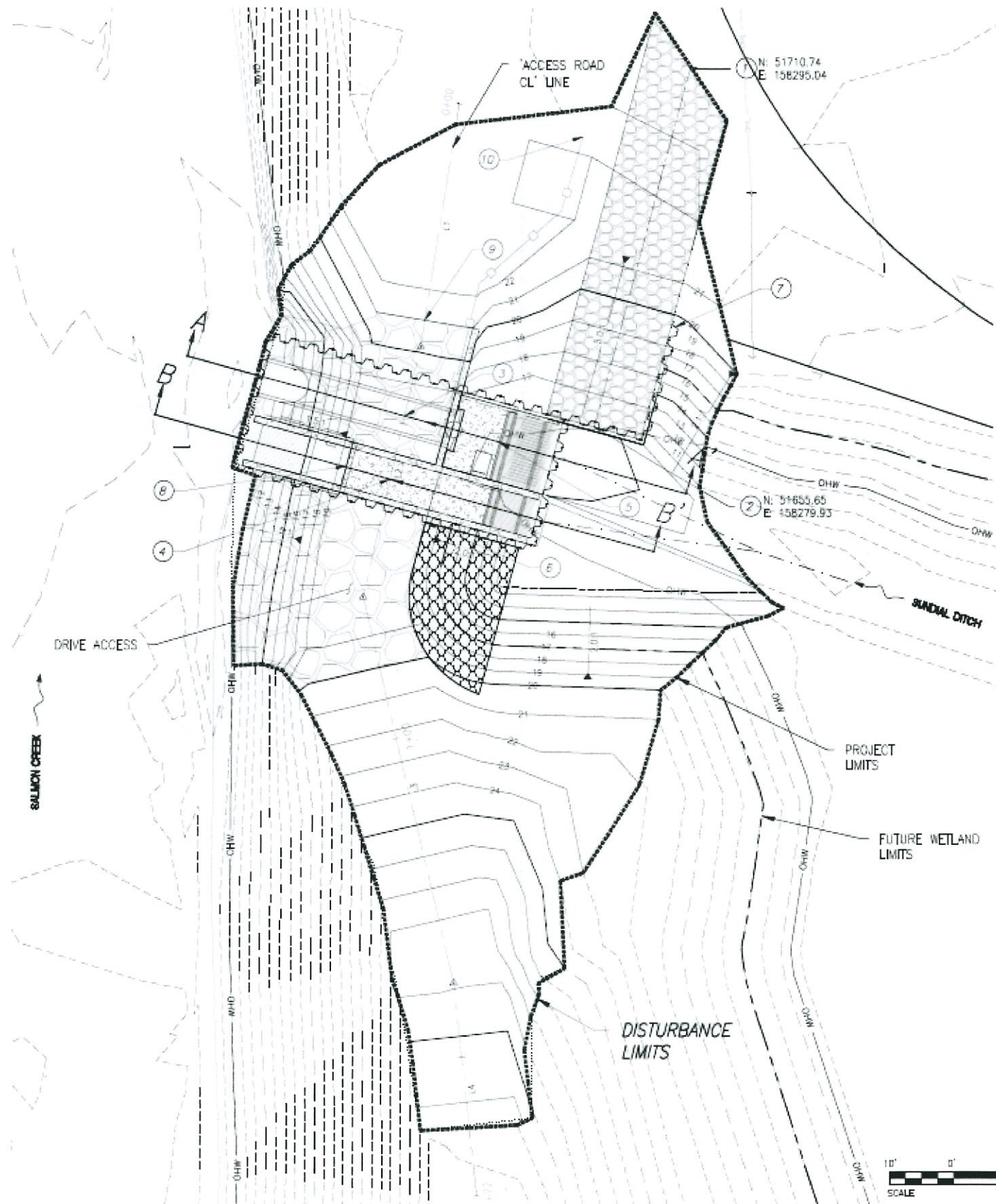

CROSS-SECTION VIEWS

