

Name J.W. McCallister & Jett C. Blackburn

By \_\_\_\_\_

Address 771 Ponderosa Village

Burns, OR 97720

Date filed April 19, 1982

Priority April 19, 1982

Action suspended until 6/20/94 95

Return to applicant \_\_\_\_\_

Date of approval OCT 20 1982

**CONSTRUCTION**

Date for beginning OCT 20 1983

Date for completion OCT 1 1984

Extended to \_\_\_\_\_

Date for application of water OCT 1 1985

Extended to \_\_\_\_\_

**PROSECUTION OF WORK**

Form "A" filed STARTED

Form "B" filed October 29, 1984

Form "C" filed October 29, 1984

**FINAL PROOF**

Blank mailed \_\_\_\_\_

Proof received \_\_\_\_\_

Date certificate issued 10/6/2006

Application No. G **G10688**

Permit No. G **G 9879**

Certificate No. **82391** 82391

Stream Index, Page No. **12-42**

**FEES PAID**

Date	Amount	Receipt No.
4-19-82	410.00	30370
Cert. Fee		
<b>FEES REFUNDED</b>		
Date	Amount	Check No.

**ASSIGNMENTS**

Date	To Whom	Address	Volume	Page

**REMARKS**

notify GW  
CARD FOR B OCT 17 1984

Form C (690-9-77)

**IMPORTANT**—This form is a notice to the Water Resources Director that permittee is ready to make **final proof** to the extent to which the water has actually been applied to the intended use under the terms of the permit. Permittee is cautioned that Certificate of Water Right will be issued based on the extent of the quantity and use as determined by the **final proof** inspection and survey which will be made in response to the filing of this Form C.

**NOTE:** In the case of an irrigation permit, this Form C should not be mailed to the Water Resources Department until all of the land described in the permit, which it is intended to irrigate under this permit at any time, has actually been irrigated.

Fill out, detach and mail to the Water Resources Department, Salem, OR 97310, when all of the water has been applied.

Application No. G 10688

**NOTICE OF COMPLETE APPLICATION OF WATER TO A BENEFICIAL USE**

I, Jett C. Blackburn, the holder of Permit No. G 9879

to appropriate the public waters of the state of Oregon, completely applied the waters to a beneficial use in accordance with the terms of said permit, on the 15 day of July, 1984.

Remarks: \_\_\_\_\_

IN WITNESS WHEREOF, I have hereunto set my hand this 26 day of Nov, 1984.

Jett C. Blackburn  
(Signature of Applicant)

771 Penderosa Vill. Burns, Ore  
(Address)

Form B (690-9-77)

Application No. G 10688

**NOTICE OF COMPLETION OF CONSTRUCTION**

I, Jett C. Blackburn, the holder of Permit No. G 9879

to appropriate the public waters of the state of Oregon, completed the construction of the works described therein on the 15 day of Nov, 1982.

Remarks: \_\_\_\_\_

If the works have less capacity than described in the permit, or you have definitely abandoned part of the proposed development, you should so state in order that our records may not be unnecessarily encumbered.

IN WITNESS WHEREOF, I have hereunto set my hand this 26 day of Nov, 1984.

Jett C. Blackburn  
(Signature of Applicant)

771 Penderosa Vill. Burns  
(Address)

Fill out, detach and mail to the Water Resources Department, Salem, OR 97310, when construction work is completed. OK

WATER RESOURCES DEPT. SALEM, OREGON

WATER RESOURCES DEPT. SALEM, OREGON

OK

OK

NOV 29 1984



# Oregon

Kate Brown, Governor

**Water Resources Department**  
725 Summer St NE, Suite A  
Salem, OR 97301  
(503) 986-0900  
Fax (503) 986-0904

September 21, 2018

TRAVIS AND KELLY SINGHOSE  
29327 WEAVER SPRINGS LANE  
BURNS OR 97720

SUBJECT: Water Right Transfer Application T-12819

Please find enclosed the Preliminary Determination indicating that, based on the information available, the Department intends to approve application T-12819. This document is an intermediate step in the approval process; water may not be used legally as proposed in the transfer application until a Final Order has been issued by the Department. Please read this entire letter carefully to determine your responsibility for additional action.

A public notice is being published in the Department's weekly publication and in the Burns Times Herald newspaper, simultaneously with issuance of the Preliminary Determination. The notice initiates a period in which any person may file either a protest opposing the decision proposed by the Department in the Preliminary Determination or a standing statement supporting the Department's decision. The protest period will end 30 days after the last date of newspaper publication.

If no protest is filed, the Department will issue a Final Order consistent with the Preliminary Determination. You should receive a copy of the Final Order about 30 days after the close of the protest period.

If a protest is filed, the application may be referred to a contested case proceeding. A contested case provides an opportunity for the proponents and opponents of the decision proposed in the Preliminary Determination to present information and arguments supporting their position in a quasi-judicial proceeding.

Please do not hesitate to contact me at 503-986-0886 or [Patrick.K.Starnes@oregon.gov](mailto:Patrick.K.Starnes@oregon.gov) if I may be of assistance.

Sincerely,

Kelly Starnes  
Transfer Program Analyst  
Transfer and Conservation Section

cc: Transfer Application file T-12819  
J.R. Johnson, Watermaster, District 10 (via e-mail)  
John A. Short, Agent for the applicant (via e-mail)

encs

**BEFORE THE WATER RESOURCES DEPARTMENT  
OF THE  
STATE OF OREGON**

In the Matter of Transfer Application	)	PRELIMINARY DETERMINATION
T-12819, Harney County	)	PROPOSING APPROVAL OF
	)	ADDITIONAL POINTS OF
	)	APPROPRIATION AND A CHANGE IN
	)	PLACE OF USE

**Authority**

Oregon Revised Statutes (ORS) 537.705 and 540.505 to 540.580 establish the process in which a water right holder may submit a request to transfer the point of appropriation, place of use, or character of use authorized under an existing water right. Oregon Administrative Rules (OAR) Chapter 690, Division 380 implement the statutes and provides the Department's procedures and criteria for evaluating transfer applications.

**Applicant**

TRAVIS AND KELLY SINGHOSE  
29327 WEAVER SPRINGS LANE  
BURNS, OR 97720

**Findings of Fact**

1. On January 4, 2018, TRAVIS AND KELLY SINGHOSE filed an application for additional points of appropriation and to change the place of use under Certificates 55574 and 82391. The Department assigned the application number T-12819.
2. Notice of the application for transfer was published on January 16, 2018, pursuant to OAR 690-380-4000. No comments were filed in response to the notice.
3. On July 31, 2018, the Department sent a copy of the draft Preliminary Determination proposing to approve Transfer Application T-12819 to the applicants. The draft Preliminary Determination cover letter set forth a deadline of August 31, 2018 for the applicants to respond. The applicants requested the completion date be extended to October 1, 2023 and for the Department proceed with issuance of a Preliminary Determination and provided the necessary information to demonstrate that the applicant is authorized to pursue the transfer.

Pursuant to OAR 690-380-4030, any person may file a protest or standing statement within 30 days after the last date of publication of notice of this preliminary determination.
--

4. The first right to be transferred is as follows:

**Certificate:** 55574 in the name of THOMAS C. CLEMENS (perfected under Permit G-6961)  
**Use:** IRRIGATION OF 120.0 ACRES  
**Priority Date:** AUGUST 12, 1976  
**Rate:** 1.5 CUBIC FEET PER SECOND  
**Limit/Duty:** The amount of water used for irrigation, together with the amount secured under any other right existing for the same lands, shall be limited to ONE-EIGHTIETH of one cubic foot per second per acre, or its equivalent for each acre irrigated, and shall be further limited to a diversion of not to exceed 3.0 acre-feet per acre for each acre irrigated during the irrigation season of each year.  
**Source:** A WELL within the MALHEUR LAKE BASIN

**Authorized Point of Appropriation:**

Twp	Rng	Mer	Sec	Q-Q	Measured Distances
25 S	31 E	WM	16	NW NE	WELL 5 - 1300 FEET SOUTH AND 2050 FEET WEST FROM THE NE CORNER OF SECTION 16

**Authorized Place of Use:**

IRRIGATION					
Twp	Rng	Mer	Sec	Q-Q	Acres
25 S	31 E	WM	16	NE NE	40.0
25 S	31 E	WM	16	NW NE	40.0
25 S	31 E	WM	16	NE NW	40.0
Total					120.0

5. Transfer Application T-12819 proposes additional points of appropriation listed in the table below with the approximate distances from the authorized point of appropriation to:

Twp	Rng	Mer	Sec	Q-Q	Measured Distances	Distance in Miles from the authorized POD - Well #5
25 S	31 E	WM	15	NW NW	ROBEY WELL 1 - 1300 FEET NORTH AND 1320 FEET WEST FROM THE CENTER CORNER OF SECTION 15	0.65 mi
25 S	31 E	WM	15	SW NE	ROBEY WELL 2 - 1350 FEET NORTH AND 1320 FEET EAST FROM THE CENTER CORNER OF SECTION 15	1.15 mi
25 S	31 E	WM	9	SE NE	WELL 1 - 4020 FEET NORTH AND 430 FEET WEST FROM THE SE CORNER OF SECTION 9	1.07 mi
25 S	31 E	WM	9	NE SW	WELL 2 - 20 FEET SOUTH FROM THE CENTER CORNER OF SECTION 9	0.74 mi
25 S	31 E	WM	9	SE SE	WELL 3 - 1370 FEET NORTH AND 1270 FEET WEST FROM THE SE CORNER OF SECTION 9	0.53 mi
25 S	31 E	WM	10	NW SW	WELL 4 - 1400 FEET NORTH AND 620 FEET EAST FROM THE SE CORNER OF SECTION 9	0.72 mi

Twp	Rng	Mer	Sec	Q-Q	Measured Distances	Distance in Miles from the authorized POD – Well #5
25 S	31 E	WM	10	SE SW	WELL 6 - 110 FEET NORTH AND 1380 FEET EAST FROM THE SE CORNER OF SECTION 9	0.70 mi
25 S	31 E	WM	9	SE SW	WELL 10 - 50 FEET SOUTH AND 2650 FEET WEST FROM THE SE CORNER OF SECTION 9	0.26 mi
25 S	31 E	WM	9	SE SW	WELL 11 - 1240 FEET NORTH AND 2780 FEET WEST FROM THE SE CORNER OF SECTION 9	0.50 mi
25 S	31 E	WM	9	SE SE	WELL 12 - 1170 FEET NORTH AND 210 FEET WEST FROM THE SE CORNER OF SECTION 9	0.58 mi
25 S	31 E	WM	10	SW SW	WELL 13 - 1160 FEET NORTH AND 60 FEET EAST FROM THE SE CORNER OF SECTION 9	0.61 mi
25 S	31 E	WM	9	NE SE	WELL 14 - 1500 FEET NORTH AND 260 FEET WEST FROM THE SE CORNER OF SECTION 9	0.63 mi
25 S	31 E	WM	9	SE NE	WELL 15 - 2710 FEET NORTH AND 1310 FEET WEST FROM THE SE CORNER OF SECTION 9	0.77 mi
25 S	31 E	WM	10	SW SW	WELL 16 - 1340 FEET NORTH AND 1220 FEET EAST FROM THE SE CORNER OF SECTION 9	0.70 mi
25 S	31 E	WM	16	NE NE	WELL A - 130 FEET SOUTH AND 330 FEET WEST FROM THE SE CORNER OF SECTION 9	0.39 mi
25 S	31 E	WM	16	NW NE	WELL B - 460 FEET SOUTH AND 2070 FEET WEST FROM THE SE CORNER OF SECTION 9	0.16 mi
25 S	31 E	WM	15	NW NW	WELL C - 600 FEET SOUTH AND 50 FEET EAST FROM THE SE CORNER OF SECTION 9	0.42 mi
25 S	31 E	WM	15	SW NW	WELL D - 1320 FEET SOUTH AND 100 FEET EAST FROM THE SE CORNER OF SECTION 9	0.40 mi

6. Transfer Application T-12819 also proposes to change the place of use of the right to:

IRRIGATION					
Twp	Rng	Mer	Sec	Q-Q	Acres
25 S	31 E	WM	16	NE NE	22.1
25 S	31 E	WM	16	NW NE	29.8
25 S	31 E	WM	16	SW NE	16.7
25 S	31 E	WM	16	NE NW	16.3
25 S	31 E	WM	16	SE NW	35.1
Total					120.0

7. The second right to be transferred is as follows:

**Certificate:** 82391 in the name of J. W. MCCALLISTER AND JETT C. BLACKBURN  
(perfected under Permit G-9879)  
**Use:** IRRIGATION OF 343.0 ACRES  
**Priority Date:** APRIL 19, 1982  
**Rate:** 4.29 CUBIC FEET PER SECOND  
**Limit/Duty:** The amount of water used for irrigation, together with the amount secured under any other right existing for the same lands, is limited to ONE-EIGHTIETH of one cubic foot per second and 3.0 acre-feet for each acre irrigated during the irrigation season of each year.  
**Source:** WELLS 1, 3, and 4 within the MALHEUR LAKE BASIN

**Authorized Points of Appropriation:**

Twp	Rng	Mer	Sec	Q-Q	Measured Distances
25 S	31 E	WM	9	SE NE	WELL 1 - 4100 FEET NORTH AND 340 FEET WEST FROM THE SE CORNER OF SECTION 9
25 S	31 E	WM	9	SE SE	WELL 3 - 1370 FEET NORTH AND 1270 FEET WEST FROM THE SE CORNER OF SECTION 9
25 S	31 E	WM	10	NW SW	WELL 4 - 1400 FEET NORTH AND 620 FEET EAST FROM THE SW CORNER OF SECTION 9

**Authorized Place of Use:**

IRRIGATION					
Twp	Rng	Mer	Sec	Q-Q	Acres
25 S	31 E	WM	9	SW NE	31.6
25 S	31 E	WM	9	SE NE	41.2
25 S	31 E	WM	9	SW NW	1.4
25 S	31 E	WM	9	SE NW	35.6
25 S	31 E	WM	9	NE SW	35.2
25 S	31 E	WM	9	NW SW	1.4
25 S	31 E	WM	9	NE SE	41.1
25 S	31 E	WM	9	NW SE	32.0
25 S	31 E	WM	9	SE SE	41.2
25 S	31 E	WM	10	NW SW	41.1
25 S	31 E	WM	10	SW SW	41.2
Total					343.0

8. Transfer Application T-12819 proposes additional points of appropriation listed in the table below with the approximate distances from the existing points of appropriation to:

Twp	Rng	Mer	Sec	Q-Q	Measured Distances	Distance from the authorized well locations measured in miles (mi)		
						Well 1	Well 3	Well 4
25 S	31 E	WM	15	NW NW	ROBEY WELL 1 - 1300 FEET NORTH AND 1320 FEET WEST FROM THE CENTER CORNER OF SECTION 15	1.05	0.70	0.52
25 S	31 E	WM	15	SW NE	ROBEY WELL 2 - 1350 FEET NORTH AND 1320 FEET EAST FROM THE CENTER CORNER OF SECTION 15	1.30	1.12	0.81

Twp	Rng	Mer	Sec	Q-Q	Measured Distances	Distance from the authorized well locations measured in miles (mi)		
						Well 1	Well 3	Well 4
25 S	31 E	WM	9	NE SW	WELL 2 - 20 FEET SOUTH FROM THE CENTER CORNER OF SECTION 9	0.53	0.35	0.66
25 S	31 E	WM	16	NW NE	WELL 5 - 1300 FEET SOUTH AND 2050 FEET WEST FROM THE SE CORNER OF SECTION 9	1.07	0.52	0.71
25 S	31 E	WM	10	SE SW	WELL 6 - 110 FEET NORTH AND 1380 FEET EAST FROM THE SE CORNER OF SECTION 9	0.82	0.55	0.28
25 S	31 E	WM	9	SE SW	WELL 10 - 50 FEET SOUTH AND 2650 FEET WEST FROM THE SE CORNER OF SECTION 9	0.90	0.37	0.68
25 S	31 E	WM	9	SE SW	WELL 11 - 1240 FEET NORTH AND 2780 FEET WEST FROM THE SE CORNER OF SECTION 9	0.71	0.28	0.65
25 S	31 E	WM	9	SE SE	WELL 12 - 1170 FEET NORTH AND 210 FEET WEST FROM THE SE CORNER OF SECTION 9	0.55	0.20	0.16
25 S	31 E	WM	10	SW SW	WELL 13 - 1160 FEET NORTH AND 60 FEET EAST FROM THE SE CORNER OF SECTION 9	0.56	0.26	0.11
25 S	31 E	WM	9	NE SE	WELL 14 - 1500 FEET NORTH AND 260 FEET WEST FROM THE SE CORNER OF SECTION 9	0.49	0.19	0.17
25 S	31 E	WM	9	SE NE	WELL 15 - 2710 FEET NORTH AND 1310 FEET WEST FROM THE SE CORNER OF SECTION 9	0.32	0.25	0.44
25 S	31 E	WM	10	SW SW	WELL 16 - 1340 FEET NORTH AND 1220 FEET EAST FROM THE SE CORNER OF SECTION 9	0.60	0.48	0.13
25 S	31 E	WM	16	NE NE	WELL A - 130 FEET SOUTH AND 330 FEET WEST FROM THE SE CORNER OF SECTION 9	0.80	0.34	0.34
25 S	31 E	WM	16	NW NE	WELL B - 460 FEET SOUTH AND 2070 FEET WEST FROM THE SE CORNER OF SECTION 9	0.92	0.38	0.62
25 S	31 E	WM	15	NW NW	WELL C - 600 FEET SOUTH AND 50 FEET EAST FROM THE SE CORNER OF SECTION 9	0.89	0.45	0.4
25 S	31 E	WM	15	SW NW	WELL D - 1320 FEET SOUTH AND 100 FEET EAST FROM THE SE CORNER OF SECTION 9	1.02	0.57	0.52



9. Transfer Application T-12819 also proposes to change the place of use of the right to:

IRRIGATION					
Twp	Rng	Mer	Sec	Q-Q	Acres
25 S	31 E	WM	9	SW NE	31.3
25 S	31 E	WM	9	SE NE	31.4
25 S	31 E	WM	9	SE NW	31.5
25 S	31 E	WM	9	NE SW	31.3
25 S	31 E	WM	9	SE SW	30.2
25 S	31 E	WM	9	NE SE	31.4
25 S	31 E	WM	9	NW SE	31.5
25 S	31 E	WM	9	SW SE	30.2
25 S	31 E	WM	9	SE SE	31.4
25 S	31 E	WM	10	NW SW	31.4
25 S	31 E	WM	10	SW SW	31.4
Total					343.0

**Transfer Review Criteria (OAR 690-380-4010)**

- 10. Water has been used within the last five years according to the terms and conditions of the rights. There is no information in the record that would demonstrate that the rights are subject to forfeiture under ORS 540.610.
- 11. A pump, pipeline, and sprinkler system sufficient to use the full amount of water allowed under the existing rights were present within the five-year period prior to submittal of Transfer Application T-12819.
- 12. The proposed changes would not result in enlargement of the rights.
- 13. The proposed changes would not result in injury to other water rights.
- 14. All other application requirements are met.

**Determination and Proposed Action**

The additional points of appropriation and change in place of use proposed in Transfer Application T-12819 appear to be consistent with the requirements of ORS 537.705 and 540.505 to 540.580 and OAR 690-380-5000. If protests are not filed pursuant to OAR 690-380-4030, the application will be approved.

*If Transfer Application T-12819 is approved, the final order will include the following:*

- 1. *The additional points of appropriation and change in place of use proposed in Transfer Application T-12819 are approved.*
- 2. *The right to the use of the water is restricted to beneficial use at the place of use described, and is subject to all other conditions and limitations contained in Certificates 55574 and 82391 and any related decree.*
- 3. *Water right Certificates 55571 and 82391 are cancelled.*

4. *The quantity of water diverted at the additional points of appropriation, together with that diverted at the original points of appropriation, shall not exceed the quantity of water lawfully available at the original points of appropriation.*
5. *Water use measurement conditions:*
  - a. *Before water use may begin under this order, the water user shall install a totalizing flow meter, or, with prior approval of the Director, another suitable measuring device at each point of appropriation (new and existing).*
  - b. *The water user shall maintain the meters or measuring devices in good working order.*
  - c. *The water user shall allow the Watermaster access to the meters or measuring devices; provided however, where the meters or measuring devices are located within a private structure, the Watermaster shall request access upon reasonable notice.*
6. *Water shall be acquired from the same aquifer (water source) as the original points of appropriation.*
7. *The former place of use of the transferred right shall no longer receive water under the right.*
8. *Full beneficial use of the water shall be made, consistent with the terms of this order, on or before **October 1, 2019**. A Claim of Beneficial Use prepared by a Certified Water Right Examiner shall be submitted by the applicant to the Department within one year after the deadline for completion of the changes and full beneficial use of the water.*

9. *After satisfactory proof of beneficial use is received, new certificates confirming the rights transferred will be issued.*

Dated at Salem, Oregon this SEP 27 2018,



Dwight French, Water Right Services Administrator, for  
Thomas M. Byler, Director  
Oregon Water Resources Department

This Preliminary Determination was prepared by Marcy Osborn. If you have questions about the information in this document, you may reach me at 541-523-8224 ext.228 or [marcy.j.osborn@oregon.gov](mailto:marcy.j.osborn@oregon.gov).

*Protests should be addressed to the attention of Water Rights Services Division, Water Resources Department, 725 Summer St. NE, Suite A, Salem, OR 97301-1266.*

**Notice Regarding Service Members:** Active duty service members have a right to stay proceedings under the federal Service Members Civil Relief Act. 50 U.S.C. App. §§501-597b. You may contact the Oregon State Bar or the Oregon Military Department for more information. The toll-free telephone number for the Oregon State Bar is: 1 (800) 452-8260. The toll-free telephone number of the Oregon Military Department is: 1 (800) 452-7500. The Internet address for the United States Armed Forces Legal Assistance Legal Services Locator website is: <http://legalassistance.law.af.mil>



# Oregon

Kate Brown, Governor

November 27, 2018

Water Resources Department  
North Mall Office Building  
725 Summer St NE, Suite A  
Salem, OR 97301  
Phone (503) 986-0900  
Fax (503) 986-0904  
[www.Oregon.gov/OWRD](http://www.Oregon.gov/OWRD)

TRAVIS AND KELLY SINGHOSE  
29327 WEAVER SPRINGS LANE  
BURNS, OR 97720

REFERENCE: Transfer Application T-12819

Enclosed is a copy of the final order approving your water right transfer application.

The time allowed to complete the transfer is specified in the final order. **YOU SHOULD GIVE PARTICULAR ATTENTION TO THE TIME LIMIT.** The water right for any portion of the authorized change in character of use or change in place of use **NOT** carried out within the time allowed will be lost.

An extension of the time limit can be allowed only upon a showing that diligent effort has been made to complete the actual change(s) within the time allowed.

You are required to hire a Certified Water Rights Examiner (CWRE) to complete a Claim of Beneficial Use report and map which must be submitted to this Department within one year of the date you complete the change(s) or within one year of the completion date authorized in the transfer final order, whichever occurs first.

If you have any questions related to the approval of this transfer, you may contact your caseworker, Kelly Starnes, by telephone at (503) 986-0886 or by e-mail at [Patrick.K.Starnes@oregon.gov](mailto:Patrick.K.Starnes@oregon.gov).

Sincerely,

Stacy H. Phillips  
Water Right Services Support  
Transfers and Conservation Section

cc: J R. Johnson, Watermaster Dist. #10 (via email)  
John A. Short, Agent  
Harney County

Enclosure

**BEFORE THE WATER RESOURCES DEPARTMENT  
OF THE  
STATE OF OREGON**

In the Matter of Transfer Application            )     FINAL ORDER  
T-12819, Harney County                         )     APPROVING ADDITIONAL POINTS  
  )     OF APPROPRIATION AND A  
  )     CHANGE IN PLACE OF USE

**Authority**

Oregon Revised Statutes (ORS) 537.705 and 540.505 to 540.580 establish the process in which a water right holder may submit a request to transfer the point of appropriation, place of use, or character of use authorized under an existing water right. Oregon Administrative Rules (OAR) Chapter 690, Division 380 implement the statutes and provides the Department’s procedures and criteria for evaluating transfer applications.

**Applicant**

TRAVIS AND KELLY SINGHOSE  
29327 WEAVER SPRINGS LANE  
BURNS, OR 97720

**Findings of Fact**

1. On January 4, 2018, TRAVIS AND KELLY SINGHOSE filed an application for additional points of appropriation and to change the place of use under Certificates 55574 and 82391. The Department assigned the application number T-12819.
2. Notice of the application for transfer was published on January 16, 2018, pursuant to OAR 690-380-4000. No comments were filed in response to the notice.
3. On July 31, 2018, the Department sent a copy of the draft Preliminary Determination proposing to approve Transfer Application T-12819 to the applicants. The draft Preliminary Determination cover letter set forth a deadline of August 31, 2018 for the applicants to respond. The applicants requested the completion date be extended to October 1, 2023 and for the Department proceed with issuance of a Preliminary Determination and provided the necessary information to demonstrate that the applicant is authorized to pursue the transfer.

This final order is subject to judicial review by the Court of Appeals under ORS 183.482. Any petition for judicial review must be filed within the 60-day time period specified by ORS 183.482(1). Pursuant to ORS 536.075 and OAR 137-003-0675, you may petition for judicial review or petition the Director for reconsideration of this order. A petition for reconsideration may be granted or denied by the Director, and if no action is taken within 60 days following the date the petition was filed, the petition shall be deemed denied.

4. On September 27, 2018, the Department issued a Preliminary Determination proposing to approve Transfer Application T-12819 and sent a copy to the applicants. Additionally, notice of the Preliminary Determination for the transfer application was published in the Department's weekly notice on October 2, 2018, and in the Burns Times-Herald newspaper on October 3 and 10, 2018, pursuant to ORS 540.520 and OAR 690-380-4020. No protests were filed in response to the notice.
5. The first right to be transferred is as follows:

**Certificate:** 55574 in the name of THOMAS C. CLEMENS (perfected under Permit G-6961)  
**Use:** IRRIGATION OF 120.0 ACRES  
**Priority Date:** AUGUST 12, 1976  
**Rate:** 1.5 CUBIC FEET PER SECOND  
**Limit/Duty:** The amount of water used for irrigation, together with the amount secured under any other right existing for the same lands, shall be limited to ONE-EIGHTIETH of one cubic foot per second per acre, or its equivalent for each acre irrigated, and shall be further limited to a diversion of not to exceed 3.0 acre-feet per acre for each acre irrigated during the irrigation season of each year.  
**Source:** A WELL within the MALHEUR LAKE BASIN

**Authorized Point of Appropriation:**

Twp	Rng	Mer	Sec	Q-Q	Measured Distances
25 S	31 E	WM	16	NW NE	WELL 5 - 1300 FEET SOUTH AND 2050 FEET WEST FROM THE NE CORNER OF SECTION 16

**Authorized Place of Use:**

IRRIGATION					
Twp	Rng	Mer	Sec	Q-Q	Acres
25 S	31 E	WM	16	NE NE	40.0
25 S	31 E	WM	16	NW NE	40.0
25 S	31 E	WM	16	NE NW	40.0
Total					120.0

6. Transfer Application T-12819 proposes additional points of appropriation listed in the table below with the approximate distances from the authorized point of appropriation to:

Twp	Rng	Mer	Sec	Q-Q	Measured Distances	Distance in Miles from the authorized POD – Well #5
25 S	31 E	WM	15	NW NW	ROBEY WELL 1 - 1300 FEET NORTH AND 1320 FEET WEST FROM THE CENTER CORNER OF SECTION 15	0.65 mi
25 S	31 E	WM	15	SW NE	ROBEY WELL 2 - 1350 FEET NORTH AND 1320 FEET EAST FROM THE CENTER CORNER OF SECTION 15	1.15 mi
25 S	31 E	WM	9	SE NE	WELL 1 - 4020 FEET NORTH AND 430 FEET WEST FROM THE SE CORNER OF SECTION 9	1.07 mi

Twp	Rng	Mer	Sec	Q-Q	Measured Distances	Distance in Miles from the authorized POD – Well #5
25 S	31 E	WM	9	NE SW	WELL 2 - 20 FEET SOUTH FROM THE CENTER CORNER OF SECTION 9	0.74 mi
25 S	31 E	WM	9	SE SE	WELL 3 - 1370 FEET NORTH AND 1270 FEET WEST FROM THE SE CORNER OF SECTION 9	0.53 mi
25 S	31 E	WM	10	NW SW	WELL 4 - 1400 FEET NORTH AND 620 FEET EAST FROM THE SE CORNER OF SECTION 9	0.72 mi
25 S	31 E	WM	10	SE SW	WELL 6 - 110 FEET NORTH AND 1380 FEET EAST FROM THE SE CORNER OF SECTION 9	0.70 mi
25 S	31 E	WM	9	SE SW	WELL 10 - 50 FEET SOUTH AND 2650 FEET WEST FROM THE SE CORNER OF SECTION 9	0.26 mi
25 S	31 E	WM	9	SE SW	WELL 11 - 1240 FEET NORTH AND 2780 FEET WEST FROM THE SE CORNER OF SECTION 9	0.50 mi
25 S	31 E	WM	9	SE SE	WELL 12 - 1170 FEET NORTH AND 210 FEET WEST FROM THE SE CORNER OF SECTION 9	0.58 mi
25 S	31 E	WM	10	SW SW	WELL 13 - 1160 FEET NORTH AND 60 FEET EAST FROM THE SE CORNER OF SECTION 9	0.61 mi
25 S	31 E	WM	9	NE SE	WELL 14 - 1500 FEET NORTH AND 260 FEET WEST FROM THE SE CORNER OF SECTION 9	0.63 mi
25 S	31 E	WM	9	SE NE	WELL 15 - 2710 FEET NORTH AND 1310 FEET WEST FROM THE SE CORNER OF SECTION 9	0.77 mi
25 S	31 E	WM	10	SW SW	WELL 16 - 1340 FEET NORTH AND 1220 FEET EAST FROM THE SE CORNER OF SECTION 9	0.70 mi
25 S	31 E	WM	16	NE NE	WELL A - 130 FEET SOUTH AND 330 FEET WEST FROM THE SE CORNER OF SECTION 9	0.39 mi
25 S	31 E	WM	16	NW NE	WELL B - 460 FEET SOUTH AND 2070 FEET WEST FROM THE SE CORNER OF SECTION 9	0.16 mi
25 S	31 E	WM	15	NW NW	WELL C - 600 FEET SOUTH AND 50 FEET EAST FROM THE SE CORNER OF SECTION 9	0.42 mi
25 S	31 E	WM	15	SW NW	WELL D - 1320 FEET SOUTH AND 100 FEET EAST FROM THE SE CORNER OF SECTION 9	0.40 mi

7. Transfer Application T-12819 also proposes to change the place of use of the right to:

IRRIGATION					
Twp	Rng	Mer	Sec	Q-Q	Acres
25 S	31 E	WM	16	NE NE	22.1
25 S	31 E	WM	16	NW NE	29.8
25 S	31 E	WM	16	SW NE	16.7
25 S	31 E	WM	16	NE NW	16.3
25 S	31 E	WM	16	SE NW	35.1
Total					120.0

8. The second right to be transferred is as follows:

**Certificate:** 82391 in the name of J. W. MCCALLISTER AND JETT C. BLACKBURN  
(perfected under Permit G-9879)

**Use:** IRRIGATION OF 343.0 ACRES

**Priority Date:** APRIL 19, 1982

**Rate:** 4.29 CUBIC FEET PER SECOND

**Limit/Duty:** The amount of water used for irrigation, together with the amount secured under any other right existing for the same lands, is limited to ONE-EIGHTIETH of one cubic foot per second and 3.0 acre-feet for each acre irrigated during the irrigation season of each year.

**Source:** WELLS 1, 3, and 4 within the MALHEUR LAKE BASIN

**Authorized Points of Appropriation:**

Twp	Rng	Mer	Sec	Q-Q	Measured Distances
25 S	31 E	WM	9	SE NE	WELL 1 - 4100 FEET NORTH AND 340 FEET WEST FROM THE SE CORNER OF SECTION 9
25 S	31 E	WM	9	SE SE	WELL 3 - 1370 FEET NORTH AND 1270 FEET WEST FROM THE SE CORNER OF SECTION 9
25 S	31 E	WM	10	NW SW	WELL 4 - 1400 FEET NORTH AND 620 FEET EAST FROM THE SW CORNER OF SECTION 9

**Authorized Place of Use:**

IRRIGATION					
Twp	Rng	Mer	Sec	Q-Q	Acres
25 S	31 E	WM	9	SW NE	31.6
25 S	31 E	WM	9	SE NE	41.2
25 S	31 E	WM	9	SW NW	1.4
25 S	31 E	WM	9	SE NW	35.6
25 S	31 E	WM	9	NE SW	35.2
25 S	31 E	WM	9	NW SW	1.4
25 S	31 E	WM	9	NE SE	41.1
25 S	31 E	WM	9	NW SE	32.0
25 S	31 E	WM	9	SE SE	41.2
25 S	31 E	WM	10	NW SW	41.1
25 S	31 E	WM	10	SW SW	41.2
Total					343.0



9. Transfer Application T-12819 proposes additional points of appropriation listed in the table below with the approximate distances from the existing points of appropriation to:

Twp	Rng	Mer	Sec	Q-Q	Measured Distances	Distance from the authorized well locations measured in miles (mi)		
						Well 1	Well 3	Well 4
25 S	31 E	WM	15	NW NW	ROBEY WELL 1 - 1300 FEET NORTH AND 1320 FEET WEST FROM THE CENTER CORNER OF SECTION 15	1.05	0.70	0.52
25 S	31 E	WM	15	SW NE	ROBEY WELL 2 - 1350 FEET NORTH AND 1320 FEET EAST FROM THE CENTER CORNER OF SECTION 15	1.30	1.12	0.81
25 S	31 E	WM	9	NE SW	WELL 2 - 20 FEET SOUTH FROM THE CENTER CORNER OF SECTION 9	0.53	0.35	0.66
25 S	31 E	WM	16	NW NE	WELL 5 - 1300 FEET SOUTH AND 2050 FEET WEST FROM THE SE CORNER OF SECTION 9	1.07	0.52	0.71
25 S	31 E	WM	10	SE SW	WELL 6 - 110 FEET NORTH AND 1380 FEET EAST FROM THE SE CORNER OF SECTION 9	0.82	0.55	0.28
25 S	31 E	WM	9	SE SW	WELL 10 - 50 FEET SOUTH AND 2650 FEET WEST FROM THE SE CORNER OF SECTION 9	0.90	0.37	0.68
25 S	31 E	WM	9	SE SW	WELL 11 - 1240 FEET NORTH AND 2780 FEET WEST FROM THE SE CORNER OF SECTION 9	0.71	0.28	0.65
25 S	31 E	WM	9	SE SE	WELL 12 - 1170 FEET NORTH AND 210 FEET WEST FROM THE SE CORNER OF SECTION 9	0.55	0.20	0.16
25 S	31 E	WM	10	SW SW	WELL 13 - 1160 FEET NORTH AND 60 FEET EAST FROM THE SE CORNER OF SECTION 9	0.56	0.26	0.11
25 S	31 E	WM	9	NE SE	WELL 14 - 1500 FEET NORTH AND 260 FEET WEST FROM THE SE CORNER OF SECTION 9	0.49	0.19	0.17
25 S	31 E	WM	9	SE NE	WELL 15 - 2710 FEET NORTH AND 1310 FEET WEST FROM THE SE CORNER OF SECTION 9	0.32	0.25	0.44
25 S	31 E	WM	10	SW SW	WELL 16 - 1340 FEET NORTH AND 1220 FEET EAST FROM THE SE CORNER OF SECTION 9	0.60	0.48	0.13
25 S	31 E	WM	16	NE NE	WELL A - 130 FEET SOUTH AND 330 FEET WEST FROM THE SE CORNER OF SECTION 9	0.80	0.34	0.34
25 S	31 E	WM	16	NW NE	WELL B - 460 FEET SOUTH AND 2070 FEET WEST FROM THE SE CORNER OF SECTION 9	0.92	0.38	0.62
25 S	31 E	WM	15	NW NW	WELL C - 600 FEET SOUTH AND 50 FEET EAST FROM THE SE CORNER OF SECTION 9	0.89	0.45	0.4

Twp	Rng	Mer	Sec	Q-Q	Measured Distances	Distance from the authorized well locations measured in miles (mi)		
						Well 1	Well 3	Well 4
25 S	31 E	WM	15	SW NW	WELL D - 1320 FEET SOUTH AND 100 FEET EAST FROM THE SE CORNER OF SECTION 9	1.02	0.57	0.52

10. Transfer Application T-12819 also proposes to change the place of use of the right to:

IRRIGATION					
Twp	Rng	Mer	Sec	Q-Q	Acres
25 S	31 E	WM	9	SW NE	31.3
25 S	31 E	WM	9	SE NE	31.4
25 S	31 E	WM	9	SE NW	31.5
25 S	31 E	WM	9	NE SW	31.3
25 S	31 E	WM	9	SE SW	30.2
25 S	31 E	WM	9	NE SE	31.4
25 S	31 E	WM	9	NW SE	31.5
25 S	31 E	WM	9	SW SE	30.2
25 S	31 E	WM	9	SE SE	31.4
25 S	31 E	WM	10	NW SW	31.4
25 S	31 E	WM	10	SW SW	31.4
Total					343.0

**Transfer Review Criteria (OAR 690-380-4010)**

11. Water has been used within the last five years according to the terms and conditions of the rights. There is no information in the record that would demonstrate that the rights are subject to forfeiture under ORS 540.610.
12. A pump, pipeline, and sprinkler system sufficient to use the full amount of water allowed under the existing rights were present within the five-year period prior to submittal of Transfer Application T-12819.
13. The proposed changes would not result in enlargement of the rights.
14. The proposed changes would not result in injury to other water rights.
15. All other application requirements are met.

**Determination and Proposed Action**

The additional points of appropriation and change in place of use proposed in Transfer Application T-12819 are consistent with the requirements of ORS 537.705 and 540.505 to 540.580 and OAR 690-380-5000.

**Now, therefore, it is ORDERED:**

1. The additional points of appropriation and change in place of use proposed in Transfer Application T-12819 are approved.
2. The right to the use of the water is restricted to beneficial use at the place of use described, and is subject to all other conditions and limitations contained in Certificates 55574 and 82391 and any related decree.
3. Water right Certificates 55571 and 82391 are cancelled.
4. The quantity of water diverted at the additional points of appropriation, together with that diverted at the original points of appropriation, shall not exceed the quantity of water lawfully available at the original points of appropriation.
5. Water use measurement conditions:
  - a. Before water use may begin under this order, the water user shall install a totalizing flow meter, or, with prior approval of the Director, another suitable measuring device at each point of appropriation (new and existing).
  - b. The water user shall maintain the meters or measuring devices in good working order.
  - c. The water user shall allow the Watermaster access to the meters or measuring devices; provided however, where the meters or measuring devices are located within a private structure, the Watermaster shall request access upon reasonable notice.
6. Water shall be acquired from the same aquifer (water source) as the original points of appropriation.
7. The former place of use of the transferred right shall no longer receive water under the right.
8. Full beneficial use of the water shall be made, consistent with the terms of this order, on or before **October 1, 2020**. A Claim of Beneficial Use prepared by a Certified Water Right Examiner shall be submitted by the applicant to the Department within one year after the deadline for completion of the changes and full beneficial use of the water.
9. After satisfactory proof of beneficial use is received, new certificates confirming the rights transferred will be issued.

Dated at Salem, Oregon this NOV 27 2018,



Dwight French, Water Right Services Administrator, for  
Thomas M. Byler, Director  
Oregon Water Resources Department

Mailing date NOV 28 2018

This is a final order in other than a contested case. This order is subject to judicial review under ORS 183.484. Any petition for judicial review must be filed within the 60 day time period specified by ORS 183.484(2). Pursuant to ORS 536.075 and OAR 137-004-0080 you may either petition for judicial review or petition the Director for reconsideration of this order. A petition for reconsideration may be granted or denied by the Director, and if no action is taken within 60 days following the date the petition was filed, the petition shall be deemed denied.

In addition, under ORS 537.260 any person with an application, permit or water right certificate subsequent in priority may jointly or severally contest the issuance of the certificate at any time before it has issued, and after the time has expired for the completion of the appropriation under the permit, or within three months after issuance of the certificate.

STATE OF OREGON

COUNTY OF HARNEY

CERTIFICATE OF WATER RIGHT

THIS CERTIFICATE ISSUED TO

J.W. McCALLISTER AND JETT C. BLACKBURN  
771 PONDEROSA VILLAGE  
BURNS, OREGON 97720

confirms the right to use the waters of WELLS 1, 3, AND 4 in the MALHEUR LAKE BASIN for IRRIGATION OF 343.0 ACRES.

This right was perfected under Permit G-9879. The date of priority is APRIL 19, 1982. This right is limited to 4.29 CUBIC FEET PER SECOND, or its equivalent in case of rotation, measured at the wells.

The wells are located as follows:

WELL 1 - SE $\frac{1}{4}$  NE $\frac{1}{4}$ , SECTION 9, T 25 S, R 31 E, W.M.; 4100 FEET NORTH AND 340 FEET WEST FROM THE SE CORNER, SECTION 9.

WELL 3 - SE $\frac{1}{4}$  SE $\frac{1}{4}$ , SECTION 9, T 25 S, R 31 E, W.M.; 1370 FEET NORTH AND 1270 FEET WEST FROM THE SE CORNER, SECTION 9.

WELL 4 - NW $\frac{1}{4}$  SW $\frac{1}{4}$ , SECTION 10, T 25 S, R 31 E, W.M.; 1400 FEET NORTH AND 620 FEET EAST FROM THE SW CORNER, SECTION 10.

The amount of water used for irrigation, together with the amount secured under any other right existing for the same lands, is limited to ONE-EIGHTIETH of one cubic foot per second and 3.0 acre-feet for each acre irrigated during the irrigation season of each year.

G-10688.VC/LHN

CERTIFICATE NUMBER 82391

A description of the place of use to which this right is appurtenant, is as follows:

SW <sup>1</sup> / <sub>4</sub> NE <sup>1</sup> / <sub>4</sub>	31.6 ACRES
SE <sup>1</sup> / <sub>4</sub> NE <sup>1</sup> / <sub>4</sub>	41.2 ACRES
SW <sup>1</sup> / <sub>4</sub> NW <sup>1</sup> / <sub>4</sub>	1.4 ACRES
SE <sup>1</sup> / <sub>4</sub> NW <sup>1</sup> / <sub>4</sub>	35.6 ACRES
NE <sup>1</sup> / <sub>4</sub> SW <sup>1</sup> / <sub>4</sub>	35.2 ACRES
NW <sup>1</sup> / <sub>4</sub> SW <sup>1</sup> / <sub>4</sub>	1.4 ACRES
NE <sup>1</sup> / <sub>4</sub> SE <sup>1</sup> / <sub>4</sub>	41.1 ACRES
NW <sup>1</sup> / <sub>4</sub> SE <sup>1</sup> / <sub>4</sub>	32.0 ACRES
SE <sup>1</sup> / <sub>4</sub> SE <sup>1</sup> / <sub>4</sub>	41.2 ACRES

SECTION 9

NW <sup>1</sup> / <sub>4</sub> SW <sup>1</sup> / <sub>4</sub>	41.1 ACRES
SW <sup>1</sup> / <sub>4</sub> SW <sup>1</sup> / <sub>4</sub>	41.2 ACRES

SECTION 10

TOWNSHIP 25 SOUTH, RANGE 31 EAST, W.M.

The right to the use of the water for the above purpose is restricted to beneficial use on the lands or place of use described.

The works shall include an airline and pressure gauge or an access port for a measuring line, adequate to determine the water level elevation in the well at all times.

The water user shall maintain a weir, meter, or other suitable measuring device, and shall keep a complete record of the amount of ground water withdrawn.

WITNESS the signature of the Water Resources Director, affixed

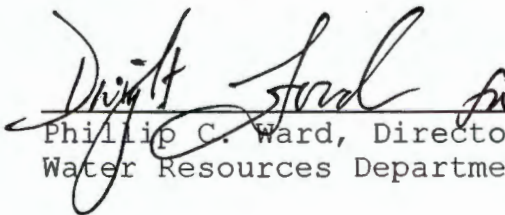

**OCT 06 2006**

  
 Phillip C. Ward, Director  
 Water Resources Department

Recorded in State Record of Water Right Certificates Number 82391.

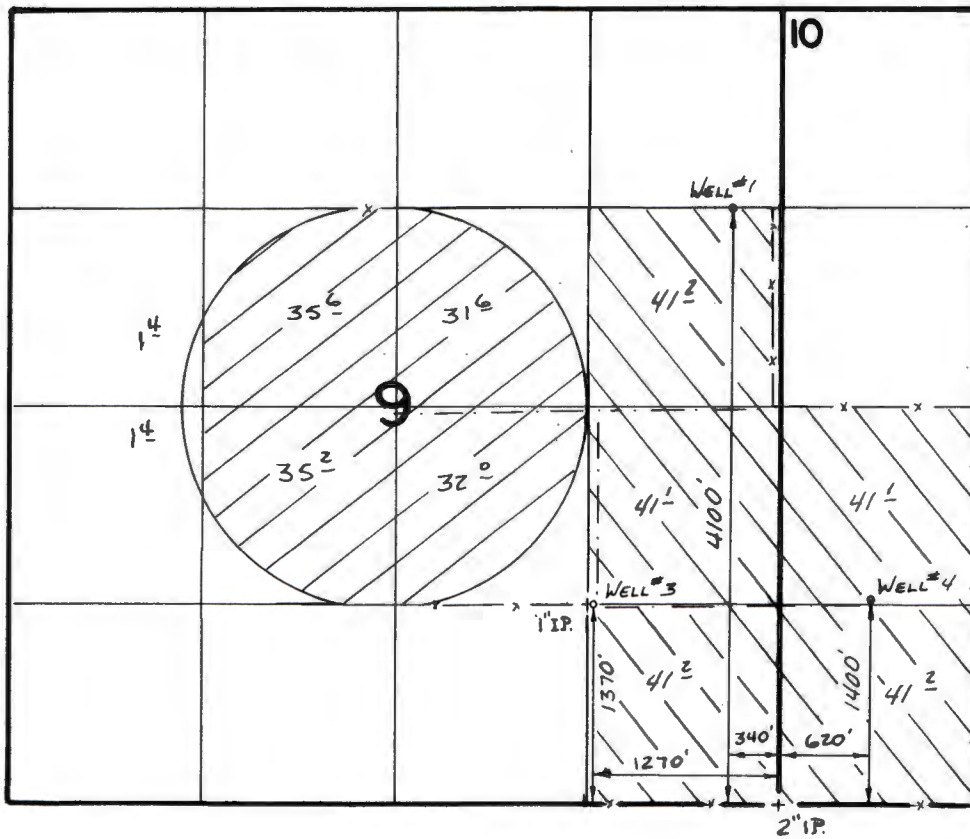
T. 25S., R. 31E., W. M.



-  WELLS 1 & 3
-  WELLS 3 & 4

**FINAL PROOF SURVEY**  
 UNDER

Application No. **G:10688** Permit No. **G:9879**..  
 IN NAME OF

**J.W. McCALLISTER & JETT C. BLACKBURN**

Surveyed ..5-9..... 1988, by **T.M. WARREN**.....

Mailing List for Certificate  
Scheduled Mailing Date:

Application: G-10688

Permit: G-9879

Certificate:

Permit/Certificate Holder:

J.W. McCALLISTER AND JETT C. BLACKBURN  
771 PONDEROSA VILLAGE  
BURNS, OREGON 97720

Copies Mailed

by: Connie Vance

(DATE) 10/6/2006

Copies of Final Certificate to be sent to:

1. Watermaster : 10 (Include Map) ✓
2. Data Center (include copy of map) ✓
3. Water Availability -
4. Vault file -

Other persons to receive copies: (include map):

T. 25S., R. 31E., W. M.

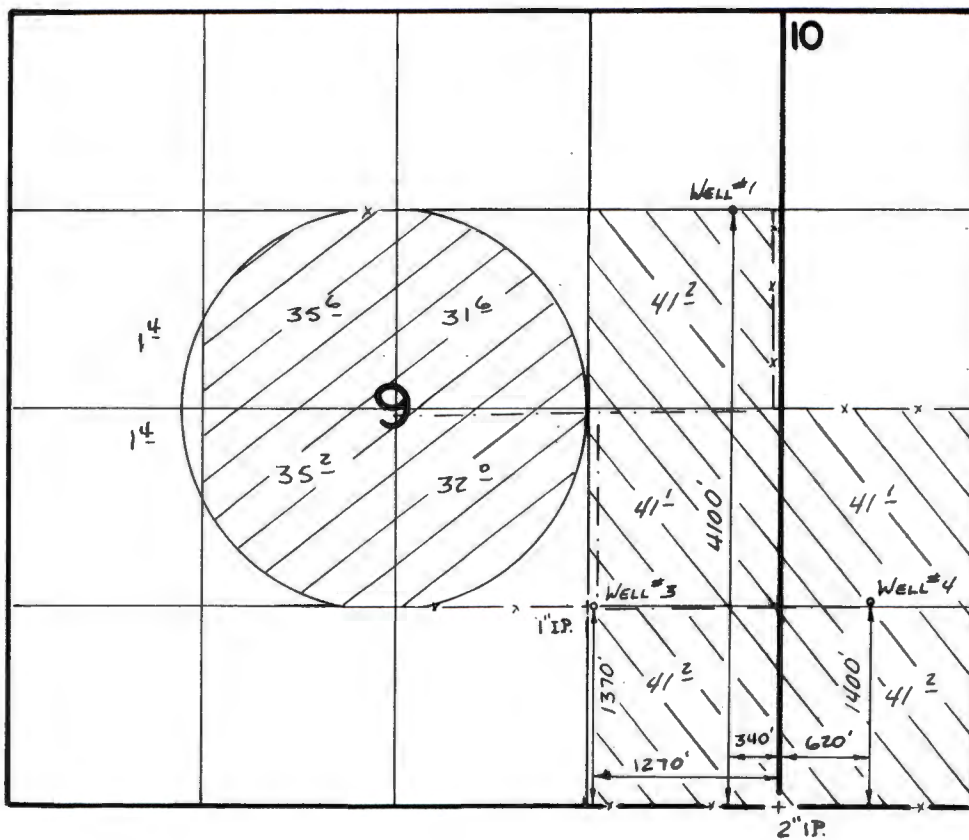

SCALE 1" = 1320'

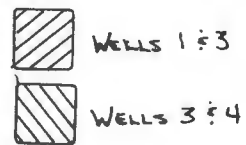

**FINAL PROOF SURVEY**  
UNDER

Application No. **G:10688** Permit No. **G:9879**  
IN NAME OF

**J.W. McALLISTER & JETT C. BLACKBURN**

Surveyed **5-9** 19**88**, by **T.M. WARREN**



This is a final order in other than a contested case. This order is subject to judicial review under ORS 183.484. Any petition for judicial review must be filed within the 60 day time period specified by ORS 183.484(2). Pursuant to ORS 536.075 and OAR 137-004-0080 you may either petition for judicial review or petition the Director for reconsideration of this order. A petition for reconsideration may be granted or denied by the Director, and if no action is taken within 60 days following the date the petition was filed, the petition shall be deemed denied.

**PROPOSED**

In addition, under ORS 537.260 any person with an application, permit or water right certificate subsequent in priority may jointly or severally contest the issuance of the certificate at any time before it has issued, and after the time has expired for the completion of the appropriation under the permit, or within three months after issuance of the certificate.

STATE OF OREGON

COUNTY OF HARNEY

PROPOSED CERTIFICATE OF WATER RIGHT

THIS CERTIFICATE ISSUED TO

J.W. McCALLISTER AND JETT C. BLACKBURN  
771 PONDEROSA VILLAGE  
BURNS, OREGON 97720

confirms the right to use the waters of WELLS 1, 3, AND 4 in the MALHEUR LAKE BASIN for IRRIGATION OF 343.0 ACRES.

This right was perfected under Permit G-9879. The date of priority is APRIL 19, 1982. This right is limited to 4.29 CUBIC FEET PER SECOND, or its equivalent in case of rotation, measured at the wells.

The wells are located as follows:

WELL 1 - SE $\frac{1}{4}$  NE $\frac{1}{4}$ , SECTION 9, T 25 S, R 31 E, W.M.; 4100 FEET NORTH AND 340 FEET WEST FROM THE SE CORNER, SECTION 9.

WELL 3 - SE $\frac{1}{4}$  SE $\frac{1}{4}$ , SECTION 9, T 25 S, R 31 E, W.M.; 1370 FEET NORTH AND 1270 FEET WEST FROM THE SE CORNER, SECTION 9.

WELL 4 - NW $\frac{1}{4}$  SW $\frac{1}{4}$ , SECTION 10, T 25 S, R 31 E, W.M.; 1400 FEET NORTH AND 620 FEET EAST FROM THE SW CORNER, SECTION 10.

The amount of water used for irrigation, together with the amount secured under any other right existing for the same lands, is limited to ONE-EIGHTIETH of one cubic foot per second and 3.0 acre-feet for each acre irrigated during the irrigation season of each year.

G-10688.VC/LHN

CERTIFICATE NUMBER

82391

A description of the place of use to which this right is appurtenant, is as follows:

SW $\frac{1}{4}$ NE $\frac{1}{4}$	31.6 ACRES
SE $\frac{1}{4}$ NE $\frac{1}{4}$	41.2 ACRES
SW $\frac{1}{4}$ NW $\frac{1}{4}$	1.4 ACRES
SE $\frac{1}{4}$ NW $\frac{1}{4}$	35.6 ACRES
NE $\frac{1}{4}$ SW $\frac{1}{4}$	35.2 ACRES
NW $\frac{1}{4}$ SW $\frac{1}{4}$	1.4 ACRES
NE $\frac{1}{4}$ SE $\frac{1}{4}$	41.1 ACRES
NW $\frac{1}{4}$ SE $\frac{1}{4}$	32.0 ACRES
SE $\frac{1}{4}$ SE $\frac{1}{4}$	41.2 ACRES

## SECTION 9

NW $\frac{1}{4}$ SW $\frac{1}{4}$	41.1 ACRES
SW $\frac{1}{4}$ SW $\frac{1}{4}$	41.2 ACRES

## SECTION 10

TOWNSHIP 25 SOUTH, RANGE 31 EAST, W.M.

The right to the use of the water for the above purpose is restricted to beneficial use on the lands or place of use described.

The works shall include an airline and pressure gauge or an access port for a measuring line, adequate to determine the water level elevation in the well at all times.

The water user shall maintain a weir, meter, or other suitable measuring device, and shall keep a complete record of the amount of ground water withdrawn.

WITNESS the signature of the Water Resources Director, affixed

---

# PROPOSED

---

Phillip C. Ward, Director  
Water Resources Department

Recorded in State Record of Water Right Certificates Number.

G-10688.VC/LHN

# Mailing List for Certificate

## Scheduled Mailing Date:

Application: G-10688

Permit: G-9879

Certificate: 82391

### Permit/Certificate Holder:

J.W. McCALLISTER AND JETT C. BLACKBURN  
771 PONDEROSA VILLAGE  
BURNS, OREGON 97720

Copies  
Mailed  
by:  
*Connie Vance*  
(STAFF)  
on:  
5/19/2006  
(DATE)

### Copies of Final Certificate to be sent to:

1. Watermaster : 10 (Include Map)
2. Data Center (include copy of map)
3. Water Availability
4. Vault

### Other persons to receive copies: (include map):



# Oregon

Theodore R. Kulongoski, Governor

Water Resources Department  
North Mall Office Building  
725 Summer Street NE, Suite A  
Salem, OR 97301-1271  
503-986-0900  
FAX 503-986-0904

**DATE MAILED: May 19, 2006**

## NOTICE

Reference: Permit G-9879

Enclosed is a proposed certificate of water right and a map which illustrates the location of the right. The map and proposed certificate represent the extent water was used within the terms of the permit based upon a survey and inspection.

If you do not agree with the proposed certificate or the map, Oregon Administrative Rule 690-330-010 (2) allows the permittee or landowner 60 days from the mailing date of this notice to request the Department to reconsider the contents of the proposed certificate.

If you agree with the proposed certificate and map no response to this notice is required. Sometime after the 60 day period, the recorded certificate of water right will be mailed to the permittee.

If you have any questions please contact Gerry Clark at 503-986-0811.

Sincerely,

Dwight French  
Administrator  
Water Rights Division

T. 25S., R. 31E., W. M.

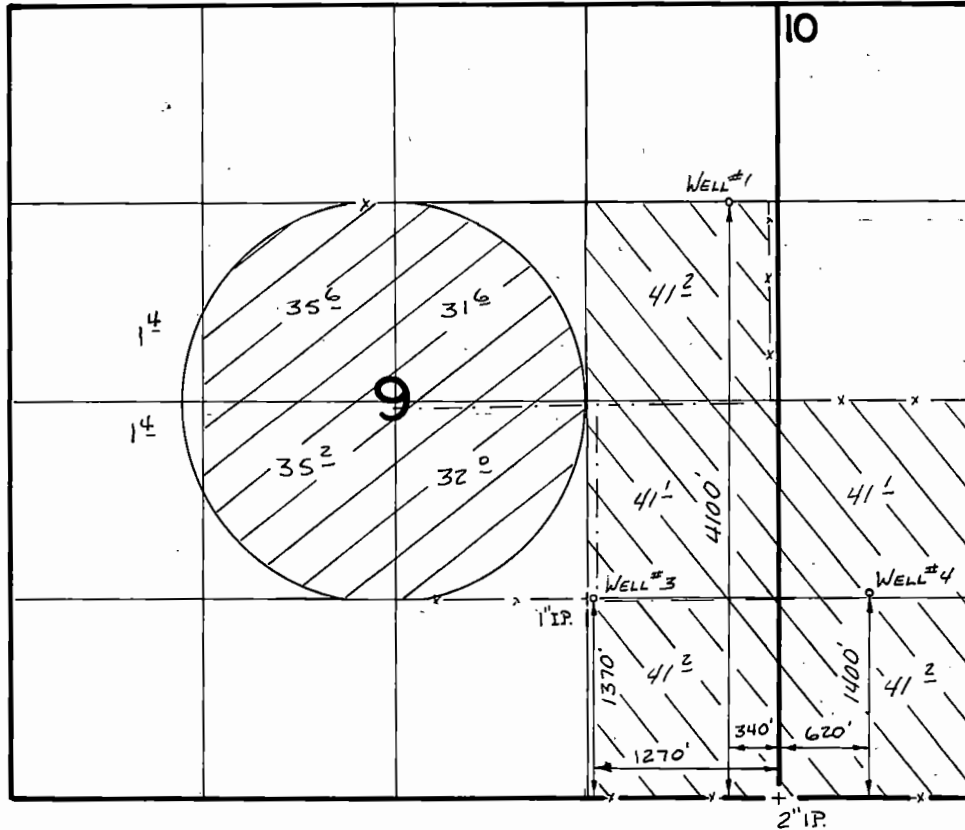

SCALE 1" = 1320'

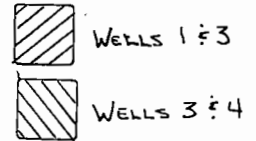

**FINAL PROOF SURVEY**  
UNDER

Application No. **G:10688** Permit No. **G:9879**..  
IN NAME OF

**J. W. McALLISTER & JETT C. BLACKBURN**

Surveyed **5-2**..... 19**88**, by **J. M. WARREN**.....



STATE OF OREGON

INTEROFFICE MEMO

TO: Mr. Dick Nimrod  
Well Construction Specialist

DATE:

FROM: Survey/Certificate Section

SUBJECT: File Number G-10688

According to an inspection made by our Field Examiner, the well described by Permit Number G-9879 appears to have the following deficiency:

Inadequate Annular Seal  
 Inadequate Sanitary Seal  
 No Airline or Access Port  
 Other \_\_\_\_\_

REMARKS: There are two wells #2 & #5,  
drilled but not used that have no  
seal at all.



# Abstract of Permit

This is to certify that I have examined APPLICATION G-10688 and do hereby grant the same SUBJECT TO EXISTING RIGHTS and the following limitations and conditions:

This permit is issued to J.W. McCallister and Jett C. Blackburn, 771 Ponderosa Village, Burns, Oregon 97720, phone 573-7206 for the use of the waters of five wells, being 2.5 cubic feet per second from Wells 1, 2, 3 and 2.0 cfs from Wells 3 and 4 for the PURPOSE of Irrigation

BLACKBURN  
REALTY  
LEF 1

that the PRIORITY OF THE RIGHT dates from April 19, 1982

and is limited to the amount of water which can be applied to beneficial use and shall not exceed 4.5 cfs

measured at the point of diversion from the wells, or its equivalent in case of rotation with other water users.

The well is to be LOCATED: Well 1 - 1,335 feet South and 410 feet West from Northeast Corner, Section 9 being within SE 1/4 NE 1/4, Section 9; Well 2 - 2,635 feet South and 680 feet West from the Northeast Corner, Section 9 being within NE 1/4 SE 1/4, Section 9; Well 3 - 1,310 feet North and 1,300 feet West from the Southeast Corner, Section 9, being with SE 1/4 SE 1/4,\* A description of the PLACE OF USE under the permit, and to which such right is appurtenant, is as follows:

25S 31E

\* Section 9; Well 4 - 1,300 feet North and 800 feet East from the SE Corner, Section 9, being within SW 1/4 SW 1/4, Section 10; Well 5 - 2,610 feet South and 1,280 feet West from Northeast Corner, Section 9, being within SE 1/4 NE 1/4, Section 9, Township 25 South, Range 31 East, WM, in the County of Harney

SEE NEXT PAGE

The well shall be constructed in accordance with the General Standards for the Construction and Maintenance of Water Wells in Oregon. The works constructed shall include an air line and pressure gauge or an access port for measuring line, adequate to determine water level elevation in the well at all times. The permittee shall install and maintain a weir, meter, or other suitable measuring device, and shall keep a complete record of the amount of ground water withdrawn.

Actual construction work shall begin on or before October 20, 1983, and shall thereafter be prosecuted with reasonable diligence and be completed on or before October 1, 1984.

Complete application of the water to the proposed use shall be made on or before October 1, 1985.

Witness my hand this 20th day of October, 1982.

\_\_\_\_\_  
WATER RESOURCES DIRECTOR

This permit is for the beneficial use of water. By law, the land use associated with this water use must be in compliance with statewide land-use goals and any local acknowledged land-use plan. It is possible that the land use you propose may not be allowed if it is not in keeping with the goals and the acknowledged plan. Your city or county planning agency can advise you about the land-use plan in your area.

PTS w/F.F. amw  
5/9/88

Max

Township 25 South, Range 31 East, WM	Section 9	SW 1/4	NE 1/4	<u>Wells 1, 2 and 5</u>	40.0 acres
	Section 9	SE 1/4	NE 1/4		40.0 acres
	Section 9	SE 1/4	NW 1/4		40.0 acres
	Section 9	NE 1/4	SW 1/4		40.0 acres
	Section 9	NW 1/4	SE 1/4		40.0 acres
				<u>Wells 3 and 4</u>	
	Section 9	NE 1/4	SE 1/4		40.0 acres
	Section 9	SE 1/4	SE 1/4		40.0 acres
	Section 10	NW 1/4	SW 1/4		40.0 acres
	Section 10	SW 1/4	SW 1/4		40.0 acres

The AMOUNT OF WATER used for irrigation, together with the amount secured under any other right existing for the same lands shall be limited to 1/80 of one cubic foot per second per acre, and shall be further limited to a diversion of not to exceed 3.0 acre-feet per acre for each acre irrigated during the irrigation season of each year, and shall conform to such reasonable rotation system as may be ordered by the proper state officer.



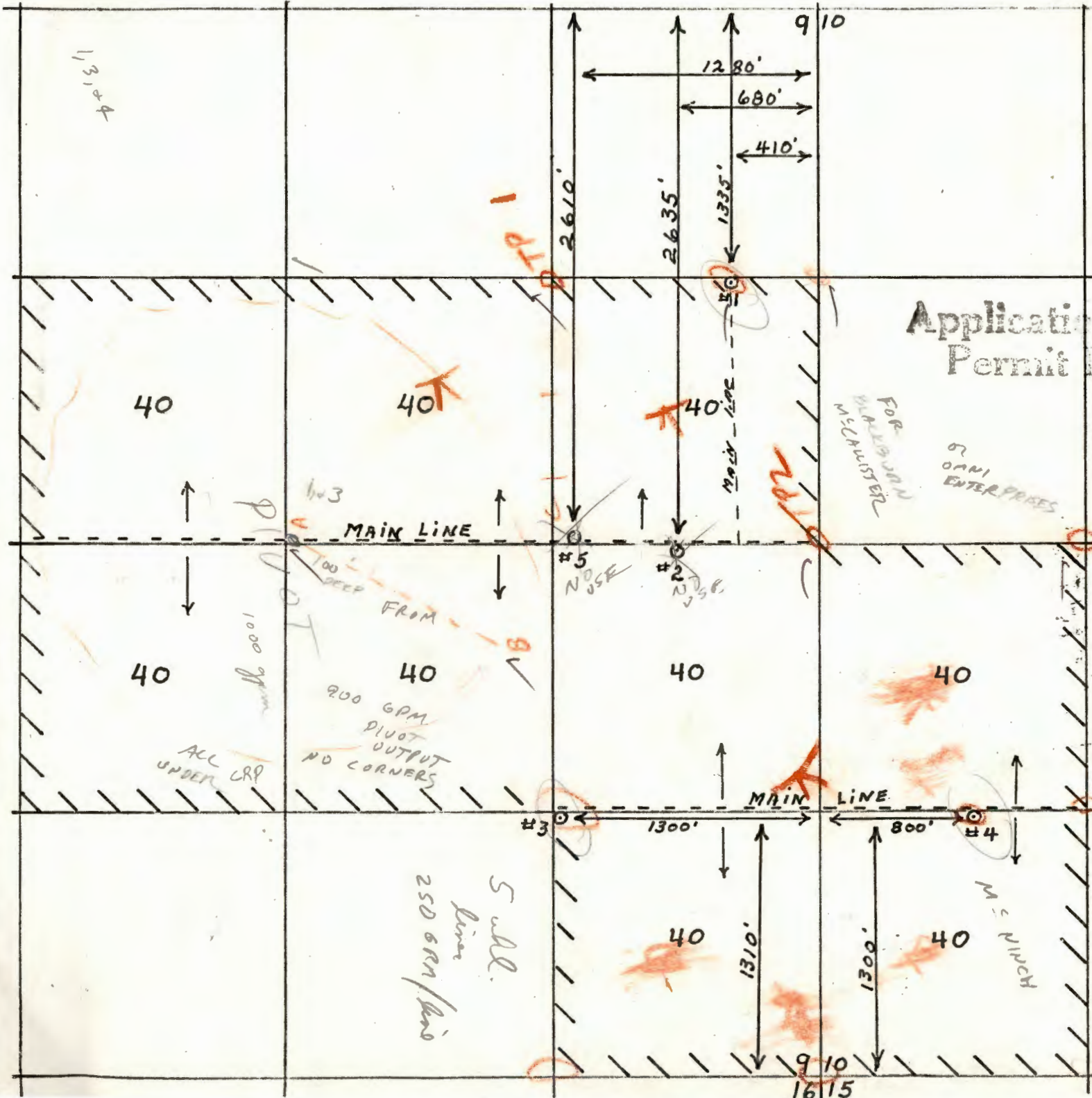

**RECEIVED**  
 SEP 13 1982  
 WATER RESOURCES DEPT.  
 SALEM, OREGON

Application No. G-10688  
 Permit No. G 9879

N  
 T-25-S  
 R-31-E  
 1" = 660'

**RECEIVED**  
 APR 29 1982  
 WATER RESOURCES DEPT.  
 SALEM, OREGON

INFO: Jett Blackburn, wells #2 & #5 not used at all, they were drilled, but never were used. Irrigation was ~~not~~ <sup>applied</sup> except for most westerly 160 acres is under pivot with no corners irrigated.

Source: 3 wells → all drilled for BLANQUAN - M<sup>c</sup>ALISTER or OMNI ENTERPRISES

#1  
12' SWL  
MEAS.  
unknown casing  
SS & PORT

#3  
unknown casing  
S.S. & PORT

#4  
unknown casing  
S.S. & PORT

Pump: NATIONAL DDT / 8" DIS.

NATIONAL DDT / 8" DIS

NATIONAL DDT / 6" DIS.

motor: U.S. MTRS. 50 HP elec. @ 1770 RPM

US MTRS. 50 HP elec. @ 1770 RPM

US MTRS. 30 HP elec. @ 1770 RPM  
ASSUMED 50' SWL

$$Q_{P1} = \frac{50(7.04)}{50 + 1.1(2.31)(65)} = 1.43$$

$$Q_{P3} = \frac{50(7.04)}{50 + 1.1(2.31)(65)} = 1.43$$

$$Q_{P4} = \frac{30(7.04)}{50 + 1.1(2.31)(65)} = .98$$

IPE: 7,000' 8" ALUM MN. 1-1320' CENTER-PIVOT

TDS - 165 - RB 30' (4-well line MTR.) (5-1/2 mi well-line) (wells 3, & 4)  
1-1320' Center PIVOT RATED @ 1000 gpm (WELLS 1 & 3)

$$TDSR = 4 \times 250 = 1000 = 2.2$$

$$= 2.2$$

$$4.4$$

USE: Alfalfa & PASTURE GRASS

$$Q_{ALLOW} = 1.68 cfs + 2.57 cfs$$

LIFT: ± 10' DIS

TIE: PTS W/FIELD FORM

$$\frac{9}{16} / \frac{10}{15} = 2" I.P.$$

Thompson M. Warren  
W.R.E. 5/9/88

$$\frac{343.0}{80} = 4.29 cfs$$

This is a final order in other than a contested case. This order is subject to judicial review under ORS 183.484. Any petition for judicial review must be filed within the 60 day time period specified by ORS 183.484(2).

Pursuant to ORS 536.075 and OAR 137-004-0080 you may either petition for judicial review or petition the Director for reconsideration of this order. A petition for reconsideration may be granted or denied by the Director, and if no action is taken within 60 days following the date the petition was filed, the petition shall be deemed denied.

In addition, under ORS 537.260 any person with an application, permit or water right certificate subsequent in priority may jointly or severally contest the issuance of the certificate at any time before it has issued, and after the time has expired for the completion of the appropriation under the permit, or within three months after issuance of the certificate.

STATE OF OREGON

COUNTY OF HARNEY

PROPOSED CERTIFICATE OF WATER RIGHT

THIS CERTIFICATE ISSUED TO

J.W. McCALLISTER AND JETT C. BLACKBURN  
771 PONDEROSA VILLAGE  
BURNS, OREGON 97720

confirms the right to use the waters of WELLS 1, 3, AND 4 in the MALHEUR LAKE BASIN for IRRIGATION OF 340.2 ACRES.

343.0 4.29

This right was perfected under Permit G-9879. The date of priority is APRIL 19, 1982. This right is limited to 4.25 CUBIC FEET PER SECOND, or its equivalent in case of rotation, measured at the wells X

The wells are located as follows:

WELL 1 - SE $\frac{1}{4}$  NE $\frac{1}{4}$ , SECTION 9, T 25 S, R 31 E, W.M.; 4100 FEET NORTH AND 340 FEET WEST FROM THE SE CORNER, SECTION 9.

WELL 3 - SE $\frac{1}{4}$  SE $\frac{1}{4}$ , SECTION 9, T 25 S, R 31 E, W.M.; 1370 FEET NORTH AND 1270 FEET WEST FROM THE SE CORNER, SECTION 9.

WELL 4 - NW $\frac{1}{4}$  SW $\frac{1}{4}$ , SECTION 10, T 25 S, R 31 E, W.M.; 1400 FEET NORTH AND 620 FEET EAST FROM THE SW CORNER, SECTION 10.

The amount of water used for irrigation, together with the amount secured under any other right existing for the same lands, is limited to ONE-EIGHTIETH of one cubic foot per second and 3.0 acre-feet for each acre irrigated during the irrigation season of each year.

G-10688.VC/LHN

CERTIFICATE NUMBER

A description of the place of use to which this right is appurtenant, is as follows:

SW <sup>1</sup> / <sub>4</sub> NE <sup>1</sup> / <sub>4</sub>	31.6 ACRES
SE <sup>1</sup> / <sub>4</sub> NE <sup>1</sup> / <sub>4</sub>	41.2 ACRES
SW <sup>1</sup> / <sub>4</sub> NW <sup>1</sup> / <sub>4</sub>	1.4 ACRES
SE <sup>1</sup> / <sub>4</sub> NW <sup>1</sup> / <sub>4</sub>	35.6 ACRES
NE <sup>1</sup> / <sub>4</sub> SW <sup>1</sup> / <sub>4</sub>	35.2 ACRES
NW <sup>1</sup> / <sub>4</sub> SW <sup>1</sup> / <sub>4</sub>	1.4 ACRES
NE <sup>1</sup> / <sub>4</sub> SE <sup>1</sup> / <sub>4</sub>	41.1 ACRES
NW <sup>1</sup> / <sub>4</sub> SE <sup>1</sup> / <sub>4</sub>	32.0 ACRES
SE <sup>1</sup> / <sub>4</sub> SE <sup>1</sup> / <sub>4</sub>	41.2 ACRES
SECTION 9	

NW <sup>1</sup> / <sub>4</sub> SW <sup>1</sup> / <sub>4</sub>	41.1 ACRES
SW <sup>1</sup> / <sub>4</sub> SW <sup>1</sup> / <sub>4</sub>	41.2 ACRES
SECTION 10	

TOWNSHIP 25 SOUTH, RANGE 31 EAST, W.M.

The right to the use of the water for the above purpose is restricted to beneficial use on the lands or place of use described.

The works shall include an airline and pressure gauge or an access port for a measuring line, adequate to determine the water level elevation in the well at all times.

The water user shall maintain a weir, meter, or other suitable measuring device, and shall keep a complete record of the amount of ground water withdrawn.

WITNESS the signature of the Water Resources Director, affixed

\_\_\_\_\_

Phillip C. Ward, Director  
Water Resources Department



Recorded in State Record of Water Right Certificates Number.

G-10688.VC/LHN

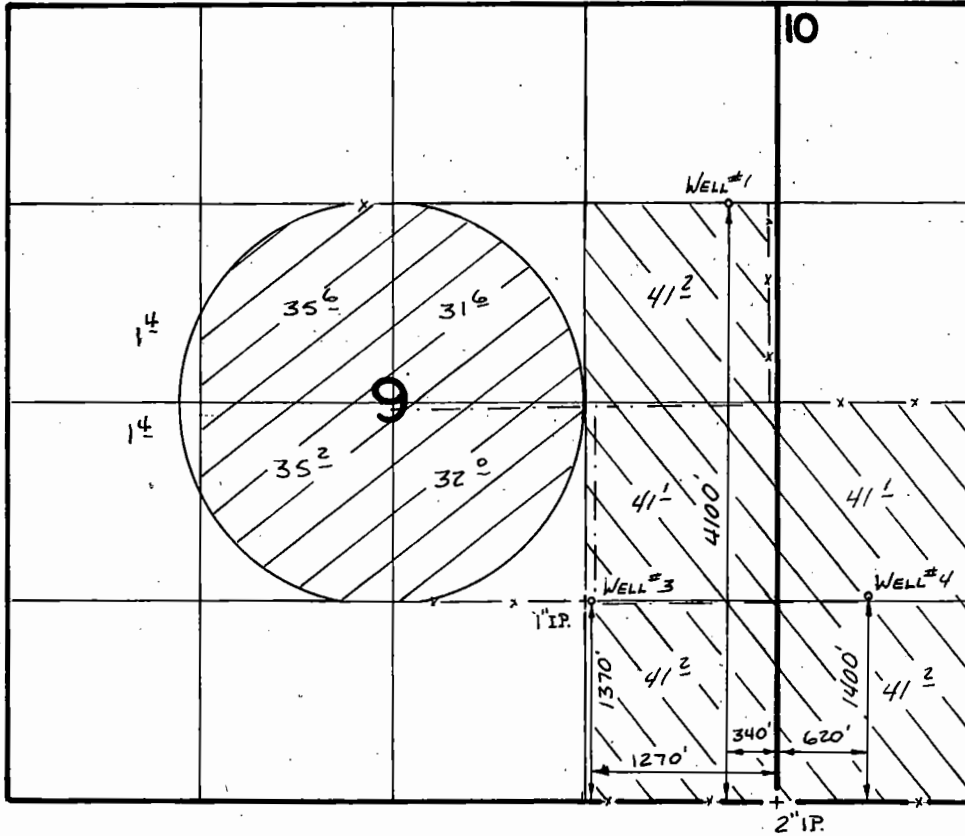
T. 25S., R. 31E., W. M.



SCALE 1" = 1320'

-  WELLS 1 & 3
-  WELLS 3 & 4

**FINAL PROOF SURVEY**  
UNDER

Application No. **G:10688** Permit No. **G:9879**..  
IN NAME OF

**J. W. McCALLISTER & JETT C. BLACKBURN**

Surveyed ...5-9..... 1988, by **T. M. WARREN**.....

T. 25S., R. 31E., W. M.

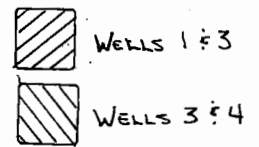
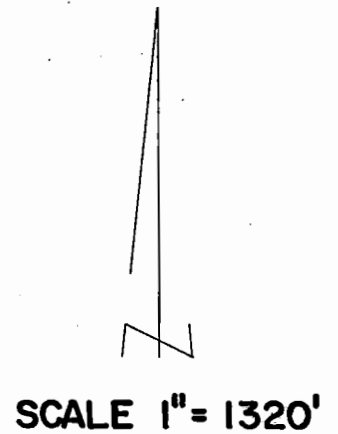
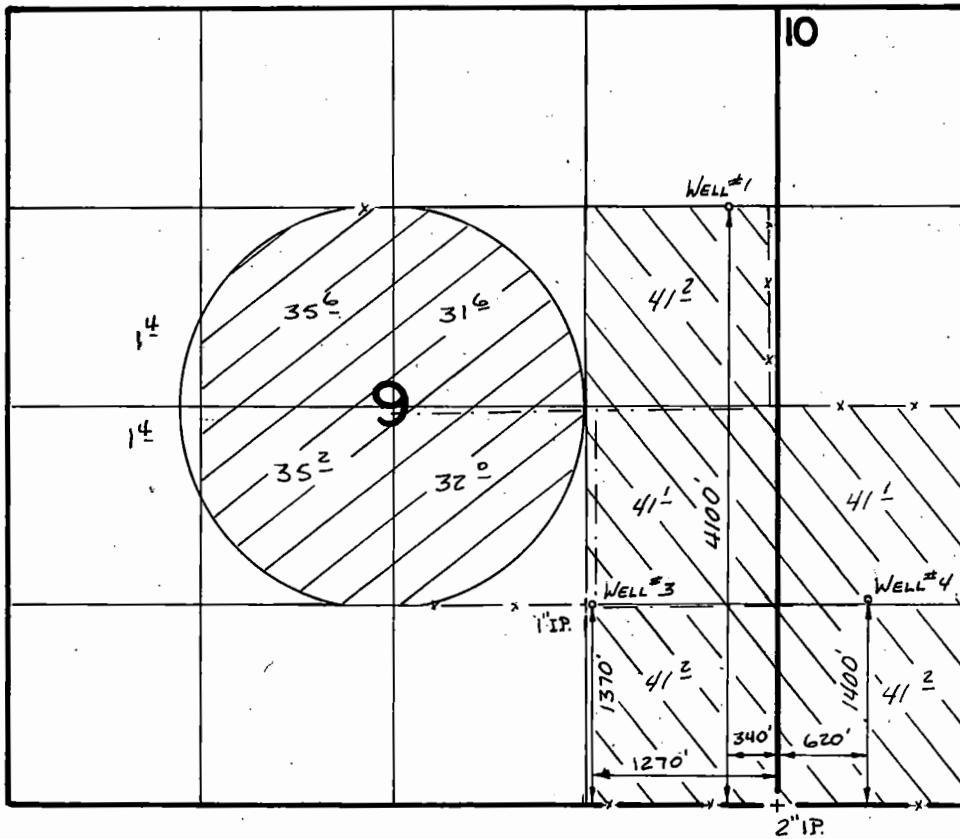

**FINAL PROOF SURVEY**  
UNDER

Application No. **G:10688** Permit No. **G:9879**  
IN NAME OF

**J.W. McCALLISTER & JETT C. BLACKBURN**

Surveyed **5-9** 19**88**, by **T.M. WARREN**

WELL?

NOTICE TO WATER WELL CONTRACTOR  
The original and first copy of this report  
are to be filed with the  
WATER RESOURCES DEPARTMENT,  
SALEM, OREGON 97310  
within 30 days from the date  
of well completion.

See letter in WWS file dated 10/1/79 RE: 8255/31E-9a1  
**RECEIVED** WATER WELL REPORT  
STATE OF OREGON  
FEB 20 1980  
WATER RESOURCES DEPT  
SALEM, OREGON  
State Well No. 31E-9a1  
State Permit No. 1116

JUL 27 1979  
(Please type or print)  
(Do not write above this line)

WATER RESOURCES DEPT

(1) OWNER: SALEM, OREGON  
Name J.W. McAllister and Jett C. Blackburn  
Address 771 PONDEROSA VILLAGE  
BURNS, OREGON 97720

(2) TYPE OF WORK (check):  
New Well  Deepening  Reconditioning  Abandon   
If abandonment, describe material and procedure in Item 12.

(3) TYPE OF WELL: (4) PROPOSED USE (check):  
Rotary  Driven  Domestic  Industrial  Municipal   
Cable  Jetted  Irrigation  Test Well  Other   
Dug  Bored

(5) CASING INSTALLED: Threaded  Welded   
16" Diam. from +1 ft. to 156 ft. Gage .250  
" Diam. from ft. to ft. Gage  
" Diam. from ft. to ft. Gage

(6) PERFORATIONS: Perforated?  Yes  No.  
Type of perforator used FACTORY LUVERD  
Size of perforations 3 in. by 1/8 in.  
2304 perforations from 60 ft. to 156 ft.  
perforations from ft. to ft.  
perforations from ft. to ft.

(7) SCREENS: Well screen installed?  Yes  No  
Manufacturer's Name  
Type Model No.  
Diam. Slot size Set from ft. to ft.  
Diam. Slot size Set from ft. to ft.

(8) WELL TESTS: Drawdown is amount water level is lowered below static level  
Was a pump test made?  Yes  No If yes, by whom?  
Yield: 550 gal./min. with 90 ft. drawdown after 12 hrs.  
" " " " "  
" " " " "  
Bailer test gal./min. with ft. drawdown after hrs.  
Artesian flow none g.p.m.  
Temperature of water 63 Depth artesian flow encountered ft.

(9) CONSTRUCTION:  
Well seal—Material used cement grout  
Well sealed from land surface to 18 ft.  
Diameter of well bore to bottom of seal 30 in.  
Diameter of well bore below seal 30 in.  
Number of sacks of cement used in well seal 60 sacks  
How was cement grout placed? poured  
Was a drive shoe used?  Yes  No Plugs Size: location ft.  
Did any strata contain unusable water?  Yes  No  
Type of water? depth of strata  
Method of sealing strata off  
Was well gravel packed?  Yes  No Size of gravel: 3/8  
Gravel placed from 18 ft. to 156 ft.

(10) LOCATION OF WELL:  
County HARNEY Driller's well number #1  
SE 1/4 NE 1/4 Section 9 T. 255 R. 31 E W.M.  
Bearing and distance from section or subdivision corner

(11) WATER LEVEL: Completed well.  
Depth at which water was first found 32 ft.  
Static level 8 ft. below land surface. Date 7/25/79  
Artesian pressure lbs. per square inch. Date

(12) WELL LOG: Diameter of well below casing 30"  
Depth drilled 205 ft. Depth of completed well 156 ft.  
Formation: Describe color, texture, grain size and structure of materials; and show thickness and nature of each stratum and aquifer penetrated, with at least one entry for each change of formation. Report each change in position of Static Water Level and indicate principal water-bearing strata.

MATERIAL	From	To	SWL
top soil	0	4	
tan sand	4	10	
tan clay	10	32	
tan sandstone	32	34	
sand	34	40	
grey clay	40	52	
black sand	52	56	
green clay	56	70	
sandstone, course	70	89	
claystone	89	93	
hard tan claystone	93	94	
course sand	94	97	
claystone	97	120	
soft sandy clay	120	143	
tan claystone	143	150	
course sand	150	155	
hard fine sandstone	155	160	
green claystone	160	169	
green clay	169	205	

Work started 7/24 1979 Completed 7/25 1979  
Date well drilling machine moved off of well 7/26 1979

Drilling Machine Operator's Certification:  
This well was constructed under my direct supervision. Materials used and information reported above are true to my best knowledge and belief.  
[Signed] *Stan Blair* Date 7/25, 1979.  
(Drilling Machine Operator)  
Drilling Machine Operator's License No. 1035

Water Well Contractor's Certification:  
This well was drilled under my jurisdiction and this report is true to the best of my knowledge and belief.  
Name WESTERN WATER WELLS INC.  
(Person, firm or corporation) (Type or print)  
Address P.O. BOX 294 BURNS, OREGON 97720  
[Signed] *Stan Blair*  
(Water Well Contractor)  
Contractor's License No. 659 Date 7/25, 1979

well 72

NOTICE TO WATER WELL CONTRACTOR  
The original and first copy of this report are to be filed with the  
WATER RESOURCES DEPARTMENT, SALEM, OREGON 97310  
within 30 days from the date of well completion.

WATER WELL REPORT  
STATE OF OREGON  
(Please type or print)  
Do not write above this line

RECEIVED  
AUG 3 - 1979  
WATER RESOURCES DEPT  
SALEM, OREGON

RECEIVED  
25/3E-9ad  
State Well No.  
State Permit No.  
AUG 1979  
Hanna 11/77

(1) OWNER: SALEM, OREGON  
Name J.W. McALLISTER & JETT C. BLACKBURN  
Address 771 PONDEROSA VILLAGE  
BURNS, OREGON 97720

(2) TYPE OF WORK (check):  
New Well  Deepening  Reconditioning  Abandon   
If abandonment, describe material and procedure in Item 12.

(3) TYPE OF WELL: Rotary  Cable  Dug   
Driven  Jetted  Bored   
(4) PROPOSED USE (check): Domestic  Industrial  Municipal  Irrigation  Test Well  Other

(5) CASING INSTALLED: Threaded  Welded   
16" Diam. from +1 ft. to 156 ft. Gage .312  
" Diam. from " ft. to " ft. Gage "  
" Diam. from " ft. to " ft. Gage "

(6) PERFORATIONS: Perforated?  Yes  No.  
Type of perforator used LUVERED  
Size of perforations 3 in. by 1/8 in.  
3840 perforations from 60 ft. to 156 ft.  
perforations from " ft. to " ft.  
perforations from " ft. to " ft.

(7) SCREENS: Well screen installed?  Yes  No  
Manufacturer's Name \_\_\_\_\_  
Type \_\_\_\_\_ Model No. \_\_\_\_\_  
Diam. \_\_\_\_\_ Slot size \_\_\_\_\_ Set from \_\_\_\_\_ ft. to \_\_\_\_\_ ft.  
Diam. \_\_\_\_\_ Slot size \_\_\_\_\_ Set from \_\_\_\_\_ ft. to \_\_\_\_\_ ft.

(8) WELL TESTS: Drawdown is amount water level is lowered below static level  
Was a pump test made?  Yes  No If yes, by whom?  
Yield: 550 gal./min. with 140 ft. drawdown after 8 hrs.  
" " " " " "  
" " " " " "  
Bailer test gal./min. with ft. drawdown after hrs.  
Artesian flow NONE g.p.m.  
Temperature of water 63 Depth artesian flow encountered \_\_\_\_\_ ft.

(9) CONSTRUCTION: Well seal—Material used CEMENT  
Well sealed from land surface to 18 ft.  
Diameter of well bore to bottom of seal 30 in.  
Diameter of well bore below seal 30 in.  
Number of sacks of cement used in well seal 60 sacks  
How was cement grout placed? POURED  
Was a drive shoe used?  Yes  No Plugs \_\_\_\_\_ Size: location \_\_\_\_\_ ft.  
Did any strata contain unusable water?  Yes  No  
Type of water? \_\_\_\_\_ depth of strata \_\_\_\_\_  
Method of sealing strata off \_\_\_\_\_  
Was well gravel packed?  Yes  No Size of gravel: #288  
Gravel placed from 18 ft. to 156 ft.

(10) LOCATION OF WELL: County HARNEY, OREGON Driller's well number #2  
SE 1/4 NE 1/4 Section 9 T. 25S R. 31E W.M.  
Bearing and distance from section or subdivision corner \_\_\_\_\_

(11) WATER LEVEL: Completed well.  
Depth at which water was first found 12 ft.  
Static level 12 ft. below land surface. Date 7/29/79  
Artesian pressure NONE lbs. per square inch. Date \_\_\_\_\_

(12) WELL LOG: Diameter of well below casing 30"  
Depth drilled 165 ft. Depth of completed well 156 ft.  
Formation: Describe color, texture, grain size and structure of materials; and show thickness and nature of each stratum and aquifer penetrated, with at least one entry for each change of formation. Report each change in position of Static Water Level and indicate principal water-bearing strata.

MATERIAL	From	To	SWL
top soil	0	4	
fine sand	4	14	
tan claystone	14	24	
sand&sandstone	24	36	
gray clay	36	40	
gray sandstone	40	54	
green claystone	54	72	
soft sandy claystone	72	100	
green sandstone	100	107	
hard cemented gravel	107	109	
soft sandstone& gravel	109	116	
hard sandy claystone	116	122	
sandstone & gravel	122	124	
sandy claystone	124	129	
soft green sandstone & medium gravel	129	137	
green sand & sandstone	137	150	
green clay	150	165	

Work started 7/26 1979 Completed 7/28 1979  
Date well drilling machine moved off of well 7/28 1979  
Drilling Machine Operator's Certification:  
This well was constructed under my direct supervision. Materials used and information reported above are true to my best knowledge and belief.  
[Signed] \_\_\_\_\_ Date 7/30, 1979  
(Drilling Machine Operator)  
Drilling Machine Operator's License No. 1035

Water Well Contractor's Certification:  
This well was drilled under my jurisdiction and this report is true to the best of my knowledge and belief.  
Name WESTERN WATER WELLS INC.  
(Person, firm or corporation) (Type or print)  
Address P.O. BOX 294 BURNS, OREGON 97720  
[Signed] \_\_\_\_\_  
(Water Well Contractor)  
Contractor's License No. 659 Date 7/30, 1979



NOTICE TO WATER WELL CONTRACTOR  
 The original and first copy of this report are to be filed with the  
**RECEIVED WATER WELL REPORT**  
 WATER RESOURCES DEPARTMENT, STATE OF OREGON  
 SALEM, OREGON 97310  
 within 30 days from the date of well completion  
 (Please type or print)  
 Write above this line

State Well No. 25s/31E-9dd  
 State Permit No. \_\_\_\_\_

Well 13?

1118  
Warkn

(1) OWNER:  
 Name J.W. McALLISTER & JETT C. BLACKBURN  
 Address 771 PONDEROSA VILLAGE  
BURNS, OREGON 97720

(2) TYPE OF WORK (check):  
 New Well  Deepening  Reconditioning  Abandon   
 If abandonment, describe material and procedure in Item 12.

(3) TYPE OF WELL: (4) PROPOSED USE (check):  
 Rotary  Driven  Domestic  Industrial  Municipal   
 Cable  Jetted  Irrigation  Test Well  Other   
 Dug  Bored

CASING INSTALLED: Threaded  Welded   
6" Diam. from +1 ft. to 168 ft. Gage .312  
 " Diam. from \_\_\_\_\_ ft. to \_\_\_\_\_ ft. Gage \_\_\_\_\_  
 " Diam. from \_\_\_\_\_ ft. to \_\_\_\_\_ ft. Gage \_\_\_\_\_

PERFORATIONS: Perforated?  Yes  No.  
 Type of perforator used Louvered  
 Size of perforations 3 in. by 1/8 in.  
3840 perforations from 72 ft. to 168 ft.  
 \_\_\_\_\_ perforations from \_\_\_\_\_ ft. to \_\_\_\_\_ ft.  
 \_\_\_\_\_ perforations from \_\_\_\_\_ ft. to \_\_\_\_\_ ft.

(7) SCREENS: Well screen installed?  Yes  No  
 Manufacturer's Name \_\_\_\_\_  
 Type \_\_\_\_\_ Model No. \_\_\_\_\_  
 Diam. \_\_\_\_\_ Slot size \_\_\_\_\_ Set from \_\_\_\_\_ ft. to \_\_\_\_\_ ft.  
 Diam. \_\_\_\_\_ Slot size \_\_\_\_\_ Set from \_\_\_\_\_ ft. to \_\_\_\_\_ ft.

(8) WELL TESTS: Drawdown is amount water level is lowered below static level  
 Was a pump test made?  Yes  No If yes, by whom?  
 Yield: 490 gal./min. with 145 ft. drawdown after 8 hrs.  
 " " " " " "

Baller test \_\_\_\_\_ gal./min. with \_\_\_\_\_ ft. drawdown after \_\_\_\_\_ hrs.  
 Artesian flow none g.p.m.  
 Temperature of water 63 Depth artesian flow encountered \_\_\_\_\_ ft.

(9) CONSTRUCTION:  
 Well seal—Material used cement grout  
 Well sealed from land surface to 18 ft.  
 Diameter of well bore to bottom of seal 30 in.  
 Diameter of well bore below seal 30 in.  
 Number of sacks of cement used in well seal 60 sacks  
 How was cement grout placed? gravity flow

(10) LOCATION OF WELL:  
 County HARNEY Driller's well number #3  
SE 1/4 SE 1/4 Section 9 T. 25S R. 31E W.M.  
 Bearing and distance from section or subdivision corner \_\_\_\_\_

(11) WATER LEVEL: Completed well.  
 Depth at which water was first found 19 ft.  
 Static level 6 ft. below land surface. Date 7/31/79  
 Artesian pressure none lbs. per square inch. Date \_\_\_\_\_

(12) WELL LOG: Diameter of well below casing 30  
 Depth drilled 180 ft. Depth of completed well 168 ft.  
 Formation: Describe color, texture, grain size and structure of materials; and show thickness and nature of each stratum and aquifer penetrated, with at least one entry for each change of formation. Report each change in position of Static Water Level and indicate principal water-bearing strata.

MATERIAL	From	To	SWL
top soil	0	4	
tan sand	4	8	
tan claystone	8	19	
green claystone	19	32	
tan clay	32	38	
gray clay	38	63	
green sandstone	63	78	
tan claystone	78	80	
sandstone & gravel	80	90	
sandy claystone	90	99	
green sand	99	104	
green claystone	104	110	
sandstone & gravel	110	112	
sandy claystone	112	117	
fractured claystone	117	124	
sandstone & gravel	124	130	
sand & gravel	130	146	
sandy claystone	146	152	
sand & gravel	152	165	
green clay	165	180	

Work started 7/30 1979 Completed 7/31 1979  
 Date well drilling machine moved off of well 7/31 1979

Drilling Machine Operator's Certification:  
 This well was constructed under my direct supervision. Materials used and information reported above are true to my best knowledge and belief.  
 [Signed] James B. Bunn Date 7/31, 1979  
 (Drilling Machine Operator)  
 Drilling Machine Operator's License No. 1035

Water Well Contractor's Certification:  
 This well was drilled under my jurisdiction and this report is true to the best of my knowledge and belief.  
 Name WESTERN WATER WELLS, INC.  
 (Person, firm or corporation) (Type or print)  
 Address P.O. BOX 294 BURNS, OREGON 97720  
 [Signed] James B. Bunn  
 (Water Well Contractor)  
 Contractor's License No. 659 Date 7/31, 1979

Was a drive shoe used?  Yes  No Plugs \_\_\_\_\_ Size \_\_\_\_\_  
 Did any strata contain unusable water?  Yes  No  
 Type of water? \_\_\_\_\_ depth of strata \_\_\_\_\_  
 Method of sealing strata off \_\_\_\_\_  
 Was well gravel packed?  Yes  No Size of gravel: 3/8  
 Gravel placed from 18 ft. to 168 ft.

NOTICE TO WATER WELL CONTRACTOR  
The original and first copy of this report  
are to be filed with the

**WATER WELL REPORT**

WATER RESOURCES DEPARTMENT  
SALEM, OREGON 97310  
within 30 days from the date  
of well completion.

STATE OF OREGON

(Please type or print)  
(Do not write above this line)

State Well No. 255/31E-10  
State Permit No. \_\_\_\_\_

*1120*  
*Harn*

*Well #?*

**(1) OWNER:**

Name BLACKBURN REALTY  
Address BURNS ORE.

**(2) TYPE OF WORK (check):**

New Well  Deepening  Reconditioning  Abandon   
If abandonment, describe material and procedure in Item 12.

**(3) TYPE OF WELL:**

Rotary  Driven   
 Jetted   
Dug  Bored

**(4) PROPOSED USE (check):**

Domestic  Industrial  Municipal   
Irrigation  Test Well  Other

**(5) CASING INSTALLED:**

Threaded  Welded   
14" Diam. from 0 ft. to 140 ft. Gage 250  
" Diam. from \_\_\_\_\_ ft. to \_\_\_\_\_ ft. Gage \_\_\_\_\_  
" Diam. from \_\_\_\_\_ ft. to \_\_\_\_\_ ft. Gage \_\_\_\_\_

**(6) PERFORATIONS:**

Perforated?  Yes  No.  
Type of perforator used TORCH.  
Size of perforations 1/4 in. by 4 in.  
\_\_\_\_\_ perforations from 60 ft. to 140 ft.  
\_\_\_\_\_ perforations from \_\_\_\_\_ ft. to \_\_\_\_\_ ft.  
\_\_\_\_\_ perforations from \_\_\_\_\_ ft. to \_\_\_\_\_ ft.

**(7) SCREENS:**

Well screen installed?  Yes  No  
Manufacturer's Name \_\_\_\_\_ Model No. \_\_\_\_\_  
Type \_\_\_\_\_ Diam. \_\_\_\_\_ Slot size \_\_\_\_\_ Set from \_\_\_\_\_ ft. to \_\_\_\_\_ ft.  
Diam. \_\_\_\_\_ Slot size \_\_\_\_\_ Set from \_\_\_\_\_ ft. to \_\_\_\_\_ ft.

**(8) WELL TESTS:**

Drawdown is amount water level is lowered below static level  
V pump test made?  Yes  No If yes, by whom?  
Yield: gal./min. with \_\_\_\_\_ ft. drawdown after \_\_\_\_\_ hrs.  
" " " " " "  
" " " " " "  
Batter test gal./min. with \_\_\_\_\_ ft. drawdown after \_\_\_\_\_ hrs.  
Artesian flow g.p.m.  
Temperature of water \_\_\_\_\_ Depth artesian flow encountered \_\_\_\_\_ ft.

**(9) CONSTRUCTION:**

Well seal—Material used \_\_\_\_\_  
Well sealed from land surface to \_\_\_\_\_ ft.  
Diameter of well bore to bottom of seal \_\_\_\_\_ in.  
Diameter of well bore below seal \_\_\_\_\_ in.  
Number of sacks of cement used in well seal \_\_\_\_\_ sacks  
How was cement grout placed? \_\_\_\_\_  
Was a drive shoe used?  Yes  No Plugs \_\_\_\_\_ Size: location \_\_\_\_\_ ft.  
Did any strata contain unusable water?  Yes  No  
Type of water? \_\_\_\_\_ depth of strata \_\_\_\_\_  
Method of sealing strata off \_\_\_\_\_  
Was well gravel packed?  Yes  No Size of gravel: \_\_\_\_\_  
Gravel placed from \_\_\_\_\_ ft. to \_\_\_\_\_ ft.

**(10) LOCATION OF WELL:**

County HARN Driller's well number \_\_\_\_\_  
1/4 Section 10 T. 255 R. 31E W.M.  
Bearing and distance from section or subdivision corner \_\_\_\_\_

**(11) WATER LEVEL: Completed well.**

Depth at which water was first found \_\_\_\_\_ ft.  
Static level \_\_\_\_\_ ft. below land surface. Date \_\_\_\_\_  
Artesian pressure \_\_\_\_\_ lbs. per square inch. Date \_\_\_\_\_

**(12) WELL LOG:**

Diameter of well below casing \_\_\_\_\_  
Depth drilled \_\_\_\_\_ ft. Depth of completed well \_\_\_\_\_ ft.  
Formation: Describe color, texture, grain size and structure of materials; and show thickness and nature of each stratum and aquifer penetrated, with at least one entry for each change of formation. Report each change in position of Static Water Level and indicate principal water-bearing strata.

MATERIAL	From	To	SWL
<u>CLAY</u>	<u>0</u>	<u>140</u>	
<u>Clay kept squeezing in so I set a 14" liner to 140' I have no idea the condition or construction of the rest of the well.</u>			

**RECEIVED**

SEP 11 1979

WATER RESOURCES DEPT  
SALEM, OREGON

Work started Aug 15 1978 Completed Aug 20 1978  
Date well drilling machine moved off of well Aug 22 1979

**Drilling Machine Operator's Certification:**

This well was constructed under my direct supervision. Materials used and information reported above are true to my best knowledge and belief.  
[Signed] Al M. Runk Date 9/7 1979  
(Drilling Machine Operator)  
Drilling Machine Operator's License No. 1236

**Water Well Contractor's Certification:**

This well was drilled under my jurisdiction and this report is true to the best of my knowledge and belief.  
Name Al M. Runk  
(Person, firm or corporation) (Type or print)  
Address P.O. Box 1254 Johnson Ore  
[Signed] Al M. Runk  
(Water Well Contractor)  
Contractor's License No. 716 Date 9/7 1979

RECEIVED

25S/31E-9db

STATE OF OREGON  
WATER WELL REPORT  
(as required by ORS 537.765)

MAR 26 1987

(1) OWNER: **WATER RESOURCES DEPT**  
Name O.M.N.I Enterprises SALEM, OREGON  
Address 771 Ponderosa Village  
City BURNS State Oregon Zip 97750

LOCATION OF WELL by legal description:  
County HARNEY Latitude \_\_\_\_\_ Longitude \_\_\_\_\_  
Township 25S N or S, Range 31E E or W, WM.  
Section 4 NW ¼ SE ¼  
Tax Lot \_\_\_\_\_ Lot \_\_\_\_\_ Block \_\_\_\_\_ Subdivision \_\_\_\_\_  
Street Address of Well (or nearest address) Highway 205

(2) TYPE OF WORK:  
 New Well  Deepen  Recondition  Abandon

(3) DRILL METHOD  
 Rotary Air  Rotary Mud  Cable  
 Other \_\_\_\_\_

(4) PROPOSED USE:  
 Domestic  Community  Industrial  Irrigation  
 Thermal  Injection  Other \_\_\_\_\_

(5) BORE HOLE CONSTRUCTION:  
Special Construction approval Yes  No  Depth of Completed Well 100 ft.  
Explosives used Yes  No  Type \_\_\_\_\_ Amount \_\_\_\_\_

HOLE SEAL

Diameter	From	To	Material	From	To	Amount sacks or pounds
20"	0	20	Cement	0	20	21 sacks
16"	20	100				

How was seal placed: Method  A  B  C  D  E  
 Other \_\_\_\_\_  
Backfill placed from \_\_\_\_\_ ft. to \_\_\_\_\_ ft. Material \_\_\_\_\_  
Gravel placed from \_\_\_\_\_ ft. to \_\_\_\_\_ ft. Size of gravel \_\_\_\_\_

(6) CASING/LINER:  
Diameter From To Gauge Steel Plastic Welded Threaded  
Casing: 16" +1.5 23' .250      
Liner: \_\_\_\_\_  
Final location of shoe(s) 23'

(7) PERFORATIONS/SCREENS:  
 Perforations Method \_\_\_\_\_  
 Screens Type \_\_\_\_\_ Material \_\_\_\_\_  
From To Slot size Number Diameter Tele/pipe size Casing Liner  
NONE

(8) WELL TESTS: Minimum testing time is 1 hour  
 Pump  Bailer  Air  Artesian  
Yield gal/min 900+ Drawdown 41' Drill stem at \_\_\_\_\_ Time 1 hr.

Temperature of water 50 Depth Artesian Flow Found \_\_\_\_\_  
Was a water analysis done?  Yes By whom \_\_\_\_\_  
Did any strata contain water not suitable for intended use?  Too little  
 Salty  Muddy  Odor  Colored  Other \_\_\_\_\_  
Depth of strata: 13' To 16'

(10) STATIC WATER LEVEL:  
11' ft. below land surface. Date March 21  
Artesian pressure \_\_\_\_\_ lb. per square inch. Date \_\_\_\_\_

(11) WATER BEARING ZONES:

Depth at which water was first found \_\_\_\_\_

From	To	Estimated Flow Rate	SWL
13	16	GPM 10	11
85	90	GPM 900+	11

(12) WELL LOG: Ground elevation \_\_\_\_\_

Material	From	To	SWL
Top soil + Brown clay	0	3	
Sandstone	3	10	
Clay + Brown sand	10	13	
Sand + Gray clay	13	16	11"
Clay Gray	16	30	
Clay Gray	30	40	
Clay + coarse sand	40	50	
Claystone	50	70	
Clay Gray	70	85	
Gravel Small	85	90	11'
Course Sand	90	100	

Date started March 11 1987 Completed March 21-1987

(unbonded) Water Well Constructor Certification:  
I certify that the work I performed on the construction, alteration, or abandonment of this well is in compliance with Oregon well construction standards. Materials used and information reported above are true to my best knowledge and belief.

Signed \_\_\_\_\_ WWC Number \_\_\_\_\_  
Date \_\_\_\_\_

(bonded) Water Well Constructor Certification:  
I accept responsibility for the construction, alteration, or abandonment work performed on this well during the construction dates reported above. all work performed during this time is in compliance with Oregon well construction standards. This report is true to the best of my knowledge and belief.

Signed Joe Valentine's WWC Number 1435  
Date March 24 1987

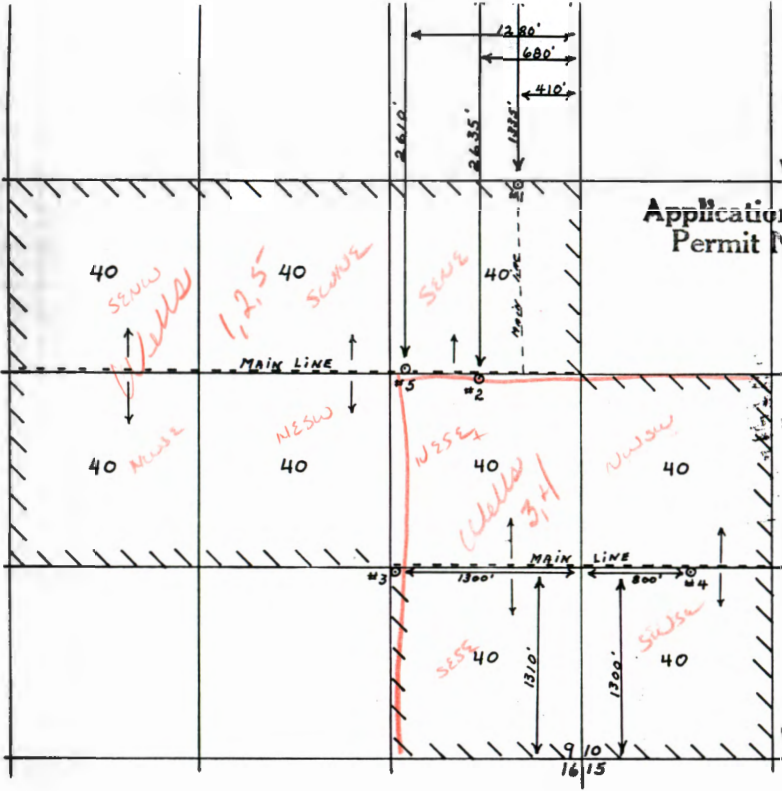

**RECEIVED**  
 SEP 15 1982  
 WATER RESOURCES DEPT.  
 SALEM, OREGON

Application No. G-10688  
 Permit No. G 9879



T-25-S  
 R-31-E  
 1" = 660'

**RECEIVED**  
 APR 19 1982  
 WATER RESOURCES DEPT.  
 SALEM, OREGON

RECEIVED

SEP 15 1982

WATER RESOURCES DEPT.  
SALEM, OREGON

Application No. G-10688  
Permit No. G 9879



T-25-S  
R-31-E

1" = 660'

RECEIVED

APR 19 1982

WATER RESOURCES DEPT.  
SALEM, OREGON

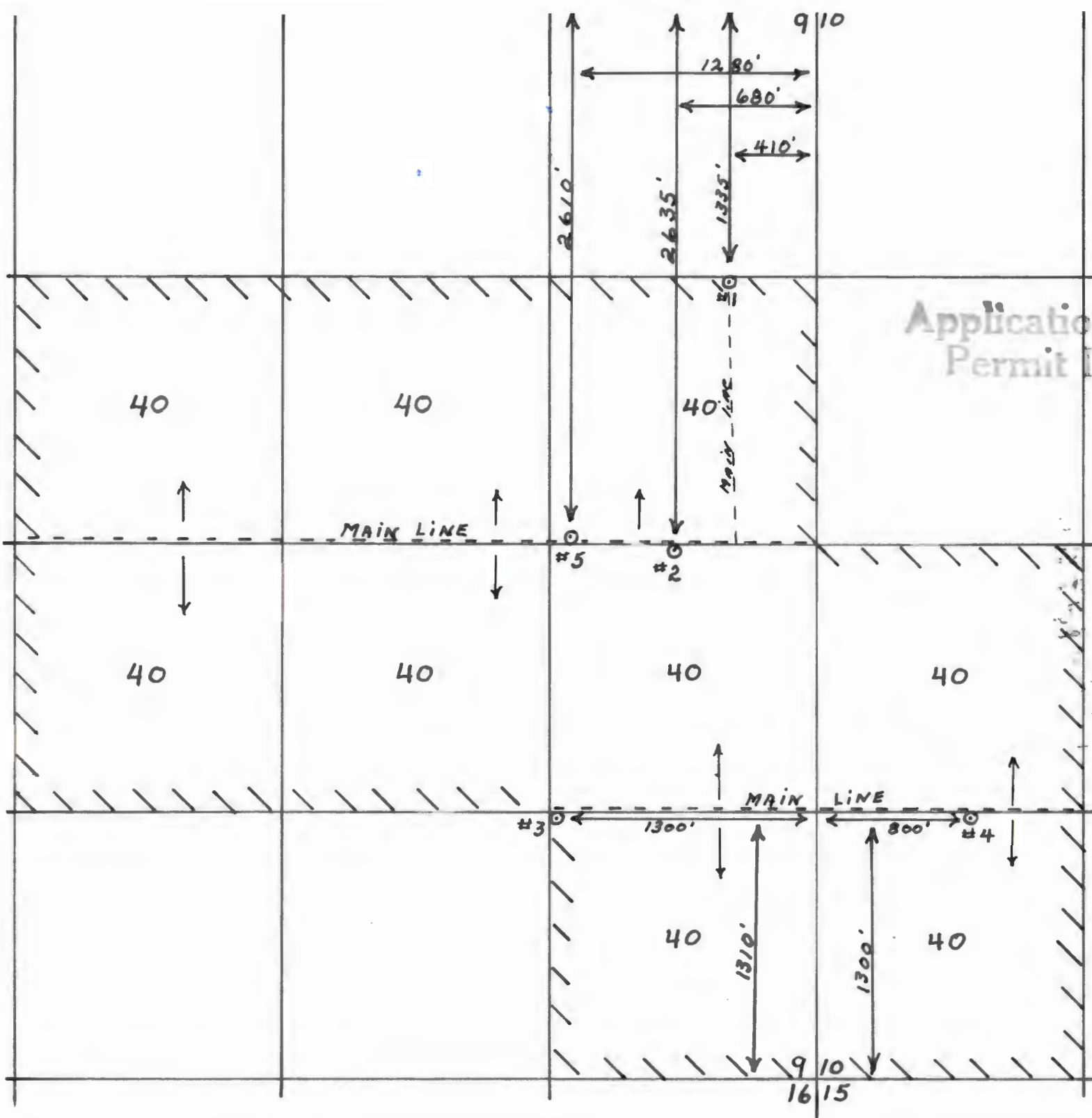

STATE OF OREGON

COUNTY OF HARNEY

PROPOSED CERTIFICATE OF WATER RIGHT

THIS CERTIFICATE ISSUED TO

J.W. McCALLISTER AND JETT C. BLACKBURN  
771 PONDEROSA VILLAGE  
BURNS, OREGON 97720

confirms the right to use the waters of WELLS 1, 3, AND 4 in the MALHEUR LAKE BASIN for IRRIGATING 134.4 ACRES FROM WELLS 1 AND 3; AND 205.8 ACRES FROM WELLS 3 AND 4.

This right was perfected under Permit G-9879. The date of priority is APRIL 19, 1982. This right is limited to 4.25 CUBIC FEET PER SECOND, 1.68 CFS FROM WELLS 1 AND 3; 2.57 CFS FROM WELLS 3 AND 4, or its equivalent in case of rotation, measured at the well.

The wells are located as follows:

1 - SE 1/4 NE 1/4, 3 - SE 1/4 SE 1/4, SECTION 9; 4 - NW 1/4 SW 1/4, SECTION 10, T 25 S, R 31 E, W.M.; 1 - 4100 FEET NORTH AND 340 FEET WEST, 3 - 1370 FEET NORTH AND 1270 FEET WEST; 4 - 1400 FEET NORTH AND 620 FEET EAST; ALL FROM THE SOUTHEAST CORNER OF SECTION 9.

The amount of water used for irrigation, together with the amount secured under any other right existing for the same lands, is limited to ONE-EIGHTIETH of one cubic foot per second and 3.0 acre-feet for each acre irrigated during the irrigation season of each year.

This right shall conform to such reasonable rotation system as may be ordered by the proper state officer.

A description of the place of use to which this right is appurtenant, is as follows:

WELLS 1 AND 3

SW 1/4 NE 1/4	31.6 ACRES
SE 1/4 NW 1/4	35.6 ACRES
NE 1/4 SW 1/4	35.2 ACRES
NW 1/4 SE 1/4	32.0 ACRES

SECTION 9

WELLS 3 AND 4

SE 1/4 NE 1/4	41.2 ACRES
NE 1/4 SE 1/4	41.1 ACRES
SE 1/4 SE 1/4	41.2 ACRES

SECTION 9

NW 1/4 SW 1/4	41.1 ACRES
SW 1/4 SW 1/4	41.2 ACRES

SECTION 10

TOWNSHIP 25 SOUTH, RANGE 31 EAST, W.M.

The right to the use of the water for the above purpose is restricted to beneficial use on the lands or place of use described.

G-10688.VC



STATE OF OREGON

COUNTY OF HARNEY

PROPOSED CERTIFICATE OF WATER RIGHT

THIS CERTIFICATE ISSUED TO

J.W. McCALLISTER & JETT C. BLACKBURN  
771 PONDEROSA VILLAGE  
BURNS, OREGON 97720

confirms the right to use the waters of WELLS #1,3,4 <sup>AND</sup> in the MALHEUR LAKE BASIN for the purpose of IRRIGATING 134.4 ACRES FROM WELLS #1 & 3 <sup>AND</sup> 205.8 ACRES FROM WELLS #3 & 4.

<sup>WAS</sup> The right has been perfected under Permit G-9879. The date of priority is APRIL 19, 1982. <sup>BEING</sup> The right is limited to ~~not more than~~ 1.68 cfs from wells 1 & 3; 2.57 cfs from wells 3 & 4; ~~for~~ 4.25 CUBIC FEET PER SECOND or its equivalent in case of rotation, measured at the well.

The wells <sup>ARE</sup> ~~is~~ located as follows:

#1-SE 1/4 NE 1/4, #3-SE 1/4 SE 1/4, SECTION 9; #4-NW 1/4 SW 1/4, SECTION 10, T 25 S, R 31 E, W.M.; #1 4100 FEET NORTH ~~AND~~ 340 FEET WEST, #3 1370 FEET NORTH ~~AND~~ 1270 FEET WEST, #4 1400 FEET NORTH ~~AND~~ 620 FEET EAST; ALL FROM THE SOUTHEAST CORNER SECTION 9.

The amount of water used for irrigation, together with the amount secured under any other right existing for the same lands, shall be limited to ONE-EIGHTIETH of one cubic foot per second ~~per acre, or its equivalent for each acre irrigated and shall be further limited to a diversion of not to exceed 3.0 acre-feet per acre for each acre irrigated during the irrigation season of each year.~~ <sup>THIS</sup>

The right shall conform to such reasonable rotation system as may be ordered by the proper state officer.

A description of the place of use ~~under the right, and to which such~~ right is appurtenant, is as follows:

<u>WELLS #1 &amp; 3</u>		
SW 1/4 NE 1/4	31.6 ACRES	
SE 1/4 NW 1/4	35.6 ACRES	
NE 1/4 SW 1/4	35.2 ACRES	
NW 1/4 SE 1/4	32.0 ACRES	
SECTION 9		
<u>WELLS #3 &amp; 4</u>		
SE 1/4 NE 1/4	41.2 ACRES	
NE 1/4 SE 1/4	41.1 ACRES	
SE 1/4 SE 1/4	41.2 ACRES	
SECTION 9		
NW 1/4 SW 1/4	41.1 ACRES	
SW 1/4 SW 1/4	41.2 ACRES	→
SECTION 10		
TOWNSHIP 25 SOUTH, RANGE 31 EAST, W.M.		

The right to the use of the water for the above purpose is restricted to beneficial use on the lands or place of use described.

G-10688.VC

1-31-92  
BWB



October 25, 1982

J. W. McCallister & Jett C. Blackburn  
771 Ponderosa Village  
Burns, OR 97720.

G 10688

G 9879

---

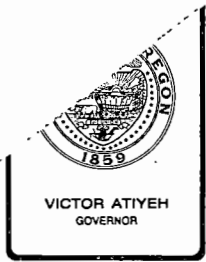

## *Water Resources Department*

MILL CREEK OFFICE PARK

555 13th STREET N.E., SALEM, OREGON 97310

PHONE 578-3008  
OR  
1-800-452-7613  
(message line)

Sep. 16, 1987

J. W. McCallister and Jet C. Blackburn  
771 Ponderosa Village  
Burns, OR 97720

Dear Mr. McCallister and Mr. Blackburn:

REFERENCE: File G-10688

Thank you for the return of your amended Application G-10688 along with supporting data.

Your application now appears to be in satisfactory form and will be placed with the next group to be considered for approval by the issuance of a permit.

Sincerely,

STEPHEN C. BROWN  
Senior Water Rights Examiner

SCB:pc

0056/0  
26220

COPY



## *Water Resources Department*

MILL CREEK OFFICE PARK

555 13th STREET N.E., SALEM, OREGON 97310

PHONE 378-3066 or  
1-800-452-7813  
(message line)

July 15, 1982

J.W. McCallister & Jett C. Blackburn  
771 Ponderosa Village  
Burns, OR 97720

Gentlemen:

REFERENCE: File G-10688

Your Application G-10688 describing the proposed use of 6.0 cubic feet per second of water from five wells for the irrigation of 360.0 acres, along with the accompanying map, has been reviewed.

It appears that certain lands will be irrigated from certain wells. The lands to be served by each well must be indicated.

The total quantity of water described by Item 6 is not in agreement with the total of the quantities described by your attachment. You should describe a total quantity of water, then describe the quantity to be appropriated from each well.

I am returning your application and map for correction and completion. Your application is endorsed so that in order to retain its priority date, it must be received in this office on or before September 15, 1982.

Sincerely,

Stephen C. Brown  
Senior Water Rights Examiner

SCB:tw  
enclosures

Resources Dept.  
13th St. N.E.  
Salem, Oregon 97310

**JETT BLACKBURN REAL ESTATE**

771 PONDEROSA VILLAGE  
BURNS, OREGON 97720  
(503) 573-7206

**SUBJECT** Water Rights **DATE** April 15, 1982

**M  
E  
S  
S  
A  
G  
E**

Enclosed please find our check in the amount of \$410.00 reflecting fees for water rights.

**RECEIVED**

If you have any questions please contact me.

APR 19 1982

Thank you.

**WATER RESOURCES DEPT  
SALEM, OREGON**

Application No. G-10688

Permit No.

Signed *Jett C. Blackburn* (Signature)  
DATE

**TO**

**R  
E  
P  
L  
Y**

\_\_\_\_\_  
\_\_\_\_\_  
\_\_\_\_\_

FOLD

Signed \_\_\_\_\_

**Reply Message**



## *Water Resources Department*

MILL CREEK OFFICE PARK

555 13th STREET N.E., SALEM, OREGON 97310

PHONE 378-3066

OR

1-800-452-7813

(message line)

J. W. McCallister and  
Jett C. Blackburn  
771 Ponderosa Village  
Burns, OR 97720

REFERENCE: File G-10688

We have received your application for use of water for irrigation along with the supporting data and fees. Our Receipt 30370 is enclosed. Your application has been filed and assigned number G-10688.

Because of the many applications which have been filed in recent months, we are temporarily behind in our processing. Your application will be examined in detail as soon as possible. We will contact you if we need any additional information. If a permit is required to satisfy the conditions of a loan or land sale or if other emergency conditions exist, please let us know and we will attempt to process your application in the shortest possible time.

After examining your application, a permit may be issued without further correspondence if no additional information is required and it does not conflict with existing rights. The proposed appropriation will be subject to the Water Policy Review Board's Basin Program Statements, existing minimum flows, and demands of prior rights during periods of low water.

Thank you for your patience.

Sincerely,

RALPH H. JACKSON  
Supervisor, Application/Permit Section  
Water Rights Division

RHJ:wpc  
enclosure  
0458B

COPY

Application No. G-10688  
Permit No.

WELL INFORMATION T-25-S R-31-E

Lines 1,2&4

1. 16" well 156' casing 550 gal/min 8' static level  
1335' south 410' west from NE corner sec. 9 within  
SE $\frac{1}{4}$  NE $\frac{1}{4}$  sec. 9.
2. 16" well 156' casing 350 gal/min 12' static level  
2635' south 680' west from NE corner sec. 9 within  
NE $\frac{1}{4}$  SE $\frac{1}{4}$  sec. 9.
3. 16" 168' casing 490 gal/min 6' static level 1310'  
north 1300' west from the SE corner sec. 9 within  
SE $\frac{1}{4}$  SE $\frac{1}{4}$  sec. 9.
4. 14" well 70' casing 650 gal/min 10' static level  
1300' north 800' east from the SE corner sec. 9.  
within SW $\frac{1}{4}$  SW $\frac{1}{4}$  sec. 10.
5. 12" well 130' casing 450 gal/min 12' static level  
2610' south 1280' west from NE corner sec. 9 with-  
in SE $\frac{1}{4}$  NE $\frac{1}{4}$  sec. 9.

lines 5

wells 1,2&3 was drilled by Jim Price of western  
water wells.

well 4 was drilled by J. M. Mc Callister

well 5 was drilled by an unknown driller.

**RECEIVED**  
SEP 15 1982  
WATER RESOURCES DEPT.  
SALEM, OREGON

**RECEIVED**  
APR 19 1982  
WATER RESOURCES DEPT  
SALEM, OREGON

**STATE OF OREGON WATER RESOURCES DEPARTMENT**  
**Application for a Permit to Appropriate Ground Water**

RECEIVED  
 APR 19 1982  
 WATER RESOURCES DEPT  
 SALEM, OREGON

I, J.W. McCallister & Jett Blackburn  
(Name of Applicant)

of 771 Ponderosa Village, Burns  
(Mailing Address) (City)

State of Oregon, 97720 Phone No. 573-7206 do hereby  
(Zip Code)

make application for a permit to appropriate the following described ground waters of the State of Oregon:

1. The development will consist of 5 wells see attached sheet  
(Give number of wells, tile lines, infiltration galleries, etc.)

having a diameter of ..... and an estimated depth of ..... feet.

2. The well or other source is to be located see attached sheet  
ft. and ft.  
(N. or S.) (E. or W.)

from the ..... corner of .....  
(Public Land Survey Corner)

(If there is more than one well, each must be described)

..... being within the ..... 1/4 of the ..... 1/4 of

Sec. .... Tp. .... R. ...., W. M., in the county of .....

3. Location of area to be irrigated, or place of use if use other than irrigation.

Township	Range	Section	List 1/4 1/4 of Section	List use and/or number of acres to be irrigated
T 25S	R 31 E	9	SW 1/4 NE 1/4	40
"	"	"	SE 1/4 NE 1/4	40
"	"	"	SE 1/4 NW 1/4	40
"	"	"	NE 1/4 SW 1/4	40
"	"	"	NE 1/4 SE 1/4	40
"	"	"	NW 1/4 SE 1/4	40
"	"	"	SE 1/4 SE 1/4	40
"	"	10	NW 1/4 SW 1/4	40
"	"	"	SW 1/4 SW 1/4	40
				360 ac.

Wells 1, 2 & 5

Wells 3 & 4

4. It is estimated that ..... see attached sheet, feet of the well will require ..... casing.  
(Kind)

5. Depth to water table is estimated ..... see attached sheet Well drilled by .....  
(Feet)

6. The amount of water which the applicant intends to apply to beneficial use is #1= 550 gpm, #2= 350 gpm, #3= 490 gpm cubic feet per second or 2490 gallons per minute. #4= 650 gpm, #5= 450 gpm

7. The use to which the water is to be applied is Irrigation

8. If the flow to be utilized is artesian, the works to be used for the control and conservation of the supply when not in use must be described.

NA

9. If the location of the well, or other development work is less than one-fourth mile from a natural stream channel, give the distance to the channel and the difference in elevation between the stream bed and the ground surface at the source of development.

NA

10. DESCRIPTION OF WORKS

Include length and dimensions of supply ditch or pipeline, size and type of pump and motor, type of irrigation system to adequately describe the proposed distribution system.

Wells # 1, 2 & 5 will be combined to irrigate 200 acres. The size of the pumps and mainline haven't been decided yet. 1350 gpm There will be 5 wheel lines for sure and possibly pivot.

Wells # 3 & 4 will be combined to irrigate 160 acres by wheel lines. 1140 gpm

11. Construction work will begin on or before 6-7-78

12. Construction work will be completed on or before 4-1-83

13. The water will be completely applied to the proposed use on or before 4-1-84

14. If the ground water supply is supplemental to an existing supply, identify the supply and existing water right.

Application No. G-10688

Permit No.



Remarks:.....  
.....  
.....  
.....  
.....  
.....  
.....

This permit, when issued, is for the beneficial use of water. By law, the land use associated with this water use must be in compliance with statewide land-use goals and any local acknowledged land-use plan. It is possible that the land use you propose may not be allowed if it is not in keeping with the goals and the acknowledged plan. Your city or county planning agency can advise you about the land-use plan in your area.

*John W. McAllister*  
Signature of Applicant  
*John Blake*

*This is to certify that I have examined the foregoing application, together with the accompanying maps and data, and return the same for.....correction and completion.....*

*In order to retain its priority, this application must be returned to the Water Resources Director with corrections on or before.....September 15....., 19.. 82.....*

WITNESS my hand this .....15th..... day of.....July....., 19.. 82.....

.....James E. Sexson..... Water Resources Director

By .....*Stephen C. Brown*.....  
Stephen C. Brown

**RECEIVED**  
SEP 15 1982  
WATER RESOURCES DEPT.  
SALEM, OREGON

*This instrument was first received in the office of the Water Resources Director at Salem, Oregon, on the .....19th..... day of .....April....., 19..82....., at .....8:15..... o'clock .....A.....M.....*

Application No.....*G-10688*..... Permit No.....

PC  
NCR

### Permit to Appropriate the Public Waters of the State of Oregon

This is to certify that I have examined the foregoing application and do hereby grant the same, SUBJECT TO EXISTING RIGHTS INCLUDING THE EXISTING MINIMUM FLOW POLICIES ESTABLISHED BY THE WATER POLICY REVIEW BOARD and the following limitations and conditions:

The right herein granted is limited to the amount of water which can be applied to beneficial use and shall not exceed 4.5 cubic feet per second measured at the point of diversion from the well or source of appropriation, or its equivalent in case of rotation with other water users, from wells #1

#2, #3, #4 and #5

The use to which this water is to be applied is irrigation being  
2.5 cfs from wells #1, 2, 5, & 2.0 cfs from wells #3 & 4

If for irrigation, this appropriation shall be limited to 1/80 of one cubic foot per second or its equivalent for each acre irrigated and shall be further limited to a diversion of not to exceed 3 acre feet per acre for each acre irrigated during the irrigation season of each year;

and shall be subject to such reasonable rotation system as may be ordered by the proper state officer.  
The well shall be constructed in accordance with the General Standards for the Construction and Maintenance of Water Wells in Oregon.

The works constructed shall include an air line and pressure gauge or an access port for measuring line, adequate to determine water level elevation in the well at all times.

The permittee shall install and maintain a weir, meter, or other suitable measuring device, and shall keep a complete record of the amount of ground water withdrawn.

The priority date of this permit is April 19, 1982

Actual construction work shall begin on or before ..... and shall thereafter be prosecuted with reasonable diligence and be completed on or before October 1, 19.....

Complete application of the water to the proposed use shall be made on or before October 1, 19.....

WITNESS my hand this ..... day of....., 19.....

PAH B