

T.3S. R.1W. Section 33, W.M.

OWRD

RECEIVED

JUL 06 2021

OWRD

Unnamed stream
to Willamette River

CERTIFIED WATER RIGHT EXAMINER
85503
Doann Hamilton
DOANN HAMILTON
MAY 10, 2012
STATE OF OREGON
EXPIRES: *June 30, 2023*

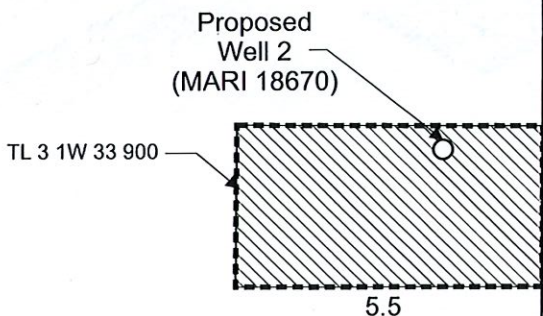

Proposed Well 2 (MARI 18670) is located 1,965 feet north and 215 feet west from the SE corner, Section 33.

 Area (5.5 Acres) to be irrigated.

 Tax lot boundary

Klupenger Rd NE

Burlington Northern Santa Fe

Arndt Rd NE

33 34
4 3

Scale: 1" = 400'

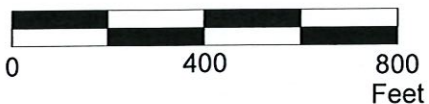

This map was prepared for the purpose of identifying the location of a water right only and is not intended to provide legal dimensions or location of property ownership lines.



Water Right Application Map

Pacific Hydro-Geology Inc.

06/2021

Katherine McBee
T.3S. R.1W. Section 33, W.M.