

RECEIVED

SECTION 1, T.26S. R.3W. W.M.
DOUGLAS COUNTY

JUL 30 1990

APPLICANT: ALAN BAUMAN
P.O. BOX 183
IDLEYLD PARK, OREGON 97447

WATER RESOURCES DEPT
SALEM, OREGON
CWRE: JAMES ARTMAN
P.O. BOX 576
WINSTON, OREGON 97496
(503) 679-7176

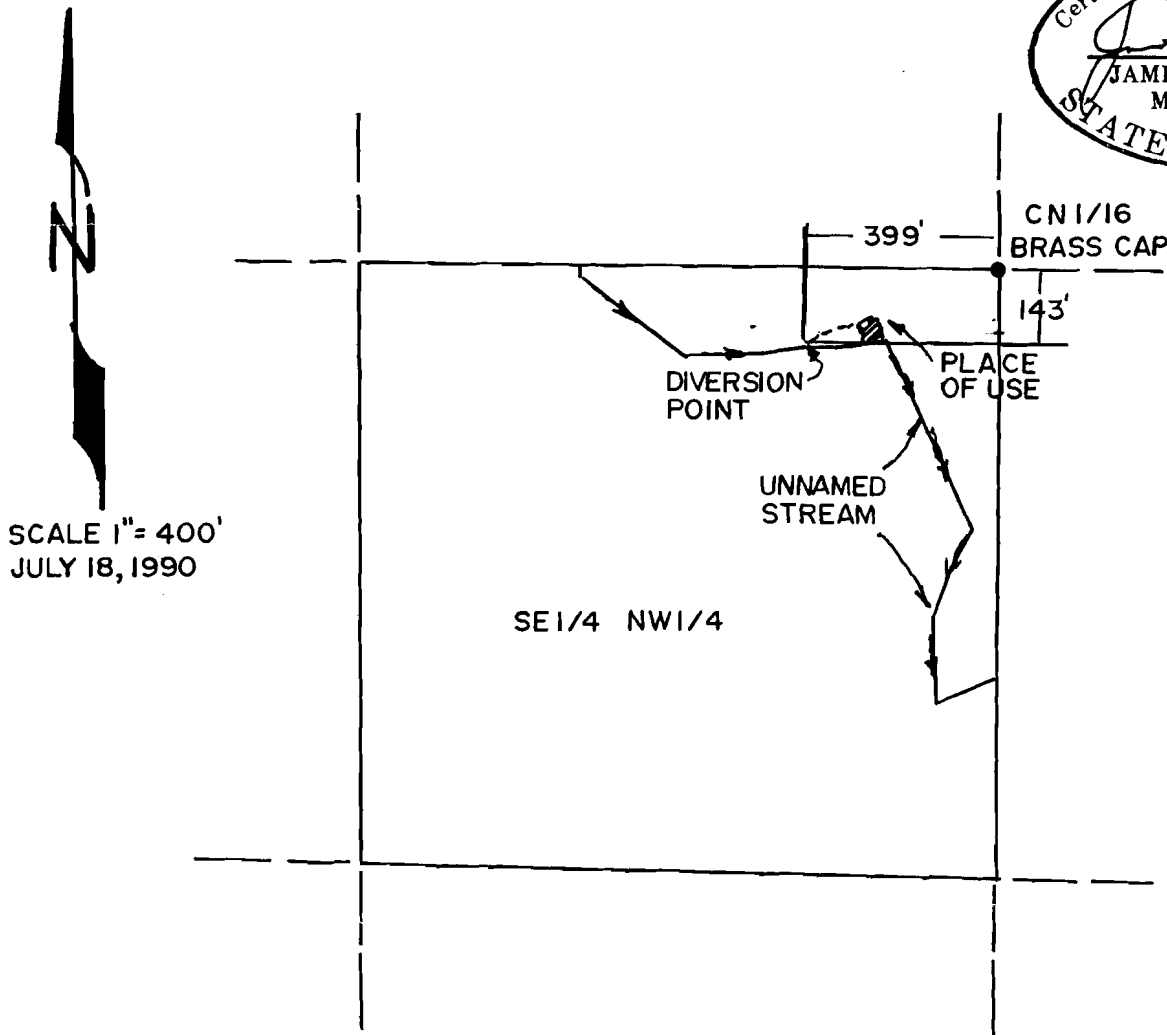
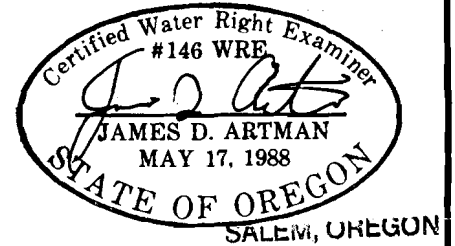

THIS MAP IS FOR THE PURPOSE OF IDENTIFYING THE LOCATION OF THE WATER RIGHT ONLY AND IS NOT INTENDED TO PROVIDE LEGAL DIMENSIONS OR LOCATIONS OF PROPERTY LINES.

APPLICATION: R. 70530
PERMIT: R11615

RECEIVED

FEB - 2 1998

WATER RESOURCES DEPT.
SALEM, OREGON

THIS MAP TO ACCOMPANY SEPARATE APPLICATION