

Name E. B. Ridgway  
 By Rte. 3, Box 145  
 Address Newberg, Oregon  
 Date filed Oct. 21, 1929  
 Action suspended until \_\_\_\_\_

Returned to applicant \_\_\_\_\_  
 Date completed \_\_\_\_\_  
 Date of approval 11-6-29

**CONSTRUCTION**  
 Date for beginning 11-6-30  
 Date for completion 10-1-31  
 Extended to 10/1/32 10/1/33  
 Date for application of water 10-1-32  
 Extended to 10/1/33

**PROSECUTION OF WORK**  
 Form "A" filed Nov. 21, 1930 (letter)  
 Form "B" filed \_\_\_\_\_  
 Form "C" filed \_\_\_\_\_

**FINAL PROOF**  
 Blank mailed Nov. 4, 1933  
 Proof received November 21, 1933  
 Date certificate issued Feb. 27, 1934  
 Receipt for recording fee No. 16853 for 1.00

Application No. 13082  
 Permit No. 9320  
 Certificate No. 10648

Stream Index, Page No. 2 p. 45 p  
 Application Record, Book No. \_\_\_\_\_

FEES PAID		
Date	Amount	Receipt No.
<u>10/21/29</u>	<u>14.50</u>	
Total		

FEES REFUNDED		
Date	Amount	Check No.

ASSIGNMENTS				
Date	To whom	Address	Volume	Page

**REMARKS**  
0.1 sec. ft. from unnamed Springs for irr. 2.5 acres + Domestic  
11-10-30 - Card for A  
10-28-31 - Card for B  
11-15-32 - Cards for B & C  
11-3-33 - Card for B and C.  
  
O. K. for Certificate

# Oregon Water Resources Department



State of Oregon  
**Water Resources Department**  
 158 12th Street NE, Salem, OR 97310  
 1(800)624-3199 • (503)378-8455  
 www.wrd.state.or.us

## Fax Transmittal

TO: BRENT ODF

FAX: 503-357-4548 DATE: Tu. 2-20-2001 PAGES: 4

FROM: 800624 3199 RESEARCH DIV # 201

COMMENTS:

THIS WORK RELATED FROM  
KEN DOWDEN

QUESTIONS CONTACT ROGER

COPIES OF WR CORP # 10648

OR	DATE	TIME	AM	PM
	TUES	2-20		
FROM	BRENT O'NEALE			
TO	BRE GRU.			
PHONE NUMBER	(503) - 357 - 1700			
FAX NUMBER	503 - 357 - 4548			
MOBILE NUMBER				
AREA CODE	503			
TIME TO CALL				
TELEPHONED	<input checked="" type="checkbox"/>	PLEASE CALL	<input checked="" type="checkbox"/>	
RETURNED YOUR CALL	<input type="checkbox"/>	WILL CALL AGAIN	<input type="checkbox"/>	
CAME TO SEE YOU	<input type="checkbox"/>	RUSH	<input type="checkbox"/>	13082
WANTS TO SEE YOU	<input type="checkbox"/>	SPECIAL ATTENTION	<input type="checkbox"/>	
WAITING TO SEE YOU	<input type="checkbox"/>	HOLDING LINE	<input type="checkbox"/>	
MESSAGE	KEN DOWDEN 10648			
	LOGGING HE W/ ME //			
	FORGETRY			
	353W ①			
SIGNED	TOPS MADE IN U.S.A.			
	FAXED MESSAGE			

- Water Services
- Water Rights & Adjudications
  - Water Rights Information
  - Adjudications
  - Hydroelectric
  - Certificates/Final Proofs
  - Hearings/Contested Cases
- Northwest Region
  - District 16 Watermaster
  - Transfers

FAX: 503-378-6203

190

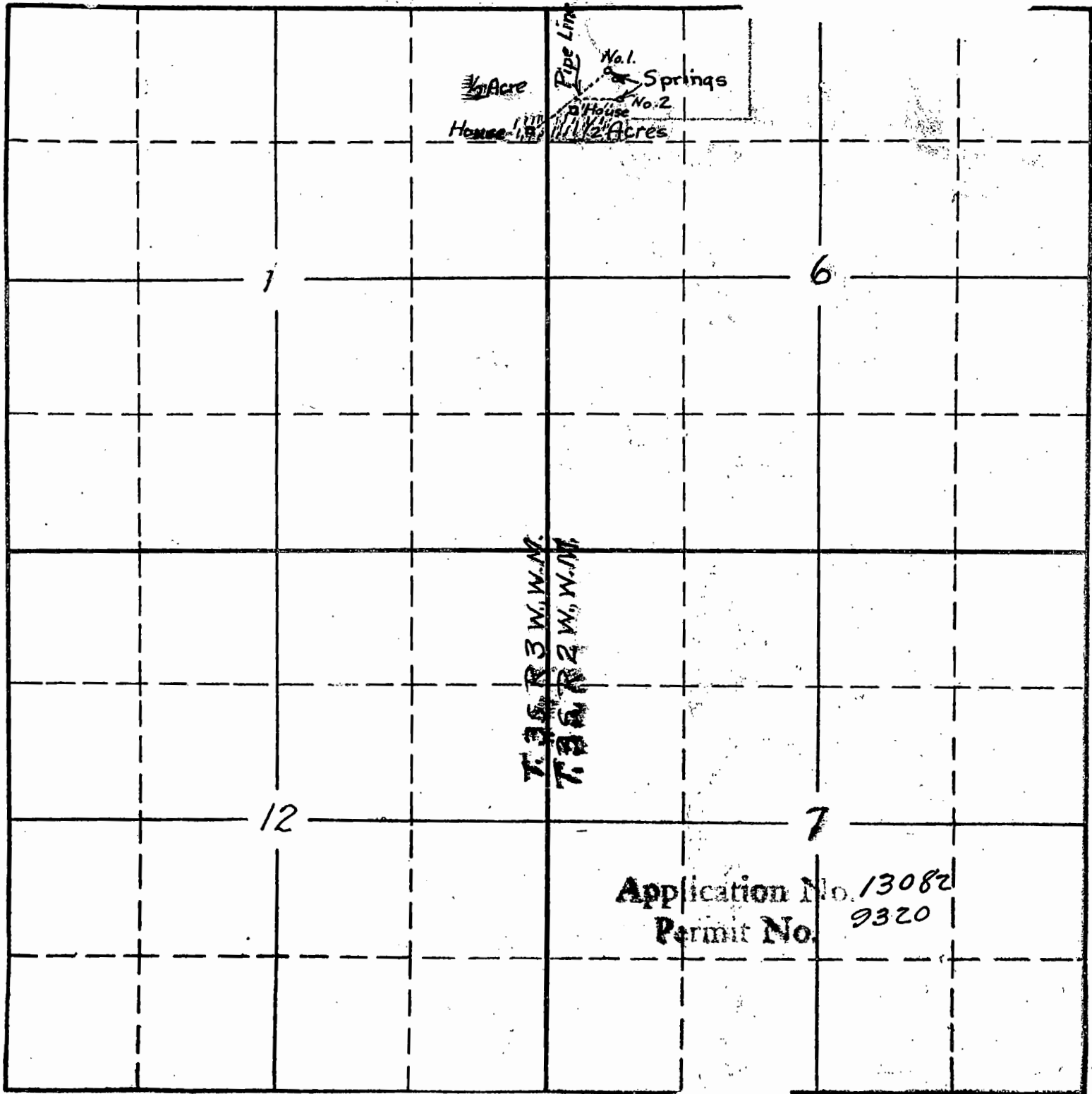

Sec. \_\_\_\_\_  
 \_\_\_\_\_  
 \_\_\_\_\_  
 Tp. 3 S  
 R. 2 W

T. 3 S  
 R. 3 W, W.M.  
 T. 3 S  
 R. 2 W, W.M.

Application No. 13082  
 Permit No. 9320

~

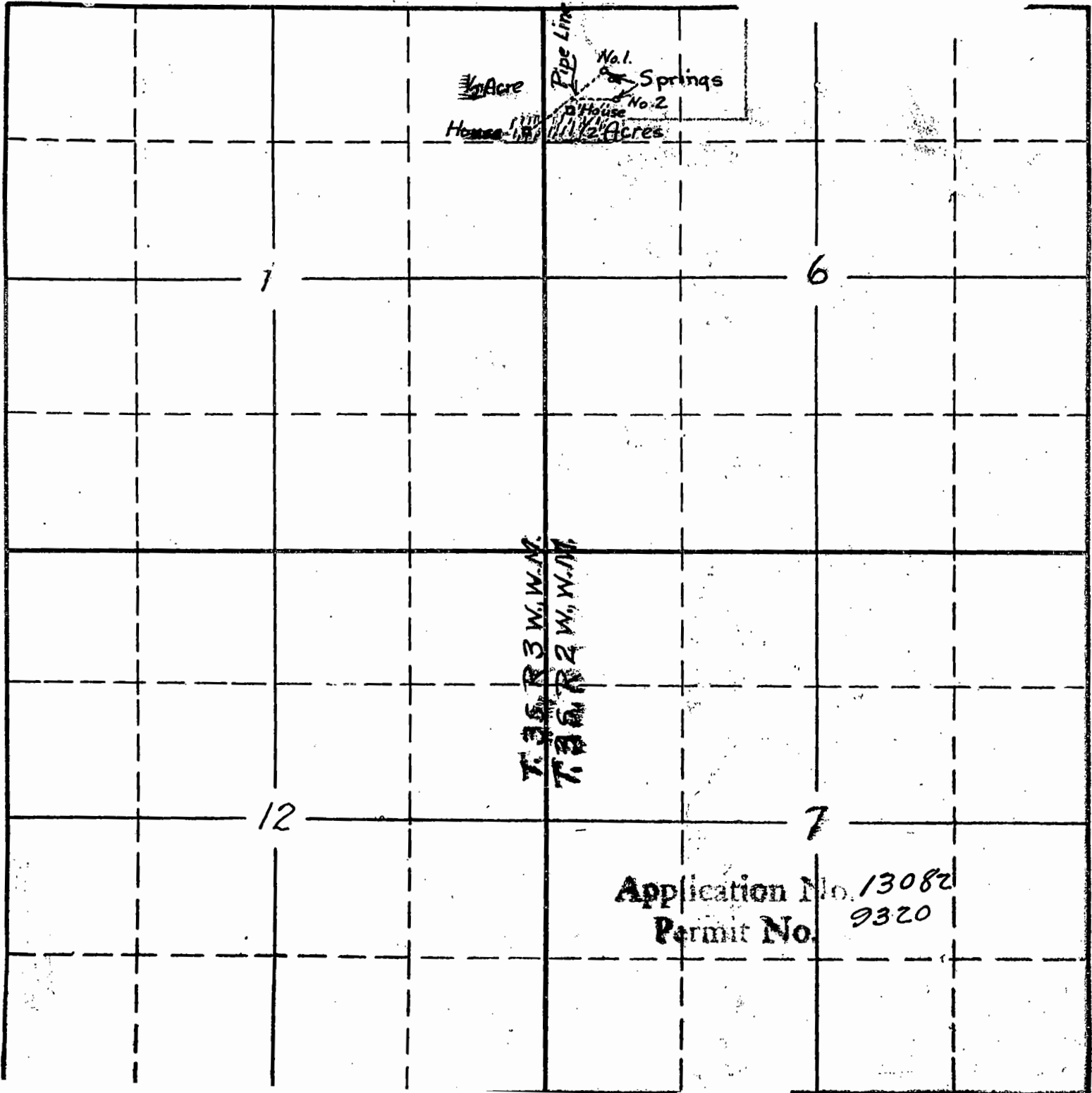

Sec. \_\_\_\_\_  
Tp. 3 S  
R. 2 W

*u*

Application No. 13082  
Permit No. 9320

Sec. \_\_\_\_\_  
\_\_\_\_\_  
\_\_\_\_\_

Tp. 3 5  
R 2 and 3 W

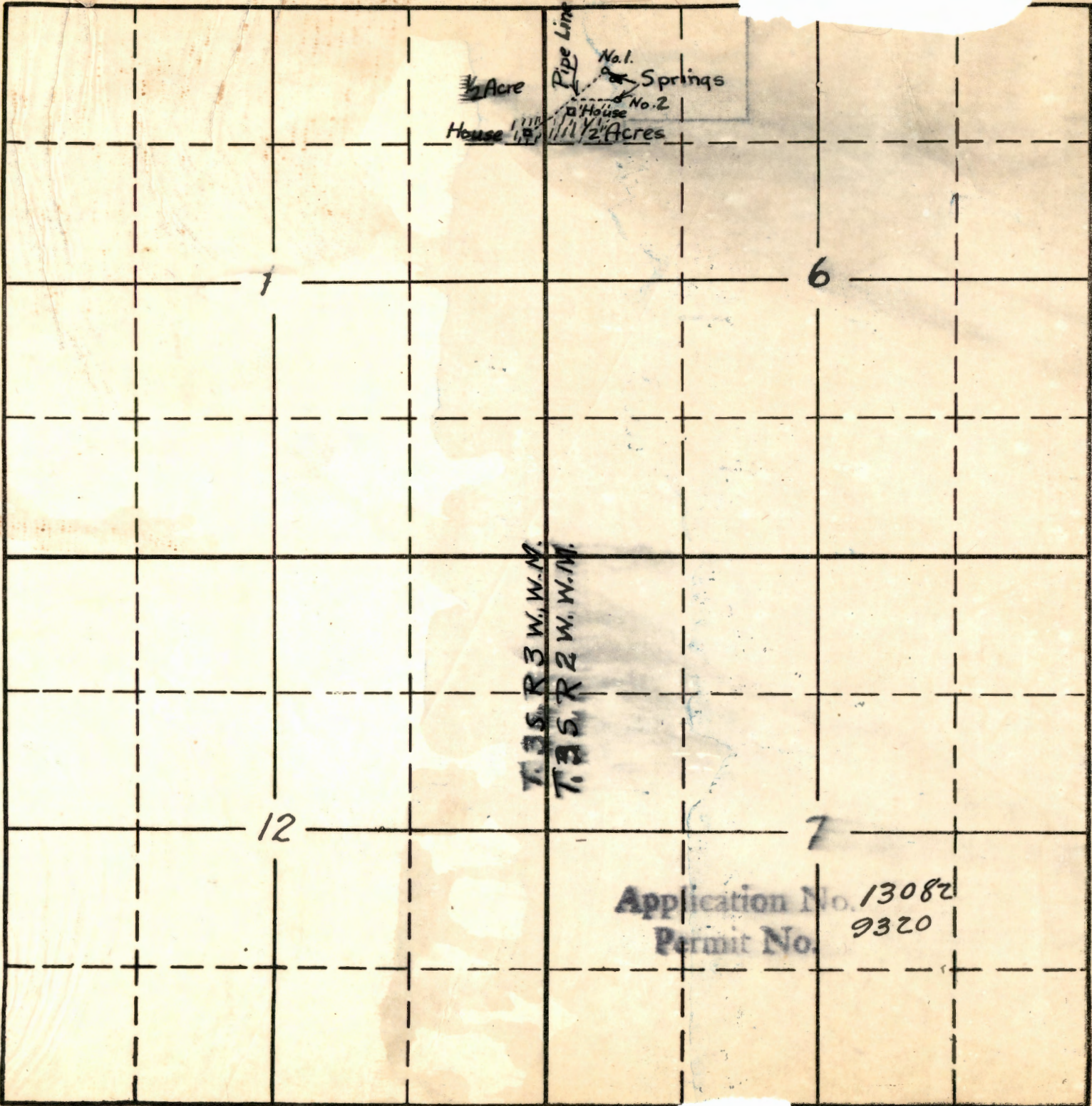

1/2 Acre

House

Pipe Line

No. 1 Springs

No. 2 House  
1/2 Acres

1

6

T. 3 S. R. 3 W. W. M.  
T. 3 S. R. 2 W. W. M.

12

7

Application No. 13082  
Permit No. 9320

u



DESCRIPTION OF WORKS

9. (a) If a dam has been constructed, give description: Height, 3 ft.; length on top, 8 ft.;

length on bottom 8 ft.; material used and character of construction,

Concrete

(b) Give description of headgate: Width, ft.; depth, ft.; material used and character of construction,

Storage tank - 6' square and 5' deep - of concrete

(c) Size of canal: Width on top (at waterline) ft.; width on bottom, ft.; depth of water, ft.; grade, ft. fall per 1,000 ft. Actual capacity, sec.-ft.

Give general description:

(d) Pipe line: Description of intake,

Length of pipe 1500 ft.; size at intake, 3 in.; size at 1000 ft. from intake, 3/4 in.; size at place of use, 1/2 in. Difference in elevation between intake and place of use, 150 ft.

Is grade uniform? Yes Actual capacity of pipe line, sec.-ft.

Give general description:

Galv. iron

(Material: Steel, wrought, cast iron, wood stave, etc.)

(e) Pumping plant: Give size and type of pump,

Suction lift, ft.; discharge lift, ft. Type of motor used

Horse power rating, H. P. Actual capacity of pump, sec.-ft.

10. During what months is water beneficially used

All year for domestic

11. State character of soil

fine to medium for irrigation

Kind of crops raised

12. Does the accompanying map, filed with your application, show correctly the point of diversion, area of land irrigated, or place of use? Yes

13. If not, wherein is such map in error?

14. Domestic use: Give number of families actually using water at this time 1

15. If for power, mining, municipal, manufacturing, storage or any other purpose than irrigation, give extent and method of such use

AFFIDAVIT OF APPROPRIATOR

STATE OF OREGON,

County of Marion } ss.

E. B. Ridgway

I, E. B. Ridgway, being first duly sworn, depose and say that I have read the above and foregoing proof of appropriation of water; that I know the contents thereof, and that the facts therein stated are true.

IN WITNESS WHEREOF, I have hereunto set my hand this 4th day of November, 1933.

E. B. Ridgway

Subscribed and sworn to before me this 4th day of Nov, 1933

W. T. Hauke

Notary Public for Oregon

[NOTARIAL SEAL]

My commission expires April 1st 1934

AFFIDAVIT OF WITNESSES

STATE OF OREGON,

County of Yamhill } ss.

We, E. L. Manzingo, and Mrs. Etta Parry

of \_\_\_\_\_, being first duly sworn, depose and say that

we are well acquainted with the facts and conditions set forth in the foregoing statement relative to proof of appropriation of water under Permit No. 9320; that we and each of us have been over and upon each tract described in said proof, and from such personal inspection have knowledge that all necessary ditches, dams and other diversion and distributing works have been constructed, and water used as stated therein; that we have carefully read such proof of appropriation, and that each and every statement contained therein is true to the best of our knowledge and belief.

E. L. Manzingo  
Mrs. Etta Parry

Subscribed and sworn to before me this 18th day of November, 1933

Low Syrdall

Notary Public for Oregon

[NOTARIAL SEAL]

My commission expires February 22, 1936



REPORT OF PERSON MAKING INSPECTION

(For use by representative of State Engineer)

I, \_\_\_\_\_, do hereby certify that I have made an inspection of the works described herein and in Permit No. \_\_\_\_\_, on the \_\_\_\_\_ day of \_\_\_\_\_, 193\_\_\_\_, and found the foregoing statements and descriptions of works to be accurate. In my opinion the appropriation has been completed to the extent of \_\_\_\_\_ (Quantity of water in second-feet or acre-feet) and I recommend the issuance of a water right certificate for this amount.

NOTE TO INSPECTORS

If conditions do not justify the above report by you, please return the proof without your signature, with a full report by letter.

ment contained therein is true to the best of our knowledge and belief. stated that we have read such proof of appropriation and (Name) each and every state and distributing works have been constructed, and water used as proof of appropriation of water under Permit No. \_\_\_\_\_ that we and each of us have been over and we are well acquainted with the facts and conditions set forth in the foregoing statement relative to of \_\_\_\_\_ being that duly sworn, depose and say that

PROOF OF APPROPRIATION

Permit No. \_\_\_\_\_

Recording fee paid

Receipt No. \_\_\_\_\_

RECEIVED NOV 21 1933

STATE ENGINEER SALEM, OREGON

We, \_\_\_\_\_

County of \_\_\_\_\_

STATE OF OREGON

[NOTARIAL SEAL]

Subscribed and sworn to before me this \_\_\_\_\_ day of \_\_\_\_\_, 1933

IN WITNESS WHEREOF, I have hereunto set my hand this \_\_\_\_\_ day

know the contents thereof, and that the facts therein stated are true. depose and say that I have read the above and foregoing proof of appropriation of water; that I

I, \_\_\_\_\_, being that duly sworn,

County of \_\_\_\_\_

STATE OF OREGON

VERIDVAIL OF APPROPRIATOR

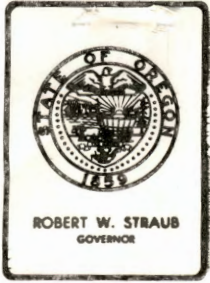

## Water Resources Department

1178 CHEMEKETA STREET N.E., SALEM, OREGON 97310 PHONE 378-3066

February 1, 1977

13082

Clarence D. Billette  
Rt. 1 Box 136  
Newberg, OR 97132

Dear Mr. Billette:

The certificate of water right issued to E. B. Ridgway recorded at Page 10648, State Record of Water Right Certificates evidenced the right to the use of 0.1 cubic foot of water per second from unnamed springs for domestic supplies and irrigation of 2.0 acres with a date of priority of October 21, 1929. The location of the house and acreage where the right is appurtenant is as illustrated on the enclosed map. According to the map, the house supplied water is located in the NE $\frac{1}{4}$  NE $\frac{1}{4}$  of Section 1, Township 3 South, Range 3 West, W. M.

The above described water right is appurtenant to the place of use where the right was established, passes with the land through change of ownership, and remains valid so long as it is not lost through non-use for any five successive years. If a portion of the right has not been used for five successive years, that portion would be lost.

I am enclosing the proper application form that you may complete and submit for applying for the use of surface waters for some beneficial use. Also enclosed is our booklet of rules and regulations relative to the appropriation and use of surface water. Permits will be issued for the use of water from Chehalem Creek and its tributaries with the understanding that water may not be available during the dry periods of the irrigation season. The available water may be needed to satisfy existing rights.

If you have a right of record for the use of water from the springs and if you believe wells in the area are reducing the water available from the springs, you may contact this office. An investigation by representatives of this office would be necessary to determine if the use from wells reduces the amount of water at the springs.

Sincerely,

Wayne J. Overcash  
Water Rights Engineer

RECEIVED

JAN 27 1977

WATER RESOURCES DEPT.  
SALEM, OREGON

CLARENCE D. BILLETTE

RT 1 Box 136

NEWBERG, OREGON

97132

DEAR SIR:

I AM CURRENTLY THE OWNER OF A PARCEL OF PROPERTY WHICH HAS SEVERAL SPRINGS ON IT. THESE SPRINGS ARE CURRENTLY BEING USED BY MY FAMILY FOR DOMESTIC AND IRRIGATION PURPOSES. THEY ARE SUPPLYING DOMESTIC FOR TWO HOMES AND IRRIGATION FOR EIGHT ACRES OF ALFALFA AND THREE OR FOUR ACRES OF PASTURE.

THERE WAS A WATER RIGHT ISSUED TO MY GREAT GRAND FATHER E.B. RIDGWAY. PERMIT # 9320. IT IS RECORDED IN THE RECORD OF STATE WATER RIGHT CERTIFICATES, VOLUME 10, PAGE 10648.

I WOULD LIKE TO GET A NEW WATER RIGHT ISSUED TO REFLECT CURRENT WATER USAGE. I NEED TO KNOW WHAT PAPER WORK TO SUBMIT TO YOU TO GET THIS CHANGED. COULD YOU PLEASE SEND ME THE NECESSARY FORMS & INSTRUCTIONS. THANK YOU.

THERE HAS BEEN A LOT OF WELL DRILLING GOING ON IN OUR IMMEDIATE AREA. DO WE HAVE ANY RECORDS IF SOMEONE'S WELL REDUCES THE WATER AVAILABLE FROM THE ABOVE MENTIONED SPRINGS?

THANK YOU

Clarence D. Billett

CHAS. E. STRICKLIN, STATE ENGINEER  
SECRETARY  
STATE RECLAMATION COMMISSION  
HYDROELECTRIC COMMISSION OF OREGON

# STATE OF OREGON

OFFICE OF THE

## STATE ENGINEER

WATER RESOURCES DEPARTMENT

SALEM

ADDRESS ALL COMMUNICATIONS  
CHAS. E. STRICKLIN, STATE ENGINEER  
SALEM, OREGON

AND REFER TO  
FILE NO. 13082

November 22, 1933

Mr. E. B. Ridgway  
Route 3, Box 145  
Newberg, Oregon

Dear Sir:

This acknowledges receipt of the final proof of appropriation of water under your Permit No. 9320.

The proof appears to be acceptable in all respects with the exception that you failed to remit the statutory fee of \$1.00 for recording the water right certificate in the county records. This fee must be paid before a certificate can be issued. Upon receipt of your remittance in the above amount, the matter of confirming your right by the issuance of a water right certificate will be given consideration.

Very truly yours

CHAS. E. STRICKLIN  
State Engineer

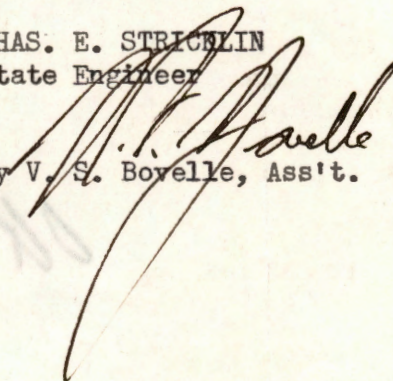
  
By V. S. Bovellev, Ass't.

EL

RECEIVED  
DEC 12 1933  
STATE ENGINEER  
SALEM, OREGON

RECEIVED  
DEC 12 1933  
STATE ENGINEER  
SALEM, OREGON

Newberg Ore. Dec 11-23.  
C. E. Stricklin

Dear Sir,

enclosed please find  
one dollar (\$1.) as per  
your request.

Yours

E. B. Ridgway

RECEIVED  
DEC 12 1933  
STATE ENGINEER  
SALEM, OREGON

This acknowledges receipt of the final  
proof of appropriation of water under your permit  
No. 2820.  
The proof appears to be acceptable in  
all respects with the exception that you failed to  
rent the statutory fee of \$1.00 for recording the  
water right certificate in the county records. This  
fee must be paid before a certificate can be issued.  
Upon receipt of your remittance in the above amount,  
the matter of confirming your right by the issuance  
of a water right certificate will be given considera-

Very truly yours

CHAS. E. STRICKLIN  
State Engineer

By V. S. Boveille, Ass't.

OK for [unclear]

November 22, 1933

Mr. E. B. Ridgway  
Route 3, Box 145  
Newberg, Oregon

Dear Sir:

This acknowledges receipt of the final proof of appropriation of water under your Permit No. 9320.

The proof appears to be ~~is~~ acceptable in all respects with the exception that you failed to remit the statutory fee of \$1.00 for recording the water right certificate in the county records. This fee must be paid before a certificate can be issued. Upon receipt of your remittance in the above amount, the matter of confirming your right by the issuance of a water right certificate will be given consideration.

Very truly yours

CHAS. E. STRICKLIN  
State Engineer

By V. S. Bovelie, Ass't.

EL

November 23, 1932.

Mr. E. B. Ridgway,  
Newberg,  
Oregon.

Dear Sir:

This acknowledges receipt of your letter of November 21, in which you request an extension of time for the completion of construction work and complete application of water to the proposed use under your Permit No. 9320.

Your letter indicates that you have shown reasonable diligence in the prosecution of work under this permit and I am, therefore, extending these time limits of another year or until October 1, 1933. I trust you will be able to complete your project within these new time limits.

Very truly yours

CHAS. E. STRICKLIN  
State Engineer

By V. S. Bovelie, Ass't.

EL

13088

Newberg Ore. 11-21-32.

M. C. & Stricklin

State Engineer

Dear Sir; Your notice  
rec'd. Will say in reply  
that I intend to complete  
my work on number 9320

I was successful only a short  
time ago in securing the  
piping - hope to have it  
connected ready for next  
summers irrigation -

I used the water last summer  
by open ditch to place of irri-  
gation

Please extend my time  
until March 1, - 33. that will  
give me time this winter to  
finish the job.

Extend

Respectfully  
E. B. Midgway



STATE ENGINEER  
RECEIVED

November 5, 1931.

Mr. E. B. Ridgway,  
Newberg, Oregon.

Dear Sir:

This will acknowledge receipt of your letter of November 3rd in which you request an extension of time for the completion of construction under your Permit No. 9320 until October 1, 1932, and with which you forwarded your receipt No. 10885.

Your letter indicates that you have shown reasonable diligence in the prosecution of work under this permit, and I am therefore extending the time for completion of construction until October 1, 1932, which date conforms with the time limit for the complete application of water.

I note you ask if it will be satisfactory to make final proof upon only one of the sources of appropriation since one spring has gone dry. I believe that this will be entirely satisfactory, and you may make whatever changes are necessary when submitting your final proof of the appropriation.

Your receipt is being returned herewith.

Very truly yours,

CHAS. E. STRICKLIN,  
State Engineer.

By  
V. S. Bovelie, Ass't.

VSB:LN  
Encl.

Mr. Chas. E. Stricklin, State Engineer

Salem, Oregon.

NOV 9 1931  
SALEM, OREGON

Dear Sir - This is to notify you that I have done construction work on the Spring to the amount of Sixty Dollars \$60.00 or more. Concreting spring and a good reservoir; hope to be able to complete the pipe line to the house and places I wish to irrigate before Oct 6, 1932.

One spring - South of the main spring has ceased to flow, so I do not believe it is worth while to do anything with it. I wish it could be so understood if you please, with you.

I expect to put in piping large enough to carry practically all the stream.

I hope this will be O.K. with you

Yours  
E. B. Ridgway  
~~7-27-31~~

I am sending  
Statement - I find I have  
not the No. 9320 i. e. I am not  
able to find same -

So may be you can check  
upon the affair by this

Please return to me  
when you have done  
with it -

Truly Yours

E. B. Ridgway

November 21, 1930.

Mr. E. B. Ridgway,  
Newberg,  
Oregon.

Dear Sir:

It is my opinion after reading your letter dated November 20th that the work you have done on your spring is sufficient to be considered beginning of construction under Permit No. 9320. Your letter is being considered as satisfactory notice and the usual form will not be required.

According to the terms of the permit you have until October 1, 1931 to complete construction and until October 1, 1932 to make complete application of water.

Yours very truly,

CHAS. E. STRICKLIN,  
State Engineer

By  
Office Assistant.

LAS:L

Newberg Ore Nov 20-30

THE ENGINEER  
RECEIVED  
NOV 21 1930  
SALEM, OREGON

Chas. E. Stricklin

State Engineer

Salem Ore.

Dear Sir - Your notice of permit  
No. 9320, sent me some days ago  
received - Will say on account  
of a shortage of money I delayed  
piping springs with new pipe  
however I made certain improvement  
on spring by squaring up walls and  
deepening & getting ready for cement  
walling - The Blank of which  
I am satisfied has become mislaid  
I am very sorry - because I fully in-  
tend to do all that is required by  
law on the springs - I irrigated  
about one acre - this last summer.

Can you not yet extend the time  
until I can do the work?

Hoping you can get help out  
and begging your pardon for  
this delay.

Permit  
9320

I am

E. B. Ridgway

Newberg Ore.

November 15, 1923

Mr. E. B. Ridgway,  
Route 5, Box 145,  
Newberg, Oregon.

Dear Sir:

Herewith you will find Application No. 18082, being  
Permit No. 9320, together with blue print.

The application has been approved and recorded in this  
office.