

**STATE OF OREGON  
WATER RESOURCES DEPARTMENT**

725 Summer St. N.E. Ste. A

SALEM, OR 97301-4172

(503) 986-0900 / (503) 986-0904 (fax)

RECEIPT # **136524**

INVOICE # \_\_\_\_\_

RECEIVED FROM: Wilson Cattle Company  
BY: \_\_\_\_\_

APPLICATION	<u>1-7885</u>
PERMIT	
TRANSFER	

CASH:  CHECK:# 53003 OTHER: (IDENTIFY)

TOTAL REC'D \$ 230.00

<b>1083 TREASURY</b>	<b>4170 WRD MISC CASH ACCT</b>	
0407 COPIES		\$
OTHER: (IDENTIFY)		\$
0243 I/S Lease	0244 Muni Water Mgmt. Plan	0245 Cons. Water

<b>4270 WRD OPERATING ACCT</b>		
MISCELLANEOUS	<u>46111</u>	
0407 COPY & TAPE FEES		\$
0410 RESEARCH FEES		\$
0408 MISC REVENUE: (IDENTIFY)		\$
TC162 DEPOSIT LIAB. (IDENTIFY)		\$
0240 EXTENSION OF TIME		\$
WATER RIGHTS:		
0201 SURFACE WATER	EXAM FEE \$	0202 RECORD FEE \$
0203 GROUND WATER	\$	0204 \$
0205 TRANSFER	\$	
WELL CONSTRUCTION		
0218 WELL DRILL CONSTRUCTOR	EXAM FEE \$	0219 LICENSE FEE \$
LANDOWNER'S PERMIT		0220 \$
<u>0200</u> OTHER (IDENTIFY) <u>COBU</u>		<u>\$230.00</u>

<b>0536 TREASURY</b>	<b>0437 WELL CONST. START FEE</b>	
0211 WELL CONST START FEE	\$	CARD#
0210 MONITORING WELLS	\$	CARD#
OTHER (IDENTIFY)		

<b>0607 TREASURY</b>	<b>0467 HYDRO ACTIVITY</b>	LIC NUMBER
0233 POWER LICENSE FEE (FW/WRD)		\$
0231 HYDRO LICENSE FEE (FW/WRD)		\$
HYDRO APPLICATION		\$

<b>TREASURY</b>	<b>OTHER / RDX</b>	
FUND	TITLE	
OBJ. CODE	VENDOR #	
DESCRIPTION		\$

RECEIPT: **136524** DATED: 10-1-2021 BY: Mindy Cordson

# CLAIM OF BENEFICIAL USE for Transfer with Multiple Changes – Surface Water



Oregon Water Resources Department  
725 Summer Street NE, Suite A  
Salem, Oregon 97301-1266  
(503) 986-0900  
[www.oregon.gov/OWRD](http://www.oregon.gov/OWRD)

A fee of \$230 must accompany this form for any Transfer final orders including a water right with a priority date of July 9, 1987, or later.

Example – A transfer involves 5 rights and one of the rights has a priority date of July 9, 1987, or later, the fee is required.

RECEIVED

SEP 22 2021

OWRD

A separate form shall be completed for each transfer.

This form is subject to revision. **Begin each new claim** by checking for a new version of this form at:  
<https://www.oregon.gov/OWRD/Forms/Pages/default.aspx>

The completion of this form is required by OAR 690-014-0100(1) and 690-014-0110(4).

Please type or print in dark ink. If this form is found to contain errors or omissions, it may be returned to you. **Every item must have a response.** If any requested information does not apply to the claim, insert "NA." **Do not delete or alter any section of this form unless directed by the form.** The Department may require the submittal of additional information from any water user or authorized agent.

"Section 8" of this form is intended to aid in the completion of this form and should not be submitted.

A claim of beneficial use includes both this report and a map. If the map is being mailed separately from this form, please include a note with this form indicating such.

If you have questions regarding the completion of this form, please call 503-979-9103.

The Department has a program that allows it to enter into a voluntary agreement with an applicant for expedited services. Under such an agreement, the applicant pays the cost to hire additional staff that would not otherwise be available. This program means a certificate may be issued in about a month. For more information on this program see:

<https://www.oregon.gov/OWRD/programs/WaterRights/RA/Pages/default.aspx>

## SECTION 1

### GENERAL INFORMATION

#### Type of Authorized Change

This Claim is being submitted for a transfer involving multiple changes.

YES  NO

Mark all that apply:

1.  Change in POD(s) or Additional POD(s)
2.  Change in Place of Use
3.  Change in Character of Use
4.  Change in Character of Use – Reservoir

*A separate section will be completed for each type of change authorized in the transfer final order.*

1. File Information

APPLICATION # <b>T-7885</b>
--------------------------------

2. Property Owner (current owner information)

APPLICANT/BUSINESS NAME <b>Zach Wilson/Wilson Family Ranches LLC</b>		PHONE NO. <b>541-519-0132</b>	ADDITIONAL CONTACT NO.
ADDRESS <b>PO Box 209</b>			
CITY <b>North Powder</b>	STATE <b>OR</b>	ZIP <b>97867</b>	E-MAIL <b>zach@beefnw.com</b>

If the current property owner is not the transfer holder of record, it is recommended that an assignment be filed with the Department. ***Each transfer holder of record must sign this form.***

3. Transfer holder of record (this may, or may not, be the current property owner)

TRANSFER HOLDER OF RECORD <b>Wilson Family Ranches LLC</b>			
ADDRESS <b>PO Box 209</b>			
CITY <b>North Powder</b>	STATE <b>OR</b>	ZIP <b>97867</b>	

4. Date of Site Inspection:

<b>08/04/21</b>
-----------------

5. Person(s) interviewed and description of their association with the project:

NAME	DATE	ASSOCIATION WITH THE PROJECT
<b>James Simon</b>	<b>08/04/21</b>	<b>Wilson Ranch Employee</b>

6. County:

<b>Baker - South of the N. Powder River, Union - North of the N. Powder River</b>
---

7. If any property described in the place of use of the transfer final order is excluded from this report, identify the owner of record for that property (ORS 537.230(5)):

OWNER OF RECORD			
ADDRESS			
CITY	STATE	ZIP	

Add additional tables for owners of record as needed



RECEIVED

SEP 22 2021

OWRD

SECTION 2  
SIGNATURES

CWRE Statement, Seal and Signature

The facts contained in this Claim of Beneficial Use are true and correct to the best of my knowledge.

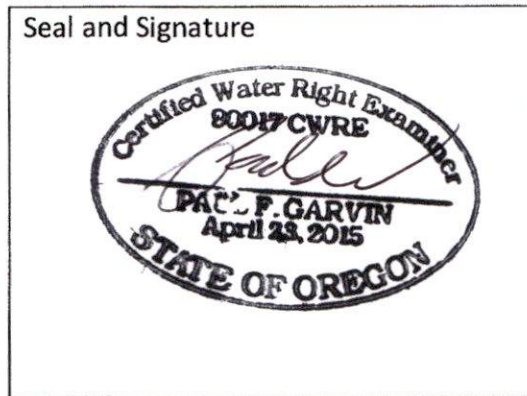

CWRE NAME <b>Paul F. Garvin</b>		PHONE NO. <b>503-347-7188</b>	ADDITIONAL CONTACT NO.	
ADDRESS <b>1705 Main St. Ste. 101</b>				
CITY <b>Baker City</b>	STATE <b>OR</b>	ZIP <b>97814</b>	E-MAIL <b>Garvin.hydrogeo@gmail.com</b>	

Transfer Holder of Record Signature or Acknowledgement

***Each*** transfer holder of record must sign this form in the space provided below.

The facts contained in this Claim of Beneficial Use are true and correct to the best of my knowledge. I request that the Department issue a water right certificate.

SIGNATURE	PRINT OR TYPE NAME	TITLE	DATE
	John Zuberg Wilson	Wilson Family Ranches LLC Representative	9/14/2021

**SECTION 3**  
**Changes Made**

**OWRD**

**Note: The Claim only needs to describe the changes that were authorized in the transfer final order.**

**Change #1**

**New or Additional Point of Diversion**

**Change in POD(s) or Additional POD(s)**

Did the transfer order authorize a change in the points of diversion or additional points of diversion?

YES  NO

*If "NO", this Section can be deleted.*

**1. New or additional point of diversion name or number:**

POINT OF DIVERSION (POD) NAME OR NUMBER (CORRESPOND TO MAP)	SOURCE
<b>POD 1 aka Daly Ditch (ADDITIONAL)</b>	<b>North Powder River</b>
<b>POD 2 aka Davis Dalton Ditch (MOVED)</b>	<b>North Powder River</b>
<b>POD 3 aka Davis-Kelsey Ditch aka Wilson Ditch (MOVED)</b>	<b>North Powder River</b>

**2. Variations:**

Was the use developed differently from what was authorized by the transfer final order, or extension final?

YES   NO

If yes, describe below.

*(e.g. "The order allowed three new/additional points of diversion. The water user only developed one of the points.")*

**POD 1 (Daly Ditch) is the additional POD, the locations of PODs 2 and 3 were moved as per the T-7885 FO.**

**3. Claim Summary:**

NEW OR ADDITIONAL POD NAME OR #	MAXIMUM RATE AUTHORIZED IN ORDER	CALCULATED THEORETICAL RATE BASED ON SYSTEM	AMOUNT OF WATER MEASURED
<b>POD 1</b>	<b>3/1 to 7/1: Tract 1 - 2.1 cfs, Tract 2 - 4.83 cfs 7/1 to 10/1: Tract 1 - 1.05 cfs, Tract 2 - 2.42 cfs</b>	<b>6.7 cfs</b>	<b>N/A</b>

**System Description**

Are there multiple new or additional Points of Diversion (POD)?

YES   NO

If "YES" you will need to copy and complete Sections A, B, or C in this Section for each POD.

POD Name or Number this section describes (only needed if there is more than one):



**A. POD System Information N/A**

Provide the following information concerning the point of diversion. Information provided must describe the equipment used to appropriate water from the point of diversion.

**1. Pump Information**

MANUFACTURER	MODEL	SERIAL NUMBER	TYPE (CENTRIFUGAL, TURBINE OR SUBMERSIBLE)	INTAKE SIZE	DISCHARGE SIZE

RECEIVED

SEP 22 2021

OWRD

**2. Motor Information**

MANUFACTURER	HORSEPOWER

**3. Theoretical Pump Capacity**

HORSEPOWER	OPERATING PSI	LIFT FROM SOURCE TO PUMP	LIFT FROM PUMP TO PLACE OF USE	TOTAL PUMP OUTPUT (IN CFS)

**4. Provide pump calculations:**

**5. Measured Pump Capacity (using meter if meter was present and system was operating)**

INITIAL METER READING	ENDING METER READING	DURATION OF TIME OBSERVED	TOTAL PUMP OUTPUT (IN CFS)

**Reminder: For pump calculations use the reference information at the end of this document.**

**6. Additional notes or comments related to the system:**

**B. Gravity Flow Pipe**

(THE DEPARTMENT TYPICALLY USES THE HAZEN-WILLIAM'S FORMULA FOR A GRAVITY FLOW PIPE SYSTEM)

**1. Does the diversion involve a gravity flow pipe?**

YES  NO

*If "NO", items 2 through 4 relating to this section may be deleted.*

**C. Gravity Flow Canal or Ditch**

(THE DEPARTMENT TYPICALLY USES MANNING'S FORMULA FOR CANALS AND DITCHES)

**1. Does the diversion involve a gravity flow ditch or canal?**

YES NO

*If "NO", items 2 through 4 relating to this section may be deleted.*

2. Complete the table:

CANAL OR DITCH TYPE (MATERIAL)	TOP WIDTH OF CANAL OR DITCH	BOTTOM WIDTH OF CANAL OR DITCH	DEPTH	"N" FACTOR	AMOUNT OF FALL	LENGTH OF CANAL / DITCH	SLOPE	COMPUTED RATE (IN CFS)
Unlined Channel - Stony Bed, Weeds on Bank	<b>B=3.45'</b>	<b>b=2.3'</b>	<b>h=1.0</b>	<b>0.03</b>	<b>46'</b>	<b>10,102'</b>	<b>46'/10,102'</b> <b>=S=0.000456</b>	<b>6.7</b>

3. Provide calculations:

Trapezoidal ditch cross section,  $z=1/\text{slope}$ , slope(ditch wall) = 60 deg,  $B = b + (2 * z * h)$  therefore **B= 3.45**  
 $A = \text{Area} = (b + zh)h = 2.87 = A$   
 $WP = \text{wetted perimeter} = b + 2h * ((1 + z^2)^{.5}) = 4.97' = WP$   
 $R = \text{hydraulic radius} = ((b + zh) * h) / (b + 2h * ((1 + z^2)^{.5})) = 0.58' = R$

RECEIVED

SEP 22 2021

OWRD

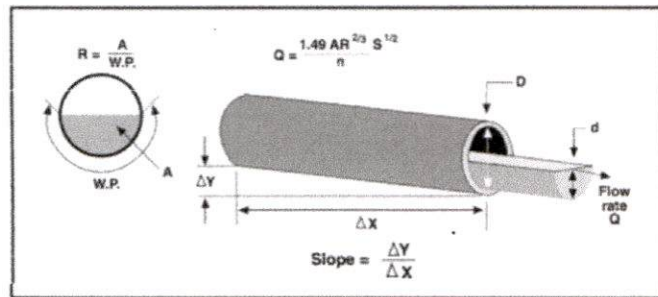

Using the equation for Q shown above:

**Q = 6.7 cfs**

4. If an actual measurement was taken, provide the following:

DATE OF MEASUREMENT	WHO MADE THE MEASUREMENT	MEASUREMENT METHOD	MEASURED QUANTITY OF WATER (IN CFS)

Attach measurement notes.

**Change #2**

**Change in Place of Use**

Did the transfer order authorize a change in the place of use?

YES  NO

*If "NO", this Section can be deleted.*

**1. Claim Summary – Authorized Use:**

If Irrigation or Nursery Use:

THE # OF ACRES ALLOWED	THE # OF ACRES DEVELOPED
277.0	277.0

RECEIVED

SEP 22 2021

OWRD

**2. Variations:**

Was the use developed differently from what was authorized by the transfer final order? YES   NO

If yes, describe below.

*(e.g. "The order authorized a change in place of use for 40 acres. The water user only developed 38 acres.")*



**Change #3**

**Change in Character of Use**

Did the transfer order authorize a change in character of use?

YES

NO

**Change #4**

**Change in Character of Use – Reservoir**

Did the transfer order authorize a change in character of use for a reservoir?

YES

NO

*If "NO", this Section can be deleted*

RECEIVED

SEP 22 2021

OWRD

**SECTION 4  
CONDITIONS**

OWRD

All conditions contained in the transfer final order, or any extension final order shall be addressed. Reports that do not address all performance related conditions will be returned.

**1. Time Limits:**

Describe how the water user has complied with each of the development timelines established in the transfer final order and any extensions of time issued for the transfer:

	DATE FROM TRANSFER	DATE THE AUTHORIZED CHANGES WERE COMPLETED *THIS DATE MUST FALL BETWEEN THE "ISSUANCE DATE" AND THE "COMPLETENESS DATE"
ISSUANCE DATE	11/6/2008	
COMPLETENESS DATE FROM ORDER (C)	10/1/2010	11/2009

\* MUST BE WITHIN PERIOD BETWEEN TRANSFER FINAL ORDER, OR ANY EXTENSION FINAL ORDER ISSUANCE AND THE DATE TO COMPLETE THE CHANGE

2. Is there an extension final order(s)?

YES  NO

**3. Measurement Conditions:**

a. Does the transfer final order, or any extension final order require the installation of a meter or other approved measuring device?

YES  NO

If "NO", items b through f relating to this section may be deleted.

**Reminder: If a meter or approved measuring device was required, the COBU map must indicate the location of the device in relation to the point of diversion.**

b. Has a meter been installed?

YES  NO

c. Meter Information

POD NAME OR #	MANUFACTURER	SERIAL #	CONDITION (WORKING OR NOT)	CURRENT METER READING	DATE INSTALLED

If a meter has been installed, items d through f relating to this section may be deleted.

d. If a meter has not been installed, has a suitable measuring device been installed and approved by the Department?

YES  NO

e. If "YES", provide a copy of the letter approving the device, if available. If the letter is not available provide the name and title of the Water Resources Department employee approving the measuring device, and the approximate date of the approval:

NAME	TITLE	APPROXIMATE DATE
Marcy Osborne	Baker Co. Watermaster	9/14/21

f. Measurement Device Description

DEVICE DESCRIPTION	CONDITION (WORKING OR NOT)	DATE INSTALLED
Weir	Working	2009

4. Recording and reporting conditions

- a. Is the water user required to report the water use to the Department? YES  NO

If the reports have not been submitted, attach a copy of the reports if available.

5. Fish Screening

- a. Are any points of diversion required to be screened to prevent fish from entering the point of diversion? YES  NO

If "NO", items b through e relating to this section may be deleted.

6. By-pass Devices

- a. Are any points of diversion required to have a by-pass device to prevent fish from entering the point of diversion? YES  NO

If "NO", items b and c relating to this section may be deleted.

7. Other conditions required by the transfer final order or extension final order:

- a. Was the water user required to restore the riparian area if it was disturbed? YES  NO
- b. Was a fishway required? YES  NO
- c. Other conditions?  YES NO

If "YES" to any of the above, identify the condition and describe the water user's actions to comply with the condition(s):

Must install headgates to control and regulate flow at the PODs. Head gates are installed.

RECEIVED

SECTION 5  
ATTACHMENTS

SEP 22 2021

Provide a list of any additional documents you are attaching to this report:

OWRD

ATTACHMENT NAME	DESCRIPTION



## SECTION 6

## CLAIM OF BENEFICIAL USE MAP

OWRD

The Claim of Beneficial Use Map must be submitted with this claim. Claims submitted without the Claim of Beneficial Use map will be returned. The map shall be submitted on polyester film at a scale of 1" = 1320 feet, 1" = 400 feet, or the original full-size scale of the county assessor map for the location.

For the purpose of this Claim, the map identifying the location of the place of use does not require a new survey. The location of the place of use identified on the Claim map should be based on the original right of record at the time the transfer final order was issued. In transfers approved for additional points of diversion, the original points must be identified the map based on the original right of record at the time the transfer final order was issued.

Provide a general description of the survey method used to prepare the map. Examples of possible methods include, but are not limited to, a traverse survey, GPS, or the use of aerial photos. If the basis of the survey is an aerial photo, provide the source, date, series and the aerial photo identification number.

**Created using satellite imagery, publicly available GIS data, and ground truthing.**

RECEIVED

SEP 22 2021

OWRD

## Map Checklist

Please be sure that the map you submit includes ALL the items listed below.  
(Reminder: Incomplete maps and/or claims may be returned.)

- Map on polyester film
- Appropriate scale (1" = 400 feet, 1" = 1320 feet, or the original full-size scale of the county assessor map)
- Township, Range, Section, Donation Land Claims, and Government Lots
- If irrigation, number of acres irrigated within each projected Donation Land Claims, Government Lots, Quarter-Quarters
- N/A** Locations of fish screens and/or fish by-pass devices in relationship to point of diversion
- Locations of meters and/or measuring devices in relationship to point of diversion or appropriation
- Conveyance structures illustrated (pumps, reservoirs, pipelines, ditches, etc.)
- Point(s) of diversion or appropriation (illustrated and coordinates)
- Tax lot boundaries and numbers
- Source illustrated if surface water
- Disclaimer ("This map is not intended to provide legal dimensions or locations of property ownership lines")
- Application and permit number or transfer number
- North arrow
- Legend
- CWRE stamp and signature



ORIGINAL

2005 FEB 28

RECEIVED



Garvin HydroGeo LLC  
1705 Main St. Ste. 101  
Baker City, OR 97814  
Garvin.hydrogeo@gmail.com  
(503) 347-7188

RECEIVED

SEP 22 2021

OWRD

September 20, 2021

Oregon Water Resources Department  
725 Summer St. NE, Suite A  
Salem, Oregon 97301

Hello,

On behalf of Wilson Family Ranches LLC, please see the enclosed Claim of Beneficial Use for Transfer T-7885. Note that a request for assignment is being submitted concurrently with this COBU. Due to privacy considerations, the former transfer holder of record (NW Farm Credit Services) will be submitting the Request for Assignment directly to OWRD. However, the \$120 recording fee for the Request for Assignment is enclosed here.

Please let me know if you have any questions regarding this COBU or the request for reassignment that is being submitted by NW Farm Credit Services

Sincerely,

Paul F. Garvin, RG, CWRE



Enclosed:

- T7885 Claim of Beneficial Use
- Request for Assignment recording fee - \$120 Check

**Additional POD**

**T 6S R 38E WM**

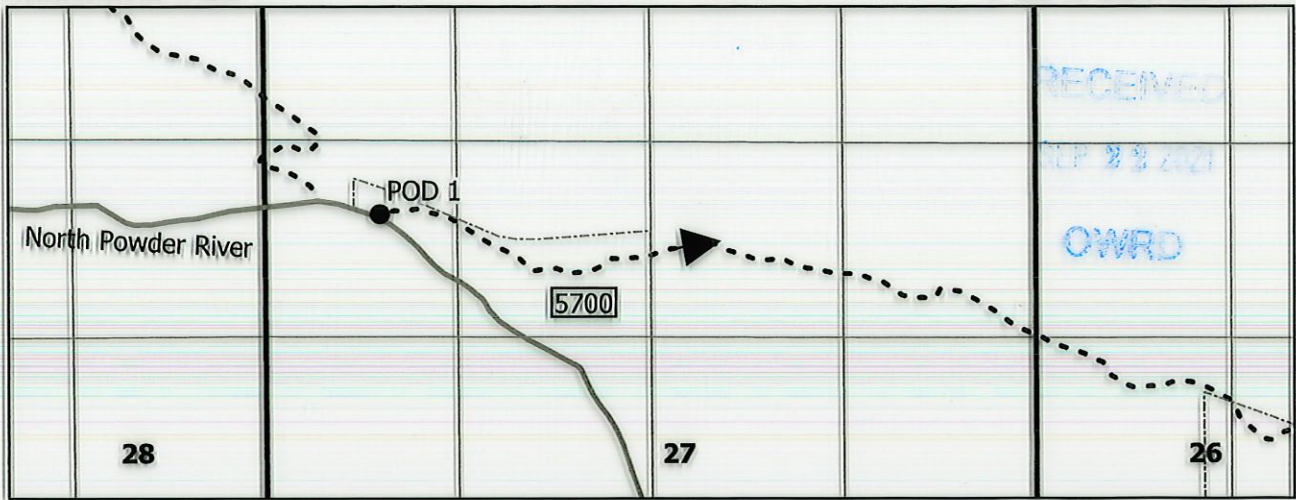

**Original PODs and all POUs**

**T 6S R 38E WM**

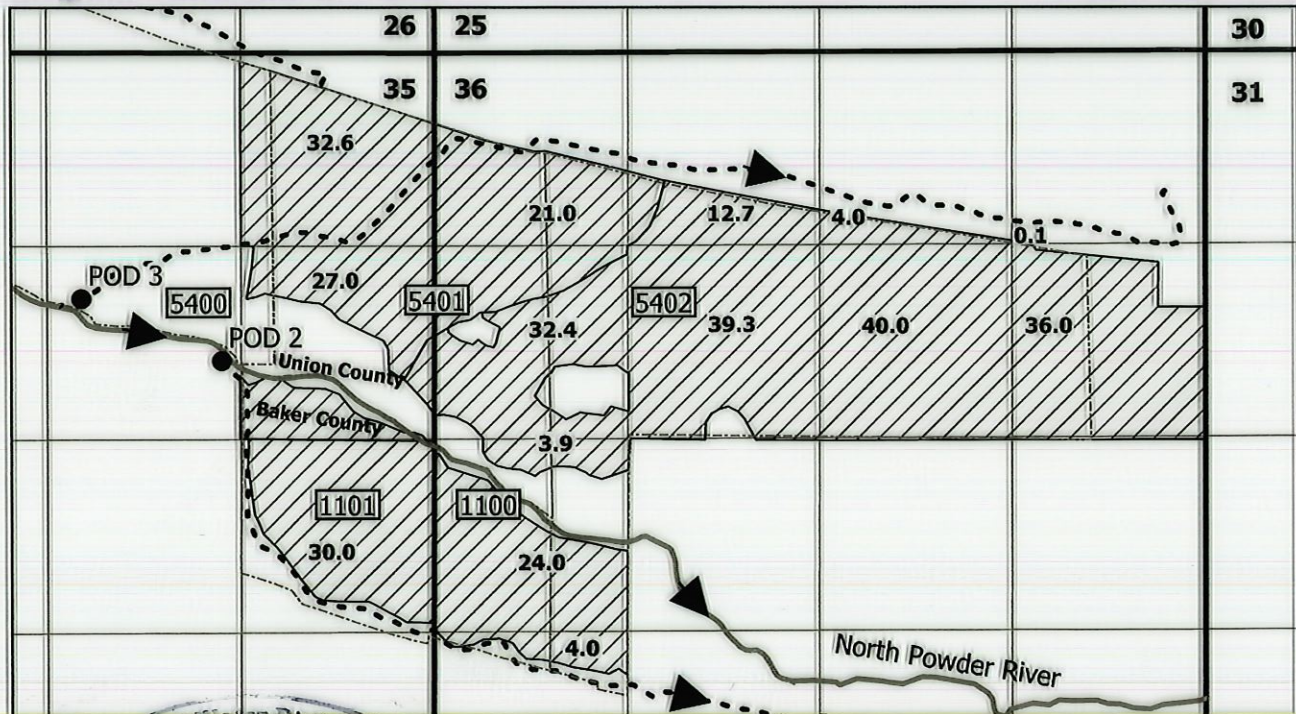

**LEGEND**

- Point of Diversion
- Ditch
- Taxlot Boundary

**Notes:**

This map is not intended to provide legal dimensions or locations of property ownership lines.

POD 1 - Daly Ditch: 2,220' N and 690' E from the SW corner of Section 27

POD 2 - Davis Dalton Ditch: 2,220' S and 1,570' W from the NE corner of Section 35

POD 3 - Davis Kelsy (aka Wilson) Ditch: 1,710' S and 2,550' W from the NE corner of Section 35

Flow measurement devices are located within 15 feet of each point of diversion

**Garvin  
HydroGeo  
LLC**

**Claim of Beneficial Use Map  
Transfer T-7885  
Union and Baker Counties, OR**

Prepared on behalf of Wilson Family Ranches LLC  
1 inch = 1,320 feet

