

RECEIVED

OCT 28 2021

OWRD

Parcel owned by Helen and Jimmy Schelhaas  
Part of the 486.1 acres of supplemental under Permit G-11446

Parcel owned by Gary Little  
This is the location of the 144.7 acres under Certificate 86688  
and also the remaining supplemental acres under Permit G-11446

Well location for Certificate 86688

T28S. R.14E.15E. W.M.

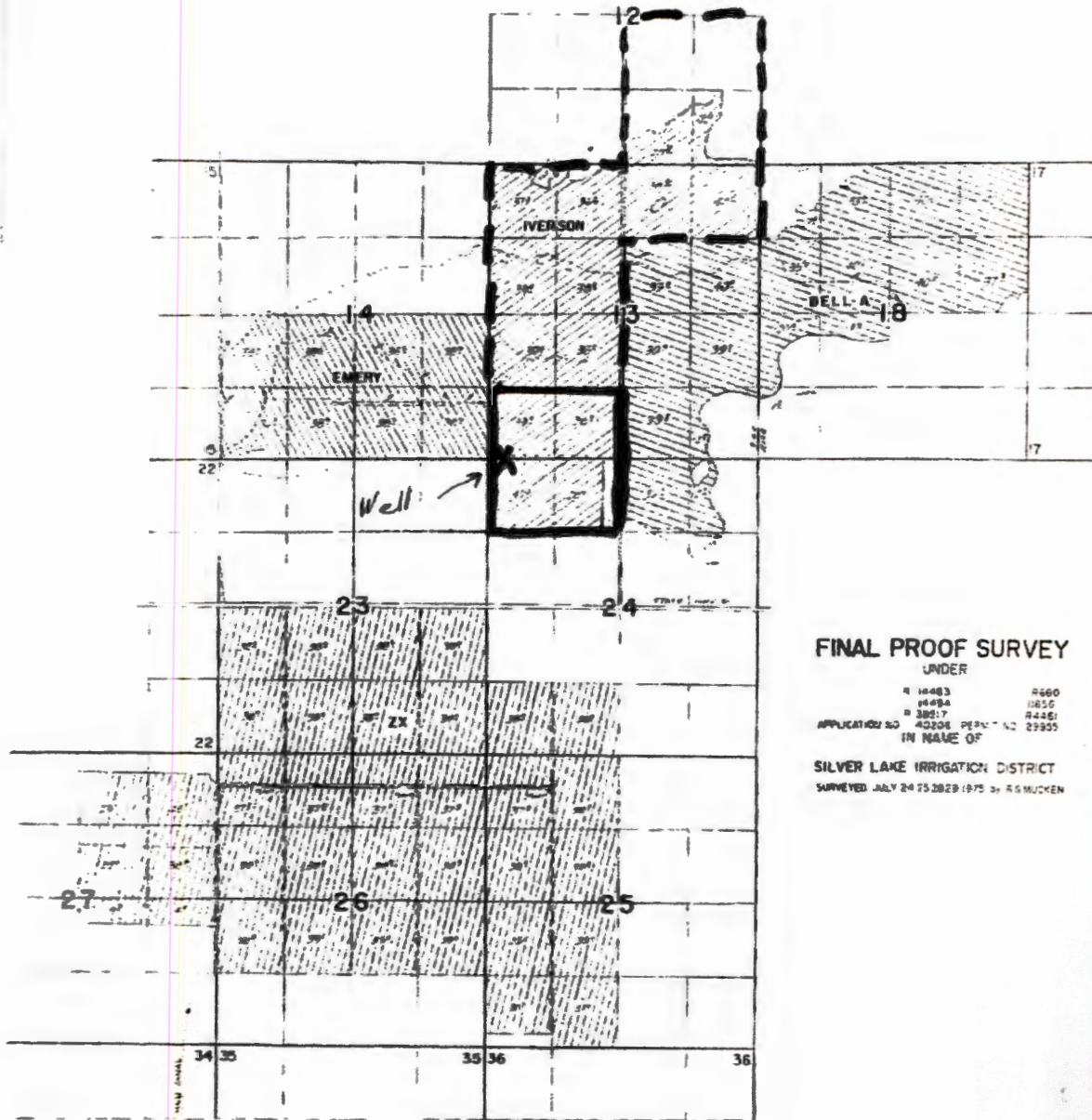

FINAL PROOF SURVEY  
UNDER

4 14483	8660
44984	1856
3887	24481
APPLICATION NO 43226	PERMIT NO 23955
IN NAME OF	

SILVER LAKE IRRIGATION DISTRICT  
SURVEYED JULY 24 25 28 29 1975 BY R. S. MUCKEN