

Application No. 11318
 Permit No. 7775
 Certificate No. 9482

FEES PAID

Date	Amount	Receipt No.
Total		

Stream Index, Page No. _____
 Application Record, Book No. _____

FEES REFUNDED

Date	Amount	Check No.

Name W. A. Williams
 By _____
 Address Sheridan, Ore.
 Date filed _____
 Action suspended until _____
 Returned to applicant _____
 Date completed _____
 Date of approval _____

ASSIGNMENTS

Date	To whom	Address	Volume	Page

REMARKS

0.08 sec. ft. from Mill Ck for irr. 6 acres.
4-12-28 - Card for A.
7/24/29 - Card for B.
4-28-30 - extension granted

OK for certificate

CONSTRUCTION

Date for beginning Feb 19, 1928
 Date for completion June 1, 1929
 Extended to 10/1/31
 Date for application of water Oct. 1, 1930
 Extended to 10/1/31

PROSECUTION OF WORK

Form "A" filed April 24, 1930
 Form "B" filed May 15, 1931
 Form "C" filed May 15, 1931

FINAL PROOF

Blank mailed May 19, 1931
 Proof received October 26, 1931
 Date certificate issued January 28, 1932
 Receipt for recording fee No. 14526 for 1.00

NOTICE OF COMPLETION OF CONSTRUCTION

I, H. A. Williams, the holder of Application No. 7775, being Pump Permit No. 7775, issued by the State Engineer of the State of Oregon for the appropriation of 0.075 second-feet of the waters of Mull creek in accordance with the tenor of such permit and the limitations endorsed thereon by the State Engineer, have completed the construction of the works described therein the 25 day of Oct, 1930 being within the time limitation as fixed in said permit or as extended by the State Engineer for the completion of construction work.

Remarks: I just run the pump enough to get things going + water on land in Oct-1930
If the works have a less capacity than as described in the permit, or you have definitely abandoned your plan of irrigating any of the lands described in your permit, you should so state in order that our records may not be unnecessarily encumbered.

IN WITNESS WHEREOF, I have hereunto set my hand this 14 day of May, 1931
Sheridan Ave H. A. Williams
(Present Address) (Signature of Applicant)

Fill out, detach, and mail to the State Engineer, Salem, Oregon.
Form D should be used in reporting progress of work if more than one year has been allowed for completion.

NOTICE OF COMPLETE APPLICATION OF WATER TO A BENEFICIAL USE

I, H. A. Williams, the holder of Application No. 7775, being Pump Permit No. 7775, issued by the State Engineer of the State of Oregon for the appropriation of 0.075 second-feet of the waters of Mull creek in accordance with the tenor of such permit and the limitations endorsed thereon by the State Engineer, completely applied the water to a beneficial use, on the 12 day of May, 1931, being the time limitation as fixed in said permit or as extended by the State Engineer for the complete application of water to a beneficial use.

Remarks: _____
If all of the water granted in the permit had not been fully applied to beneficial use, you should so state, so that delinquent appropriators may have notice.

IN WITNESS WHEREOF, I have hereunto set my hand this 14 day of May, 1931
Sheridan Ave H. A. Williams
(Present Address) (Signature of Applicant)

Fill out, detach, and mail to the State Engineer, Salem, Oregon.

Form A

NOTICE OF BEGINNING OF CONSTRUCTION

I, W. A. Williams, the holder of Application No. 11318, being

Permit No. 7775, issued by the State Engineer of the State of Oregon
(Reservoir or Enlargement)

for the appropriation of 0.08 second-feet of the waters of Mill Creek
in accordance with the tenor of such permit and the limitations endorsed thereon by the State Engineer,
began the actual construction of the works described therein on the 1 day of May, 1927
being within the time limitation as fixed in said permit for the beginning of construction work.

Leveling land for irrigation. No construction of ditches
The appropriator should state the manner of beginning construction work, number of men and teams employed, the amount of work completed up to the date of this
necessary as water will be pumped and distributed through
statement, and any additional information which may tend to show the beginning of work in good faith.

pipes.

IN WITNESS WHEREOF, I have hereunto set my hand this 24th day of April, 1930

(Present Address)

W. A. Williams
(Signature of Applicant)

Fill out, detach, and mail to the State Engineer, Salem, Oregon.

Twp.-65 R.6 W.

1/2 of book 734

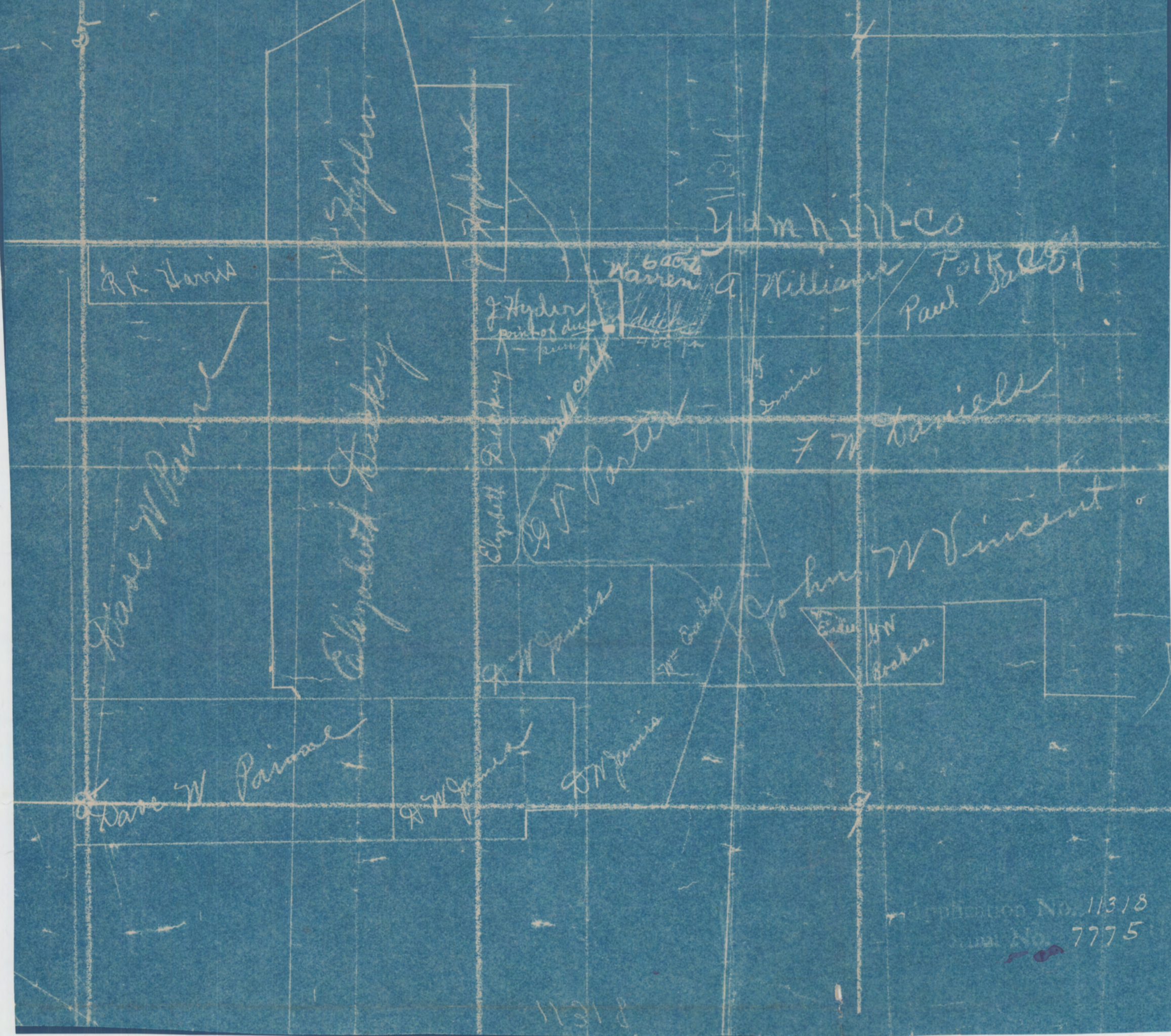

Section No. 11318
Sub. No. 7775

Twp.-6 S. R. 6 W.

1/2 of SW 1/4 of 34

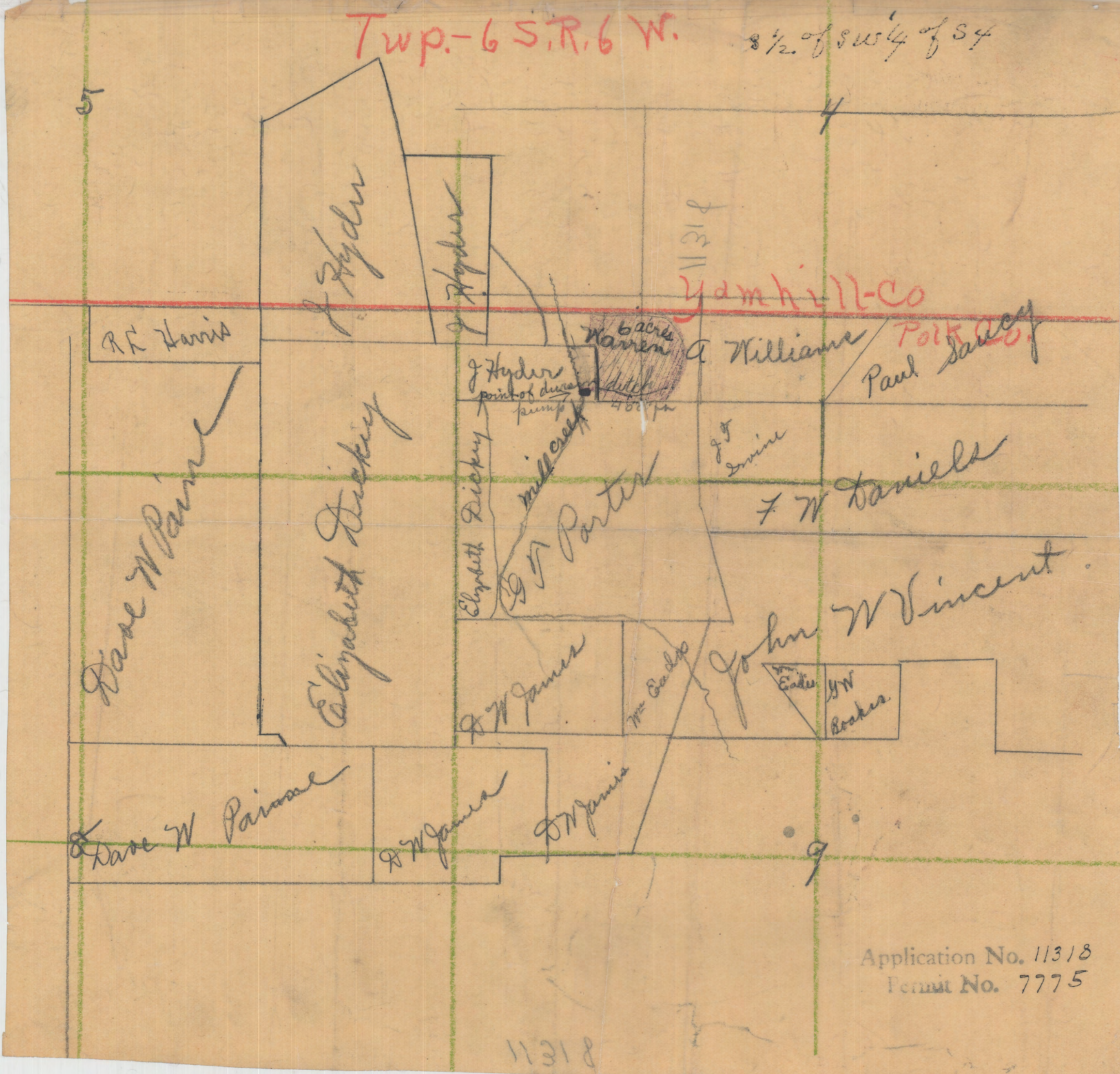

Application No. 11318
Permit No. 7775

11318

Twp.-6 S. R. 6 W. 3 1/2 of 8 or 1/4 of 34

5

4

Yamhill Co

R R Harris

J Hyder

J Hyder

William

Port
Paul

J Hyder
point of disc
pump
400 ft

Dave W Paine

Elizabeth Dickky

Elizabeth Dickky

Porter

J J
mine

J W Daniels

R W James

W E Baker

John W Vincent

East
W
Baker

Dave W Paine

R W James

R W James

Application No. 11318
Lentul No. 7775

9482

OK

PROOF OF APPROPRIATION OF WATER

1. Name W. A. Williams 2. Address Sheridan

3. Source of supply Mill Creek

Tributary of Yamhill River

4. Amount of water 0.08 5. Priority date February 8, 1927

6. Use irrigation

7. Location of point of diversion, ^{*SW SW*} ~~Sec. 4~~, Twp. 6 S., Range 6 W. W. M. (Legal Subdivision)

8. The description of land given below corresponds to that found in your permit covering land to be irrigated, or, if for other purposes, the place of use. In the blank column on the right, headed "No. acres actually irrigated," fill in the number of acres you have irrigated in each of the tracts described:

Township	Range	Section	Forty-acre Tract	No. Acres Described in Permit	No. Acres Actually Irrigated
6 S	6 W	4	SW $\frac{1}{2}$ SW $\frac{1}{2}$	3	3
			SE $\frac{1}{2}$ SW $\frac{1}{2}$	3	3

This column must be filled in if water is used for irrigation

(Attach separate sheet if necessary)

(check) *etc.*

APPLICATION No. 11318

COUNTY Polk

PROOF OF APPROPRIATION OF WATER

- 1. Name W. A. Williams 2. Address Sheridan
- 3. Source of supply Mill Creek
 Tributary of Yamhill River
- 4. Amount of water 0.08 5. Priority date February 8, 1927
- 6. Use irrigation
- 7. Location of point of diversion, ^{SW SW} SW $\frac{1}{4}$ SW $\frac{1}{4}$ Sec. 4, Twp. 6 S., Range 6 W. W. M.
 (Legal Subdivision)
- 8. The description of land given below corresponds to that found in your permit covering land to be irrigated, or, if for other purposes, the place of use. In the blank column on the right, headed "No. acres actually irrigated," fill in the number of acres you have irrigated in each of the tracts described:

Township	Range	Section	Forty-acre Tract	No. Acres Described in Permit	No. Acres Actually Irrigated
6 S	6 W	4	SW $\frac{1}{4}$ SW $\frac{1}{4}$	3	3
			SE $\frac{1}{4}$ SW $\frac{1}{4}$	3	3

This column must be filled in if water is used for irrigation

DESCRIPTION OF WORKS

9. (a) If a dam has been constructed, give description: Height,ft.; length on top,ft. length on bottomft.; material used and character of construction,

(b) Give description of headgate: Width,ft.; depth,ft.; material used and character of construction,

(c) Size of canal: Width on top (at waterline) 2 ft.; width on bottom, 1.5 ft.; depth of water, 1/2 ft.; grade,ft. fall per 1,000 ft. Actual capacity, sec.-ft. Give general description,

(d) Pipe line: Description of intake,

From pump to ditch

Length of pipe, 10 ft.; size at intake, 3 in.; size at 10 ft. from intake, 2 1/2 in.; size at place of use, ~~3 1/2~~ in. Difference in elevation between intake and place of use, 10 ft.

Is grade uniform? Yes Actual capacity of pipe line, sec.-ft.

Give general description: *Pipe line from pump house up wash flume, and flume to ditch*
(Material: Steel, wrought, cast iron, wood stave, etc.)

2 1/2"

(e) Pumping plant: Give size and type of pump, Cent pump

Suction lift, 2 ft.; discharge lift, ~~2 1/2~~ ft. Type of motor used Ford motor

Horse power rating, H. P. Actual capacity of pump, 150 gal per hr sec.-ft.

10. During what months is water beneficially used May June July and August, Sept

11. State character of soil Loam - Bottom lands

Kind of crops raised alfalfa Raisins corn + garden

12. Does the accompanying map, filed with your application, show correctly the point of diversion, area of land irrigated, or place of use? Yes

13. If not, wherein is such map in error?

14. Domestic use: Give number of families actually using water at this time

15. If for power, mining, municipal, manufacturing, storage or any other purpose than irrigation, give extent and method of such use

AFFIDAVIT OF APPROPRIATOR

STATE OF OREGON,

County of Marion } ss.

I, W. A. Williams, being first duly sworn, depose and say that I have read the above and foregoing proof of appropriation of water; that I know the contents thereof, and that the facts therein stated are true.

IN WITNESS WHEREOF, I have hereunto set my hand this 21st day of October, 1931.

W. A. Williams

Subscribed and sworn to before me this 21st day of October, 1931.

Wm. F. Rogers
Notary Public for Oregon

[NOTARIAL SEAL]

My commission expires Asst State Engineer

AFFIDAVIT OF WITNESSES

STATE OF OREGON,

County of Marion } ss.

We, G. G. Porter, and H. E. Freetag of Sheldon, being first duly sworn, depose and say that

we are well acquainted with the facts and conditions set forth in the foregoing statement relative to proof of appropriation of water under Permit No. 7775; that we and each of us have been over and upon each tract described in said proof, and from such personal inspection have knowledge that all necessary ditches, dams and other diversion and distributing works have been constructed, and water used as stated therein; that we have carefully read such proof of appropriation, and that each and every statement contained therein is true to the best of our knowledge and belief.

G. G. Porter

H. E. Freetag

Subscribed and sworn to before me this 21st day of October, 1931.

Wm. F. Rogers
Notary Public for Oregon

[NOTARIAL SEAL]

My commission expires March-6-1933

REPORT OF PERSON MAKING INSPECTION

(For use by representative of State Engineer)

I, _____, do hereby certify that I have made an inspection of the works described herein and in Permit No. _____, on the _____ day of _____, 193____, and found the foregoing statements and descriptions of works to be accurate. In my opinion the appropriation has been completed to the extent of _____ (Quantity of water in second-feet or acre-feet) and I recommend the issuance of a water right certificate for this amount.

NOTE TO INSPECTORS

If conditions do not justify the above report by you, please return the proof without your signature, with a full report by letter.

(Name)

(Title)

PROOF OF APPROPRIATION

Permit No.

Recording fee paid

Receipt No.

**STATE ENGINEER
RECEIVED
OCT 26 1931
SALEM, OREGON**

COUNTY OF _____
STATE OF OREGON

COUNTY OF _____
STATE OF OREGON

April 28, 1930.

Mr. W. A. Williams,
Sheridan,
Oregon.

Dear Sir:

While you were in this office on April 24th you filed the notice of beginning construction work under Your Permit No. 7775 and made application for an extension of time within which you might complete construction work and make complete application of water.

In view of your statements that considerable land has been prepared for irrigation and no construction work is necessary other than the setting of a pump and laying a pipe line, which can be done after the land is entirely prepared for irrigation and in alfalfa, I am complying with your request. Your time limit for completion of construction and complete application of water is being extended until October 1, 1931.

Yours very truly,

RHEA LUPER,
State Engineer

By _____
Office Assistant.

LAS:L

VOL 58 1020

Mr. W. A. Williams,
Sheridan, Oregon.

February 24, 1927.

Dear Sir:

Herewith you will find Application No. 11318, being
Permit No. 7775.

The application has been approved and recorded
in this office.

February 8, 1927.

Mr. W. A. Williams,
Sheridan,
Oregon.

Dear Sir:

Enclosed please find official receipt number 5040 for \$3.90, which amount was transmitted with application for permit to appropriate water, together with a map to accompany the filing.

The application has been numbered 11318 and is being returned herewith for your signature before two witnesses.

In order to retain its original date of priority, the application should be signed and returned to this office on or before March 8, 1927.

Yours very truly,

H.
Enc.

Rhea Luper,
State Engineer.

RECEIVED
FEB - 8 1927
SALEM,
OREGON

Sheridan Ore Feb - 6 - 27

State Engineer
Salem Ore

Dear Sir: Since being in your office
I got the assessor of Polk county to make
me a map of my land to be irrigated
but he wouldn't draw it on the
paper you gave me for the purpose
and I can't so I will have to leave
it to you. If there is any extra charges
please let me know

yours truly

H. A. Williams

Enclosed find check