

CERTIFIED WATER RIGHT EXAMINER
 85503
 DOANN HAMILTON
 MAY 10, 2012
 STATE OF OREGON
 EXPIRES: June 30 2012

RECEIVED
 DEC 20 2021
 OWRD

T.9S. R.3W. Sec. 14 & 15, W.M.

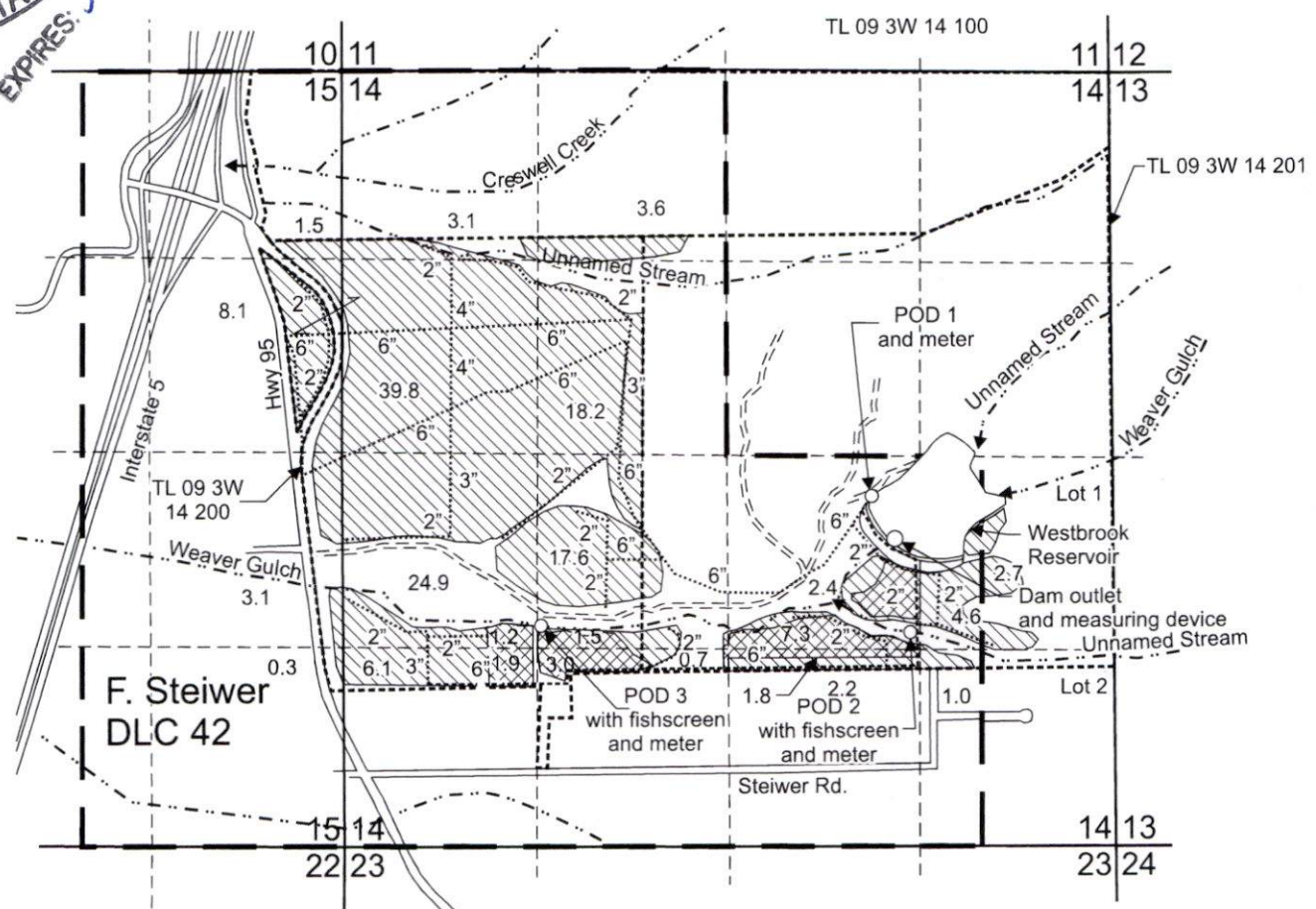

POD 1 (Westbrook Reservoir) is located 2,395 feet north and 1,675 feet west from the SE corner, Section 14.
 POD 2 (Unnamed Stream) is located 1,460 feet north and 1,410 feet west from the SE corner, Section 14.
 POD 3 (Weaver Gulch) is located 1,500 feet north and 1,355 feet east from the SW corner, Section 14.

Area (139.9 Acres) of primary irrigation under Application S-84037, Permit S-53603 irrigated by POD 1, 2, and 3.
 Area (16.7 Acres) of supplemental irrigation under Application S-84037, Permit S-53603 irrigated by POD 1 only, primary water right is Certificate 23305.

----- Tax lot boundary - - - - - Donation Land Claim boundary Water main line

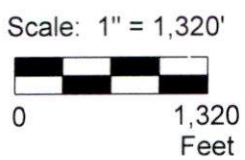

This map was prepared for the purpose of identifying the location of a water right only and is not intended to provide legal dimensions or location of property ownership lines.



Claim of Beneficial Use Map
 Application S-84037, Permit S-53603

Pacific Hydro-Geology Inc.

Heritage Seedlings and Liners, Inc.
 T.9S. R.3W Section 14 & 15, W.M.

11/2021

Heritage, Jefferson S-84037 COBUMap.cdr

CERTIFIED WATER RIGHT EXAMINER
 85503
 DOANN HAMILTON
 MAY 10, 2012
 STATE OF OREGON
 EXPIRES: June 30 2022

T.9S. R.3W. Sec. 14 & 15, W.M.

RECEIVED
 DEC 20 2021
 OWRD

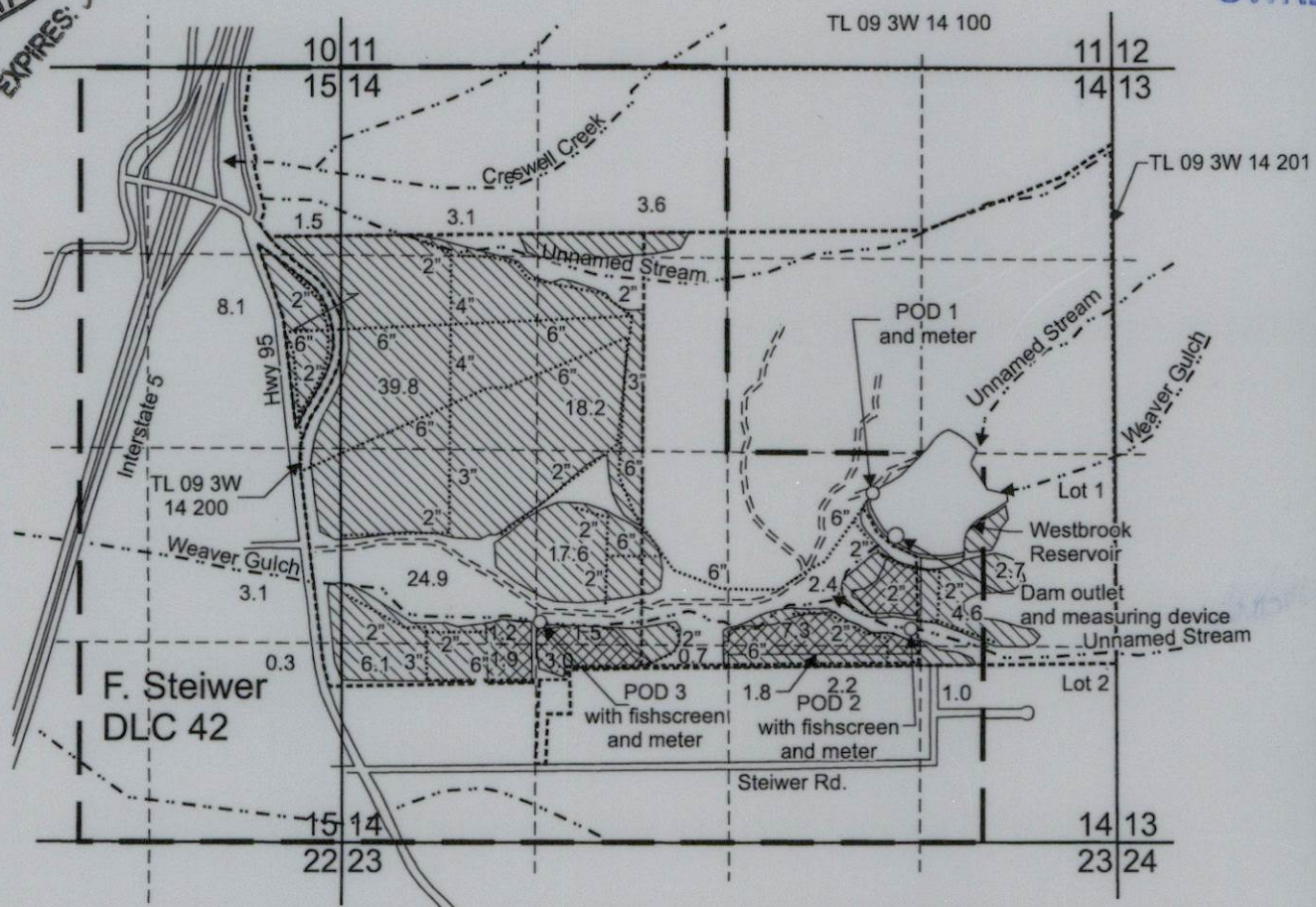

POD 1 (Westbrook Reservoir) is located 2,395 feet north and 1,675 feet west from the SE corner, Section 14.
 POD 2 (Unnamed Stream) is located 1,460 feet north and 1,410 feet west from the SE corner, Section 14.
 POD 3 (Weaver Gulch) is located 1,500 feet north and 1,355 feet east from the SW corner, Section 14.

- Area (139.9 Acres) of primary irrigation under Application S-84037, Permit S-53603 irrigated by POD 1, 2, and 3.
- Area (16.7 Acres) of supplemental irrigation under Application S-84037, Permit S-53603 irrigated by POD 1 only, primary water right is Certificate 23305.

----- Tax lot boundary — — — — — Donation Land Claim boundary Water main line

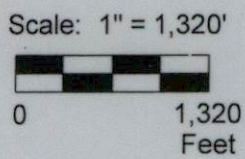

This map was prepared for the purpose of identifying the location of a water right only and is not intended to provide legal dimensions or location of property ownership lines.

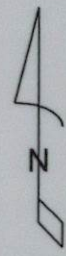

Claim of Beneficial Use Map
Application S-84037, Permit S-53603

Pacific Hydro-Geology Inc.

Heritage Seedlings and Liners, Inc.
 T.9S. R.3W Section 14 & 15, W.M.

11/2021

Heritage, Jefferson S-84037 COBU Map.cdr