

- LEGEND**
- Proposed Point of Diversion (POD)
 - Proposed Place of Use (POU)
 - Berm
 - Donation Land Claim (DLC)
 - Tax Lot
 - Road
 - Watercourse
 - Waterbody

Application for a Permit to Store Water in a Reservoir in the Name of Sarbanand Enterprises, LLC Yamhill County

Township 5 North, Range 5 West (W.M.)

LOCATION DESCRIPTION
Proposed POD
 Located 1,650 feet North and 2,160 feet East from the SW corner of Section 35, Township 5 South, Range 5 West (W.M.)
Center of Berm
 Located 1,415 feet North and 2,210 feet East from the SW corner of Section 35, Township 5 South, Range 5 West (W.M.)

E-RECEIVED

December 7, 2021

OWRD

DISCLAIMER
 This map was prepared for the purpose of identifying the location of a water right only and it is not intended to provide legal dimensions or location of property ownership lines.

Date: September 16, 2021
 Data Sources: BLM, ESRI, OWRD, USGS, Yamhill Co.

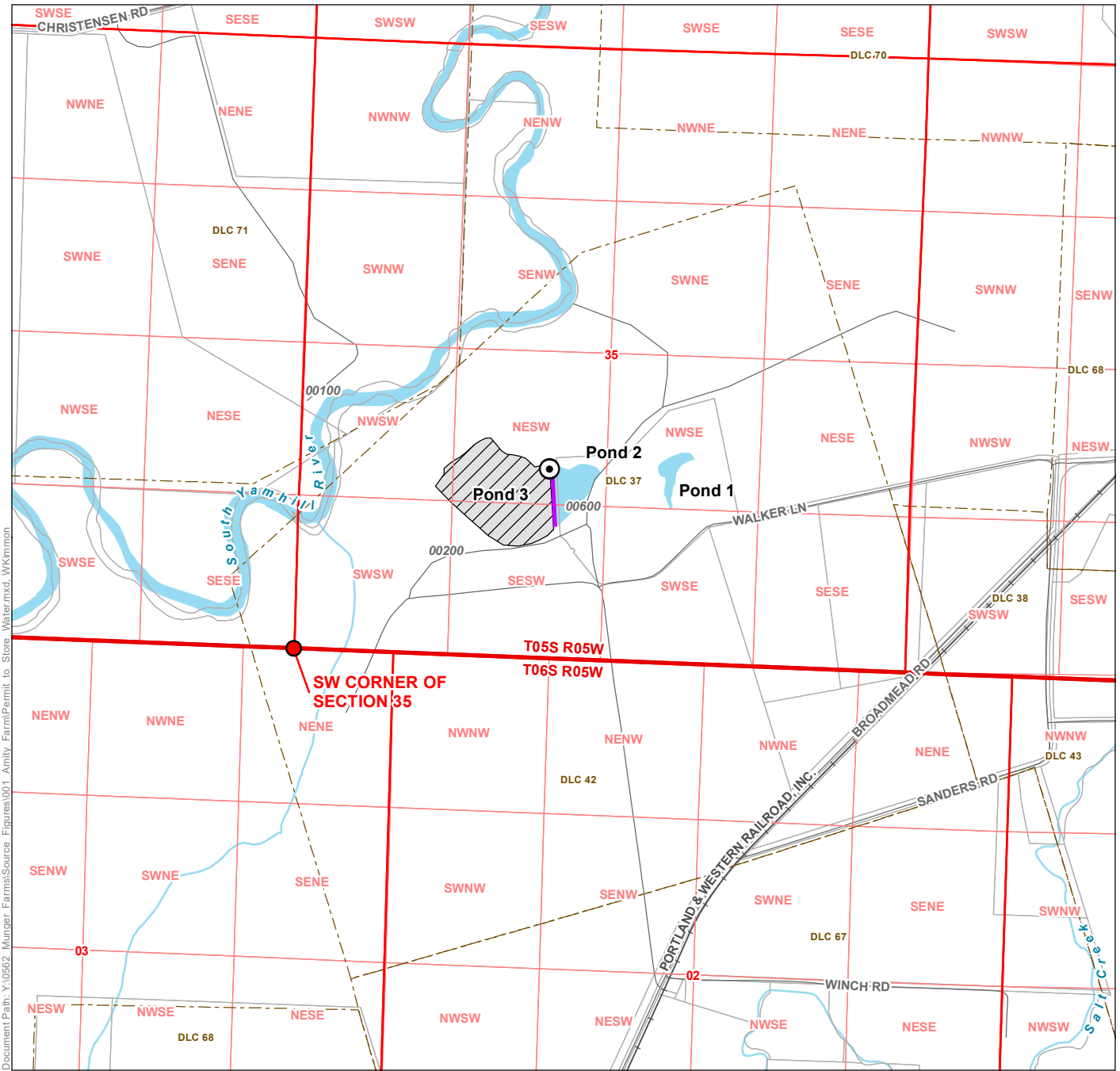

- LEGEND**
- Proposed Point of Diversion (POD)
 - Proposed Place of Use (POU)
 - Berm
 - Donation Land Claim (DLC)
 - Tax Lot
 - Road
 - Watercourse
 - Waterbody

**Application for a Permit to Store Water in a Reservoir
in the Name of Sarbanand Enterprises, LLC
Yamhill County
Township 5 North, Range 5 West (W.M.)**

LOCATION DESCRIPTION
Proposed POD
 Located 1,650 feet North and 2,160 feet East from the SW corner of Section 35, Township 5 South, Range 5 West (W.M.)
Center of Berm
 Located 1,415 feet North and 2,210 feet East from the SW corner of Section 35, Township 5 South, Range 5 West (W.M.)

DISCLAIMER
 This map was prepared for the purpose of identifying the location of a water right only and it is not intended to provide legal dimensions or location of property ownership lines.

Date: September 16, 2021
 Data Sources: BLM, ESRI, OWRD, USGS, Yamhill Co.

E-RECEIVED
December 7, 2021
OWRD

