

CLAIM OF BENEFICIAL USE MAP

TO ADD PLACE OF USE AND POINTS OF APPROPRIATION FOR APPLICATION G-16045

TAX LOT: 1700 IN SECTION 28,
TOWNSHIP 22 SOUTH, RANGE 32 EAST, W.M.

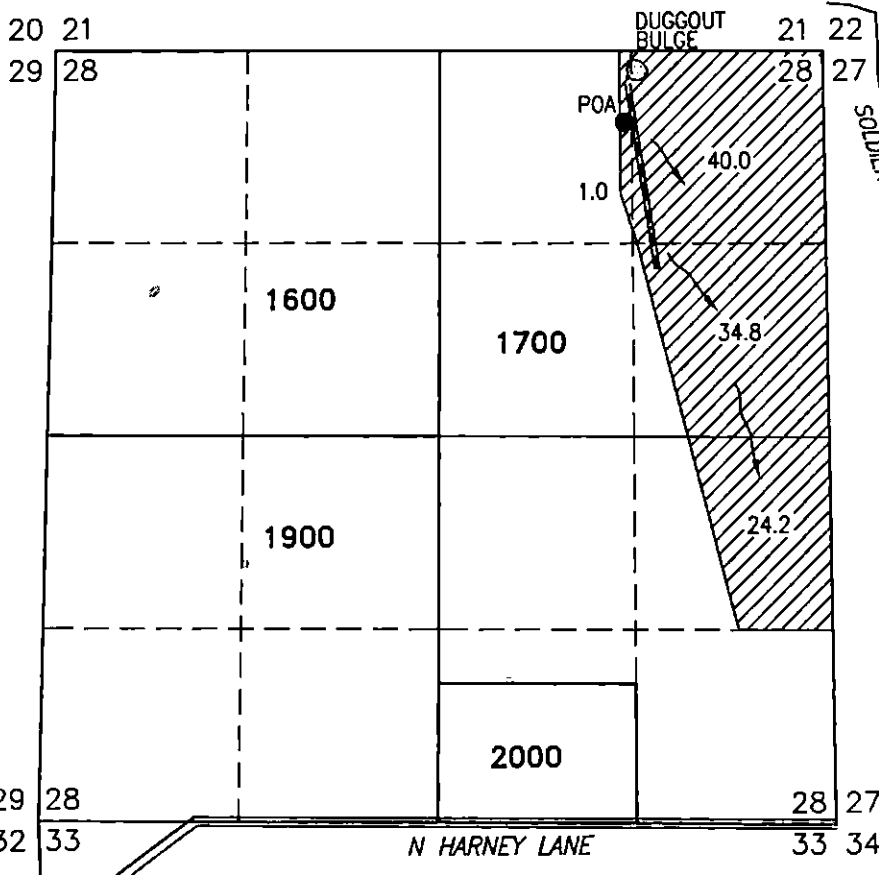

175
J 1701
AVR

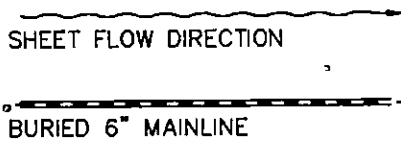

POA (HARN 50944/50952)
 • LOCATED IN THE NW 1/4 NE 1/4 SECTION 28, T22S R32E, W.M. AND 485 FEET SOUTH AND 1369 FEET WEST FROM THE NE CORNER OF SECTION 28. METER IS LOCATED 9 FEET NORTH AND 16 FEET EAST FROM WELL.

 100.0 ACRES IR FROM PERMIT G-15674 AND POA, AS SHOWN

THIS MAP IS FOR THE PURPOSE OF LOCATING A WATER RIGHT ONLY AND HAS NO INTENT TO PROVIDE LEGAL DIMENSIONS OR THE LOCATION OF PROPERTY LINES.

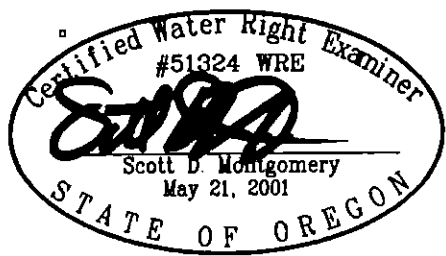

RENEWAL DATE: 12/31/2022

PREPARED FOR:

 JOSEPH & VIVIAN CRONIN
 35049 N HARNEY LANE
 BURNS, OR 97720

PREPARED BY:

 ALL POINTS ENGINEERING AND SURVEYING, INC.
 P.O. BOX 767 TERREBONNE, OR 97760
 (541) 548-5833 www.APEandS.com