

T.4S. R.2E. Sec. 32 & 33, and T.5S. R.2E. Sec. 4 & 5, W.M.

RECEIVED

FEB 25 2022

OWRD

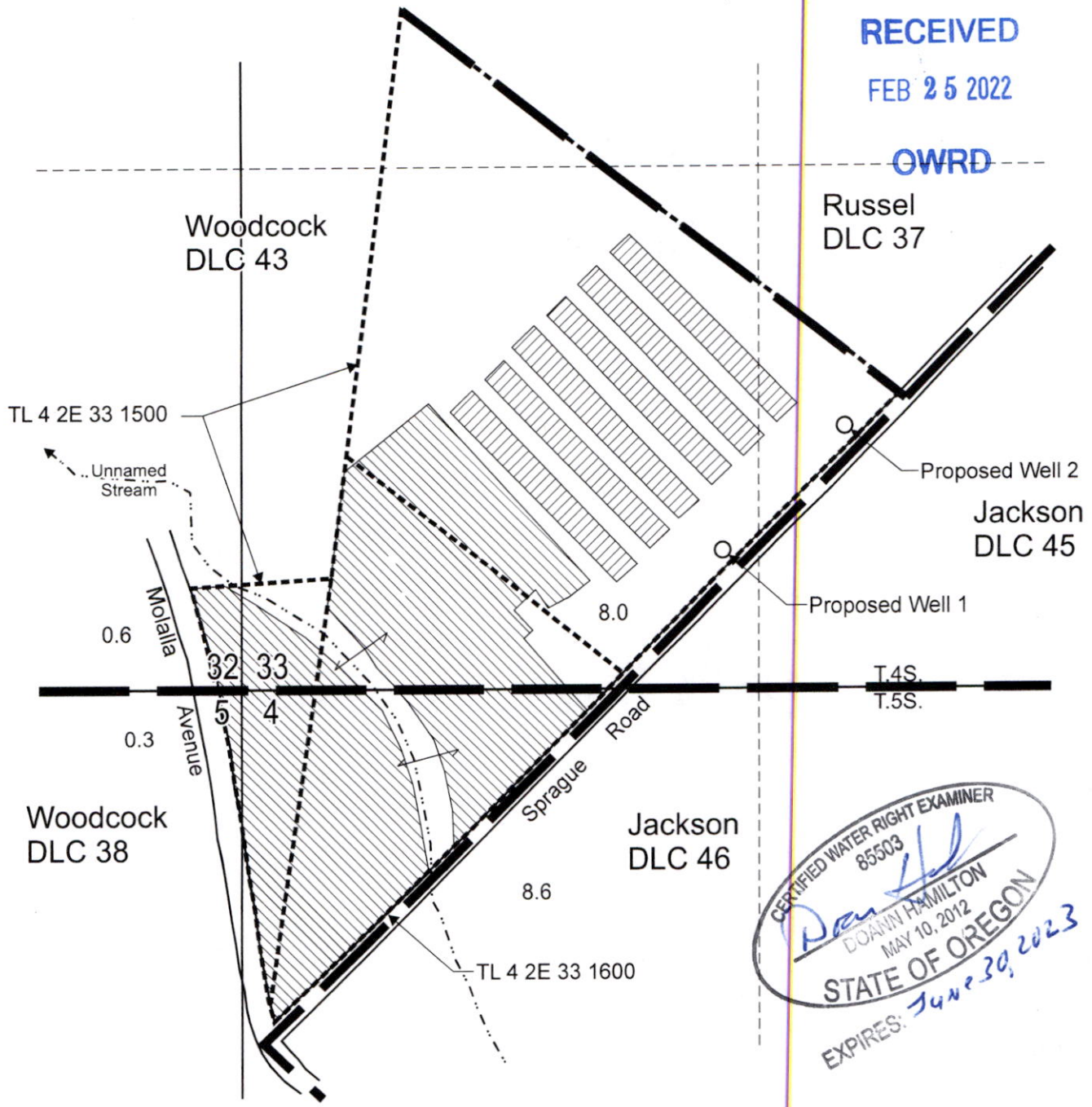

CERTIFIED WATER RIGHT EXAMINER
85503
Don Hamilton
DONAM HAMILTON
MAY 10, 2012
STATE OF OREGON
EXPIRES: June 30, 2023

Proposed Well 1 is located 345 feet north and 1,230 feet east from the SW corner, Section 33.
Proposed Well 2 is located 660 feet north and 1,540 feet east from the SW corner, Section 33.

- Area (17.5 Acres) to be covered under nursery operations.
- Proposed Commercial Use
- Tax lot boundary
- Donation Land Claim boundary

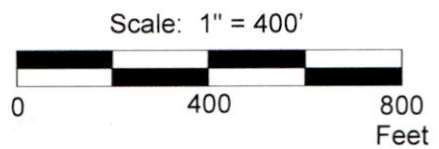

This map was prepared for the purpose of identifying the location of a water right only and is not intended to provide legal dimensions or location of property ownership lines.



Water Right Application Map

Tuan Tiet
T.4S. R.2E. Sec. 32 & 33,
T.5S. R.2E. Sec. 4 & 5, W.M.

Pacific Hydro-Geology Inc.

02/2022

TietGWAppMap.cdr