

UNITED STATES
DEPARTMENT OF THE INTERIOR
BUREAU OF LAND MANAGEMENT

RECEIVED

JAN 4 1985

WATER RESOURCES DEPT
SALEM, OREGON

SECTION: 28
SE 1/4 SW 1/4

Oregon State Water Filings

TOWNSHIP 17 S, RANGE 23 E, W. M.

North

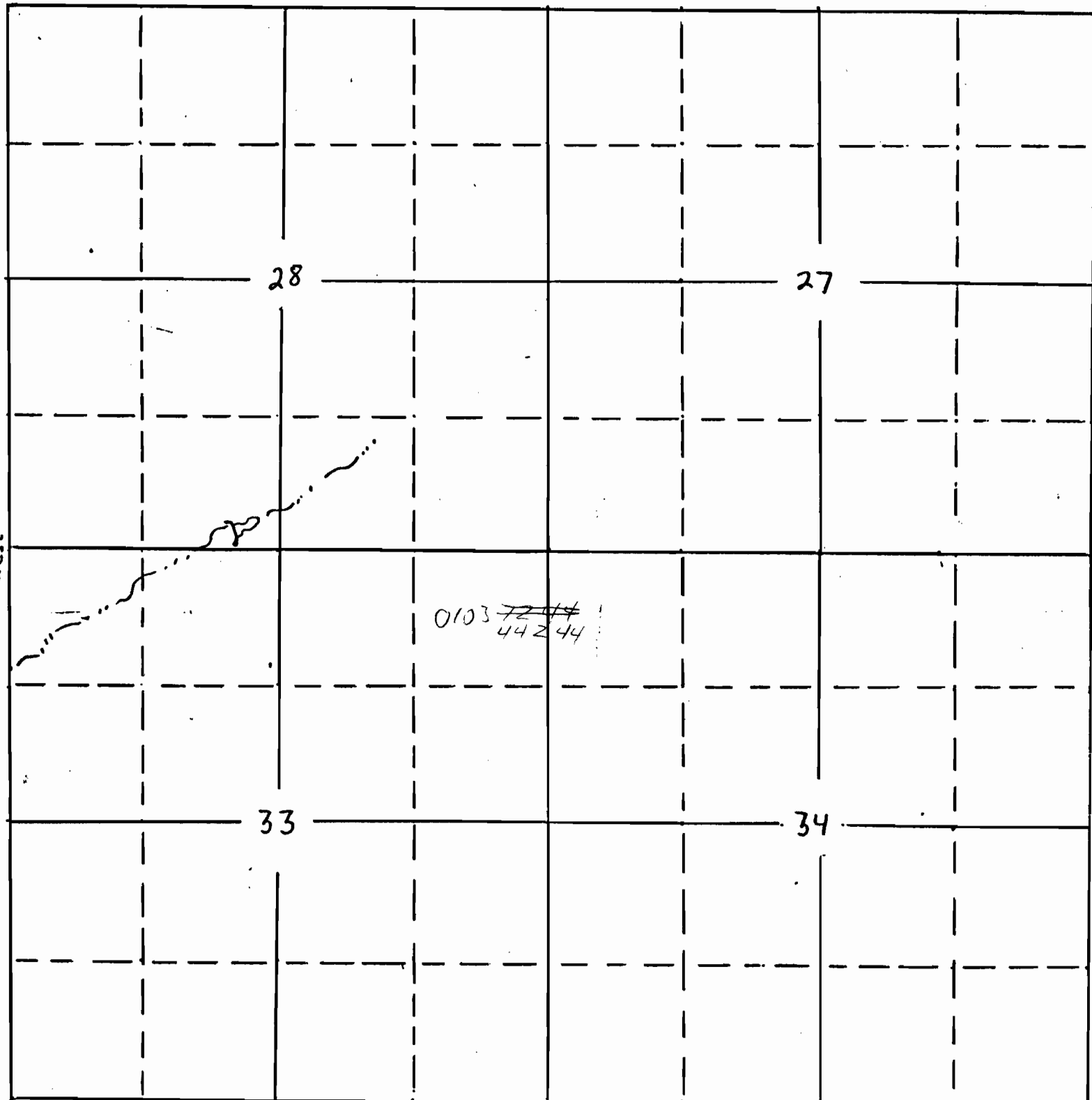

west

South

APPLICATION No.
PERMIT No.

R-66080
R11890