

No. R-73598
 No. R11712

Map for: Richard P. Noble

RECEIVED

AUG 18 1993

Location: The NE 1/4 and NW 1/4 of the NE 1/4 of Section 18 and the NE 1/4, NW 1/4 and SW 1/4 of the NW 1/4 of Section 17 and also the SW 1/4 of the SW 1/4 of Section 8, T.6 S., R.6 W., W.M., Polk County, Oregon.

Tax Lot: 6617-300,301,800,401,500,400;
 6608-502,600; 6618-100,102,101

Application No.

Date : 17 June 1993 Scale : 1" = 1320'

LEGEND:

- . . . - . . . - = Property line
- = D.L.C. line
- = Section line
- = "40" line
- = watering trough
- = house site

I certify that the information I have provided in this application is an accurate representation of the proposed water use and is true and correct to the best of my knowledge. It is to be used for the purpose of identifying the location of water right only and is not intended to provide legal dimensions or locations of property ownership lines.

NOTE

All dimensions are scaled from an aerial photograph and said dimensions reference the NW corner of Section 17.

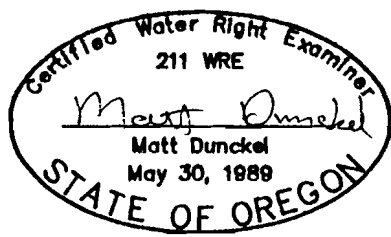

By : Matt Dunckel & Assoc.
 19010 Baker Creek Rd.
 McMinnville, Oregon 97128
 Phone : 472-7904

RECEIVED

JUL 15 1993

WATER RESOURCES DEPT.
 SALEM, OREGON

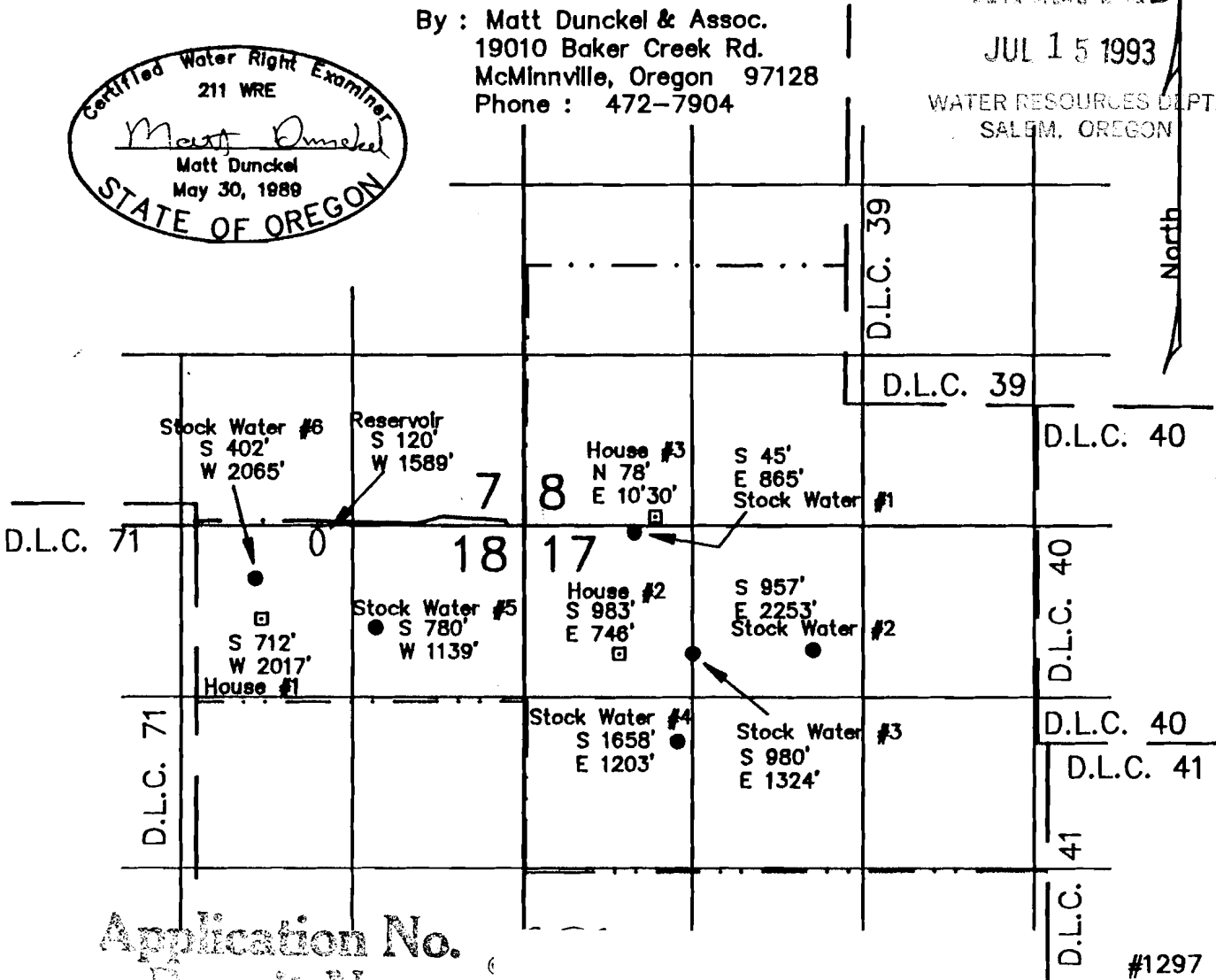

Application No.
 Permit No.

#1297