

FINAL PROOF SURVEY MAP

RECEIVED

IN THE NAME OF DARYL ROBISON and DANIEL LOSHBAUGH AUG 17 1999

SECTION 33, T 31 S, R 15 W, W.M.

WATER RESOURCES DEPT.
SALEM, OREGON

APPLICATION R-73610
APPLICATION 73611

PERMIT R-11511
PERMIT 51557

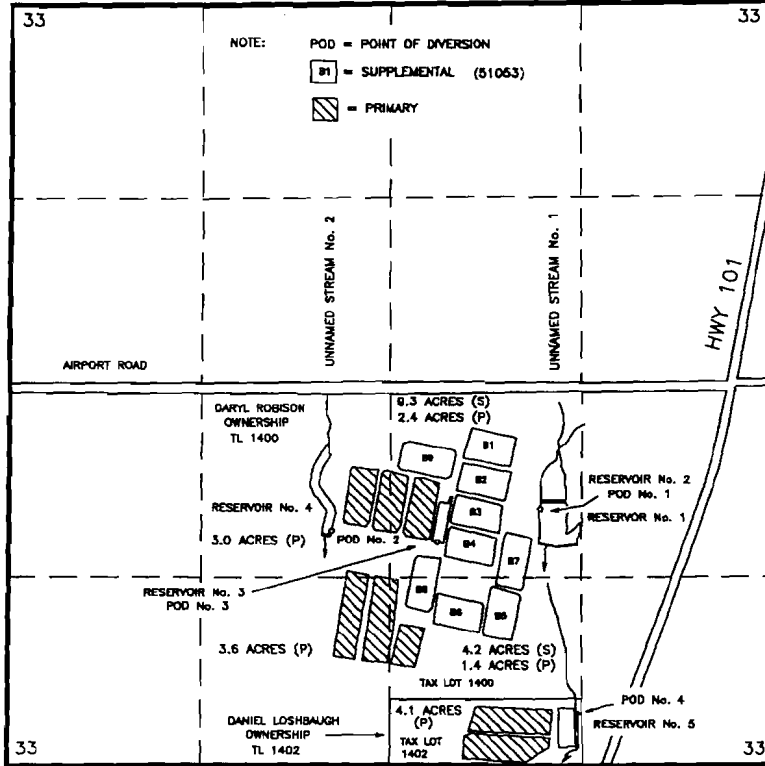

POINTS OF DIVERSION	NORTH	WEST	¼ ¼ SECTION	SECTION
DIVERSION No. 1	1750 FEET	1575 FEET	NW¼SE¼	33
DIVERSION No. 2	1610 FEET	3025 FEET	NE¼SW¼	33
DIVERSION No. 3	1530 FEET	2285 FEET	NW¼SE¼	33
DIVERSION No. 4	355 FEET	1340 FEET	SW¼SE¼	33

ALL FROM THE SOUTHEAST CORNER OF SECTION 33; AND WITHIN SECTION 33, TOWNSHIP 31 SOUTH, RANGE 15 WEST, W.M.; IN CURRY COUNTY.

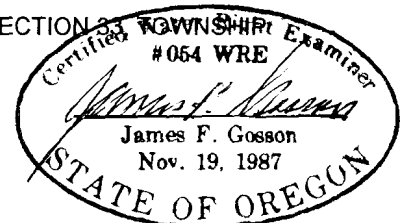

THE PURPOSE OF THIS MAP IS TO IDENTIFY THE LOCATION OF THE WATER RIGHT. IT IS NOT INTENDED TO PROVIDE INFORMATION RELATIVE TO THE LOCATION OF PROPERTY OWNERSHIP BOUNDARY LINES.