

T11S, R26E, W.M.  
Grant County, Oregon

RECEIVED

MAY 02 2022

OWRD

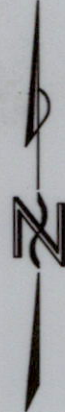
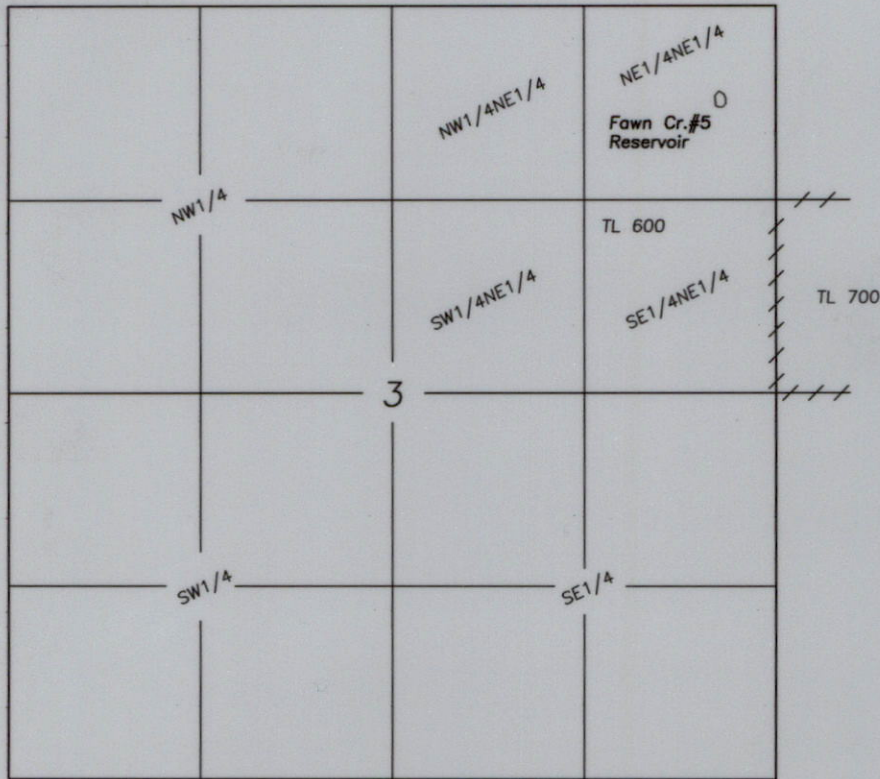

SCALE 1"=1320'

There is no outlet, the dam is located 630' South & 350' West of the NE corner of Section 3.

FINAL PROOF SURVEY  
CLAIM OF BENEFICIAL USE  
FAWN CREEK #5 RESERVOIR

For

Bureau of Land Management

July 16, 2020

LEGEND

Application No. R-59571  
Permit No. R-8005  
Priority 12/21/1979

//// Tax Lot Boundary

A portion of Tax Lot  
15-27 TL800

NOTE: Tax Lot 600 is owned by the BLM and is more that 5200 acres. A portion of the tax lot boundary is shown.

NOTE: The preparation of this map was for the purpose of identifying the location of the proposed water right and has no intent to provide dimensions or location of property ownership lines.

Prepared by  
Cornerstone Surveying, Inc

P.O. BOX 33  
JOHN DAY, OR. 97845  
(541)575-1813  
jwsurvey55@gmail.com

