

WASH

Application No. G 7951

Permit No. G: 7331

Certificate No. 50059

Stream Index, Page No. 2-157

1N/4W-9

Name John F. Wood

By _____

Address 1825 Maple St.

Forest Grove, OR 97116

Date filed March 24, 1977

Priority March 24, 1977

Action suspended until 7-24-81 TS

Return to applicant JUL 21 1977

Date of approval _____

CONSTRUCTION

Date for beginning JUL 21 1978

Date for completion OCT 1 1978

Extended to _____

Date for application of water OCT 1 1979

Extended to _____

PROSECUTION OF WORK

Form "A" filed _____

Form "B" filed Completed

Form "C" filed 9-6-77

FINAL PROOF

Blank mailed MAY 21 1981

Proof received June 25, 1981

Date certificate issued JUL 3 1981

FEEES PAID

Date	Amount	Receipt No.
<u>3-24-77</u>	<u>\$30.00</u>	<u>59266</u>
<u>5-12-77</u>	<u>1.20</u>	<u>60447</u>

Cert. Fee

FEEES REFUNDED

Date	Amount	Check No.

ASSIGNMENTS

Date	To Whom	Address	Volume	Page

REMARKS

Form 130 sent June 24, 1981

Form C

IMPORTANT—This form is a notice to the State Engineer that permittee is ready to make **final proof** to the extent to which the water has actually been applied to the intended use under the terms of the permit. Permittee is cautioned that Certificate of Water Right will be issued based on the extent of the quantity and use as determined by the **final proof** inspection and survey which will be made in response to the filing of this Form C.

NOTE: In the case of an irrigation permit, this Form C should not be mailed to the State Engineer until all of the land described in the permit, which it is intended to irrigate under this permit at any time, has actually been irrigated.
Fill out, detach and mail to the State Engineer, Salem, Oregon 97310, when all of the water has been applied.

Application No. G-7951

NOTICE OF COMPLETE APPLICATION OF WATER TO A BENEFICIAL USE

I, John F. Wood, the holder of Permit No. G 7331
to appropriate the public waters of the state of Oregon, completely applied the waters to a beneficial use in accordance with the terms of said permit, on the 15TH day of AUGUST, 1977

Remarks: _____

IN WITNESS WHEREOF, I have hereunto set my hand this

John F. Wood
(Signature of Applicant)

15TH day of SEPTEMBER, 1977
1825 Maple St, Forest Grove
(Address) OR 97116

RECEIVED
SEP - 6 1977
WATER RESOURCE DEPT
I, SALEM, OREGON

cl
10

T1N. R4W. WM.

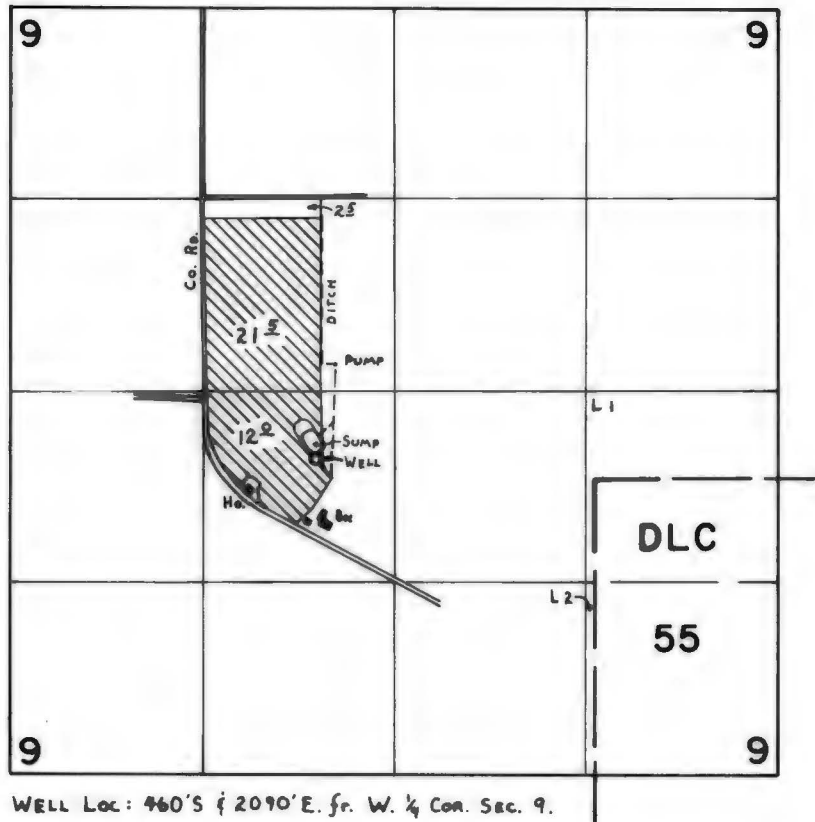

FINAL PROOF SURVEY UNDER

Application No. G-7951 Permit No. G-7331
IN NAME OF

JOHN F. WOOD

Surveyed AUG. 10. 1978. by C. L. HUGHES.

RECEIVED

MAR 24 1977

WATER RESOURCES DEPT.
SALEM, OREGON

CONTRACT FOR THE SALE OF REAL PROPERTY

THIS CONTRACT made this 3rd day of December, 1973, by and between BROWNLEE N. BUSH and RINA MAE BUSH, husband and wife, herein referred to as the "sellers", and JOHN F. WOOD and HELEN L. WOOD, husband and wife, herein referred to as the "buyers".

WITNESSETH:

Sellers hereby agree to sell and buyers agree to purchase all the following described real property situate in Washington County, Oregon, more particularly described as follows:

PARCEL I: Beginning at the NW corner of the SE quarter of the NW quarter of Sec. 9, T1N, R4W, of the Will. Mer., in Washington County, Oregon, and running thence S. 12.20 chains; thence E. 1° 30' S., mainly along drainage ditch, 5.82 chains; thence S. 48° E. along drainage ditch, 6.58 chains; thence E. 2° S. along said drainage ditch, 6.99 chains; thence E. 1° 30' S. along said drainage ditch 10 chains to the SW corner of land sold by George Hines and wife to Chas. H. Bamford; thence N. 17.80 chains; thence W. 21.50 chains; thence N. 37 1/2 links; thence W. 7.50 chains; thence S. 37 1/2 links to the place of beginning; SUBJECT TO roadway 20.0 feet in width along the N. side of said land, and EXCEPTING tract conveyed to Thomas Williams by deed recorded in Deed Book 97, Page 140, and ALSO EXCEPTING tract conveyed to J. D. Mickly by deed recorded in Deed Book 97, Page 141; Beginning at a point N. 88° 30' W. 36 chains from the quarter section corner on the E. side of Sec. 9, T1N, R4W, of the Will. Mer., running thence N. 88° W. 6.80 chains; thence N. 87° 30' W. 6.20 chains; thence N. 48° W. 6.40 chains; thence N. 88° 30' W. along drainage ditch, 5.84 chains to the center of the County Road; thence S. 13 chains to the S. side of County Road; thence Southeasterly along the S. side of the County Road, 6 chains; thence S. 52° E. 5.55 chains; thence S. 4.21 chains; thence E. 2.90 chains; thence N. 2.70 chains; thence S. 62° E. 9.87 chains to a point 30 feet from the NE corner of the Bamford home place; thence N. 5.45 chains; thence E. 2 chains; thence N. 5° E. 17.09 chains to the place of beginning; EXCEPTING THEREFROM those portions thereof lying S. of the County Road, which said portions were conveyed to Charles H. Bamford by deeds recorded in Deed Book 50, Page 374, and Deed Book 107, Page 138; ALSO EXCEPT: Beginning at the SW corner of the NE quarter of the NW quarter of Sec. 9, T1N, R4W, of the Will. Mer., Washington County, Oregon; thence N. 37 1/2 links; thence E. 7.50 chains; thence S. 37 1/2 links; thence W. 7.50 chains to the place of beginning. EXCEPTING THEREFROM that portion thereof lying within the boundaries of Hillside Road.

PARCEL II: Beginning at a point N. 88° 30' W. 36 chains from the quarter section corner on the E. side of Sec. 9, T1N, R4W, Will. Mer., Washington County, Oregon, and running thence N. 88° W. 6.80 chains; thence N. 87° 30' W. 6.20 chains; thence N. 48° W. 6.40 chains

thence N. 88° 30' W. along drainage ditch, 5.84 chains to the center of the County Road; thence S. 13 chains to the S. side of County Road; thence southeasterly along the S. side of the County Road, 6 chains; thence S. 52° E. 5.55 chains; thence continuing southerly along the S. side of the County Road, 12.12 chains, more or less, to the W. line of that tract conveyed to Leisey in Book "M", Page 611, Washington County, Oregon Deed Records; thence N. along the W. line of said tract, 5.45 chains to the NW corner of said Leisey tract; thence E. along the N. line of said tract, 2.0 chains; thence northeasterly 12.09 chains to the place of beginning.

~~SUBJECT TO: (1) Transmission line easement recorded December 18, 1953, in Book 351, Page 509, Deed Records of Washington County. (2) Utility Easement recorded April 3, 1961, in Deed Book 442, Page 509. (Affects Parcel II). (3) Utility easement recorded April 3, 1961, in Deed Book 442, Page 511. (Affects Parcel II) (4) Assessments, rules and regulations of Drainage District No. 1, Washington County, Oregon.~~

~~TOGETHER with the following personal property:~~

- ~~Approximately 1800 feet, 4 inch main line pipe.~~
- ~~Approximately 600 feet, 3 inch lateral with sprinklers.~~
- ~~Approximately 468 feet, 2 inch lateral with sprinklers.~~
- ~~Riser valves~~
- ~~Elbow couplings~~
- ~~1 - 7 1/2 hp, 3ph irrigation pump~~
- ~~1 - 10 hp, 3ph irrigation pump~~

~~RESERVING to sellers all milking equipment in milking parlor and shed and the right to remove the same.~~

~~SECTION 1. PURCHASE PRICE AND PAYMENT TERMS~~

STATE OF OREGON

COUNTY OF WASHINGTON

Proof of Appropriation of Water

RECEIVED

JUN 25 1981

WATER RESOURCES DEPT
SALEM, OREGON

JOHN F. WOOD

of 1825 Maple Street, Forest Grove, State of Oregon 97116,
has applied beneficially the waters of
a well

a tributary of an unnamed stream (West Dairy Creek) for the purpose of
irrigation of 33.5 acres

under Permit No. G-7331 and that the use of said waters has been completed under the
terms of said permit; that the priority of the right dates from

March 24, 1977

that the amount of water for the purposes aforesaid, has been actually beneficially used in the
amount of

0.25 cubic foot per second

or its equivalent in case of rotation, measured at the point of diversion from the well.
The well is located in the NE $\frac{1}{4}$ SW $\frac{1}{4}$, Section 9, T1N, R4W, WM; 460 feet South, 2090
feet East from W $\frac{1}{4}$ corner of Section 9.

The amount of water used for irrigation, together with the amount secured under any other
right existing for the same lands, shall be limited to one-eightieth of one cubic foot per second
per acre, or its equivalent for each acre irrigated and shall be further limited
to a diversion of not to exceed 2 $\frac{1}{2}$ acre feet per acre for each acre irrigated
during the irrigation season of each year,

and shall
conform to such reasonable rotation system as may be ordered by the proper state officer.

A description of the place of use under the right, and to which such right is appurtenant, is
as follows:

21.5 acres SE $\frac{1}{4}$ NW $\frac{1}{4}$
12.0 acres NE $\frac{1}{4}$ SW $\frac{1}{4}$
Section 9
Township 1 North, Range 4 West, WM

I have read the above and foregoing proof of appropriation of water; I know the contents
thereof, and that the facts therein stated are true.

IN WITNESS WHEREOF, I have hereunto set my hand this 18 day of June,

1981.

John F. Wood

mvs

1800-4"
480-3"

DBS-2LL-98
1/10/78
98

N. J. Dairy Creek Wells

Basin 2, Vol. 20A

RECEIVED
MAR 24 1977
WATER RESOURCES DEPT.
SEASIDE

Permit No. G-7331
APPLICATION FOR A PERMIT
G-7951

To Appropriate the Ground Waters of the State of Oregon

I, John F. Wood (Name of applicant)
of 1825 Maple St., Forest Grove (Postoffice Address), county of Washington
state of Oregon 97116, do hereby make application for a permit to appropriate the following described ground waters of the state of Oregon, SUBJECT TO EXISTING RIGHTS:

If the applicant is a corporation, give date and place of incorporation

A Well

1. Give name of nearest stream to which the well, tunnel or other source of water development is situated trib. of un-named stream (Name of stream) tributary of West Dairy Creek

2. The amount of water which the applicant intends to apply to beneficial use is 0.4225 cubic feet per second or _____ gallons per minute.

3. The use to which the water is to be applied is irrigation of 33 1/2 AC

4. The well or other source is located 460 S and 2090 E from the SW corner of Section 9 (Section or subdivision)

(If preferable, give distance and bearing to section corner)
(If there is more than one well, each must be described. Use separate sheet if necessary)
being within the NE 1/4 of Sec 9 of Sec. 9, Twp. 1 N., R. 4 W., W. M., in the county of Washington

5. The pipe line (Canal or pipe line) to be 30 feet in length, terminating in the S.E. 1/4 of N.W. 1/4 of Sec. 9, Twp. 1 N., R. 4 W., W. M., the proposed location being shown throughout on the accompanying map.

6. The name of the well or other works is _____

DESCRIPTION OF WORKS

7. If the flow to be utilized is artesian, the works to be used for the control and conservation of the supply when not in use must be described.

Well is capped and controlled by a 6 inch valve.

8. The development will consist of one (Give number of wells, tunnels, etc.) having a diameter of 6 inches and an estimated depth of 450 feet. It is estimated that _____ feet of the well will require steel (Kind) casing. Depth to water table is estimated _____ (Feet)

24237
45221

G-5381
G-5914

CANAL SYSTEM OR PIPE LINE—

9. (a) Give dimensions at each point of canal where materially changed in size, stating miles from headgate. At headgate: width on top (at water line) feet; width on bottom feet; depth of water feet; grade feet fall per one thousand feet.

(b) At miles from headgate: width on top (at water line) feet; width on bottom feet; depth of water feet; grade feet fall per one thousand feet.

(c) Length of pipe, 1000 ft.; size at intake 6 in.; in size at 30 ft. from intake 4 in.; size at place of use 4 in.; difference in elevation between intake and place of use, - 0 - ft. Is grade uniform? yes Estimated capacity, sec. ft.

10. If pumps are to be used, give size and type centrifugal pump

Give horsepower and type of motor or engine to be used 10 hp electric motor

11. If the location of the well, tunnel, or other development work is less than one-fourth mile from a natural stream or stream channel, give the distance to the nearest point on each of such channels and the difference in elevation between the stream bed and the ground surface at the source of development

x 12. Location of area to be irrigated, or place of use

Township N. or S.	Range E or W of Willamette Meridian	Section	Forty-acre Tract	Number Acres To Be Irrigated
1 N.	4 W. ✓	9 ✓	S.E. 1/4 of N.W. 1/4	23.5
1 N.	4 W.	9	N.E. 1/4 of S.W. 1/4	10.0
				<u>33.5</u>
			SE NW ✓	<u>21.5</u> ✓
			NE SW ✓	<u>12.0</u> ✓
				<u>33.5</u>

(If more space required, attach separate sheet)

y. Character of soil loam and clay

Kind of crops raised grain and hay

MUNICIPAL SUPPLY—

13. To supply the city of
in county, having a present population of
and an estimated population of in 19.....

ANSWER QUESTIONS 14, 15, 16, 17 AND 18 IN ALL CASES

- 14. Estimated cost of proposed works, \$.....
- 15. Construction work will begin on or before completed
- 16. Construction work will be completed on or before completed
- 17. The water will be completely applied to the proposed use on or before June, 1977.....

18. If the ground water supply is supplemental to an existing water supply, identify any application for permit, permit, certificate or adjudicated right to appropriate water, made or held by the applicant. *NA*

John T. Wood
(Signature of applicant)

Remarks:

Well is artesian, water is discharged into a holding pond 200' x 75' x 8' water is then pumped onto the field.

STATE OF OREGON, }
County of Marion, } ss.

This is to certify that I have examined the foregoing application, together with the accompanying maps and data, and return the same for

In order to retain its priority, this application must be returned to the State Engineer, with corrections on or before, 19.....

WITNESS my hand this day of, 19.....

..... STATE ENGINEER
By ASSISTANT

STATE OF OREGON, }
County of Marion, } ss.

PERMIT

This is to certify that I have examined the foregoing application and do hereby grant the same, SUBJECT TO EXISTING RIGHTS and the following limitations and conditions:

The right herein granted is limited to the amount of water which can be applied to beneficial use and shall not exceed 0.25 ~~0.42~~ cubic feet per second measured at the point of diversion from the well or source of appropriation, or its equivalent in case of rotation with other water users, from a well.

The use to which this water is to be applied is irrigation of 35 1/2 Ac

If for irrigation, this appropriation shall be limited to 1/80th of one cubic foot per second or its equivalent for each acre irrigated and shall be further limited to a diversion of not to exceed 2 1/2 acre feet per acre for each acre irrigated during the irrigation season of each year;

and shall be subject to such reasonable rotation system as may be ordered by the proper state officer.

The well shall be cased as necessary in accordance with good practice and if the flow is artesian the works shall include proper capping and control valve to prevent the waste of ground water.

The works constructed shall include an air line and pressure gauge or an access port for measuring line, adequate to determine water level elevation in the well at all times.

The permittee shall install and maintain a weir, meter, or other suitable measuring device, and shall keep a complete record of the amount of ground water withdrawn.

The priority date of this permit is March 24, 1977

Actual construction work shall begin on or before July 21, 1978 and shall thereafter be prosecuted with reasonable diligence and be completed on or before October 1, 1978

Complete application of the water to the proposed use shall be made on or before October 1, 1979

WITNESS my hand this 21st day of July, 1977

James E. Selmon
Water Resources Director

Application No. G-7951
Permit No. G-7331

PERMIT

TO APPROPRIATE THE GROUND
WATERS OF THE STATE
OF OREGON

This instrument was first received in the
office of the State Engineer at Salem, Oregon,
on the 29th day of March
1977, at 3:15 o'clock P. M.

Returned to applicant:

Approved:

Recorded in book No. of
Ground Water Permits on page

STATE ENGINEER
Drainage Basin No. 2 page 157

Info: Dr. Wood. Land is irrigated as applied.

Source: A well. W.L. is zero (artesian), 6" casing; well is 165' deep.

pump - Century $1\frac{1}{2}$ HP @ 3450 RPM } pumps water from
Universal Vert cent. $1\frac{1}{2} \times 1"$ } well to a pond (open ditch) ^{3" pipe}

Pond is 175' x 100' x 8' deep. No drain, no spillway. Two 4" overflow pipes discharge water from pond into 3x5x3' deep ditch.

pump - GE $7\frac{1}{2}$ HP @ 3500 RPM Pacific CDD 3x2 pumps fr. ditch to "rr" area

Use: Irrigation of pastureland for dairy stock.

Equip: pipe - 4" Alum main - 1880'

3" Alum laterals - 480'

heads - 13 RB 30's $\frac{1}{64} \times \frac{3}{32}$ (12 max)

Lift: see quad.

Tie: DBS - 2LL - 98

AT 65 psi

$$\text{pump } \frac{(6.61)(7.5)}{30 + 165.1} = .254 \text{ cfs}$$

$$\text{heads } \frac{(12)(9.0)}{450} = .240 \text{ cfs}$$

Chris Hughes

FE

8/10/78

$$1\frac{1}{2} \text{ hp @ } 75\% \text{ eff w/ } 15' \text{ hd} = 300 \text{ gpm}$$

$$7\frac{1}{2} \text{ hp @ } 200' \text{ hd} = 112 \text{ gpm} = 0.25 \text{ cfs}$$

$$\text{@ } 75 \quad 9.55 \times 12 = 114.5 = 0.255 \text{ cfs.}$$
$$12 \text{ hd @ } 80 \text{ PSI} = (9.87 \times 12) = 118.5 \text{ gpm} = 0.26 \text{ cfs.}$$



Applications

G-7951 24237
G-10789 63802

USING THE ROAD INTERSECTION AS THE NW COR
SE¹NW⁴ Sec 9 [which appear correct from the
L.D. FOR THE NORTH PORTION (PARCEL I of L.D. in Appl G-7951)]. THERE
APPEARS TO BE AN ERROR IN THE BEARING OF THE
LINE (DRAINAGE DITCH) WHICH STARTS THE L.D. FOR PARCEL II (G-7951).
THE BEARING ON THE DITCH APPEARS TO BE N 87° W INSTEAD
OF N 82° 30' W called in L.D. THEREFORE Appl. 24237 HAS
BEEN REDRAFTED SO ALL LAND AGREES WITH THE
PARCEL I L.D.

LMT
5/8/84

RECEIVED

MAR 24 1977

WATER RESOURCES DEPT.
SEASIDE, OREGON

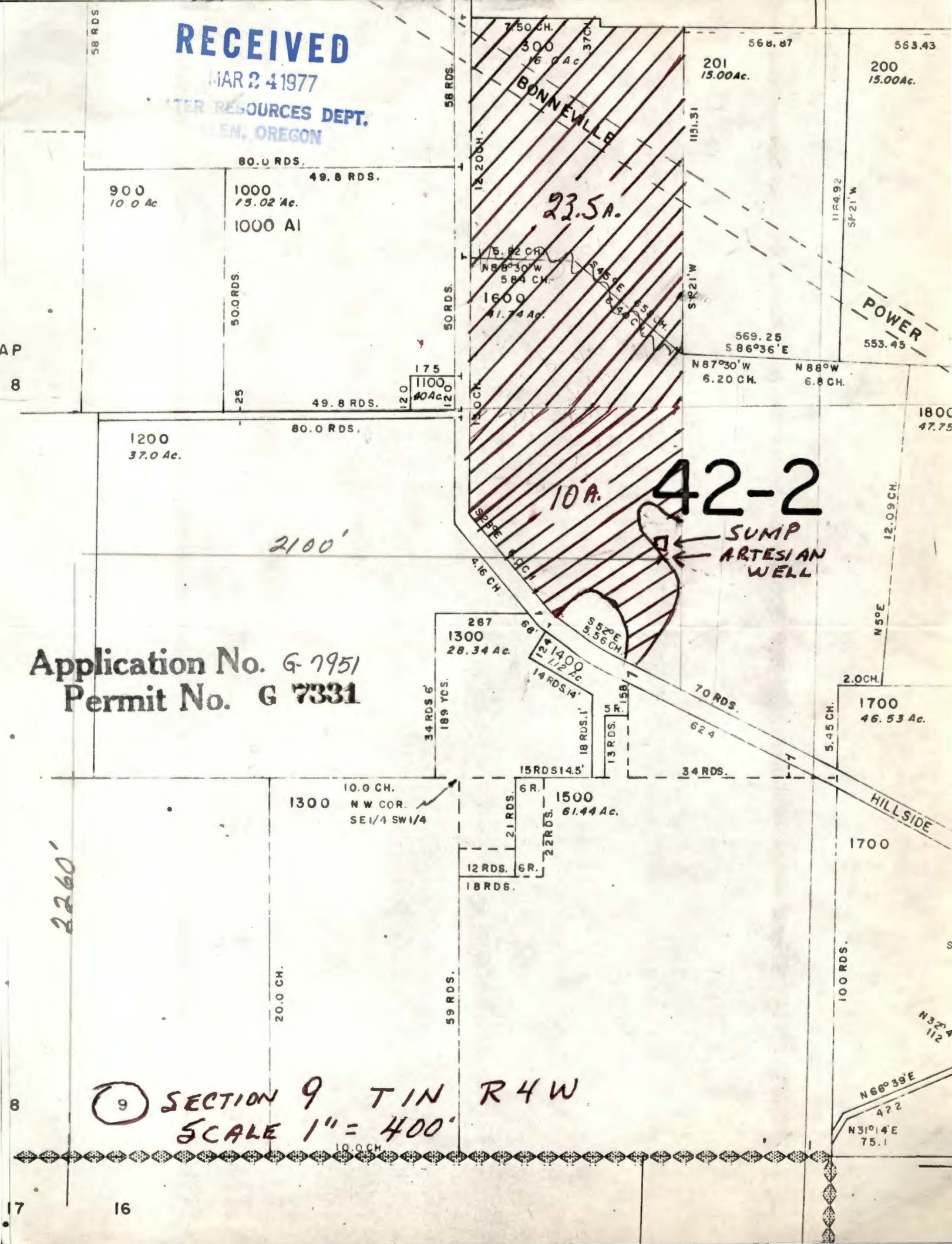

Application No. G 7951
Permit No. G 7331

SECTION 9 T1N R4W
SCALE 1" = 400'

378-3066

October 30, 1979

DUANE DEFREES
FEDERAL LAND BANK
876 S E OAK STREET
HILLSBORO OR 97123

RE: File No. G-7951

Dear Mr. Defrees:

Enclosed is the copy of the form C submitted by John F. Wood relative to his permit No. G-7331.

Our receipt No. 14750 covering the copying fee of \$1.00 you submitted is also enclosed.

Sincerely,

Wayne J. Overcash
Water Rights Engineer

WJO:jfv
enclosures

Federal Land Bank Association of Hillsboro

876 S.E. Oak Street / Hillsboro, Oregon 97123
Telephone: 648-0704

WADE H. PETERSON, MANAGER

TILLAMOOK BRANCH:

2211 THIRD STREET / P. O. BOX 271
TILLAMOOK, OREGON 97141
TELEPHONE: 842-8543

LYLE E. SPECHT, BRANCH MANAGER



RECEIVED
OCT 29 1979
WATER RESOURCES DEPT
SALEM, OREGON

October 25, 1979

Mr. Wayne Overcash
State of Oregon Water Resources Dept.
State Office Building
Salem, Oregon 97308

Re: 180624 - Wood

Dear Mr. Overcash:

We are enclosing a Federal Land Bank draft in the amount of \$1 for which we would like you to mail us a copy of Form "C" of Permit #G7331. This is in the name of John F. and Helen L. Wood of 570 N. 10th Space 100, Cornelius, Oregon 97113.

Very truly yours,

A handwritten signature in cursive script that reads "Duane Defrees".

Duane Defrees
Assistant Manager

DD:dm
ENC.



John F. Wood
1825 Maple St.
Forest Grove, OR 97116

August 1, 1977

G 7951

G 7331

378-3066

G-7951

13 May 1977

John F. Wood
1825 Maple Street
Forest Grove, Oregon 97116

Dear Mr. Wood:

Thank you for the additional \$1.20 recording fee
in support of your application No. G-7951.

Your application is now satisfactory and a permit
will be issued in 30 to 60 days.

Sincerely,

Vestal R. Garner
Water Rights Engineer

VRG:lcj
encl: Receipt No. 60447

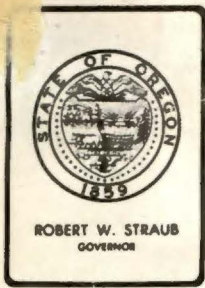

Water Resources Department

1178 CHEMEKETA STREET N.E., SALEM, OREGON 97310 PHONE 378-3066

April 26, 1977

G-7951

John F. Wood
1825 Maple Street
Forest Grove, Oregon 97116

Dear Mr. Wood:

We have received your map, legal land description, fees of \$30.00 and application for a permit to use 0.4225 cubic foot per second of water from a well for irrigation of 33.5 acres. For reference, your application is numbered G-7951.

The permit examination fee is \$20.00; the recording fee is \$10.00 for the first 30 acres and 30 cents for each additional acre. Therefore, we will need an additional \$1.20 recording fee.

Upon receipt of the additional fee in the amount of \$1.20, your application will be satisfactory for issuance of a permit.

Sincerely,

Vestal R. Garner
Water Rights Engineer

BM/VRG:cjw