

# FINAL PROOF SURVEY MAP IN THE NAME OF SEA WIND FARMS, INC.

APPLICATION R-73733  
S-73734

PERMIT R-12095  
52993

SECTIONS 29 & 30, TOWNSHIP 31 SOUTH, RANGE 15 WEST, W.M.

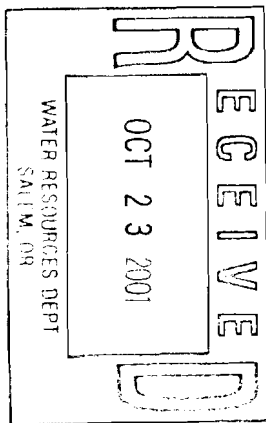
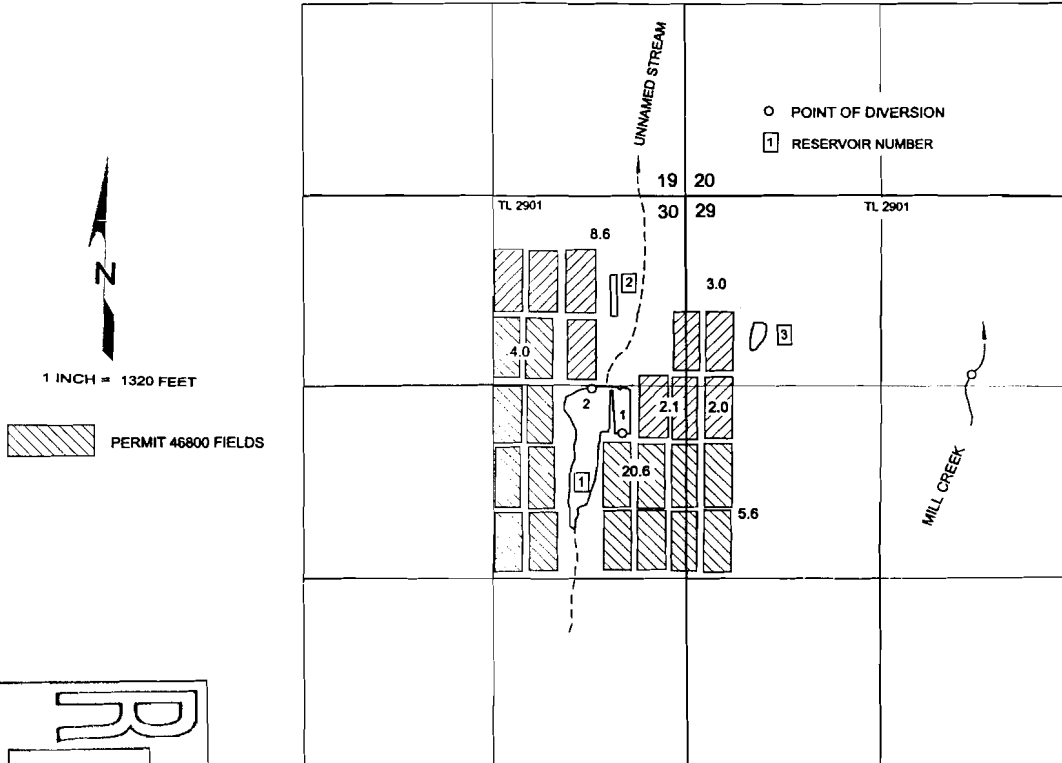

THE MILL CREEK POINT OF DIVERSION IS LOCATED 1230 FEET SOUTH AND 1940 FEET EAST FROM THE NORTHEAST CORNER OF SECTION 30 BEING WITHIN THE NE $\frac{1}{4}$  NW $\frac{1}{4}$  OF SECTION 29, TOWNSHIP 31 SOUTH, RANGE 15 WEST, W.M.; AND

THE UNNAMED STREAM POINTS OF DIVERSION ARE LOCATED AS FOLLOWS: NUMBER ONE IS 1650 FEET SOUTH AND 420 FEET WEST AND NUMBER TWO IS 1340 FEET SOUTH AND 640 FEET WEST; BOTH BEING WITHIN THE SE $\frac{1}{4}$  NE $\frac{1}{4}$  OF SECTION 30, TOWNSHIP 31 SOUTH, RANGE 15 WEST, W.M.; AND

THE DAM FOR RESERVOIR ONE IS LOCATED 1320 FEET SOUTH AND 540 FEET WEST, WITHIN THE SE $\frac{1}{4}$  NE $\frac{1}{4}$ ; AND THE CENTER OF RESERVOIR TWO IS LOCATED 490 FEET SOUTH AND 670 FEET WEST, WITHIN THE NE $\frac{1}{4}$  NE $\frac{1}{4}$ ; BOTH FROM THE NORTHEAST CORNER OF SECTION 30 AND WITHIN SECTION 30, TOWNSHIP 31 SOUTH, RANGE 15 WEST, W.M.; AND

THE CENTER OF RESERVOIR THREE IS LOCATED 960 FEET SOUTH AND 490 FEET WEST FROM THE NORTHEAST CORNER OF SECTION 30; BEING WITHIN THE NW $\frac{1}{4}$  NW $\frac{1}{4}$  OF SECTION 29, TOWNSHIP 31 SOUTH, RANGE 15 WEST, W.M.; ALL WITHIN CURRY COUNTY.

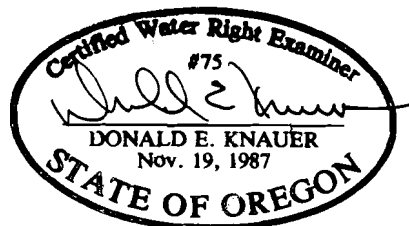

THE PURPOSE OF THIS MAP IS TO IDENTIFY THE LOCATION OF THE WATER RIGHT. IT IS NOT INTENDED TO PROVIDE INFORMATION RELATIVE TO THE LOCATION OF PROPERTY OWNERSHIP BOUNDARY LINES.