

# T.5S. R.4W. Section 10, W.M.

4 3  
9 10

Proposed Well 1 is located 1,585 feet south and 970 feet east from the NW corner, Section 10.

Proposed Well 2 is located 1,510 feet south and 1,215 feet east from the NW corner, Section 10.

Proposed Well 3 (YAMH 1649) is located 965 feet south and 1,275 feet east from the NW corner, Section 10.

Proposed Well 4 is located 1,390 feet south and 1,090 feet east from the NW corner, Section 10.

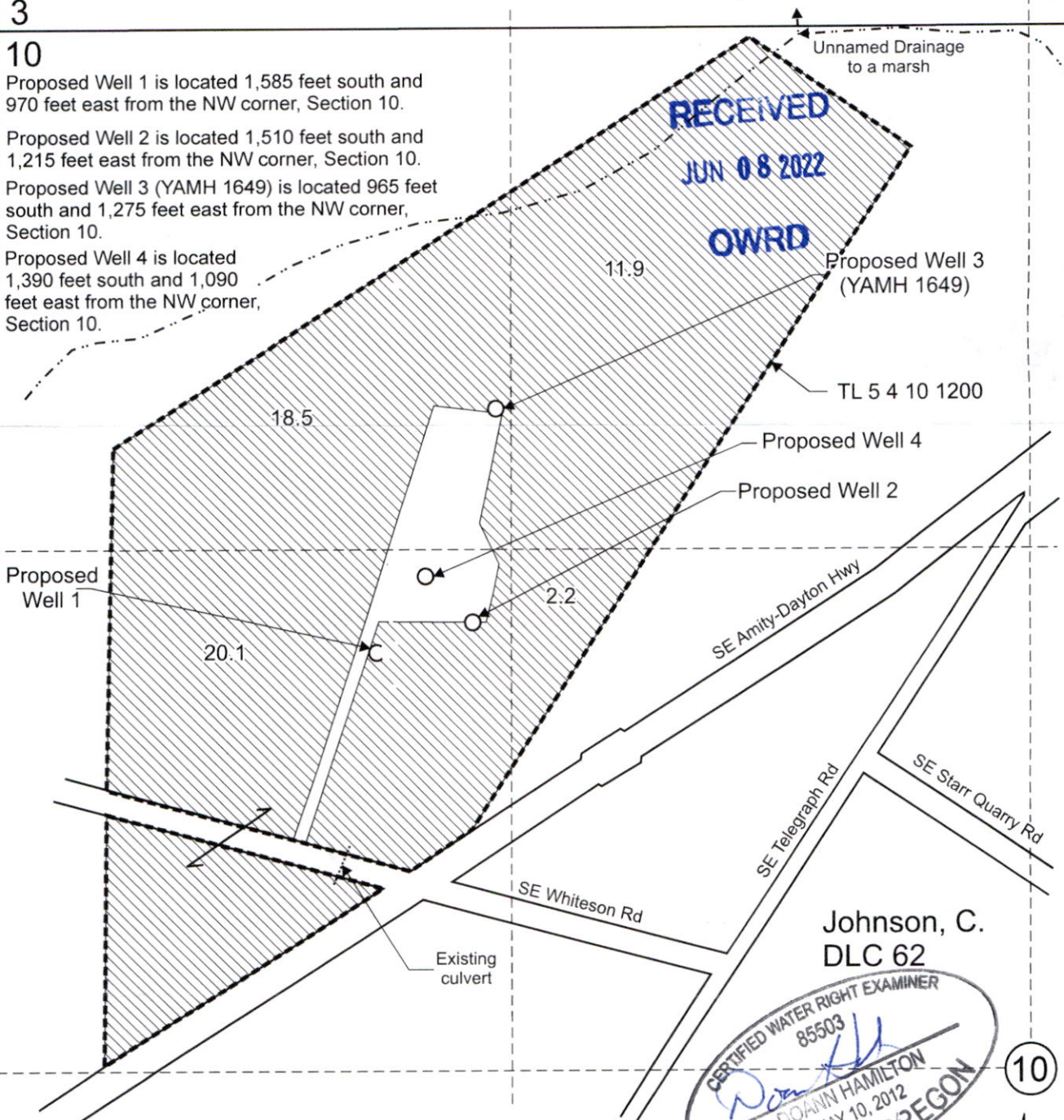

Area (52.7 Acres) to be irrigated.

Tax lot boundary

Donation Land Claim boundary

Scale: 1" = 400'

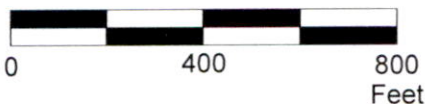

This map was prepared for the purpose of identifying the location of a water right only and is not intended to provide legal dimensions or location of property ownership lines.

Johnson, C.  
DLC 62  
CERTIFIED WATER RIGHT EXAMINER  
85503  
*Don Hamilton*  
DOAN HAMILTON  
MAY 10, 2012  
STATE OF OREGON  
EXPIRES: *June 30, 2023*

10



Water Right Application Map

Pacific Hydro-Geology Inc.

Dan Chapman  
T.5S. R.4W. Section 10, W.M.

6/5/2022