

Daniel & Elizabeth Withers Map of Proposed New Water Rights Primary

T 31 S, R 16 E
Sec 3 & 10

Map 1 of 2

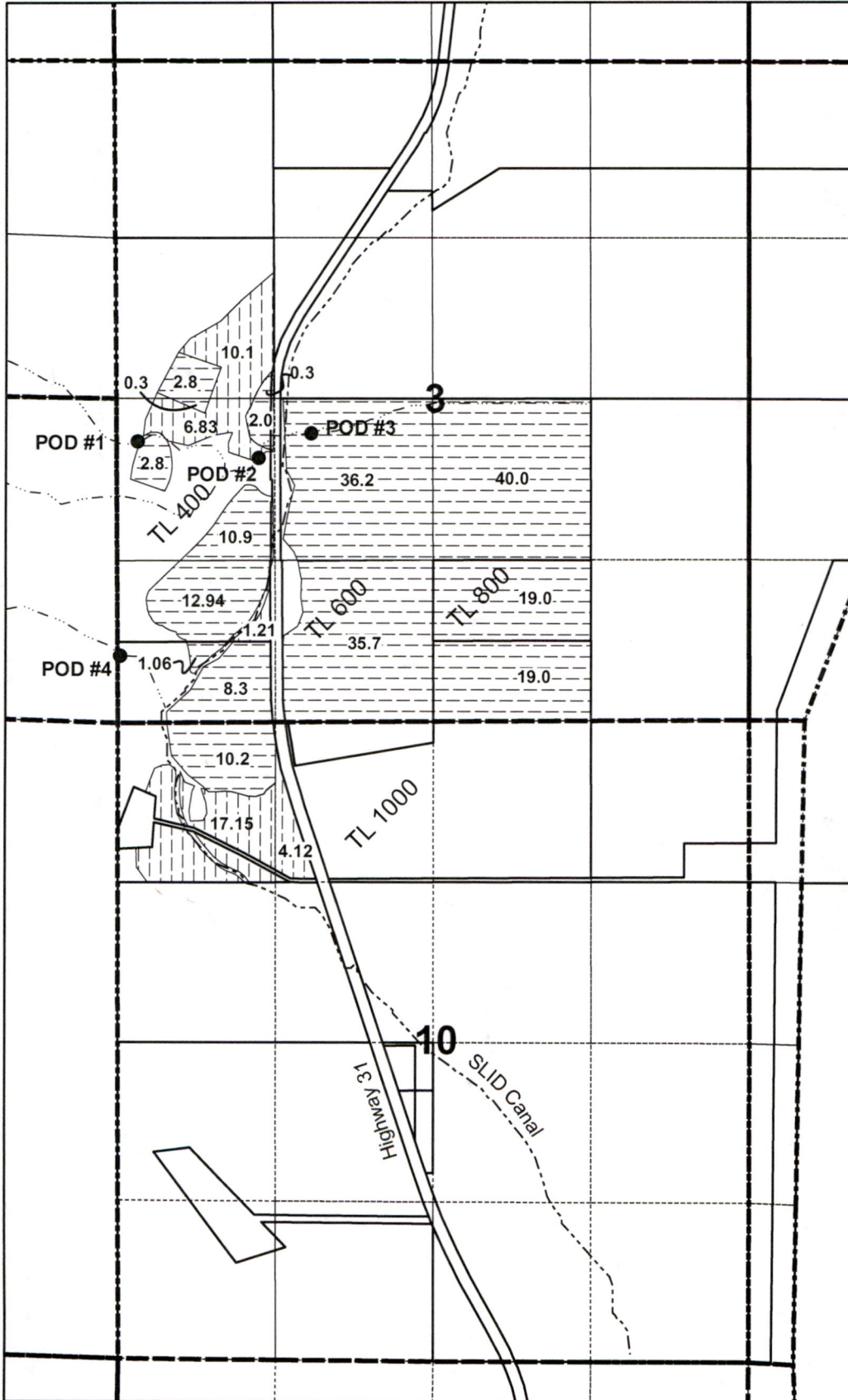

Legend

- Point of Diversion (POD)
- New Water Right Primary
39.41 ac. season 3-1 to 9-30
- New Water Right Primary
201.5 ac. season 3-1 to 4-30
- - - - - Unnamed creek
- - - - - Summer Lake ID Canal

POD #1- 2337 feet North & 157 feet East

POD #2- 2200 feet North & 1161 feet East

POD #3- 2404 feet North & 1594 feet East

POD #4- 560 feet North & 16 feet East

All from the SW Corner of Section 3
T 31 S, R 16 E.



1 inch = 1,320 feet

Daniel & Elizabeth Withers Map of Proposed New Water Rights Supplemental

T 31 S, R 16 E
Sec 3 & 10





Map 2 of 2

RECEIVED

NOV 01 2021

OWRD

Legend

-  New Water Right 100.4 ac Supplemental 5-1 to 9-30
-  Point of Diversion (POD)
-  Unnamed creek
-  Summer Lake ID Canal

POD #1- 2337 feet North & 157 feet East

POD #2- 2200 feet North & 1161 feet East

POD #3- 2404 feet North & 1594 feet East

POD #4- 560 feet North & 16 feet East

All from the SW Corner of Section 3
T 31 S, R 16 E.



1 inch = 1,320 feet

