

**FINAL PROOF SURVEY MAP**  
**IN THE NAME OF JAMES W. JACKSON**

SECTION 28, T 28 S, R 14 W, W.M.

APPLICATION R 69506  
 APPLICATION 69507

PERMIT R 11389  
 PERMIT 51271

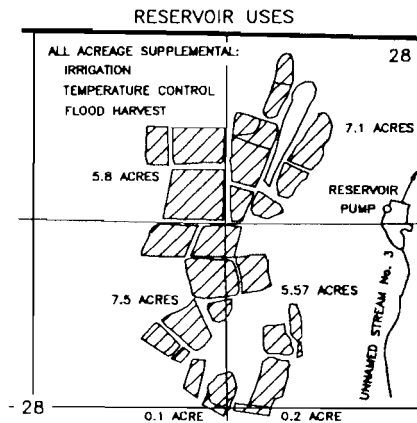
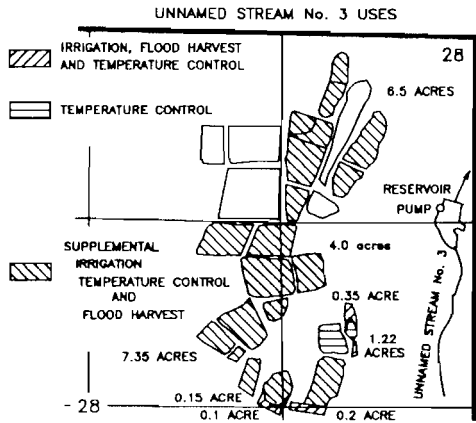
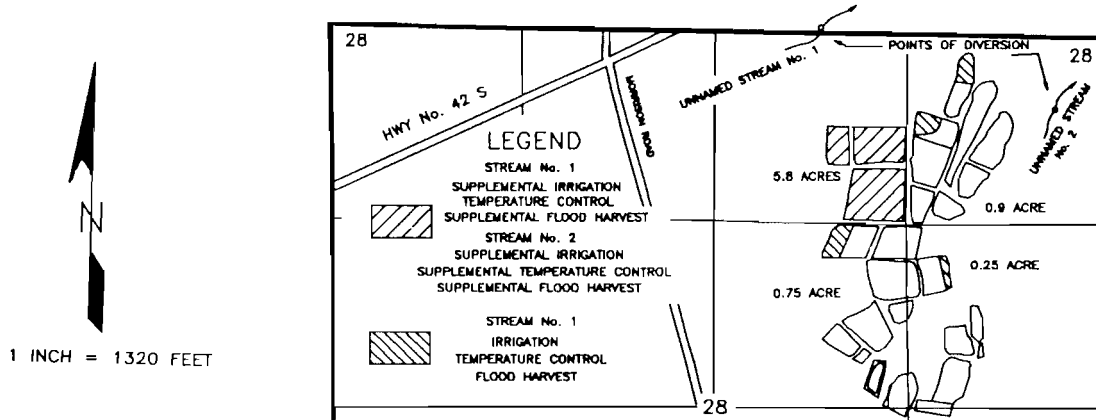

THE POINTS OF DIVERSION ARE LOCATED AS FOLLOWS:

DIVERSION	NORTH/SOUTH	WEST	¼ ¼	SECTION
UNNAMED STREAM No. 1	60 FEET NORTH	1,910 FEET	SW¼ SE¼	21
UNNAMED STREAM No. 2	490 FEET SOUTH	330 FEET	NE¼ NE¼	28
UNNAMED STREAM No. 3 (RESERVOIR)	1,130 FEET SOUTH	130 FEET	NE¼ NE¼	28
RESERVOIR PUMP	1,180 FEET SOUTH	230 FEET	NE¼ NE¼	28

ALL FROM THE NORTHEAST CORNER OF SECTION 28; BEING WITHIN SECTIONS 21 AND 28, TOWNSHIP 28 SOUTH, RANGE 14 WEST, W.M.; IN COOS COUNTY.

THE PURPOSE OF THIS MAP IS TO IDENTIFY THE LOCATION OF THE WATER RIGHT. IT IS NOT INTENDED TO PROVIDE INFORMATION RELATIVE TO THE LOCATION OF PROPERTY OWNERSHIP BOUNDARY LINE(S).