

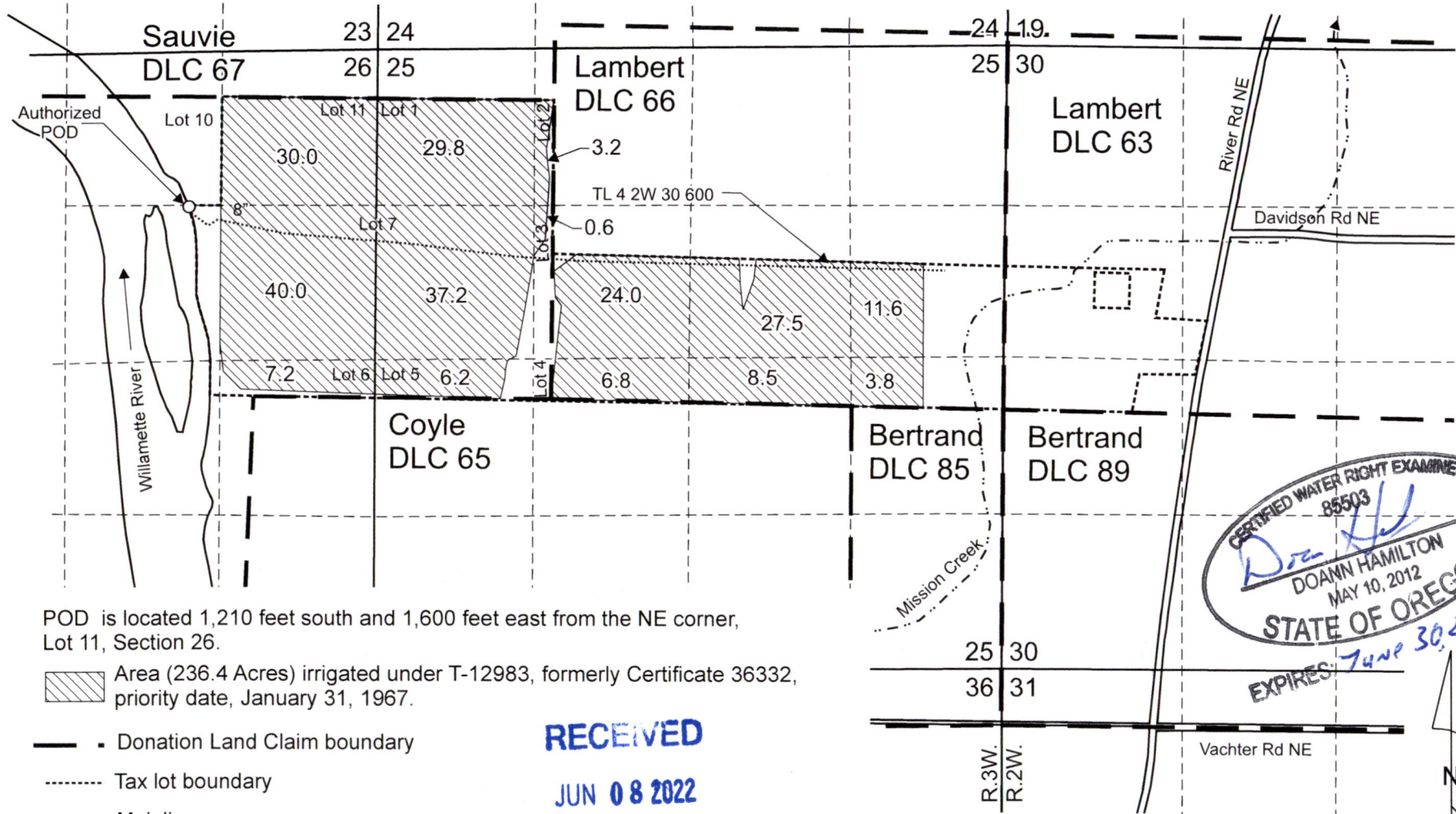



T.4S. R.3W. Sec. 25 & 26, W.M.



POD is located 1,210 feet south and 1,600 feet east from the NE corner, Lot 11, Section 26.

 Area (236.4 Acres) irrigated under T-12983, formerly Certificate 36332, priority date, January 31, 1967.

-  Donation Land Claim boundary
-  Tax lot boundary
-  Mainlines

RECEIVED

JUN 08 2022

OWRD

Scale: 1" = 1,320'



This map was prepared for the purpose of identifying the location of a water right only and is not intended to provide legal dimensions or location of property ownership lines.

Pacific Hydro-Geology Inc.

05/2022

Claim of Beneficial Use Map
T-12983, formerly Certificate 36332

Tony Smith
T.4S. R.3W. Sec. 25 & 26, W.M.