

Application for a Permit to Use Groundwater



Oregon Water Resources Department
725 Summer Street NE, Suite A
Salem, Oregon 97301-1266
503-986-0900
www.oregon.gov/OWRD

SECTION 1: APPLICANT INFORMATION AND SIGNATURE

Applicant

NAME			PHONE (HM)		
PHONE (WK)		CELL		FAX	
ADDRESS					
CITY		STATE	ZIP	E-MAIL*	

Organization

NAME NORTHWEST HOUSING ALTERNATIVES, ATTN: CLAYTON CROWHURST			PHONE 503-654-1007		FAX
ADDRESS 2316 SE WILLARD ST.					CELL
CITY MILWAUKIE		STATE OR	ZIP 97222	E-MAIL* CROWHURST@NWHOUSING.ORG	

Agent – The agent is authorized to represent the applicant in all matters relating to this application.

AGENT / BUSINESS NAME GSI WATER SOLUTIONS, INC. ATTN: BRUCE BRODY-HEINE			PHONE 971-200-8519		FAX
ADDRESS 147 SW SHEVLIN HIXON DR., SUITE 201					CELL
CITY BEND		STATE OR	ZIP 97702	E-MAIL* BBHEINE@GSIWS.COM	

Note: Attach multiple copies as needed

* By providing an e-mail address, consent is given to receive all correspondence from the Department electronically. (Paper copies of the proposed and final order documents will also be mailed.)

By my signature below I confirm that I understand:

- I am asking to use water specifically as described in this application.
- Evaluation of this application will be based on information provided in the application.
- I cannot use water legally until the Water Resources Department issues a permit.
- Oregon law requires that a permit be issued before beginning construction of any proposed well, unless the use is exempt. Acceptance of this application does not guarantee a permit will be issued.
- If I get a permit, I must not waste water.
- If development of the water use is not according to the terms of the permit, the permit can be cancelled.
- The water use must be compatible with local comprehensive land-use plans.
- Even if the Department issues a permit, I may have to stop using water to allow senior water-right holders to get water to which they are entitled.

I (we) affirm that the information contained in this application is true and accurate.

	<small>Digitally signed by Clayton Crowhurst DN: cn=Clayton Crowhurst, o=Oregon Water Resources Department Reason: I have signed the document with my digital signature</small> Clayton Crowhurst Applicant Signature	Clayton Crowhurst, Housing Developer Print Name and Title if applicable	6/22/22 Date
	Applicant Signature	Print Name and Title if applicable	Date

RECEIVED

JUL 05 2022

Groundwater Application — Page 1

Rev. 07/21

OWRD

For Department Use: App. Number: _____

SECTION 2: PROPERTY OWNERSHIP

Please indicate if you own all the lands associated with the project from which the water is to be diverted, conveyed, and used.

- YES, there are no encumbrances.
- YES, the land is encumbered by easements, rights of way, roads or other encumbrances.
- NO, I have a recorded easement or written authorization permitting access.
- NO, I do not currently have written authorization or easement permitting access.
- NO, written authorization or an easement is not necessary, because the only affected lands I do not own are state-owned submersible lands, and this application is for irrigation and/or domestic use only (ORS 274.040).
- NO, because water is to be diverted, conveyed, and/or used only on federal lands.

Affected Landowners: List the names and mailing addresses of all owners of any lands that are not owned by the applicant and that are crossed by the proposed ditch, canal or other work, even if the applicant has obtained written authorization or an easement from the owner. *(Attach additional sheets if necessary).*

OAH Limited Partnership, 2316 SE Willard St., Milwaukie, OR 97222
Ontario Acquisition LLC, 2316 SE Willard St., Milwaukie, OR 97222

Please see Attachment B

Legal Description: You must provide the legal description of: 1. The property from which the water is to be diverted, 2. Any property crossed by the proposed ditch, canal or other work, and 3. Any property on which the water is to be used as depicted on the map. **Please see Attachment C**

SECTION 3: WELL DEVELOPMENT

WELL NO.	NAME OF NEAREST SURFACE WATER	IF LESS THAN 1 MILE:	
		DISTANCE TO NEAREST SURFACE WATER	ELEVATION CHANGE BETWEEN NEAREST SURFACE WATER AND WELL HEAD
WELL 1	SNAKE RIVER	1322 FT	21 FT

Please provide any information for your existing or proposed well(s) that you believe may be helpful in evaluating your application. For existing wells, describe any previous alteration(s) or repair(s) not documented in the attached well log or other materials *(attach additional sheets if necessary).*

Please see Attachment D for well log.

RECEIVED

JUL 05 2022

OWRD

For Department Use: App. Number: _____

SECTION 3: WELL DEVELOPMENT, continued

Total maximum rate requested: 0.03 cfs (each well will be evaluated at the maximum rate unless you indicate well-specific rates and annual volumes in the table below).

The table below must be completed for each source to be evaluated or the application will be returned. If this is an existing well, the information may be found on the applicable well log. *(If a well log is available, please submit it in addition to completing the table.)* If this is a proposed well, or well-modification, consider consulting with a licensed well driller, geologist, or certified water right examiner to obtain the necessary information.

OWNER'S WELL NAME OR NO.	PROPOSED	EXISTING	WELL ID (WELL TAG) NO.* OR WELL LOG ID**	FLOWING ARTESIAN	CASING DIAMETER	CASING INTERVALS (IN FEET)	PERFORATED OR SCREENED INTERVALS (IN FEET)	SEAL INTERVALS (IN FEET)	MOST RECENT STATIC WATER LEVEL & DATE (IN FEET)	PROPOSED USE			
										SOURCE AQUIFER***	TOTAL WELL DEPTH	WELL-SPECIFIC RATE (GPM)	ANNUAL VOLUME (ACRE-FEET)
WELL 1	<input type="checkbox"/>	<input checked="" type="checkbox"/>	L53139 MALH 52101	<input type="checkbox"/>	8 IN.	+1 ½ – 38 ½'	26 – 38'	0 – 18'	19' 3/10/2021	GRAVEL AND SAND	38.5'	0.03 CFS	4.36 AF
	<input type="checkbox"/>	<input type="checkbox"/>		<input type="checkbox"/>									
	<input type="checkbox"/>	<input type="checkbox"/>		<input type="checkbox"/>									
	<input type="checkbox"/>	<input type="checkbox"/>		<input type="checkbox"/>									
	<input type="checkbox"/>	<input type="checkbox"/>		<input type="checkbox"/>									
	<input type="checkbox"/>	<input type="checkbox"/>		<input type="checkbox"/>									
	<input type="checkbox"/>	<input type="checkbox"/>		<input type="checkbox"/>									
	<input type="checkbox"/>	<input type="checkbox"/>		<input type="checkbox"/>									

* Licensed drillers are required to attach a Department-supplied Well Tag, with a unique Well ID or Well Tag Number to all new or newly altered wells. Landowners can request a Well ID for existing wells that do not have one. The Well ID is intended to serve as a unique identification number for each well.
 ** A well log ID (e.g. MARI 1234) is assigned by the Department to each log in the agency's well log database. A separate well log is required for each subsequent alteration of the well.
 *** Some aquifer examples: Troutdale Formation, gravel and sand, alluvium, basalt, bedrock, etc.

OWRD

RECEIVED
JUL 05 2022

For Department Use: App. Number: _____

SECTION 4: SENSITIVE, THREATENED OR ENDANGERED FISH SPECIES PUBLIC INTEREST INFORMATION

This information must be provided for your application to be accepted as complete. The Water Resources Department will determine whether the proposed use will impair or be detrimental to the public interest with regard to sensitive, threatened or endangered fish species if your proposed groundwater use is determined to have the potential for substantial interference with nearby surface waters.

To answer the following questions, use the map provided in [Attachment 3](#) or the link below to determine whether the proposed point of appropriation (POA) is located in an area where the Upper Columbia, the Lower Columbia, and/or the Statewide public interest rules apply.

For more detailed information, click on the following link and enter the TRSQQ or the Lat/Long of a POA and click on "Submit" to retrieve a report that will show which section, if any, of the rules apply:
https://apps.wrd.state.or.us/apps/misc/lkp_trsqq_features/

If you need help to determine in which area the proposed POA is located, please call the customer service desk at (503) 986-0801.

Upper Columbia - OAR 690-033-0115 thru -0130

Is the well or proposed well located in an area where the Upper Columbia Rules apply?

Yes No

If yes, you are notified that the Water Resources Department will consult with numerous federal, state, local and tribal governmental entities so it may determine whether the proposed use is consistent with the "Columbia River Basin Fish and Wildlife Program" adopted by the Northwest Power Planning Council in 1994 for the protection and recovery of listed fish species. The application may be denied, heavily conditioned, or if appropriate, mitigation for impacts may be needed to obtain approval for the proposed use.

If yes, and if the Department determines that proposed groundwater use has the potential for substantial interference with nearby surface waters:

- I understand that the permit, if issued, will not allow use during the time period April 15 to September 30, except as provided in OAR 690-033-0140.
- I understand that the Department of Environmental Quality will review my application to determine if the proposed use complies with existing state and federal water quality standards.
- I understand that I will install and maintain water use measurement and recording devices as required by the Water Resources Department, and comply with recording and reporting permit condition requirements.

RECEIVED

JUL 05 2022

OWRD

Lower Columbia - OAR 690-033-0220 thru -0230

Is the well or proposed well located in an area where the Lower Columbia rules apply?

Yes No

If yes, and the proposed groundwater use is determined to have the potential for substantial interference with nearby surface waters you are notified that the Water Resources Department will determine, by reviewing

For Department Use: App. Number: _____

recovery plans, the Columbia River Basin Fish and Wildlife Program, and regional restoration programs applicable to threatened or endangered fish species, in coordination with state and federal agencies, as appropriate, whether the proposed use is detrimental to the protection or recovery of a threatened or endangered fish species and whether the use can be conditioned or mitigated to avoid the detriment.

If a permit is issued, it will likely contain conditions to ensure the water use complies with existing state and federal water quality standards; and water use measurement, recording and reporting required by the Water Resources Department. The application may be denied, or if appropriate, mitigation for impacts may be needed to obtain approval of the proposed use.

If yes, you will be required to provide the following information, if applicable.

Yes No The proposed use is for more than **one** cubic foot per second (448.8 gpm) and is not subject to the requirements of OAR 690, Division 86 (Water Management and Conservation Plans).

If yes, provide a description of the measures to be taken to assure reasonably efficient water use:

Statewide - OAR 690-033-0330 thru -0340

Is the well or proposed well located in an area where the Statewide rules apply?

Yes No

If yes, and the proposed groundwater use is determined to have the potential for substantial interference with nearby surface waters you are notified that the Water Resources Department will determine whether the proposed use will occur in an area where endangered, threatened or sensitive fish species are located. If so, the Water Resources Department, Department of Fish and Wildlife, Department of Environmental Quality, and the Department of Agriculture will recommend conditions required to achieve “no loss of essential habitat of threatened and endangered (T&E) fish species,” or “no net loss of essential habitat of sensitive (S) fish species.” If conditions cannot be identified that meet the standards of no loss of essential T E fish habitat or no net loss of essential S fish habitat, the agencies will recommend denial of the application unless they conclude that the proposed use would not harm the species.

SECTION 5: WATER USE

USE	PERIOD OF USE	ANNUAL VOLUME (ACRE-FEET)
Irrigation	March 1 – Oct. 31	4.36

For irrigation use only:

Please indicate the number of primary, supplemental and/or nursery acres to be irrigated (*must match map*).

Primary: 1.09 Acres Supplemental: 0 Acres Nursery Use: 0 Acres

If you listed supplemental acres, list the Permit or Certificate number of the underlying primary water right(s):

N/A

Indicate the maximum total number of acre-feet you expect to use in an irrigation season: 4.36 AF

For Department Use: App. Number: _____

RECEIVED
Groundwater Application — Page 5
JUL 05 2022
Rev. 07/21

OWRD

- If the use is **municipal or quasi-municipal**, attach **Form M N/A**
- If the use is **domestic**, indicate the number of households: N/A (**Exempt Uses:** Please note that 15,000 gallons per day for single or group **domestic** purposes and 5,000 gallons per day for a single **industrial or commercial** purpose are exempt from permitting requirements.)
- If the use is **mining**, describe what is being mined and the method(s) of extraction (*attach additional sheets if necessary*): N/A

SECTION 6: WATER MANAGEMENT

A. Diversion and Conveyance

What equipment will you use to pump water from your well(s)?

Pump (give horsepower and type): The pump will be selected during final system design but is anticipated to be a 0.5-1 hp submersible pump.

Other means (describe):

Provide a description of the proposed means of diversion, construction, and operation of the diversion works and conveyance of water. Water will be pumped from the well and conveyed via buried PVC piping to the place of use.

B. Application Method

What equipment and method of application will be used? (e.g., drip, wheel line, high-pressure sprinkler) (*attach additional sheets if necessary*)

Water will be used to irrigate landscaping around an affordable housing development, food bank, and community clinic. Water will be applied using water-efficient sprinklers, drip irrigation, and other methods as appropriate.

C. Conservation

Please describe why the amount of water requested is needed and measures you propose to: prevent waste; measure the amount of water diverted; prevent damage to aquatic life and riparian habitat; prevent the discharge of contaminated water to a surface stream; prevent adverse impact to public uses of affected surface waters (*attach additional sheets if necessary*).

The applicant will use a water-efficient irrigation system and will only irrigate when necessary to promote plant health. No excess irrigation water will be allowed to flow off the property. Water use will be measured at the well if required by OWRD. Construction is not anticipated to occur near riparian or aquatic environments, and no discharge of contaminated water to surface water will occur. No adverse impacts to public uses of surface waters are anticipated.

SECTION 7: PROJECT SCHEDULE

- Date construction will begin: Within 5 years of permit issuance
- Date construction will be completed: Within 5 years of permit issuance
- Date beneficial water use will begin: Within 5 years of permit issuance

RECEIVED

JUL 05 2022

OWRD

SECTION 8: RESOURCE PROTECTION

In granting permission to use water the state encourages, and in some instances requires, careful control of activities that may affect adjacent waterway or streamside area. See instruction guide for a list of possible permit requirements from other agencies. Please indicate any of the practices you plan to undertake to protect water resources.

- Water quality will be protected by preventing erosion and run-off of waste or chemical products.

Describe: Water will be applied for irrigation using a water-efficient irrigation system to prevent erosion and run-off.

- Excavation or clearing of banks will be kept to a minimum to protect riparian or streamside areas.
Note: If disturbed area is greater than one acre, applicant should contact the Oregon Department of Environmental Quality to determine if a 1200C permit is required.

Describe planned actions and additional permits required for project implementation: The source of water is groundwater, and there are no surface water resources in the proposed place of use. Therefore, no impacts to riparian or streamside areas will occur.

- Other state and federal permits or contracts required and to be obtained, if a water right permit is granted:
List:

SECTION 9: WITHIN A DISTRICT

- Check here if the point of appropriation (POA) or place of use (POU) are located within or served by an irrigation or other water district.

Irrigation District Name N/A	Address	
City	State	Zip

SECTION 10: REMARKS

Use this space to clarify any information you have provided in the application (*attach additional sheets if necessary*).

RECEIVED

JUL 05 2022

OWRD

For Department Use: App. Number: _____

Minimum Requirements Checklist

Minimum Requirements (OAR 690-310-0040, OAR 690-310-0050 & ORS 537.140)

Include this checklist with the application

Check that each of the following items is included. The application will be returned if all required items are not included. If you have questions, please call the Water Rights Customer Service Group at (503) 986-0900.

Please submit the original application and signatures to the Water Resources Department. Applicants are encouraged to keep a copy of the completed application.

- SECTION 1: Applicant Information and Signature
- SECTION 2: Property Ownership
- SECTION 3: Well Development
- SECTION 4: Sensitive, Threatened or Endangered Fish Species Public Interest Information
- SECTION 5: Water Use
- SECTION 6: Water Management
- SECTION 7: Project Schedule
- SECTION 8: Resource Protection
- SECTION 9: Within a District
- SECTION 10: Remarks

Include the following additional items:

- Land Use Information Form with approval and signature of local planning department (*must be an original*) or signed receipt. **(Attachment A)**
- Provide the legal description of: (1) the property from which the water is to be diverted, (2) any property crossed by the proposed ditch, canal or other work, and (3) any property on which the water is to be used as depicted on the map. **(Attachment C)**
- Fees - Amount enclosed: \$2,590.00
See the Department's Fee Schedule at www.oregon.gov/owrd or call (503) 986-0900.
- Map that includes the following items: **(Attachment E)**
 - Permanent quality and drawn in ink
 - Even map scale not less than 4" = 1 mile (example: 1" = 400 ft, 1" = 1320 ft, etc.)
 - North Directional Symbol
 - Township, Range, Section, Quarter/Quarter, Tax Lots
 - Reference corner on map
 - Location of each diversion, by reference to a recognized public land survey corner (distances north/south and east/west)
 - Indicate the area of use by Quarter/Quarter and tax lot identified clearly.
 - Number of acres per Quarter/Quarter and hatching to indicate area of use if for primary irrigation, supplemental irrigation, or nursery
 - Location of main canals, ditches, pipelines or flumes (if well is outside of the area of use)

RECEIVED

JUL 05 2022

OWRD

Groundwater Application — Page 1

Rev. 07/21

For Department Use: App. Number: _____

03/27/2022

03/27/2022

03/27/2022

Attachment A
Land Use Information Form

Application for a Groundwater Permit - Northwest Housing Alternatives

RECEIVED

JUL 05 2022

OWRD

Land Use Information Form



Oregon Water Resources Department
725 Summer Street NE, Suite A
Salem, Oregon 97301-1266
(503) 986-0900
www.oregon.gov/OWRD

NOTE TO APPLICANTS

In order for your application to be processed by the Water Resources Department (WRD), this Land Use Information Form must be completed by a local government planning official in the jurisdiction(s) where your water right will be used and developed. The planning official may choose to complete the form while you wait, or return the receipt stub to you. Applications received by WRD without the Land Use Form or the receipt stub will be returned to you. Please be aware that your application will not be approved without land use approval.

This form is NOT required if:

- 1) Water is to be diverted, conveyed, and/or used only on federal lands; **OR**
- 2) The application is for a water right transfer, allocation of conserved water, exchange, permit amendment, or ground water registration modification, and **all** of the following apply:
 - a) The existing and proposed water use is located entirely within lands zoned for exclusive farm-use or within an irrigation district;
 - b) The application involves a change in place of use only;
 - c) The change does not involve the placement or modification of structures, including but not limited to water diversion, impoundment, distribution facilities, water wells and well houses; **and**
 - d) The application involves irrigation water uses only.

NOTE TO LOCAL GOVERNMENTS

The person presenting the attached Land Use Information Form is applying for or modifying a water right. The Water Resources Department (WRD) requires its applicants to obtain land-use information to be sure the water rights do not result in land uses that are incompatible with your comprehensive plan. Please complete the form or detach the receipt stub and return it to the applicant for inclusion in their water right application. You will receive notice once the applicant formally submits his or her request to the WRD. The notice will give more information about WRD's water rights process and provide additional comment opportunities. You will have 30 days from the date of the notice to complete the land-use form and return it to the WRD. If no land-use information is received from you within that 30-day period, the WRD may presume the land use associated with the proposed water right is compatible with your comprehensive plan. Your attention to this request for information is greatly appreciated by the Water Resources Department. If you have any questions concerning this form, please contact the WRD's Customer Service Group at 503-986-0801.

RECEIVED

JUL 05 2022

OWRD

Land Use Information Form



Oregon Water Resources Department
 725 Summer Street NE, Suite A
 Salem, Oregon 97301-1266
 (503) 986-0900
 www.oregon.gov/OWRD

Applicant(s): Northwest Housing Alternatives

Mailing Address: 2316 SE Willard St.

City: Milkwaukie

State: OR

Zip Code: 97222

Daytime Phone: 503-654-1007

A. Land and Location

Please include the following information for all tax lots where water will be diverted (taken from its source), conveyed (transported), and/or used or developed. Applicants for municipal use, or irrigation uses within irrigation districts may substitute existing and proposed service-area boundaries for the tax-lot information requested below.

Township	Range	Section	¼ ¼	Tax Lot #	Plan Designation (e.g., Rural Residential/RR-5)	Water to be:			Proposed Land Use:
<u>18S</u>	<u>47E</u>	<u>3</u>	<u>NWNW</u>	<u>900</u>	<u>O-RM</u>	<input checked="" type="checkbox"/> Diverted	<input checked="" type="checkbox"/> Conveyed	<input checked="" type="checkbox"/> Used	<u>Residential</u>
<u>18S</u>	<u>47E</u>	<u>3</u>	<u>NWNW</u>	<u>800</u>	<u>O-RM</u>	<input type="checkbox"/> Diverted	<input checked="" type="checkbox"/> Conveyed	<input checked="" type="checkbox"/> Used	<u>Residential</u>
<u>18S</u>	<u>47E</u>	<u>3</u>	<u>NWNW</u>	<u>801</u>	<u>O-RM</u>	<input type="checkbox"/> Diverted	<input checked="" type="checkbox"/> Conveyed	<input checked="" type="checkbox"/> Used	<u>Residential</u>
<u>18S</u>	<u>47E</u>	<u>3</u>	<u>NWNW</u>	<u>802</u>	<u>O-RM</u>	<input type="checkbox"/> Diverted	<input checked="" type="checkbox"/> Conveyed	<input checked="" type="checkbox"/> Used	<u>Residential</u>

List all counties and cities where water is proposed to be diverted, conveyed, and/or used or developed:

City of Ontario

B. Description of Proposed Use

Type of application to be filed with the Water Resources Department:

- Permit to Use or Store Water
 Water Right Transfer
 Permit Amendment or Ground Water Registration Modification
 Limited Water Use License
 Allocation of Conserved Water
 Exchange of Water

Source of water: Reservoir/Pond Ground Water Surface Water (name) _____

Estimated quantity of water needed: 0.03 cubic feet per second gallons per minute acre-feet

Intended use of water: Irrigation Commercial Industrial Domestic for _____ household(s)
 Municipal Quasi-Municipal Instream Other _____

Briefly describe:

The applicant proposes to irrigate landscaping around an affordable housing development from an existing well.

Note to applicant: If the Land Use Information Form cannot be completed while you wait, please have a local government representative sign the receipt at the bottom of the next page and include it with the application filed with the Water Resources Department.

See bottom of Page 3. →

RECEIVED

JUL 05 2022

OWRD

For Local Government Use Only

The following section must be completed by a planning official from each county and city listed unless the project will be located entirely within the city limits. In that case, only the city planning agency must complete this form. This deals only with the local land-use plan. Do not include approval for activities such as building or grading permits.

Please check the appropriate box below and provide the requested information

- Land uses to be served by the proposed water uses (including proposed construction) are allowed outright or are not regulated by your comprehensive plan. Cite applicable ordinance section(s):
- Land uses to be served by the proposed water uses (including proposed construction) involve discretionary land-use approvals as listed in the table below. (Please attach documentation of applicable land-use approvals which have already been obtained. Record of Action/land-use decision and accompanying findings are sufficient.) **If approvals have been obtained but all appeal periods have not ended, check "Being pursued."**

Type of Land-Use Approval Needed (e.g., plan amendments, rezones, conditional-use permits, etc.)	Cite Most Significant, Applicable Plan Policies & Ordinance Section References	Land-Use Approval:	
		<input type="checkbox"/> Obtained <input type="checkbox"/> Denied	<input type="checkbox"/> Being Pursued <input type="checkbox"/> Not Being Pursued
		<input type="checkbox"/> Obtained <input type="checkbox"/> Denied	<input type="checkbox"/> Being Pursued <input type="checkbox"/> Not Being Pursued
		<input type="checkbox"/> Obtained <input type="checkbox"/> Denied	<input type="checkbox"/> Being Pursued <input type="checkbox"/> Not Being Pursued
		<input type="checkbox"/> Obtained <input type="checkbox"/> Denied	<input type="checkbox"/> Being Pursued <input type="checkbox"/> Not Being Pursued
		<input type="checkbox"/> Obtained <input type="checkbox"/> Denied	<input type="checkbox"/> Being Pursued <input type="checkbox"/> Not Being Pursued

Local governments are invited to express special land-use concerns or make recommendations to the Water Resources Department regarding this proposed use of water below, or on a separate sheet.

Name: DAN K. CUMMINGS Title: COMMUNITY DEVELOPMENT DIRECTOR
 Signature: [Signature] Phone: (541) 881-3222 Date: 5/17/2022
 Government Entity: CITY OF ONTARIO COMMUNITY DEVELOPMENT

Note to local government representative: Please complete this form or sign the receipt below and return it to the applicant. If you sign the receipt, you will have 30 days from the Water Resources Department's notice date to return the completed Land Use Information Form or WRD may presume the land use associated with the proposed use of water is compatible with local comprehensive plans.

Receipt for Request for Land Use Information

Applicant name: _____

City or County: _____ Staff contact: _____

Signature: _____ Phone: _____ Date: _____

RECEIVED
 JUL 05 2022
 OWRD

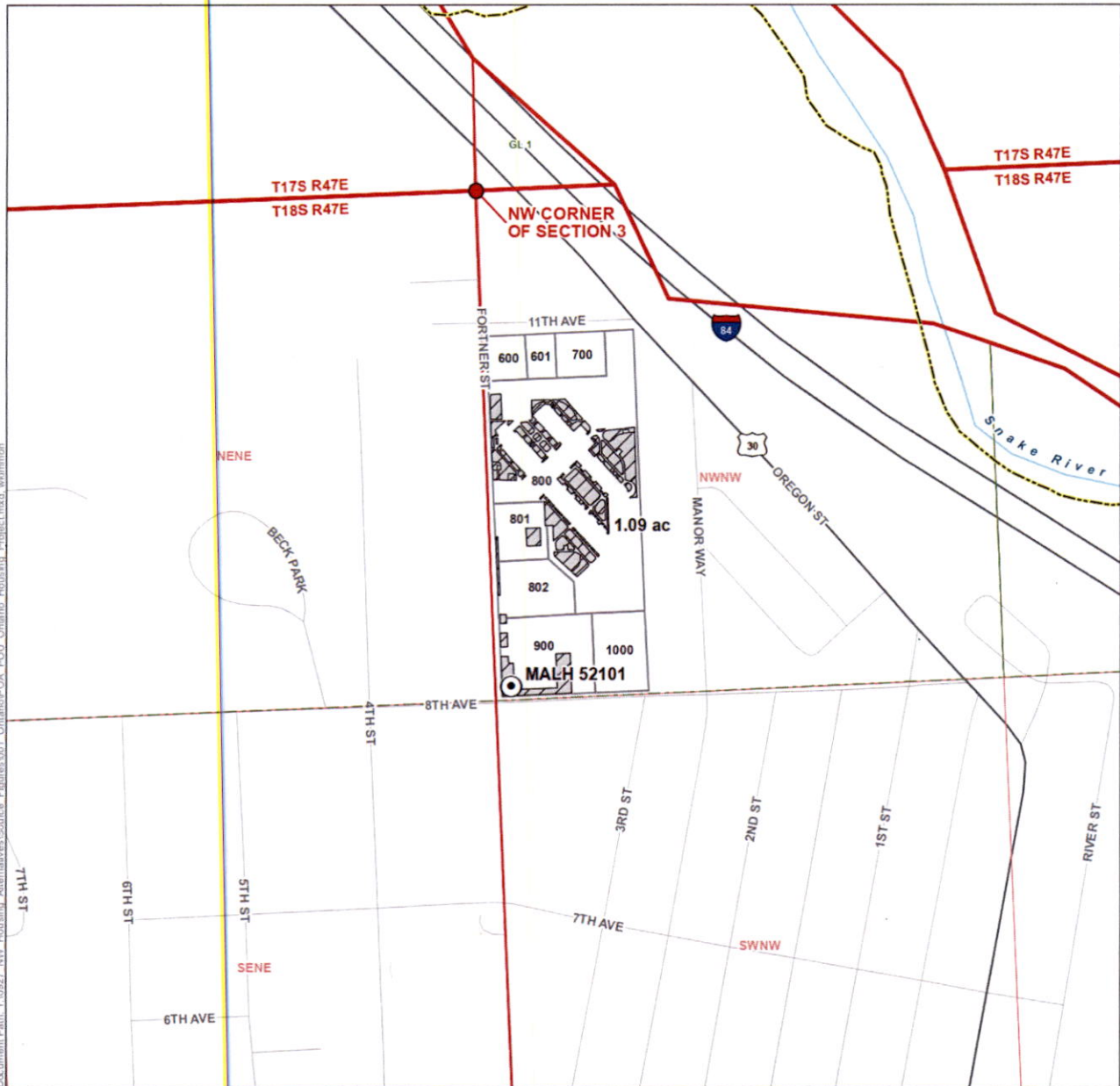

Document Path: Y:\0927_NW_Housing_Alternatives\Source_Figures\001_Ontario_Housing_Project.mxd, whimmon

Application for a Permit to Use Groundwater
Proposed Point of Appropriation and Place of Use
 Malheur County
 Township 18 South, Range 47 East (W.M.)

LEGEND

- Point of Appropriation (POA)
- Place of Use (POU)
- Government Lot (GL)
- Tax Lots
- Major Road
- Railroad
- Watercourse
- Waterbody

RECEIVED

JUL 05 2022

OWRD

DISCLAIMER
 This map was prepared for the purpose of identifying the location of a water right only and it is not intended to provide legal dimensions or location of property ownership lines.

Date: March 31, 2022
 Data Sources: BLM, ESRI, OWRD, USGS

LOCATION DESCRIPTION
MALH 52101
 Located 1,280 feet South and 40 feet East from the NW corner of Section 3, Township 18 South, Range 47 East (W.M.)

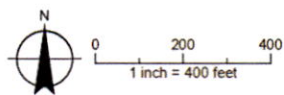



2316 SE Willard, Milwaukie, Oregon 97222
p: 503.654.1007 • f: 503.654.1319 • www.nwhousing.org

TO: Northwest Housing Alternatives

FROM: Ontario Acquisition, LLC

DATE: June 7, 2022

RE: Site access for irrigation

The entity Ontario Acquisition LLC grants to Northwest Housing Alternatives, and its successors and assigns, access to tax lots 801, 802, 900, and 1300. Access shall be for the purpose of irrigation, maintenance of related equipment, and other work related to landscape irrigation.

Ontario Acquisition, LLC

X Clayton Crowhurst
Digitally signed by Clayton Crowhurst
DN: cn=Clayton Crowhurst, email=ccrowhurst@nwhousing.org,
ou=Northwest Housing Alternatives,
ou=Housing Development, cn=Clayton
Crowhurst
Reason: I have reviewed this document
Date: 2022.06.07 15:23:53-0700'

Clayton Crowhurst
Authorized Representative, Ontario Acquisition, ...

RECEIVED

JUL 05 2022

OWRD



2316 SE Willard, Milwaukie, Oregon 97222
p: 503.654.1007 • f: 503.654.1319 • www.nwhousing.org

TO: Northwest Housing Alternatives

FROM: OAH Limited Partnership

DATE: June 7, 2022

RE: Site access for irrigation

The entity OAH Limited Partnership grants to Northwest Housing Alternatives, and its successors and assigns, access to tax lot 800. Access shall be for the purpose of irrigation, maintenance of related equipment, and other work related to landscape irrigation.

OAH Limited Partnership

X

Clayton Crowhurst

Digitally signed by Clayton Crowhurst
DN: cn=US, e=crowhurst@nwhousing.org,
o=Northwest Housing Alternatives,
ou=Housing Development, cn=Clayton
Crowhurst
Reason: I have reviewed this document
Date: 2022.06.07 15:27:58-07'00'

Clayton Crowhurst
Authorized Representative, OAH Limited Partner...

RECEIVED

JUL 05 2022

OWRD

Attachment C

Legal Description of Property

Application for a Groundwater Permit – Northwest Housing Alternatives

RECEIVED

JUL 05 2022

OWRD

Legal Description Tax Lot 800

Exhibit "A"

Land in Malheur County, Oregon, as follows:

In Twp. 18 S., R. 47 E., W.M.:

Sec. 3: Being a Re-Plat of Tracts 5, 6, 7, 8, 9 and 10, and a portion of Tract 11 of G.W. Routh Tracts, within Government Lot 1 of said Section 3, more particularly described as follows:

Parcel No. 3, of Partition Plat No. 21-11, recorded May 20, 2021, Instrument No. 2021-2364, Official Records of Malheur County, Oregon.

TOGETHER WITH the Road Dedication and Access Easement, as disclosed on Partition Plat No. 21-11, recorded May 20, 2021, Instrument No. 2021-2364, Official Records of Malheur County.

RECEIVED

JUL 05 2022

OWRD

Legal Description Tax Lot 801

Map: 18S4703BB Tax Lot: 801

Land in Malheur County, Oregon, as follows:

In Twp. 18 S., R. 47 E., W.M.:

Sec. 3: Being a Re-Plat of Tracts 5, 6, 7, 8, 9 and 10, and a portion of Tract 11 of G.W. Routh Tracts, within Government Lot 1 of said Section 3, more particularly described as follows:

Parcel No. 1, of Partition Plat No. 21-11, recorded May 20, 2021, Instrument No. 2021-2364, Official Records of Malheur County, Oregon.

TOGETHER WITH the Road Dedication and Access Easement, as disclosed on Partition Plat No. 21-11, recorded May 20, 2021, Instrument No. 2021-2364, Official Records of Malheur County,

RECEIVED

JUL 05 2022

OWRD

Legal Description Tax Lot 802

Map: 18S4703BB Tax Lot: 802

Land in Malheur County, Oregon, as follows:

In Twp. 18 S., R. 47 E., W.M.:

Sec. 3: Being a Re-Plat of Tracts 5, 6, 7, 8, 9 and 10, and a portion of Tract 11 of G.W. Routh Tracts, within Government Lot 1 of said Section 3, more particularly described as follows:

Parcel No. 2, of Partition Plat No. 21-11, recorded May 20, 2021, Instrument No. 2021-2364, Official Records of Malheur County, Oregon.

TOGETHER WITH the Road Dedication and Access Easement, as disclosed on Partition Plat No. 21-11, recorded May 20, 2021, Instrument No. 2021-2364, Official Records of Malheur County,

RECEIVED

JUL 05 2022

OWRD

Legal Description Tax Lot 900

EXHIBIT A

Legal Description of the Property

The W 1/2 of Tract 2 and all of Tracts 3 and 4 of what is commonly known as G.W. Routh Tracts, situated in Lot 1, Sec. 3, Twp. 18 S., R. 47 E., W.M., Malheur County, Oregon, SAVE AND EXCEPTING THEREFROM a strip of land 16 feet in width off the West and South sides of Tract 4, and off the South side of Tract 3, and the W 1/2 of Tract 2.

RECEIVED

JUL 05 2022

OWRD

RECEIVED

JUL 05 2022

OWRD

Attachment D

Well Log MALH 52101

Application for a Groundwater Permit – Northwest Housing Alternatives

STATE OF OREGON
WATER SUPPLY WELL REPORT
(as required by ORS 537.765)

WELL I.D. # L 53139
START CARD # 145290

Instructions for completing this report are on the last page of this form.

(1) LAND OWNER: Well Number _____
Name Presbyterian Community Care Center
Address 1085 N Oregon St.
City Ontario State OR Zip 97914

(9) LOCATION OF WELL by legal description:
County Malheur Latitude _____ Longitude _____
Township 18 N or S Range 47 E or W. WM.
Section 3 SW 1/4 1/4
Tax Lot 800 Lot _____ Block _____ Subdivision _____
Street Address of Well (or nearest address) 1085 N Oregon St.

(2) TYPE OF WORK
 New Well Deepening Alteration (repair/recondition) Abandonment

(3) DRILL METHOD:
 Rotary Air Rotary Mud Cable Auger
 Other _____

(10) STATIC WATER LEVEL:
20 ft. below land surface. Date 9-4-03
Artesian pressure _____ lb. per square inch Date _____

(4) PROPOSED USE:
 Domestic Community Industrial Irrigation
 Thermal Injection Livestock Other _____

(11) WATER BEARING ZONES:
Depth at which water was first found 20'

(5) BORE HOLE CONSTRUCTION:
Special Construction approval Yes No Depth of Completed Well 38 1/2
Explosives used Yes No Type _____ Amount _____

From	To	Estimated Flow Rate	SWL
<u>20</u>	<u>40</u>	<u>40</u>	<u>20</u>

HOLE		SEAL		Sacks or pounds	
Diameter	From To	Material	From To		
<u>12"</u>	<u>0</u> <u>18</u>	<u>Bentonite</u>	<u>0</u> <u>18</u>	<u>70 Sacks</u>	
<u>8"</u>	<u>18</u> <u>45</u>				

How was seal placed: Method A B C D E
 Other Poured in
Backfill placed from 0 ft. to 19 ft. Material Bentonite
Gravel placed from _____ ft. to _____ ft. Size of gravel _____

(12) WELL LOG:
Ground Elevation _____

Material	From	To	SWL
<u>Brown Sandy Clay</u>	<u>0</u>	<u>20</u>	<u>20</u>
<u>Sand Gravel</u>	<u>20</u>	<u>40</u>	<u>20</u>

(6) CASING/LINER:
Diameter From To Gauge Steel Plastic Welded Threaded
Casing: 8" 11/23/1/2 250
Liner: _____

Drive Shoe used Inside Outside None
Final location of shoe(s) 38 1/2

(7) PERFORATIONS/SCREENS:
 Perforations Method Air Perforator
 Screens Type _____ Material _____
From To Slot size Number Diameter Tele/pipe size Casing Liner
26 38 1/4 144 8"

Date started 9-4-03 Completed 9-4-03

(unbonded) Water Well Constructor Certification:
I certify that the work I performed on the construction, alteration, or abandonment of this well is in compliance with Oregon water supply well construction standards. Materials used and information reported above are true to the best of my knowledge and belief.
Signed _____ WWC Number _____ Date _____

(8) WELL TESTS: Minimum testing time is 1 hour
 Pump Bailer Air Flowing Artesian
Yield gal/min Drawdown Drill stem at Time
40 5 38 1 hr.

Temperature of water 58 Depth Artesian Flow Found _____
Was a water analysis done? Yes By whom _____
Did any strata contain water not suitable for intended use? Too little
 Salty Muddy Odor Colored Other _____
Depth of strata: _____

(bonded) Water Well Constructor Certification:
I accept responsibility for the construction, alteration, or abandonment work performed on this well during the construction date reported above. All work performed during this time is in compliance with Oregon water supply well construction standards. This report is true to the best of my knowledge and belief.
Signed _____ WWC Number 1697 Date 9-10-03

RECEIVED

JUL 05 2022

OWRD

RECEIVED

JUL 05 2022

OWRD

Attachment E

Application Map

Application for a Groundwater Permit – Northwest Housing Alternatives

Molly Monroe

From: Leah Cogan
Sent: Wednesday, July 6, 2022 3:13 PM
To: Molly Monroe
Subject: FW: Groundwater application - Northwest Housing Alternatives

RECEIVED
JUL 11 2022
OWRD

From: LUONGO Dante J * WRD <Dante.J.LUONGO@water.oregon.gov>
Sent: Tuesday, July 5, 2022 1:52 PM
To: Leah Cogan <lcogan@gsiws.com>
Subject: RE: Groundwater application - Northwest Housing Alternatives

Hi Leah,

OWRD has received and accepted the Ground Water e-application for Northwest Housing Alternatives. The temporary application number is: **DL-1**

Please print this email and include a copy of it when mailing in the payment. The fees due for this application are: \$1,980.00 (If opting to include recording fee: \$2,590.00)

A copy of the fee calculator is included for your reference:

Today's Date: Tuesday, July 5, 2022

Base Application Fee.
Number of proposed cubic feet per second (cfs) to be appropriated. (1 cfs = 448.83 gallons per minute)
Number of proposed Use's for the appropriated water. (i.e. Irrigation, Supplemental Irrigation, Pond Maintenance, Industrial, Commercial, etc) *
Number of proposed groundwater points of appropriation. (i.e. number of wells) (include all injection wells, if applicable) **
Permit Recording Fee. ***
* the 1st Water Use is included in the base cost. ** the 1st groundwater point of appropriation is included in the base cost. *** the Permit Recording Fee is not required when the application is submitted but, must be paid before a permit will be issue
Estimated cost of Permit Application

Best Regards,
Dante Luongo

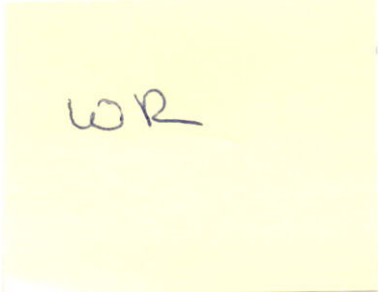

From: Leah Cogan <lcogan@gsiws.com>

Sent: Tuesday, July 5, 2022 1:27 PM

To: WRD_DL_customerservice <WRD_DL_customerservice@water.oregon.gov>

Cc: Clayton Crowhurst <crowhurst@NWHousing.org>; Bruce Brody-Heine <BBheine@gsiws.com>

Subject: Groundwater application - Northwest Housing Alternatives

Good afternoon,

GSI Water Solutions, Inc. is electronically submitting the attached application for a permit to use groundwater on behalf of Northwest Housing Alternatives. The permit application fee will be mailed to OWRD when we receive the temporary number for this application. Please let me know if you have any questions.

Thank you,

Leah Cogan

Water Resources Analyst

direct: 971.200.8529 | mobile: 541.272.9888

1600 SW Western Boulevard, Suite 240, Corvallis, OR 97333

GSI Water Solutions, Inc. | www.gsiws.com

pronouns: she, her

Please note: GSI is open for business, although most of us are working remotely. I can be reached by phone or email.