

# FINAL PROOF SURVEY MAP IN THE NAME OF WAYNE STOLZ

APPLICATION S-73931  
R-73932

PERMIT 52549  
R-11907

SECTION 5, TOWNSHIP 29 SOUTH, RANGE 14 WEST, W.M.

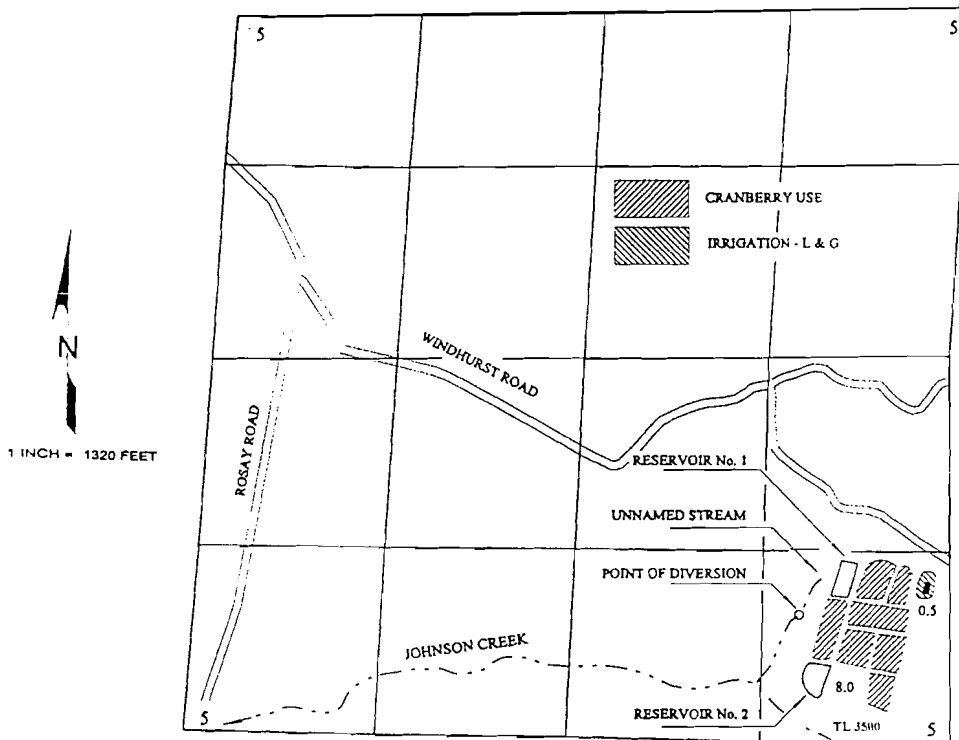

THE POINT OF DIVERSION IS LOCATED 900 FEET NORTH AND 1040 FEET WEST; AND RESERVOIR No. 1 IS LOCATED 1160 FEET NORTH AND 780 FEET WEST; AND RESERVOIR No. 2 IS LOCATED 410 FEET NORTH AND 1000 FEET WEST; ALL FROM THE SOUTHEAST CORNER OF SECTION 5, ALL WITHIN THE SE $\frac{1}{4}$ SE $\frac{1}{4}$  OF SECTION 5, TOWNSHIP 29 SOUTH, RANGE 14 WEST, W.M.; COOS COUNTY.

THE PURPOSE OF THIS MAP IS TO IDENTIFY THE LOCATION OF THE WATER RIGHT. IT IS NOT INTENDED TO PROVIDE INFORMATION RELATIVE TO THE LOCATION OF PROPERTY OWNERSHIP BOUNDARY LINES.

RECEIVED

SALEM, OREGON

