

RECEIVED

FEB 22 1994

WATER RESOURCES DEPT.  
SALEM, OREGON

APPLICATION MAP

IN THE NAME OF ROBERT H. OR BARBARA L. STOLZ

SECTION 5, TOWNSHIP 29 SOUTH, RANGE 14 WEST, W.M.



1 INCH = 1320 FEET

Application No. 73932  
Permit No. R11907

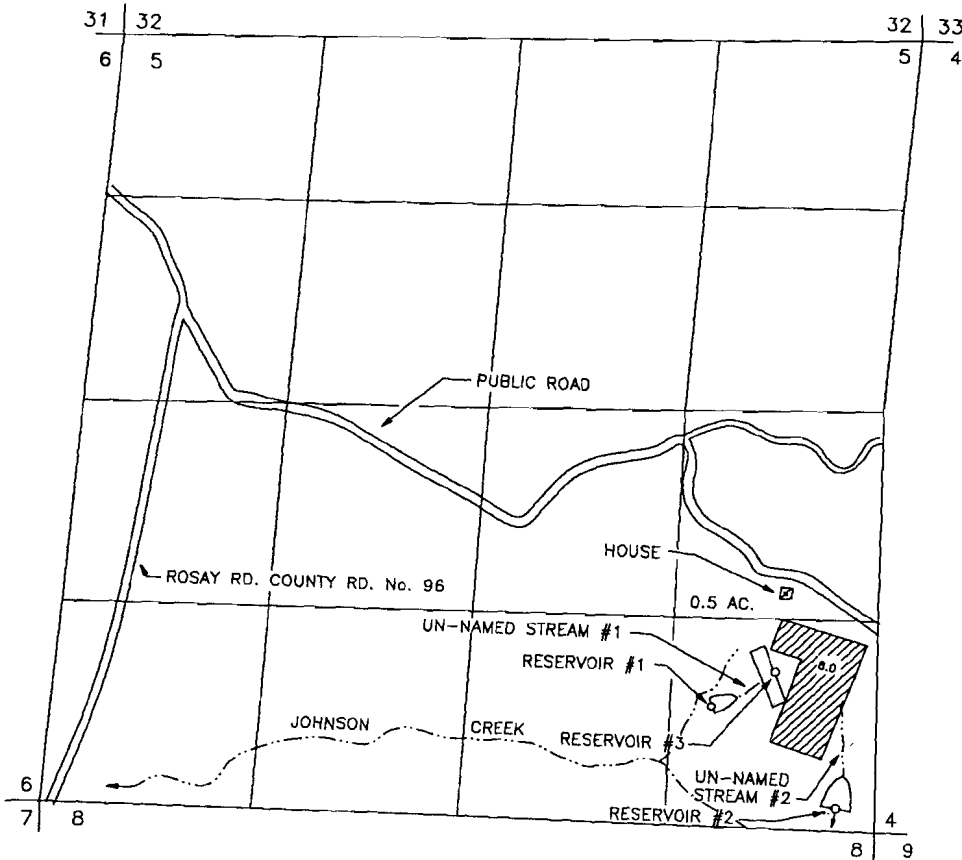

DIVERSION #	FT. N. OR S.	FT. E. OR W.	FROM	1/4 1/4	S	T	R
#1	790' NORTH	1070' WEST	SE CORNER SEC 5	SE SE	5	29S	14W
#2	140' NORTH	260' WEST	SE CORNER SEC 5	SE SE	5	29S	14W
#3	1020' NORTH	670' WEST	SE CORNER SEC 5	SE SE	5	29S	14W

THE PURPOSE OF THIS MAP IS TO IDENTIFY THE LOCATION OF THE WATER RIGHT. IT IS NOT INTENDED TO PROVIDE INFORMATION RELATIVE TO THE LOCATION OF PROPERTY OWNERSHIP BOUNDARY LINES.

