

RECEIVED

SEP - 8 1997

WATER RESOURCES DEPT.  
SALEM, OREGON

FINAL PROOF SURVEY MAP  
IN THE NAME OF GARY AND STEVE GANT

SECTIONS 6 & 7, TOWNSHIP 29 SOUTH, RANGE 14 WEST, W.M.

APPLICATION R-69929  
APPLICATION 69930

PERMIT R-11465  
PERMIT 51487

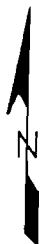

1 INCH = 1,320 FEET

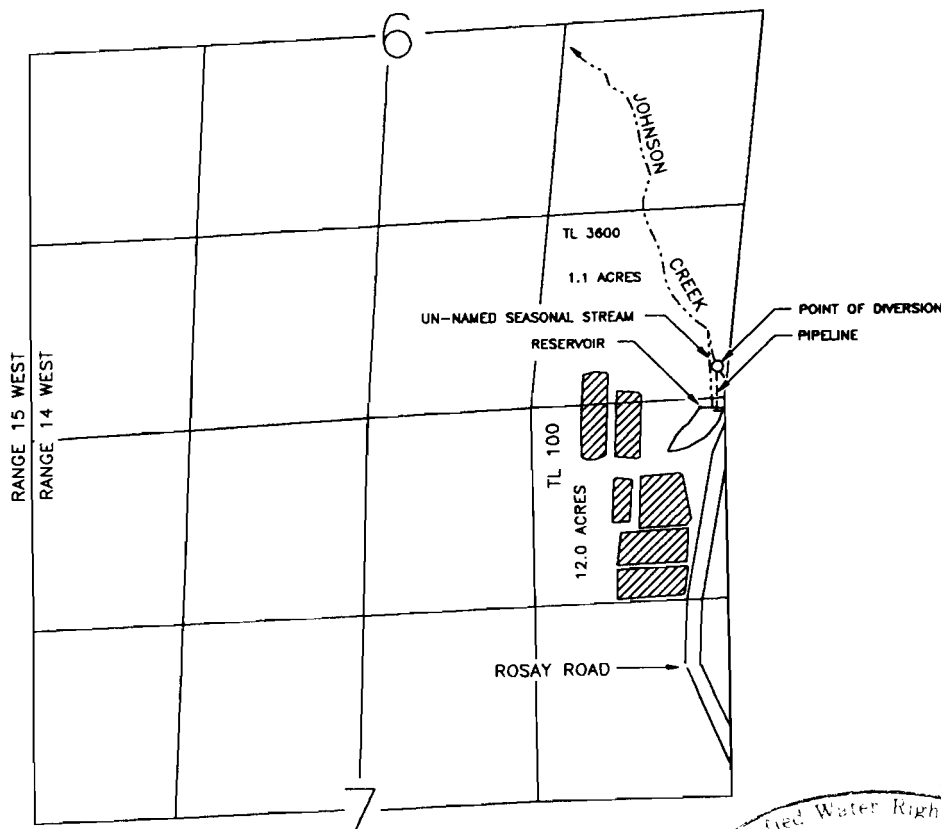

DRWG.97-22

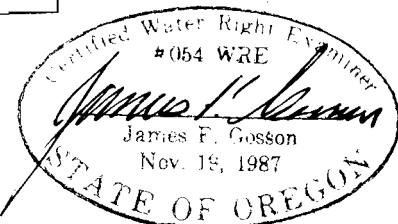

THE POINT OF DIVERSION IS LOCATED 220 FEET NORTH AND 50 FEET WEST FROM THE SOUTHEAST CORNER OF SECTION 6; BEING WITHIN THE SE1/4 SE1/4 OF SECTION 6, TOWNSHIP 29 SOUTH, RANGE 14 WEST, W.M., COOS COUNTY.

THE PURPOSE OF THIS MAP IS TO IDENTIFY THE LOCATION OF THE WATER RIGHT. IT IS NOT INTENDED TO PROVIDE INFORMATION RELATIVE TO PROPERTY OWNERSHIP BOUNDARY LINES.