

STATE OF OREGON

COUNTY OF LAKE

CERTIFICATE OF WATER RIGHT

THIS CERTIFICATE ISSUED TO

STEVE SPHAR
PO BOX 182
SILVER LAKE OR 97638

confirms the right to store water perfected under the terms of Permit R-13665. The amount of water used to which this right is entitled is limited to the amount used beneficially, and shall not exceed the amount specified, or its equivalent in the case of rotation, measured at the point of diversion from the source. The specific limits and conditions of the use are listed below.

APPLICATION FILE NUMBER: R-85522

SOURCE OF WATER: BRIDGE CREEK, A TRIBUTARY OF SILVER CREEK

STORAGE FACILITY: UNNAMED RESERVOIR

PURPOSE OR USE OF THE STORED WATER: MULTIPLE PURPOSE

MAXIMUM STORAGE VOLUME: 8.98 ACRE-FEET EACH YEAR

WATER MAY BE APPROPRIATED FOR STORAGE DURING THE PERIOD: YEAR ROUND

DATE OF PRIORITY: APRIL 1, 2003

The dam is located as follows:

Twp	Rng	Mer	Sec	Q-Q	Measured Distances
29 S	13 E	WM	3	NW NE	680 FEET SOUTH AND 1900 FEET WEST FROM NE CORNER, SECTION 3

The area submerged by this reservoir is as follows:

Twp	Rng	Mer	Sec	Q-Q
28 S	13 E	WM	35	NE SW
28 S	13 E	WM	35	NW SW
28 S	13 E	WM	35	SW SW
28 S	13 E	WM	35	SE SW
29 S	13 E	WM	2	NW NW
29 S	13 E	WM	3	NE NE
29 S	13 E	WM	3	NW NE

NOTICE OF RIGHT TO PETITION FOR RECONSIDERATION OR JUDICIAL REVIEW

This is an order in other than a contested case. This order is subject to judicial review under ORS 183.484 and ORS 536.075. Any petition for judicial review must be filed within the 60-day time period specified by ORS 183.484(2). Pursuant to ORS 183.484, ORS 536.075 and OAR 137-004-0080, you may petition for judicial review and petition the Director for reconsideration of this order. A petition for reconsideration may be granted or denied by the Director, and if no action is taken within 60 days following the date the petition was filed, the petition shall be deemed denied. In addition, under ORS 537.260 any person with an application, permit or water right certificate subsequent in priority may jointly or severally contest the issuance of the certificate within three months after issuance of the certificate.

Measurement, recording and reporting conditions:

- A. The water user shall maintain the meter or other suitable measuring device as approved by the Director in good working order.
- B. The water user shall allow the watermaster access to the meter or measuring device; provided however, where the meter or measuring device is located within a private structure, the watermaster shall request access upon reasonable notice.
- C. The Director may require the water user to keep and maintain a record of the amount (volume) of water used and may require the water user to report water use on a periodic schedule as established by the Director. In addition, the Director may require the water user to report general water use information, the periods of water use and the place and nature of use of water under the right. The Director may provide an opportunity for the water user to submit alternative reporting procedures for review and approval.

The storage of water allowed herein is subject to the installation and maintenance of an outlet pipe, or the provision of other means to evacuate water when determined necessary by the Water Resources Director to satisfy prior downstream rights.

The water user shall pass all live flow outside the storage season described above.

This right does not provide for the appropriation of water for any out of reservoir uses, the maintenance of the water level or maintaining a suitable fresh water condition. If any water is used for out of reservoir uses, or any live flow is appropriated to maintain either the water level or a suitable freshwater condition, a secondary water right is required.

The use may be restricted if the quality of the source stream or downstream waters decrease to the point that those waters no longer meet existing state or federal water quality standards due to reduced flows.

The water user shall maintain and operate fish screening to prevent fish from entering the diversion. The water user shall also maintain and operate a fishway at the obstruction that will provide adequate upstream and downstream passage for fish.

Failure to comply with any of the provisions of this right may result in action including, but not limited to, restrictions on the use, civil penalties, or cancellation of the right.

This right is for the beneficial use of water without waste. The water user is advised that new regulations may require the use of best practical technologies or conservation practices to achieve this end.

By law, the land use associated with this water use must be in compliance with statewide land-use goals and any local acknowledged land-use plan.

The use of water allowed herein may be made only at times when sufficient water is available to satisfy all prior rights, including prior rights for maintaining instream flows.

This right does not authorize the water right holder to pursue this right in such a way as to interfere with or affect adjacent property not under the ownership of the water right holder.

The right to store water for the above purpose is restricted to beneficial use at the place of use described.

Issued NOV 04 2016

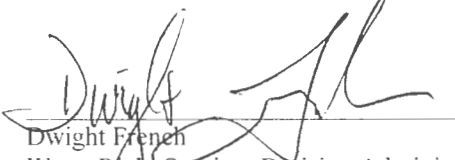
Dwight French
Water Right Services Division Administrator, for
Thomas M. Byler, Director
Oregon Water Resources Department



Oregon
Kate Brown, Governor

Water Resources Department
725 Summer St NE, Suite A
Salem, OR 97301
(503) 986-0900
Fax (503) 986-0904

DATE MAILED: November 4, 2016

NOTICE OF CERTIFICATE ISSUANCE

The attached certificate confirms the water right established under the terms of a permit issued by this Department. The water right is now appurtenant to the specific place where the use was established as described by the certificate. The water right is limited to a specific amount of water, but not more than can be beneficially used for the purposes stated within the certificate.

The certificate is a final order in other than a contested case. This order is subject to judicial review under ORS 183.484 and ORS 536.075. Any petition for judicial review must be filed within the 60-day time period specified by ORS 183.484(2). Pursuant to ORS 183.484, ORS 536.075 and OAR 137-004-0080, you may petition for judicial review and petition the Director for reconsideration of this order. A petition for reconsideration may be granted or denied by the Director, and if no action is taken within 60 days following the date the petition was filed, the petition shall be deemed denied. In addition, under ORS 537.260 any person with an application, permit or water right certificate subsequent in priority may jointly or severally contest the issuance of the certificate within three months after issuance of the certificate.

Oregon law does not allow the Director to reissue a certificate because of a change in the ownership of the appurtenant place of use. The water must be controlled and not wasted. To change the location of the point of diversion, the character of use, or the location of use requires the advance approval of the Water Resources Director.

If any portion of this water right is not used for five or more consecutive years that portion of the right may be subject to forfeiture according to ORS 540.610. Land enrolled in a Federal Reserve Program is not subject to forfeiture during the period of enrollment. Other exceptions to forfeiture are explained in ORS 540.610.

If you have any questions please contact Gerry Clark at 503-986-0811.

Mailing List for Certificate

Application: R-85522

Permit: R-13665

Certificate: 91939

Permit/Certificate Holder:

STEVE SPHAR ✓
PO BOX 182
SILVER LAKE OR 97638

Copies of Final Certificate to be sent to:

1. Watermaster District #: 12 ✓
2. Water Availability ✓
3. Vault ✓
4. File

Other persons to receive copies: (include map):

- 1.

<p>Copies Mailed</p> <p>by: <u>Connie Dan</u> (STAFF)</p> <p>on: <u>NOV 04 2016</u></p> <p>(DATE)</p>
--

STATE OF OREGON

COUNTY OF LAKE

CERTIFICATE OF WATER RIGHT

THIS CERTIFICATE ISSUED TO

STEVE SPHAR
PO BOX 182
SILVER LAKE OR 97638

PROPOSED

confirms the right to store water perfected under the terms of Permit R-13665. The amount of water used to which this right is entitled is limited to the amount used beneficially, and shall not exceed the amount specified, or its equivalent in the case of rotation, measured at the point of diversion from the source. The specific limits and conditions of the use are listed below.

APPLICATION FILE NUMBER: R-85522

SOURCE OF WATER: BRIDGE CREEK, A TRIBUTARY OF SILVER CREEK

STORAGE FACILITY: UNNAMED RESERVOIR

PURPOSE OR USE OF THE STORED WATER: MULTIPLE PURPOSE

MAXIMUM STORAGE VOLUME: 8.98 ACRE-FEET EACH YEAR

WATER MAY BE APPROPRIATED FOR STORAGE DURING THE PERIOD: YEAR ROUND

DATE OF PRIORITY: APRIL 1, 2003

The dam is located as follows:

Twp	Rng	Mer	Sec	Q-Q	Measured Distances
29 S	13 E	WM	3	NW NE	680 FEET SOUTH AND 1900 FEET WEST FROM NE CORNER, SECTION 3

The area submerged by this reservoir is as follows:

Twp	Rng	Mer	Sec	Q-Q
28 S	13 E	WM	35	NE SW
28 S	13 E	WM	35	NW SW
28 S	13 E	WM	35	SW SW
28 S	13 E	WM	35	SE SW
29 S	13 E	WM	2	NW NW
29 S	13 E	WM	3	NE NE
29 S	13 E	WM	3	NW NE

NOTICE OF RIGHT TO PETITION FOR RECONSIDERATION OR JUDICIAL REVIEW

This is an order in other than a contested case. This order is subject to judicial review under ORS 183.484 and ORS 536.075. Any petition for judicial review must be filed within the 60-day time period specified by ORS 183.484(2). Pursuant to ORS 183.484, ORS 536.075 and OAR 137-004-0080, you may petition for judicial review and petition the Director for reconsideration of this order. A petition for reconsideration may be granted or denied by the Director, and if no action is taken within 60 days following the date the petition was filed, the petition shall be deemed denied. In addition, under ORS 537.260 any person with an application, permit or water right certificate subsequent in priority may jointly or severally contest the issuance of the certificate within three months after issuance of the certificate.

PROPOSED

91939

Measurement, recording and reporting conditions:

- A. The water user shall maintain the meter or other suitable measuring device as approved by the Director in good working order.
- B. The water user shall allow the watermaster access to the meter or measuring device; provided however, where the meter or measuring device is located within a private structure, the watermaster shall request access upon reasonable notice.
- C. The Director may require the water user to keep and maintain a record of the amount (volume) of water used and may require the water user to report water use on a periodic schedule as established by the Director. In addition, the Director may require the water user to report general water use information, the periods of water use and the place and nature of use of water under the right. The Director may provide an opportunity for the water user to submit alternative reporting procedures for review and approval.

The storage of water allowed herein is subject to the installation and maintenance of an outlet pipe, or the provision of other means to evacuate water when determined necessary by the Water Resources Director to satisfy prior downstream rights.

The water user shall pass all live flow outside the storage season described above.

This right does not provide for the appropriation of water for any out of reservoir uses, the maintenance of the water level or maintaining a suitable fresh water condition. If any water is used for out of reservoir uses, or any live flow is appropriated to maintain either the water level or a suitable freshwater condition, a secondary water right is required.

The use may be restricted if the quality of the source stream or downstream waters decrease to the point that those waters no longer meet existing state or federal water quality standards due to reduced flows.

The water user shall maintain and operate fish screening to prevent fish from entering the diversion. The water user shall also maintain and operate a fishway at the obstruction that will provide adequate upstream and downstream passage for fish.

Failure to comply with any of the provisions of this right may result in action including, but not limited to, restrictions on the use, civil penalties, or cancellation of the right.

This right is for the beneficial use of water without waste. The water user is advised that new regulations may require the use of best practical technologies or conservation practices to achieve this end.

By law, the land use associated with this water use must be in compliance with statewide land-use goals and any local acknowledged land-use plan.

The use of water allowed herein may be made only at times when sufficient water is available to satisfy all prior rights, including prior rights for maintaining instream flows.

This right does not authorize the water right holder to pursue this right in such a way as to interfere with or affect adjacent property not under the ownership of the water right holder.

The right to store water for the above purpose is restricted to beneficial use at the place of use described.

Issued _____

Dwight French
Water Right Services Division Administrator, for
Thomas M. Byler, Director
Oregon Water Resources Department

RECEIVED

APR 01 2003

WATER RESOURCES DEPT.
SALEM, OREGON

R13E

RECEIVED

IAN 08 2003

WATER RESOURCES DEPT.
SALEM, OREGON

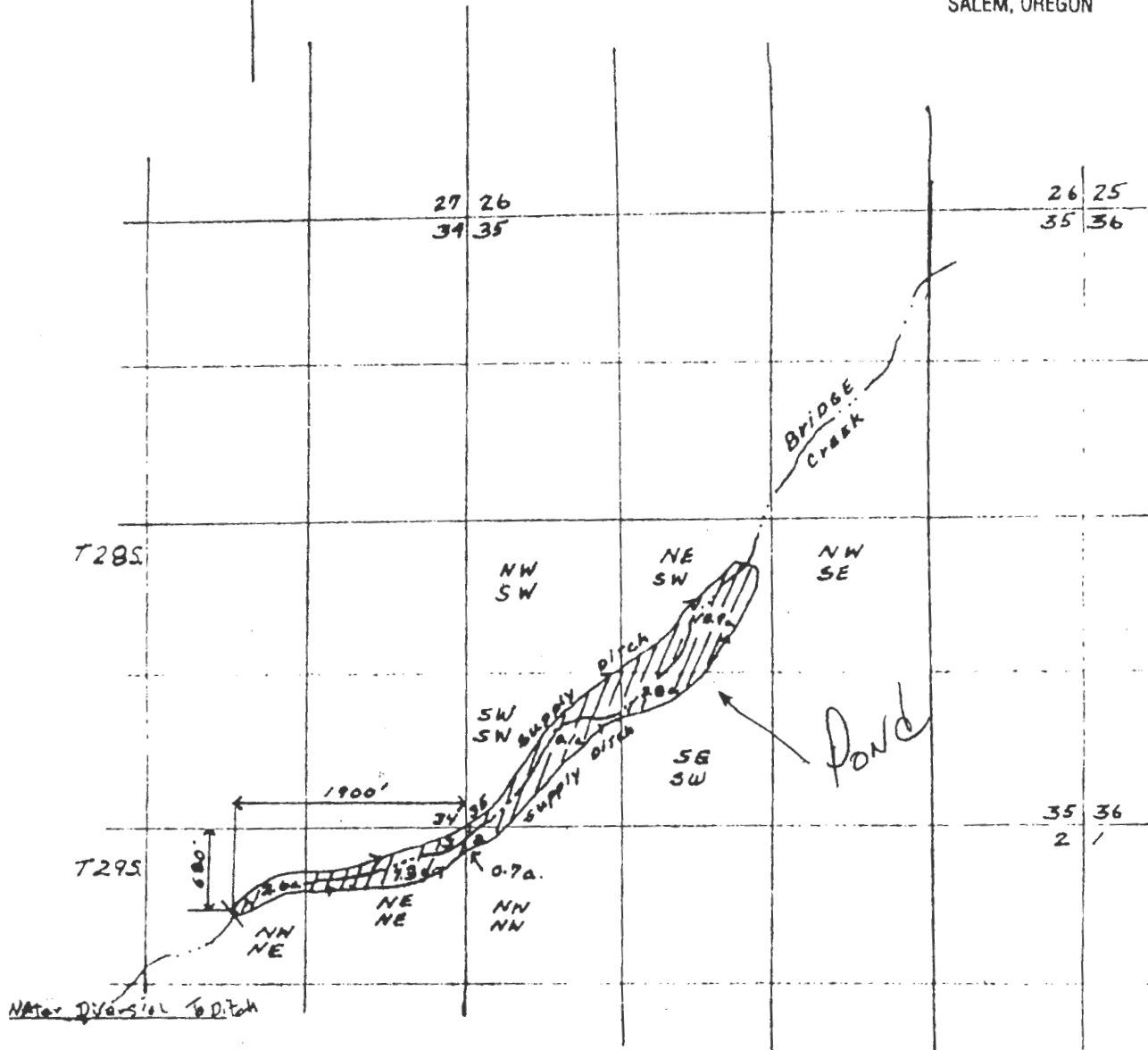

T 28 S R 13 E SEC. 35	
SW ¼ SW ¼	10.1 Acres
SE ¼ SW ¼	3.8 "
NE ¼ SW ¼	10.9 "
	24.8 ac
T 29 S R 13 E SEC. 3	
NW ¼ NE ¼	2.6 "
NE ¼ NE ¼	7.3 "
	9.9 ac
T 29 S. R 13 E SEC. 2	
NW ¼ NW ¼	0.7 "
	0.7 ac
Total	35.4 ac

App # R. 85522
Permit # R-13665

JAMES SPHAR

BRIDGE CREEK MEADOW

EXISTING IRRIGATION SYSTEM

SCALE 1" = 1 MILE

DATA PLOTTED ON AERIAL

RECEIVED BY OWRD

SEP 10 2015

SALEM, OR

Mailing List for Proposed Certificate

Application: R-85522

Permit: R-13665

Certificate:

Permit/Certificate Holder:

STEVE SPHAR

PO BOX 182

SILVER LAKE OR 97638 ✓

<p>Copies Mailed</p> <p>by: <u>Connie Vasce</u> (STAFF)</p> <p>on: <u>JUL 22 2016</u></p> <p>(DATE)</p>
--

Copies of Final Certificate to be sent to:

1. Watermaster District #: 12 ✓
- ~~2. Data Center (include copy of map)~~
- ~~3. Water Availability~~
- ~~4. Vault~~ ✓
5. File

Other persons to receive copies: (include map):

- 1.



Oregon
Kate Brown, Governor

Water Resources Department
725 Summer St NE, Suite A
Salem, OR 97301
(503) 986-0900
Fax (503) 986-0904

DATE MAILED: JUL 22 2016

NOTICE

Reference: Application R-85522 Permit R-13665

Enclosed is a proposed certificate of water right and a map. The map and proposed certificate represent the extent water was stored based upon a Claim of Beneficial Use, that either you or a previous permit holder submitted.

The certificate is the final step in the water right process. The Department encourages you to review this proposal. If you do not agree with the proposed certificate, Oregon Administrative Rule 690-330-010 (2) allows the permittee or landowner 60 days from the mailing date of this notice to request the Department to reconsider the contents of the proposed certificate.

If you agree with the proposed certificate, no response to this notice is required. Sometime after comment period, the recorded certificate of water right will be mailed to the permit holder of record.

If your name is not listed on the proposed certificate, and you are the current landowner, and would like to have the final certificate issued in your name, you may apply through the Department to have the permit assigned to you. If you have any questions about the assignment process, please contact Jerry Sauter at 503-986-0817.

If you have any questions please contact Gerry Clark at 503-986-0811.

Sincerely,

Dwight French
Administrator Water Right Services



RECEIVED
 APR 01 2003
 WATER RESOURCES DEPT.
 SALEM, OREGON
 R13E

RECEIVED
 IAN 08 2003
 WATER RESOURCES DEPT.
 SALEM, OREGON

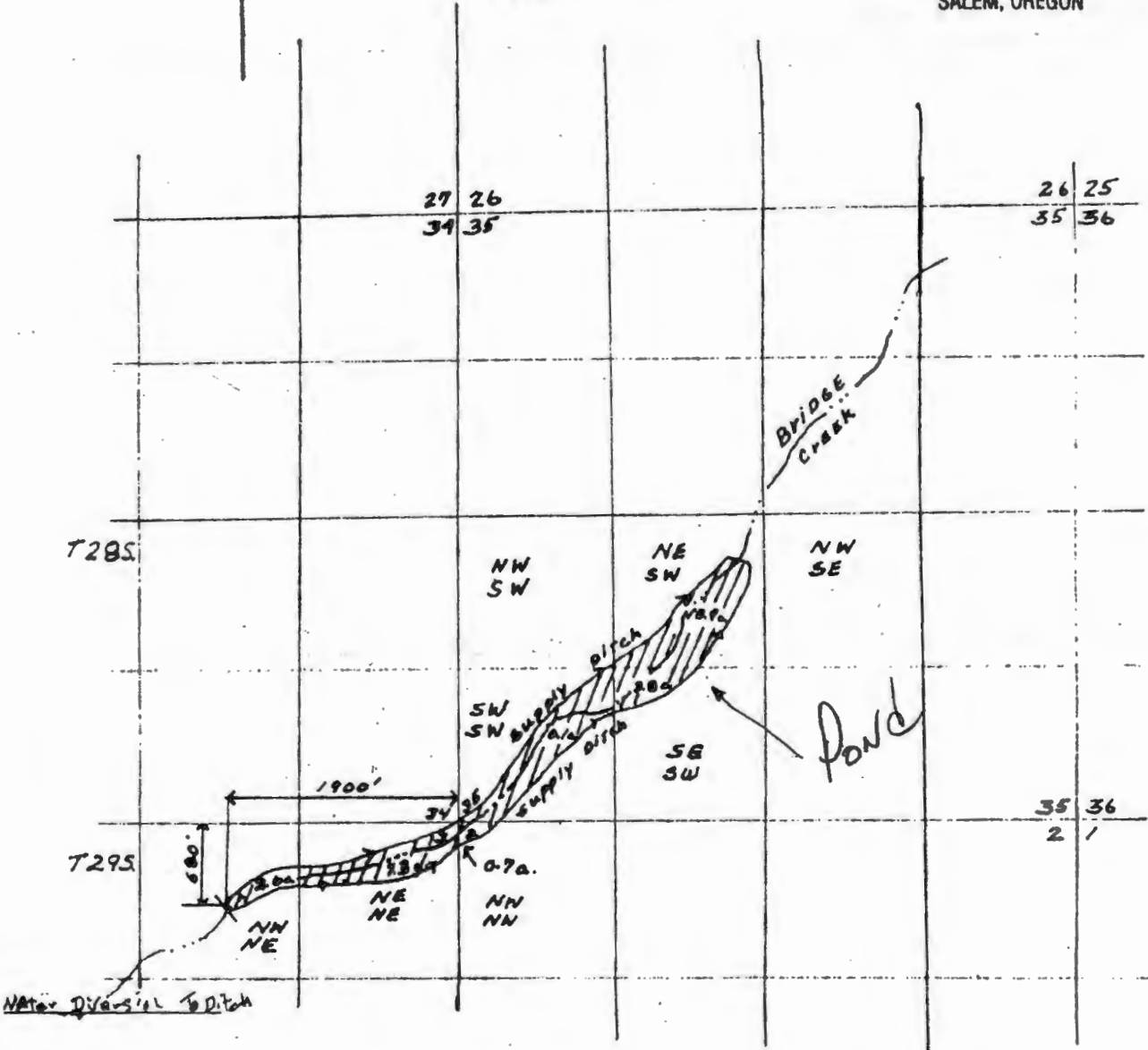

T 28 S R 13 E SEC. 35
 SW ¼ SW ¼ 10.1 Acres
 SE ¼ SW ¼ 3.9 "
 NE ¼ SW ¼ 10.9 " 24.8 ac
 T 29 S R 13 E SEC. 3
 NW ¼ NE ¼ 2.6 "
 NE ¼ NE ¼ 7.3 " 9.9 ac
 T 29 S. R 13 E SEC. 2
 NW ¼ NW ¼ 0.7 " 0.7 ac
 Total 35.4 ac

App # R. 85522
 Permut # R-13665
JAMES SPHAR
 BRIDGE CREEK MEADOW
 EXISTING IRRIGATION SYSTEM
 SCALE 4" = 1 MILE
 DATA PLOTTED ON AERIAL

RECEIVED BY OWRD

SEP 10 2015

SALEM, OR

Certificate Checklist for Qualifying Reservoirs

Under ORS 537.409(10)(11) (COBU by Permittee for "Alternative Reservoirs")

(Must be less than 9.2 acre feet)

File No. R- 85522

File Marked YES

Date Rec'd. 9.10.15

Claim Logged YES

Reviewer Codi

Peer Review M. Bjork
7-12-16

Intake Checklist

Does a secondary permit exist for use of water under this permit at the time of this submittal?

YES NO (If "Yes", this self certification cannot be accepted. The Claim must be prepared by a CWRE for both the reservoir and the secondary use permit.)

Are reservoir dimensions included? YES NO

Signed by all permittees? YES NO (Must be signed by all permittees. If not, Assignment may be needed).

Was a map included? YES NO (Must Identify Location of the Reservoir)

Processing Notes and Conclusions

The Claimed maximum capacity of the reservoir in acre feet is: 8.98 $\frac{325.5 \times 171.5 \times 7}{43560} = 8.970$

The Permitted capacity of the reservoir in acre feet is: 9.0

Is this reservoir located within an "Area of Interest"? YES NO

Identified Party NA

Current Ownership Check:

Does the County Assessor indicate that there is a new landowner? YES NO

(If new owners, indicate name and mailing address below)

Attached

Pls. Complete
Processing
Notes & Concl.
Section :-
←

Issue: PROPOSED (If fewer acre feet were developed than were permitted)

CERTIFICATE # _____

HOLMES Codi N

From: Dave Knowles <dknowles@co.lake.or.us>
Sent: Tuesday, July 12, 2016 12:01 PM
To: HOLMES Codi N
Subject: RE: Ownership Info

Codi,
Sorry about the slow response getting back to you.
The owners of your described map is account #8032.
Steve & Cathie Sphar
P.O. Box 182
Silver Lake OR 97638

Lake County Assessor's Office
Assessor
Dave Knowles
541-947-6921
dknowles@co.lake.or.us

From: HOLMES Codi N [<mailto:codi.n.holmes@state.or.us>]
Sent: Thursday, July 07, 2016 8:31 AM
To: Dave Knowles <dknowles@co.lake.or.us>
Subject: Ownership Info

I am inquiring about current ownership and mailing address for Tax Map 29S13E000000100.

Thank you

Codi Holmes
Certificate Specialist
Oregon Water Resources
725 Summer St NE Suite A
Salem OR 97301
503-986-0887

CONFIDENTIALITY NOTICE - This e-mail may contain information that is privileged, confidential, or otherwise exempt from disclosure under applicable law. If you are not the addressee or it appears from the context or otherwise that you have received this e-mail in error, please advise me immediately by reply e-mail, keep the contents confidential, and immediately delete the message and any attachments from your system.

Certificate Checklist for Qualifying Reservoirs

Under ORS 537.409 (10) (11)(COBU by Permittee)

(Must be less than 9.2 acre feet)

File No.: R-8 5522

Date: 9/10/2015

Reviewer: Connie Vance

Secondary Permit?: YES NO. (If Yes, Self Certification Cannot Be Allowed. COBU For Both Reservoir and Secondary Must Be Performed By a CWRE)

Signed by permittee? YES NO (Must be Signed by Permittee. If no. Assignment may be needed)

Reservoir Dimensions Included YES NO

The Maximum Capacity of the Reservoir in Acre Feet *: _____ Permit = _____
(If less than permit, issue PROPOSED)

Check Area of Interest YES NO
Identified Party _____

Check Current Ownership YES NO (If new owners, indicate name and mailing address below)

Map Included (Must Identify Location of the Reservoir)* YES NO

Issue: PROPOSED

CERTIFICATE = _____

Peer Review _____

File Marked yes

Claim Logged yes

**CLAIM OF
BENEFICIAL USE
for Reservoirs storing less than
9.2 acre-feet permitted under
ORS 537.409**



Oregon Water Resources Department
725 Summer Street NE, Suite A
Salem, Oregon 97301-1266
(503) 986-0900
www.wrd.state.or.us

**A fee of \$175 must accompany this form.
The Claim will be returned if the fee is not included.**

This form may be completed by the permit holder of record if:

- 1) The permit was issued under the authority of ORS 537.409.
- 2) No secondary permit exists for the use of water stored in the reservoir.
- 3) The developed capacity of the reservoir is less than 9.2 acre-feet.
- 4) The water was stored by the date required in the permit.

A separate form shall be completed for each permit.

This form must be submitted to the Water Resources Department within one year of storage of water in the reservoir.

Please type or print in dark ink. If the data provided is found to contain errors or omissions, it may be returned. The Department may require the submittal of additional information.

If you have questions regarding the completion of this form, please call 503-986-0900 and ask for the Certificate Section.

**SECTION 1
GENERAL INFORMATION**

File Information

APPLICATION #	PERMIT #
R- 85522	R- 13665

Applicant Information

APPLICANT NAME	PHONE No.	ADDITIONAL CONTACT No.	
Steve Sphar	541-576-3048		
ADDRESS			
PO. Box 182			
CITY	STATE	ZIP	E-MAIL
Silverlake	OR	97638	N/A

RECEIVED BY OWRD

SECTION 2
RESERVOIR INFORMATION

Reservoir Dimensions and Capacity

AVERAGE LENGTH	AVERAGE WIDTH	AVERAGE DEPTH	MAXIMUM CAPACITY IN ACRE-FEET
325.5	171.5	7.0	8.98

To determine capacity in acre-feet use for the above table, use the following calculation:

$$\text{Acre-feet} = \frac{(\text{Average Length})(\text{Average Width})(\text{Average Depth})}{43,560}$$

SECTION 3

MAP

Attach a map identifying the reservoir location. If the water right application map accurately reflects the location of the reservoir, you may attach a copy it. Otherwise, you must submit a map meeting the standards of OAR 690-310-0050, which are attached.

Preparation of the map by a Certified Water Rights Examiner is **not** required for this type of permit, but may be submitted.

SECTION 4

SIGNATURE

This Claim of Beneficial Use must be signed by each permit holder of record.

By my signature, I certify that the information contained herein is true and correct to the best of my knowledge.

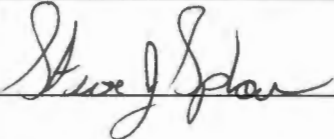
SIGNATURE	PRINT OR TYPE NAME	TITLE	DATE
	Steve Sphar	owner	8/31/15

STATE OF OREGON

COUNTY OF LAKE

PERMIT TO CONSTRUCT A RESERVOIR AND STORE THE PUBLIC WATERS

THIS PERMIT IS HEREBY ISSUED TO

STEVE SPHAR
PO BOX 182
SILVER LAKE, OR 97638

The specific limits and conditions of the use are listed below.

APPLICATION FILE NUMBER: R-85522

SOURCE OF WATER: BRIDGE CREEK, A TRIBUTARY OF SILVER CREEK

STORAGE FACILITY: UNNAMED RESERVOIR

PURPOSE OR USE OF THE STORED WATER: MULTIPLE PURPOSE

MAXIMUM STORAGE VOLUME: 9.0 ACRE FEET EACH YEAR

WATER MAY BE APPROPRIATED FOR STORAGE DURING THE PERIOD: YEAR ROUND

DATE OF PRIORITY: APRIL 01, 2003

DAM LOCATION: NW 1/4 NE 1/4, SECTION 3, T29S, R13E, W.M.; 680 FEET SOUTH
& 1900 FEET WEST FROM NE CORNER, SECTION 3

THE AREA TO BE SUBMERGED BY THE RESERVOIR IS LOCATED AS FOLLOWS:

NE 1/4 SW 1/4

NW 1/4 SW 1/4

SW 1/4 SW 1/4

SE 1/4 SW 1/4

SECTION 35

TOWNSHIP 28 SOUTH, RANGE 13 EAST, W.M.

NW 1/4 NW 1/4

SECTION 2

NE 1/4 NE 1/4

NW 1/4 NE 1/4

SECTION 3

TOWNSHIP 29 SOUTH, RANGE 13 EAST, W.M.

RECEIVED BY OWRD

SEP 10 2015

SALEM, OR

Application R-85522 Water Resources Department

PERMIT R-13665

Measurement, recording and reporting conditions:

- A. Before water use may begin under this permit, the permittee shall install a meter or other suitable measuring device as approved by the Director. The permittee shall maintain the meter or measuring device in good working order.
- B. The permittee shall allow the watermaster access to the meter or measuring device; provided however, where the meter or measuring device is located within a private structure, the watermaster shall request access upon reasonable notice.
- C. The Director may require the permittee to keep and maintain a record of the amount (volume) of water used and may require the permittee to report water use on a periodic schedule as established by the Director. In addition, the Director may require the permittee to report general water use information, the periods of water use and the place and nature of use of water under the permit. The Director may provide an opportunity for the permittee to submit alternative reporting procedures for review and approval.

The storage of water allowed herein is subject to the installation and maintenance of an outlet pipe, or the provision of other means to evacuate water when determined necessary by the Water Resources Director to satisfy prior downstream rights.

The permittee shall pass all live flow outside the storage season described above.

This permit does not provide for the appropriation of water for any out of reservoir uses, the maintenance of the water level or maintaining a suitable fresh water condition. If any water is used for out of reservoir uses, or any live flow is appropriated to maintain either the water level or a suitable freshwater condition, a secondary water right is required.

If the riparian area is disturbed in the process of developing a point of diversion, the permittee shall be responsible for restoration and enhancement of such riparian area.

The use may be restricted if the quality of the source stream or downstream waters decrease to the point that those waters no longer meet existing state or federal water quality standards due to reduced flows.

The permittee shall install, maintain, and operate fish screening to prevent fish from entering the proposed diversion. The permittee shall

WILLIAMSON Bethanie R

8/17

COBU Received

From: BAMBERGER Machel A
Sent: Wednesday, August 26, 2015 4:26 PM
To: SAUTER Jerry K
Cc: WILLIAMSON Bethanie R
Subject: app R-85522

August 26, 2015, Cathy Sphar called about the compliance letter they received. They thought, the water master said they were all done. I sent out a copy of the permit and map, along with the Claim form.

Machelle

Machelle A Bamberger | Adjudication and Extension Specialist

Water Resources Department | 725 Summer St. NE, Suite A | Salem, Oregon 97301

Ph: 503 986-0802 | Fax: 503 986-0901

Email: Machelle.A.Bamberger@wrд.state.or.us | Web: <http://www.wrd.state.or.us>



Oregon Water Resources Department

Water Rights Application
Number R-85522

Final Order

Appeal Rights

This is a final order in other than contested case. Pursuant to ORS 537.409(9), ORS 183.484, OAR 137-004-080 and OAR 690-01-005, you may either petition the Director for reconsideration of this order or petition for judicial review of this order. Any petition for judicial review of the order must be filed within the 60 day time period specified by ORS 183.484(2).

Application History

On APRIL 01, 2003, STEVE SPHAR submitted an application to the Department for a water use permit. Pursuant to ORS 537.409, the Department provided public notice of the application in the Department's weekly public notice. A 60 day comment period followed.

The Department **has not** received adverse comments related to the possible issuance of the attached permit.

The Department **has** received comments from Oregon Department of Fish and Wildlife related to the possible issuance of the attached permit. Permit Number R-13665 is conditioned to address the issues raised in those comments.

Water is available for the proposed use as described in the attached permit.

The use, as described on the attached permit, will not injure any existing water rights and does not pose potential detrimental impacts to existing fishery resources.

Therefore, the proposed use would not impair or be detrimental to the public interest.

Order

Application R-85522 therefore is approved pursuant to ORS 537.409, and Permit Number R-13665 is issued as limited by the conditions contained therein.

DATED July 16, 2003



Paul R. Cleary
Director

This document was prepared by Jerry Gainey. If you have any questions about any of the statements contained in this document I am the most likely the best person to answer your questions. You can reach me at 1-503-378-8455, extension 458.

If you have questions about how to file a protest or if you have previously filed a protest and want to know the status, please contact Renee Moulun at extension 239.

If you have other questions about the Department or any of its programs please contact our Water Rights Information Group at extension 201. Address all other correspondence to: Water Rights Section, Oregon Water Resources Department, 158 12th Street NE, Salem, OR 97301-4172, Fax: (503)378-6203.

STATE OF OREGON

COUNTY OF LAKE

PERMIT TO CONSTRUCT A RESERVOIR AND STORE THE PUBLIC WATERS

THIS PERMIT IS HEREBY ISSUED TO

STEVE SPHAR
PO BOX 182
SILVER LAKE, OR 97638

The specific limits and conditions of the use are listed below.

APPLICATION FILE NUMBER: R-85522

SOURCE OF WATER: BRIDGE CREEK, A TRIBUTARY OF SILVER CREEK

STORAGE FACILITY: UNNAMED RESERVOIR

PURPOSE OR USE OF THE STORED WATER: MULTIPLE PURPOSE

MAXIMUM STORAGE VOLUME: 9.0 ACRE FEET EACH YEAR

WATER MAY BE APPROPRIATED FOR STORAGE DURING THE PERIOD: YEAR ROUND

DATE OF PRIORITY: APRIL 01, 2003

DAM LOCATION: NW 1/4 NE 1/4, SECTION 3, T29S, R13E, W.M.; 680 FEET SOUTH
& 1900 FEET WEST FROM NE CORNER, SECTION 3

THE AREA TO BE SUBMERGED BY THE RESERVOIR IS LOCATED AS FOLLOWS:

NE 1/4 SW 1/4
NW 1/4 SW 1/4
SW 1/4 SW 1/4
SE 1/4 SW 1/4
SECTION 35

TOWNSHIP 28 SOUTH, RANGE 13 EAST, W.M.

NW 1/4 NW 1/4
SECTION 2
NE 1/4 NE 1/4
NW 1/4 NE 1/4
SECTION 3

TOWNSHIP 29 SOUTH, RANGE 13 EAST, W.M.

Measurement, recording and reporting conditions:

- A. Before water use may begin under this permit, the permittee shall install a meter or other suitable measuring device as approved by the Director. The permittee shall maintain the meter or measuring device in good working order.
- B. The permittee shall allow the watermaster access to the meter or measuring device; provided however, where the meter or measuring device is located within a private structure, the watermaster shall request access upon reasonable notice.
- C. The Director may require the permittee to keep and maintain a record of the amount (volume) of water used and may require the permittee to report water use on a periodic schedule as established by the Director. In addition, the Director may require the permittee to report general water use information, the periods of water use and the place and nature of use of water under the permit. The Director may provide an opportunity for the permittee to submit alternative reporting procedures for review and approval.

The storage of water allowed herein is subject to the installation and maintenance of an outlet pipe, or the provision of other means to evacuate water when determined necessary by the Water Resources Director to satisfy prior downstream rights.

The permittee shall pass all live flow outside the storage season described above.

This permit does not provide for the appropriation of water for any out of reservoir uses, the maintenance of the water level or maintaining a suitable fresh water condition. If any water is used for out of reservoir uses, or any live flow is appropriated to maintain either the water level or a suitable freshwater condition, a secondary water right is required.

If the riparian area is disturbed in the process of developing a point of diversion, the permittee shall be responsible for restoration and enhancement of such riparian area.

The use may be restricted if the quality of the source stream or downstream waters decrease to the point that those waters no longer meet existing state or federal water quality standards due to reduced flows.

The permittee shall install, maintain, and operate fish screening to prevent fish from entering the proposed diversion. The permittee shall

also install a fishway at the obstruction that will provide adequate upstream and downstream passage for fish. The permittee may submit evidence that the Oregon Department of Fish and Wildlife (ODFW) has determined screens and/or fishways are not necessary. The required screens and fishways are to be in place, functional, and approved by ODFW before diversion of any water.

STANDARD CONDITIONS

Failure to comply with any of the provisions of this permit may result in action including, but not limited to, restrictions on the use, civil penalties, or cancellation of the permit.

This permit is for the beneficial use of water without waste. The water user is advised that new regulations may require the use of best practical technologies or conservation practices to achieve this end.

By law, the land use associated with this water use must be in compliance with statewide land-use goals and any local acknowledged land-use plan.

The use of water allowed herein may be made only at times when sufficient water is available to satisfy all prior rights, including prior rights for maintaining instream flows.

This permit does not authorize the permit holder to pursue this right in such a way as to interfere with or affect adjacent property not under the ownership of the permit holder.

The Director finds that the proposed use(s) of water described by this permit, as conditioned, will not impair or be detrimental to the public interest.

The reservoir shall be filled and complete application of the stored water to the use shall be made on or before October 1, 2007.

Within one year after complete application of water to the proposed use, the permittee shall submit a claim of beneficial use to the Oregon Water Resources Department.

The claim of beneficial use shall be prepared by a Certified Water Right Examiner in conformance with the requirements of OAR 690-014 if an associated secondary permit exists for the use of stored water under this permit, or if the reservoir stores 9.2 or more acre-feet of water.

If no secondary permit exists and the reservoir stores less than 9.2 acre-feet of water, the claim of beneficial use need not be prepared by a Certified Water Right Examiner. The information submitted to the Oregon Water Resources Department shall include:

- (a) the dimensions of the reservoir;
- (b) the maximum capacity of the reservoir in acre-feet; and
- (c) a map identifying the location of the reservoir prepared in compliance with Water Resource Department standards.

Issued July 16, 2003

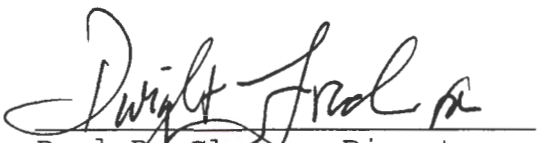
Paul R. Cleary, Director
Water Resources Department

REAL ESTATE TRANSACTIONS: Pursuant to ORS 537.330, in any transaction for the conveyance of real estate that includes any portion of the lands described in this permit, the seller of the real estate shall, upon accepting an offer to purchase that real estate, also inform the purchaser in writing whether any permit, transfer approval order, or certificate evidencing the water right is available and that the seller will deliver any permit, transfer approval order or certificate to the purchaser at closing, if the permit, transfer approval order or certificate is available.

CULTURAL RESOURCES PROTECTION LAWS: Permittees involved in ground-disturbing activities should be aware of federal and state cultural resources protection laws. ORS 358.920 prohibits the excavation, injury, destruction or alteration of an archeological site or object, or removal of archeological objects from public and private lands without an archeological permit issued by the State Historic Preservation Office. 16 USC 470, Section 106, National Historic Preservation Act of 1966 requires a federal agency, prior to any undertaking to take into account the effect of the undertaking that is included on or eligible for inclusion in the National Register. For further information, contact the State Historic Preservation Office at 503-378-4168, extension 232.



Oregon
Kate Brown, Governor

Water Resources Department

725 Summer St NE, Suite A

Salem, OR 97301

(503) 986-0900

Fax (503) 986-0904

September 14, 2015

Steve Sphar
PO Box 182
Silverlake OR 97638

On September 10, 2015, the Water Resources Department received the Claim of Beneficial Use (COBU) for the following file(s):

Application R-85522 Permit-R-13665

The COBU included a report and map. In the future the Department will review your submittal. At that time we will review these items and provide a final certificate, proposed certificate, or a request for additional information.

If you are interested in having your COBU reviewed sooner, you may pay to have your file processed immediately, using the Reimbursement Authority program, which is described at: http://www.wrd.state.or.us/OWRD/mgmt_reimbursement_authority.shtml

Customer Service phone: (503) 986-0801

If you sell the property, please contact the Department, or have the new owners contact the Department about the need to file an assignment.

Cc: file



Oregon

Kate Brown, Governor

Water Resources Department

North Mall Office Building
725 Summer St NE, Suite A
Salem, OR 97301
Phone (503) 986-0900
Fax (503) 986-0904
www.wrd.state.or.us

NOTE: For water rights information and useful forms, please see our web site at www.oregon.gov/OWRD

August 17, 2015

Certified mail number 7008 1830 0004 4595 0817
Return receipt requested

STEVE J. SPHAR
PO BOX 182
SILVER LAKE, OR 97638

Reference: Application R-85522, Permit R-13665

Dear Permit Holder:

This letter is in regard to your water use permit as referenced above. Your permit required you to complete the development of your water use by October 1, 2007.

In order for the Department to consider issuance of a certificate of water right, you are required by law to hire a certified water right examiner to prepare and submit a claim of beneficial use that includes a final proof survey map of the development. The map and claim of beneficial use were to have been submitted to our Department within one year of October 1, 2007. The fee for submitting a claim of beneficial use is \$175.00. Please see the enclosed 'Resource Sheet' for our current database of CWRE's.

If you are not finished with the development of your permit, you need to file an application for an extension of time to complete your development. The fee for filing an extension of time is \$575.00. Please see the enclosed 'Resource Sheet' to access the extension of time form.

In the event that you are no longer using water as allowed by this permit, you should cancel it so that we may clear our records. Please see the enclosed 'Resource Sheet' to access the cancellation form, if you are interested in this option.

If you have not submitted either a Claim of Beneficial Use or a request for an extension of time for your permit within 60 days of the date of this letter (October 16, 2015) the Department may issue a Final Order to cancel your permit without further notice. If the Department issues a Final Order to cancel your permit, and you request reconsideration of the final order and reinstatement of your permit, there is a \$450.00 reinstatement fee that is charged in addition to the claim of beneficial use or extension of time fee.

Should you have any questions, please contact Corey Courchane by telephone at 503-986-0825, Mabelle Bamberger by telephone at 503-986-0802, or myself at the address above or by telephone at 503-986-0817.

Sincerely,

Jerry Sauter
Water Rights Program Analyst

Enclosures (1)

cc: File R-85522
OWRD Watermaster District 12

1. Per Dwight French, **do not** send "C" DATE NOTICE PACKET if: update appropriate db

None Extension pending _____

Assignment is pending _____

Cancellation has been requested _____

Dept. has already sent a certified 60-Day Compliance letter (date _____, # _____)

Was **60 days notice** allowed? Y N If No, How Much Time ? _____

Was mail deliverable as addressed? Y N date _____

If mail returned, online/www check ? Y N date _____ successful ? Y N

Re-send Cert. Letter ? Y N date _____

Send cancellation order Y N

Claim of beneficial use and final proof map (COBU) have been received by Department
Date information received _____

2. IF NONE OF THE ABOVE APPLY

Send **certified** "C" date notice packet to permit holder.

"C" DATE 10-1-2007 BASIN NUMBER 13 WM # 12

CWRE or AGENT None

3. AOI Yes _____ NO λ If Yes, name of AOI _____



Send letter



RECEIVED

APR 01 2003

WATER RESOURCES DEPT.
SALEM, OREGON

R13E

RECEIVED

IAN 08 2003

WATER RESOURCES DEPT.
SALEM, OREGON

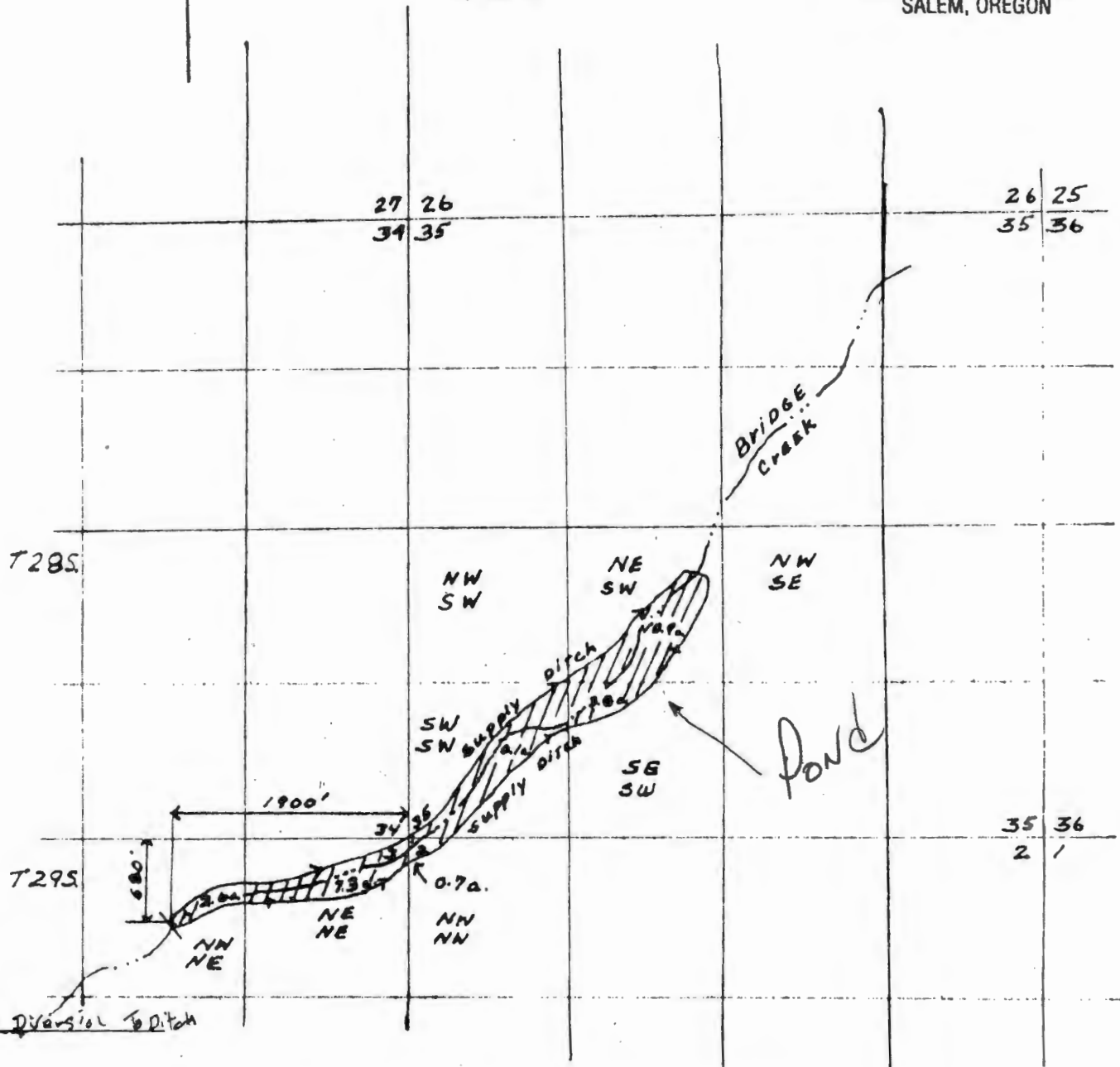

T 28 S	R 13 E	SEC. 35	
SW 1/4	SW 1/4	10.1	Acres
SE 1/4	SW 1/4	3.8	"
NE 1/4	SW 1/4	10.9	" 24.8 ac
T 29 S	R 13 E	SEC. 3	
NW 1/4	NE 1/4	2.6	"
NE 1/4	NE 1/4	7.3	" 9.9 ac
T 29 S	R 13 E	SEC. 2	
NW 1/4	NW 1/4	0.7	" 0.7 ac
Total			55.4 ac

App # R. 85522
Permit # R-13665

JAMES SPHAR

BRIDGE CREEK MEADOW

EXISTING IRRIGATION SYSTEM

SCALE 1" = 1 MILE

DATA PLOTTED ON AERIAL



Oregon

John A. Kitzhaber, M.D., Governor

Water Resources Department

Commerce Building
158 12th Street NE
Salem, OR 97301-4172
(503) 378-3739
FAX (503) 378-8130
www.wrd.state.or.us

January 10, 2003

STEVE J SPHAR
PO BOX 182
SILVER LAKE OR 97638

Talked with Mr. Sphar. Fixed Map and App. Form Over phone.

Dear Applicant:

NOTE: Mr. Sphar is working with MR. DAVE ROE (WATER MASTER DST#12)

The Water Resources Department has received your application to store water under the Alternate Review Process (ORS 537.409) At this time we are unable to accept your application because it does not meet minimum filing requirements.

Please provide the following information:

- The application that you submitted is not the correct application form. Please fill out the enclosed, "Application for a Permit to Construct a Reservoir." The alternate permit application process is for qualifying reservoirs only. To use this type of application form, it requires your reservoir to be less than 9.2 acre feet of storage or your dam height to be less than 10 feet; of which, your reservoir is at both 9.2 acre feet and dam height is 10 feet. One of the two (9.2 acre-feet or 10 feet height) must fall below the above-mentioned requirements in order to qualify for the alternate reservoir process.

Examples of Qualifying Reservoirs under the "Alternate Review Process" are as follows:

- Storage capacity of 15 acre-feet and dam height of 9.9.
Or
- Dam height of 7.9 and storage capacity of 200 acre-feet.
Or
- Storage capacity of 9.1 acre-feet and a dam height of 14 feet.

The above are examples of "Qualifying Reservoirs" for the "Alternate Review Process (ORS 537.409)

BEN CAR

app # R-85522



- Please fill out the enclosed "Land Use Information Form" and have it signed by your local planning official.

Please provide a map containing the following information:

- The location of your reservoir or dam must be referenced to a recognized public land survey corner; do not measure from property lines unless they are part of the public land survey lines. The locations may be shown by distance and bearing. (EX: 400 feet south and 350 feet west of the Northeast corner of section 27).
- The scale of the map must be a standard, even scale of not less than 4 inches to a mile, and must be indicated on the map. Note: We realize that you did submit a map of the right scale, but I believe that your reservoir is not in that same section.

Note: Please return any corresreservoirence received by us so that we may accelerate the processing of your application.

Your application and supporting data and check for \$92.00 are being returned. We can begin processing your application when the information noted above is received.

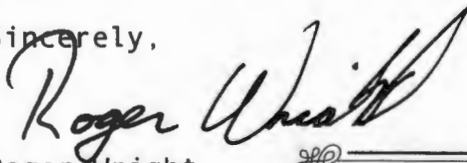

If you have any questions about the application procedure for Alternate Reservoirs or general water right questions, you may call the Water Rights Information Group (WRIG) at: (503)378-8455 extension 273.

Sincerely,



Roger Wright
Public Service Re
Water Rights Sect

cc: W.M. DIST. _
GEN. CORR.
FISCAL

BRIDGE CREEK RED ANGUS STEVE SPHAR CATHIE E. SPHAR P O BOX 182 (541) 576-3048 SILVER LAKE, OR 97636		3902 <small>96-841/1232</small>
Pay to the Order of <u>Oregon Water Resources</u>		<u>27/10/02</u> Date \$ 92.00
<u>Twenty Two</u> Dollars		Dollars 
 Community First Bank <small>www.cfbnk.com</small>		
Mr. <u>Water Permit</u>		 3902

App. No. _____

For Department Use

Permit No. _____

Date _____

3. WATER USE

Indicate the proposed use(s) of the stored water. **NOTE: You may wish to consider filing for "Multipurpose use" for your reservoir. Multipurpose use does not limit the types of future uses for the stored water. Multipurpose covers all uses including: stockwater, fish and wildlife, aesthetics, domestic, irrigation, agriculture, fire protection and pollution abatement.** If any use will be out of reservoir use, regardless of the type of storage listed, a secondary application must be filed to appropriate the stored water.

4. PROPERTY OWNERSHIP

RECEIVED

JAN 08 2003

WATER RESOURCES DEPT.
SALEM, OREGON

Do you own all the land where you propose to divert, transport, and use water?

- Yes (Skip to section 5)
- No Please check the appropriate box below.
 - I have a recorded easement or written authorization permitting access.
 - I do not currently have written authorization or an easement permitting access to lands not under my ownership.

List the names and mailing addresses of all affected landowners*:

* If more than 25 landowners are involved, a list is not required. Alternative notice may be made.

5. ENVIRONMENTAL IMPACT

- A. Channel:** Is the reservoir in stream or off channel ?
 - B. Wetland:** Is the project in a wetland? Yes No Don't know
 - C. Existing:** Is this an existing reservoir? Yes No If yes, how long has it been in place? _____ years.
 - D. Fish Habitat:** Is there fish habitat upstream of the proposed structure? Yes No Don't know. If yes, how much? _____ miles.
 - E. Partnerships:** Have you been working with other agencies? Yes No
- Indicate agency, staff and phone numbers of those involved. Also indicate any agencies that are cost sharing in this project.

6. SIGNATURE

I attest that all statements made and information provided in this application are true and correct to the best of my knowledge.

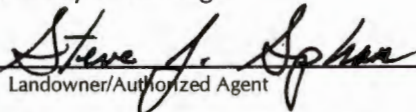
Landowner/Authorized Agent

NOV. 1 - 02
Date

Before you submit your application be sure you have:

- Answered each question completely.
- Included a legible map which includes Township, Range, Section, quarter-quarter and tax lot number. The map must meet map requirements to be accepted.
- Included a land use form or receipt stub signed by a local planning official.
- Included a check payable to Oregon Water Resources Department for the appropriate amount.

FEE STRUCTURE: The fee is based on the number of acre-feet proposed to be stored. The fee is \$10 per Acre-Foot. Example: 0.3 AF = \$3.00; 1.5 AF = \$15.00; 20.0 AF = \$100
Maximum fee is \$100 for any reservoir storing more than 10 Acre-Feet

STATE OF OREGON
COUNTY OF LAKE
CERTIFICATE OF WATER RIGHT

This Is to Certify, That JAMES H. OR LORRAINE D. SPHAR

of Silver Lake, State of Oregon, 97638, has made proof to the satisfaction of the Water Resources Director, of a right to the use of the waters of Bridge Creek

a tributary of Silver Creek for the purpose of irrigation of 14.5 acres

under Permit No. 36203 and that said right to the use of said waters has been perfected in accordance with the laws of Oregon; that the priority of the right hereby confirmed dates from May 7, 1971 that the amount of water to which such right is entitled and hereby confirmed, for the purposes aforesaid, is limited to an amount actually beneficially used for said purposes, and shall not exceed 0.18 cubic foot per second

or its equivalent in case of rotation, measured at the point of diversion from the stream. The point of diversion is located in the Lot 2 (NW $\frac{1}{4}$ NE $\frac{1}{4}$), Section 3, T. 29 S., R. 13 E., W. M., 590 feet South and 1750 feet West from the NE Corner, Section 3

The amount of water used for irrigation, together with the amount secured under any other right existing for the same lands, shall be limited to one-eightieth of one cubic foot per second per acre, or its equivalent for each acre irrigated and shall be further limited to a diversion of not to exceed 3 acre feet per acre for each acre irrigated during the irrigation season of each year,

and shall conform to such reasonable rotation system as may be ordered by the proper state officer.

A description of the place of use under the right hereby confirmed, and to which such right is appurtenant, is as follows:

- 5.2 acres NE $\frac{1}{4}$ SW $\frac{1}{4}$
- 2.6 acres SW $\frac{1}{4}$ SW $\frac{1}{4}$
- 2.0 acres SE $\frac{1}{4}$ SW $\frac{1}{4}$
- Section 35
- T. 28 S., R. 13 E., W. M.
- 0.7 acre Lot 4 (NW $\frac{1}{4}$ NW $\frac{1}{4}$)
- Section 2
- 4.0 acres Lot 1 (NE $\frac{1}{4}$ NE $\frac{1}{4}$)
- Section 3
- T. 29 S., R. 13 E., W. M.

The right to the use of the water for the purposes aforesaid is restricted to the lands or place of use herein described. and is subject to the existing minimum flow policies established by the Water Policy Review Board.

WITNESS the signature of the Water Resources Director, affixed

this date. June 17, 1977

James E. Sexson
Water Resources Director

Recorded in State Record of Water Right Certificates, Volume 36, page 44494

Do Not Send to Salem, A.P.

RECEIVED

JAN 08 2003

WATER RESOURCES DEPT.
SALEM, OREGON

RECEIVED

IAN 08 2003

WATER RESOURCES DEPT.
SALEM, OREGON

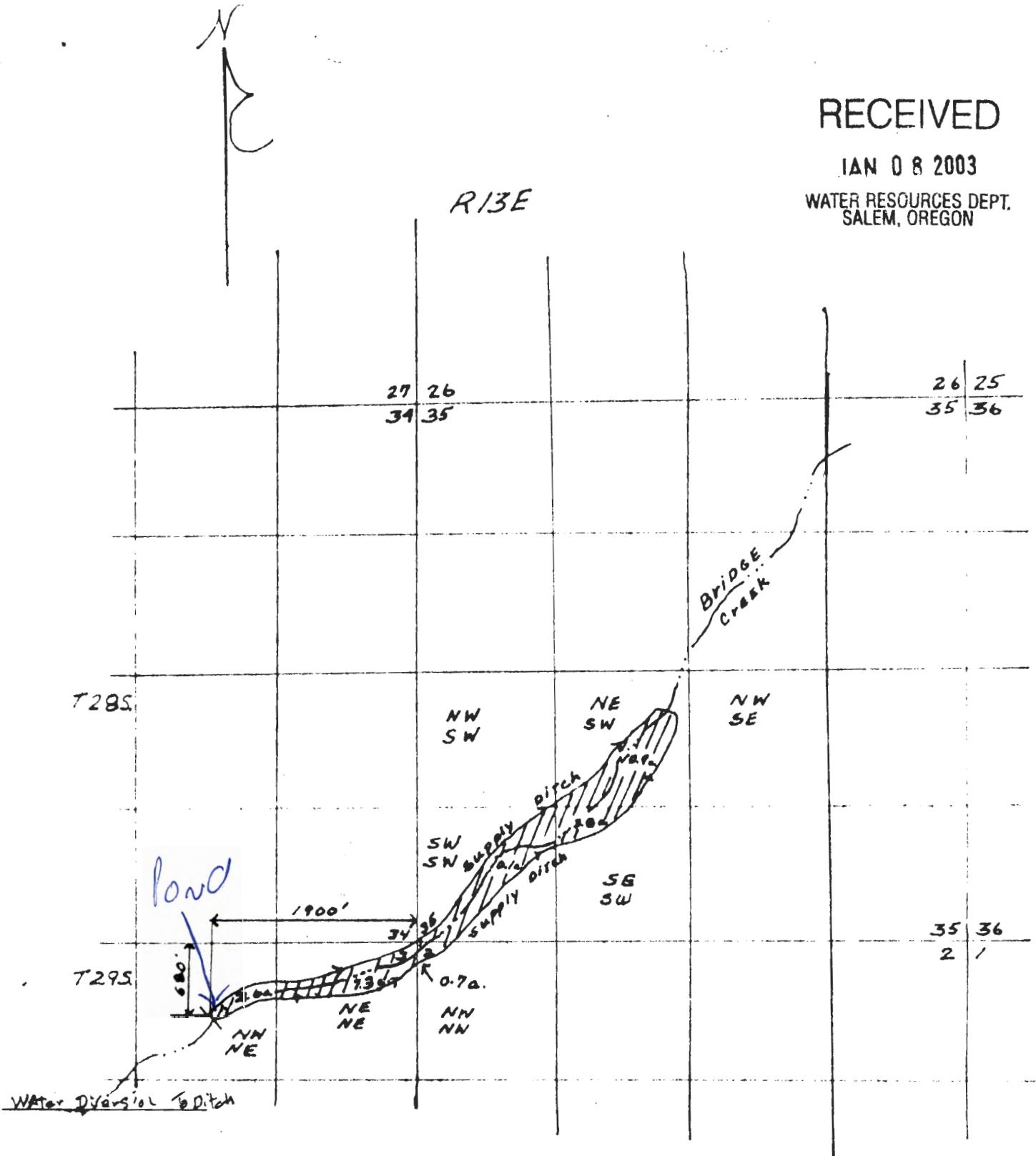

T 28 S R 13 E SEC. 35
 SW 1/4 SW 1/4 10.1 Acres
 SE 1/4 SW 1/4 3.8 "
 NE 1/4 SW 1/4 10.9 " 24.8 ac
 T 29 S R 13 E SEC. 3
 NW 1/4 NE 1/4 2.6 "
 NE 1/4 NE 1/4 7.3 " 9.9 ac.
 T 29 S. R 13 E SEC. 2
 NW 1/4 NW 1/4 0.7 " 0.7 ac.
 Total 35.4 ac.

JAMES SPHAR

BRIDGE CREEK MEADOW

EXISTING IRRIGATION SYSTEM

SCALE 4" = 1 MILE

DATA PLOTTED ON AERIAL

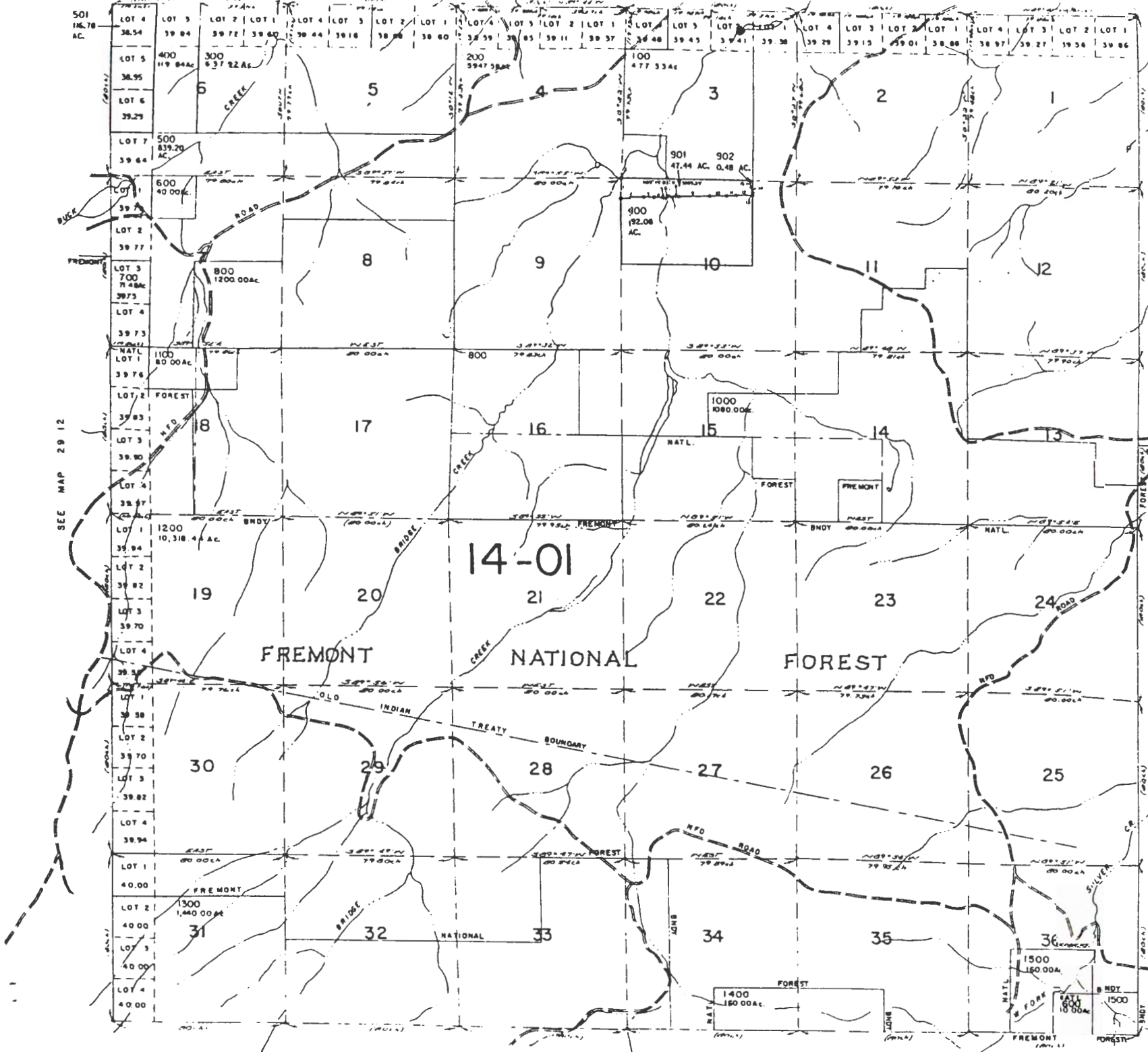

29 13

POD
RESERVOIR
LAKE

PARCEL 901
 1. 100' x 100' = 10,000
 2. 100' x 100' = 10,000
 3. 100' x 100' = 10,000
 4. 100' x 100' = 10,000
 5. 100' x 100' = 10,000
 6. 100' x 100' = 10,000
 7. 100' x 100' = 10,000
 8. 100' x 100' = 10,000
 9. 100' x 100' = 10,000
 10. 100' x 100' = 10,000
 11. 100' x 100' = 10,000
 12. 100' x 100' = 10,000

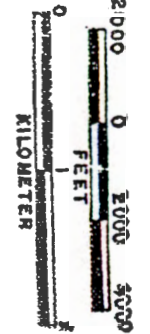

RECEIVED

JAN 08 2003

WATER RESOURCES DEPT.
SALEM, OREGON

29 13

REVISED 1-25-99, RA

SEE MAP 30 13

RECEIVED

JAN 08 2003

WATER RESOURCES DEPT.
SALEM, OREGON

Creek Channel

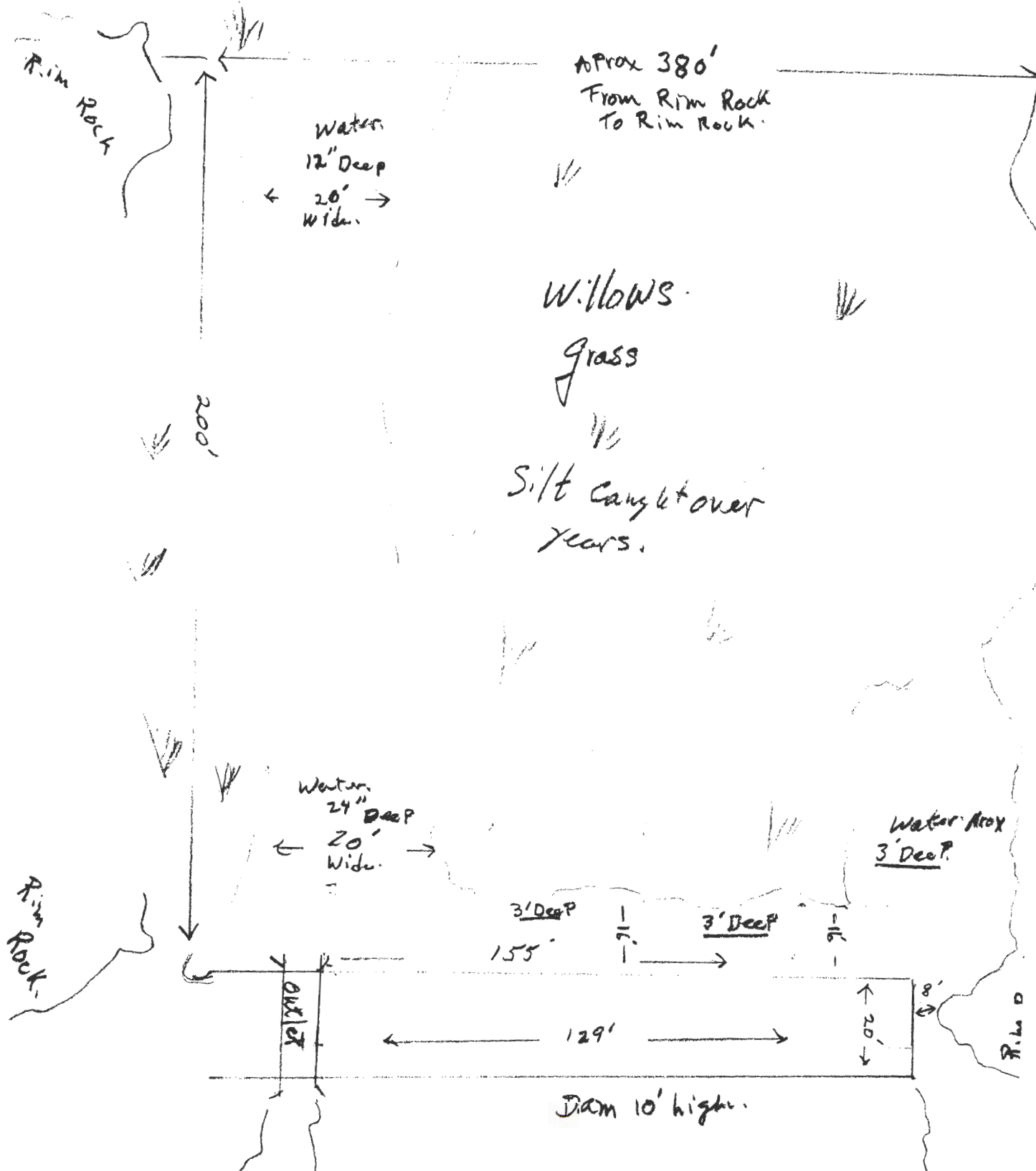

Aprox 380'
From Rim Rock
To Rim Rock.

Water
12" Deep
20' Wide.

Willows.

Grass

Silt caught over
years.

Water
24" Deep
20' Wide.

Water Aprox
3' Deep.

3' Deep
155'
3' Deep
9'

129'

Dam 10' high.

Rim Rock

Rim Rock

R.L.D

1-20'

RECEIVED

JAN 08 2003

WATER RESOURCES DEPT.
SALEM, OREGON

34

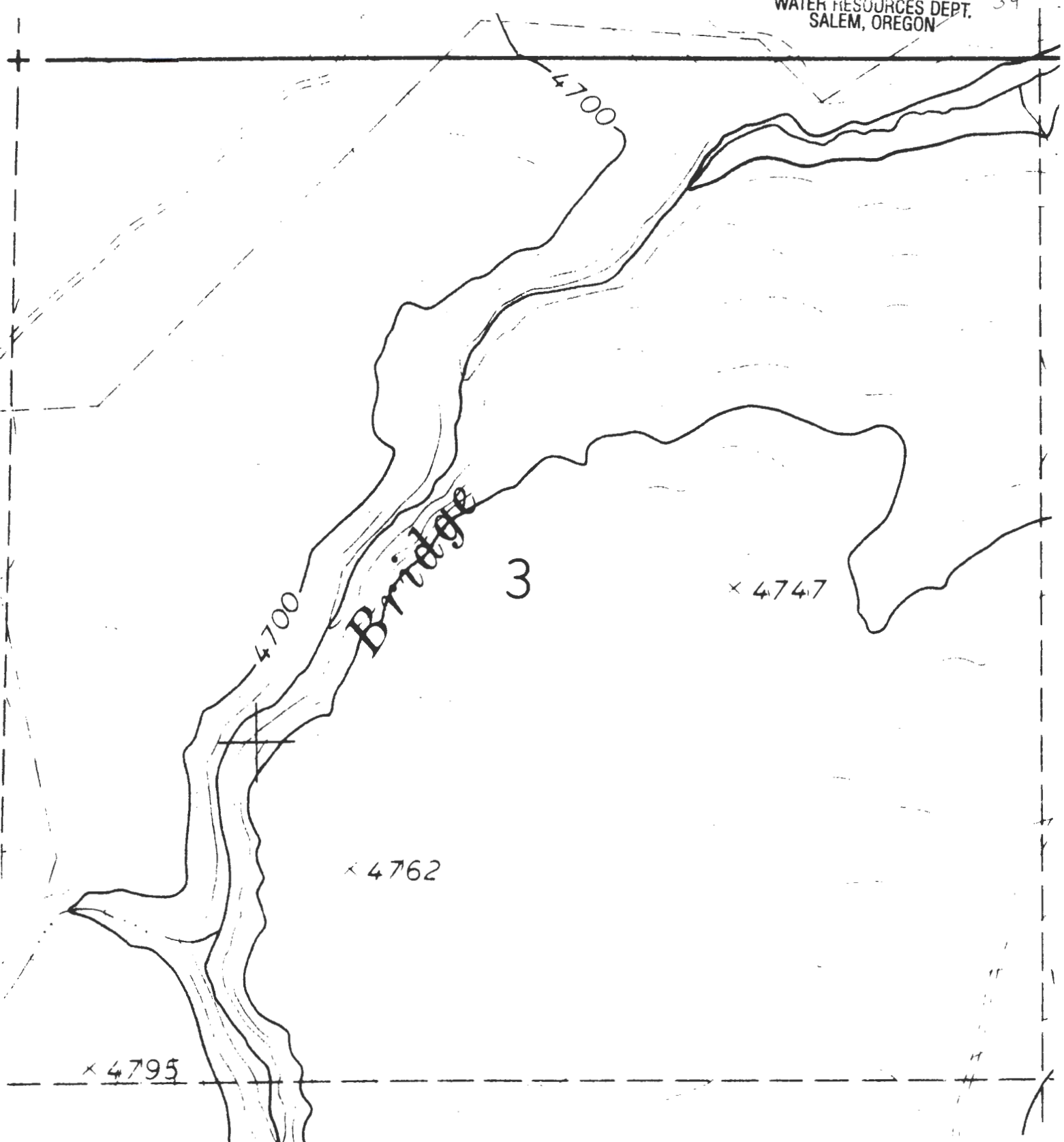

STATE OF OREGON

COUNTY OF LAKE

CERTIFICATE OF WATER RIGHT

This Is to Certify, That JAMES H. OR LORRAINE D. SPHAR

of Silver Lake, State of Oregon, 97638, has made proof to the satisfaction of the Water Resources Director, of a right to the use of the waters of Bridge Creek

a tributary of Silver Creek for the purpose of irrigation of 14.5 acres

under Permit No. 36203 and that said right to the use of said waters has been perfected in accordance with the laws of Oregon; that the priority of the right hereby confirmed dates from May 7, 1971

that the amount of water to which such right is entitled and hereby confirmed, for the purposes aforesaid, is limited to an amount actually beneficially used for said purposes, and shall not exceed 0.18 cubic foot per second

or its equivalent in case of rotation, measured at the point of diversion from the stream. The point of diversion is located in the Lot 2 (NW 1/4 NE 1/4), Section 3, T. 29 S., R. 13 E., W. M., 590 feet South and 1750 feet West from the NE Corner, Section 3

The amount of water used for irrigation, together with the amount secured under any other right existing for the same lands, shall be limited to one-eightieth of one cubic foot per second per acre, or its equivalent for each acre irrigated and shall be further limited to a diversion of not to exceed 3 acre feet per acre for each acre irrigated during the irrigation season of each year,

and shall conform to such reasonable rotation system as may be ordered by the proper state officer.

A description of the place of use under the right hereby confirmed, and to which such right is appurtenant, is as follows:

- 5.2 acres NE 1/4 SW 1/4
- 2.6 acres SW 1/4 SW 1/4
- 2.0 acres SE 1/4 SW 1/4
- Section 35
- T. 28 S., R. 13 E., W. M.
- 0.7 acre Lot 4 (NW 1/4 NW 1/4)
- Section 2
- 4.0 acres Lot 1 (NE 1/4 NE 1/4)
- Section 3
- T. 29 S., R. 13 E., W. M.

RECEIVED APR 01 2003 WATER RESOURCES DEPT. SALEM, OREGON

The right to the use of the water for the purposes aforesaid is restricted to the lands or place of use herein described. and is subject to the existing minimum flow policies established by the Water Policy Review Board.

WITNESS the signature of the Water Resources Director, affixed

this date. June 17, 1977

James E. Sexson Water Resources Director

Do Not Send to Salem. A.D.

RECEIVED

JAN 08 2003

WATER RESOURCES DEPT. SALEM, OREGON

app # R-85522

Based on information received, the use of live flow for filling (one time) the alternate reservoir:

- water availability: YEAR-ROUND
- other restrictions: YEAR-ROUND

Will be limited to: _____

Application for a Permit to Store Water

Alternate Review Process (ORS 537.409)

You may use this form for any reservoir storing less than 9.2 acre-feet or with a dam less than 10 feet high.

Use a separate form for each reservoir

Please type or print in dark ink. If your application is found to be incomplete or inaccurate, we will return it to you. If any requested information does not apply, insert "n/a"

1. APPLICANT INFORMATION

Landowner: Steve J. SPAR
First Last

RECEIVED
APR 01 2003

Authorizing Agent: _____

WATER RESOURCES DEPT.
SALEM, OREGON

Mailing Address: P.O. Box 182

Silver Lake Ore. 97638
City State Zip

Phone: 541-576-#3048 Home
Work Other

*Fax: _____ *E-Mail Address: _____

*Optional Information

2. LOCATION AND SOURCE

A. Reservoir Name: _____

B. Source: Provide the name of the water body or other source from which water will be diverted, and the name of the stream or lake it flows into. Indicate if source is run-off, seepage, or an unnamed stream or spring.

Source: Bridge Creek Tributary to: Silver ~~Lake~~ Creek

C. Reservoir Location

Township (N or S)	Range (E or W)	Section	quarter/quarter	tax lot number
<u>28-29-S</u>	<u>13 E</u>	<u>3</u>	<u>NW-NE</u>	<u>Acc# 18339</u> <u>lots 1, 2, 3, 4</u>

D. County of use: LAKE

E. Dam: Maximum height of dam: 9.0 feet. If excavated, write "excavated" or "0 feet".

F. Quantity: Amount of water to be stored in the reservoir at maximum capacity. List quantity in Acre-Feet: 9.0 Acre Ft.

app # R-85582

change to 9.0 ft.

RECEIVED

JAN 08 2003

WATER RESOURCES DEPT.
SALEM, OREGON

App. No. _____	For Department Use	Date _____
Permit No. _____		

3. WATER USE

Indicate the proposed use(s) of the stored water. **NOTE: You may wish to consider filing for "Multipurpose use" for your reservoir. Multipurpose use does not limit the types of future uses for the stored water. Multipurpose covers all uses including: stockwater, fish and wildlife, aesthetics, domestic, irrigation, agriculture, fire protection and pollution abatement.** If any use will be out of reservoir use, regardless of the type of storage listed, a secondary application must be filed to appropriate the stored water.

MULTIPURPOSE

4. PROPERTY OWNERSHIP

RECEIVED

APR 01 2003

WATER RESOURCES DEPT.
SALEM, OREGON

Do you own all the land where you propose to divert, transport, and use water?

- Yes (Skip to section 5)
- No Please check the appropriate box below.
 - I have a recorded easement or written authorization permitting access.
 - I do not currently have written authorization or an easement permitting access to lands not under my ownership.

List the names and mailing addresses of all affected landowners*:

* If more than 25 landowners are involved, a list is not required. Alternative notice may be made.

5. ENVIRONMENTAL IMPACT

- A. Channel:** Is the reservoir in stream or off channel ?
- B. Wetland:** Is the project in a wetland? Yes No Don't know
- C. Existing:** Is this an existing reservoir? Yes No If yes, how long has it been in place? 50 years.
- D. Fish Habitat:** Is there fish habitat upstream of the proposed structure? Yes No Don't know. If yes, how much? _____ miles.
- E. Partnerships:** Have you been working with other agencies? Yes No

Indicate agency, staff and phone numbers of those involved. Also indicate any agencies that are cost sharing in this project.

6. SIGNATURE

I attest that all statements made and information provided in this application are true and correct to the best of my knowledge.

Steve J. Spahn
Landowner/Authorized Agent

Nov. 1 - 02
Date

Before you submit your application be sure you have:

- Answered each question completely.
- Included a legible map which includes Township, Range, Section, quarter-quarter and tax lot number. The map must meet map requirements to be accepted.
- Included a land use form or receipt stub signed by a local planning official.
- Included a check payable to Oregon Water Resources Department for the appropriate amount.

FEE STRUCTURE: The fee is based on the number of acre-feet proposed to be stored. The fee is \$10 per Acre-Foot. Example: 0.3 AF = \$3.00; 1.5 AF = \$15.00; 20.0 AF = \$100
Maximum fee is \$100 for any reservoir storing more than 10 Acre-Feet

APP # R 85522

ORS 537.409 ALTERNATE RESERVOIR WORKSHEET

FILE # R- 85522
WM DIST 12
REGION SC
Public Notice Date 4-22-03
WID # 13-31300514

Land Use complete? Y / N / NA

Appropriate Fees (\$10 per af w/ max of \$100) Y / N

Secondary app necessary? Y N Secondary file number S Will Need Y/N

Is stream **withdrawn**? Y N

SWW NO In (may not be allowed) Out or Above

5/15/03

Mail forms to appropriate Interagency Review Team members on _____.

ODFW Contact: Curtis Edwards
DEQ Contact: NA- Per Deck Nichols
Watermaster: David POE

If in Umatilla: Confederated Tribes of the Umatilla Indian Reservation, PO Box 638, Pendleton, Oregon 97801

Measurement

Water available:	JAN	FEB	MAR	APR	MAY	JUN	JUL	AUG	SEP	OCT	NOV	DEC
Allowed season	JAN	FEB	MAR	APR	MAY	JUN	JUL	AUG	SEP	OCT	NOV	DEC

conditions Small (≤ 9.2 af) | Medium (> 9.2 , but < 100 af) | Large (≥ 100 af)

PISPC

Assign permit number. R- 13665.

Save in S:\GROUPS\WR\FO\WEEK 381.

Remarks: _____
Peer Review
AK

Completed by Gainey Date 7/2/03

Curtis EDWARDS

ODFW ALTERNATE RESERVOIR APPLICATION REVIEW SHEET

Recommendations for Water Right Applications under the Alternate Reservoir review process (ORS 537.409)

In lieu of the water right application process set forth in ORS 537.140 to 537.211, an owner of a reservoir may submit an alternate reservoir application for a reservoir that has a storage capacity less than 9.2 acre-feet or a dam or impoundment structure less than 10 feet in height. ORS 537.409 describes the criteria used to evaluate alternate reservoir applications.

The review shall be limited to issues pertaining to: a) water availability, b) potential detrimental impact to existing fishery resources; and c) potential injury to existing water rights. (ORS 537.409 (6))

Within 60 days after the department provides public notice...any person may submit detailed, legally obtained information in writing, requesting the department to deny the application for a permit on the basis that the reservoir: (a) Would result in injury to an existing water right; or (b) Would pose a significant detrimental impact to existing fishery resources. (ORS 537.409 (5))

The review of alternate reservoirs is limited to these criteria only.

Date: 5/15/03 30 day Deadline Date: 6/13/03

R-85522

STEVE J SPHAR
PO BOX 182
SILVER LAKE OR 97638

1) Does the proposed reservoir have the potential to injure existing water rights? NO / YES / DON'T KNOW
Explain: An instream application is in the works to Forest Service boundary. I am not sure what happens below this.

2) Would the proposed reservoir pose a significant detrimental impact to an existing fishery resource? NO / YES
Explain: (For example, list STE species or other existing fishery resources that would be negatively impacted.)
Great Basin Redhead Trout movement up and downstream.

Please check either of the boxes below if appropriate:

Any diversion into storage during the period _____ through _____ poses a significant detrimental impact to existing fishery resources.

This proposed pond or reservoir contemplates impounding water in the Columbia Basin above Bonneville Dam. ODFW has determined that additional diversions of water in this area poses a significant detrimental impact to existing fishery resources during the period April 15 through September 30.

3) Can conditions be applied to mitigate the detrimental impact to an existing fishery resource? NO / YES
If YES, which conditions are recommended: (select from the Menu of Conditions listed on back)
Pispic - this is an existing situation that needs to be cleaned up. A cooperative screen and ladder will resolve any problems.

4) Did you meet with staff from another agency to discuss this application? NO / YES
Who: David Poe Agency: WRD Date: _____
Who: _____ Agency: _____ Date: _____

ODFW RECOMMENDATION:

- Approval with fishery conditions
- Approval without fishery conditions
- Denial. (Based on significant detrimental impact to existing fishery resource or injury to existing water right.)

ODFW Representative: Name: Curtis Edwards Date: 6/10/03

WRD Contact: Caseworker: Jerry Gainey, Water Rights Division

503-378-8455 ext: 458 / Fax: 503-378-6203 / e-mail: Jerry.W.Gainey@wrdd.state.or.us

WATERMASTER ALTERNATE RESERVOIR APPLICATION REVIEW SHEET

Recommendations for Water Right Applications under the Alternate Reservoir review process (ORS 537.409)

Dave Poe

In lieu of the water right application process set forth in ORS 537.140 to 537.211, an owner of a reservoir may submit an alternate reservoir application for a reservoir that has a storage capacity less than 9.2 acre-feet or a dam or impoundment structure less than 10 feet in height. ORS 537.409 describes the criteria used to evaluate alternate reservoir applications.

The review shall be limited to issues pertaining to: a) water availability, b) potential detrimental impact to existing fishery resources; and c) potential injury to existing water rights. (ORS 537.409 (6))

Within 60 days after the department provides public notice...any person may submit detailed, legally obtained information in writing, requesting the department to deny the application for a permit on the basis that the reservoir: (a) Would result in injury to an existing water right; or (b) Would pose a significant detrimental impact to existing fishery resources. (ORS 537.409 (5))

The review of alternate reservoirs is limited to these criteria only.

Date: 5/15/03 30 day Deadline Date: 6/13/03

R-85522
STEVE J SPHAR
PO BOX 182
SILVER LAKE OR 97638

1) Does the proposed reservoir have the potential to injure existing water rights?

NO YES

Explain: _____

2) Can conditions be applied to mitigate the potential injury to existing water rights?

NO YES

If YES, which conditions are recommended:

3) Did you meet with staff from another agency to discuss this application?

NO / YES

Who: Curtis Edwards Agency: ODFW Date: 05/06/03
Who: _____ Agency: _____ Date: _____

WATERMASTER RECOMMENDATION:

- Approval with conditions
- Approval without conditions
- Denial. (Based on significant detrimental impact to existing fishery resource or injury to existing water right.)

RECEIVED

MAY 21 2003

WATER RESOURCES DEPT.
SALEM, OREGON

Watermaster: Name: *[Signature]* Date: 05/20/03

WRD Contact: Caseworker: Jerry Gainey, Water Rights Division

503-378-8455 ext: 458 / Fax: 503-378-6203 / e-mail: Jerry.W.Gainey@wrdd.state.or.us

MENU OF CONDITIONS FOR WRD, ODFW, DEQ AND AG
(Developed 6/27/97 - revised 2/26/02)

- fish** The permittee shall install, maintain, and operate fish screening and by-pass devices as required by the Oregon Department of Fish and Wildlife to prevent fish from entering the proposed diversion. The required screen is to be in place and functional prior to diversion of any water.
- odfw** The permittee shall install, maintain, and operate fish screening and by-pass devices as required by the Oregon Department of Fish and Wildlife to prevent fish from entering the proposed diversion. The required screens and by-pass devices are to be in place, functional and approved by an ODFW representative prior to diversion of any water.
- B54b** The permittee shall install, maintain, and operate fish screening to prevent fish from entering the proposed diversion. The permittee shall also install a fishway at the obstruction that will provide adequate upstream and downstream passage for fish. The permittee may submit evidence that the Oregon Department of Fish and Wildlife (ODFW) has determined screens and/or fishways are not necessary. The required screens and fishways are to be in place, functional, and approved by ODFW before diversion of any water.
- b54c** The permittee shall not construct, operate or maintain any dam or artificial obstruction to fish passage in the channel of the subject stream without providing a fishway to ensure adequate upstream and downstream passage for fish. The applicant is hereby directed to contact an Oregon Department of Fish and Wildlife Fish Passage Coordinator, Portland, Oregon, before beginning construction of any in-channel obstruction.
- b54m** The permittee may be required in the future to install, maintain, and operate fish screening devices to prevent fish from entering the proposed diversion.
- b52** Water may be diverted only when Department of Environmental Quality sediment standards are being met.
- b5** The water user shall install and maintain adequate treatment facilities meeting current DEQ requirements to remove sediment before returning the water to the stream.
- b51a** The period of use has been limited to _____ through _____.
- b57** Before water use may begin under this permit, a totalizing flow meter must be installed at each diversion point. The totalizing flow meter must be installed and maintained as identified in OAR 690-507-645.
- b58** Before water use may begin under this permit, a staff gage that measures the entire range and stage between full reservoir level dead pool storage must be installed in the reservoir. The staff gage shall be United States Geological Survey style porcelain enamel iron staff gage style A, C, E or I. Additionally, before water use may begin under this permit, if the reservoir is located in channel then weirs or other suitable measuring devices must be installed upstream and downstream of the reservoir, and, a gated valve outlet must be installed. A written waiver may be obtained from the local Watermaster if in his judgement the installation of the weir(s) will provide no public benefit.
- no id yet** (futile call) The use of water allowed herein may be made only at times when waters from the (SPRING OR WHATEVER) would not otherwise flow into a tributary of the (WHATEVER) River or sufficient water is available to satisfy all prior rights, including rights for maintaining instream flows.
- 4a** This use of water shall be limited when it reduces the flow of water in (NAME OF STREAM).(name of stream).
- plspc** If the riparian area is disturbed in the process of developing a point of diversion, the permittee shall be responsible for restoration and enhancement of such riparian area.
- The use may be restricted if the quality of the source stream or downstream waters decrease to the point that those waters no longer meet existing state or federal water quality standards due to reduced flows.
- The permittee shall install, maintain, and operate fish screening to prevent fish from entering the proposed diversion. The permittee shall also install a fishway at the obstruction that will provide adequate upstream and downstream passage for fish. The permittee may submit evidence that the Oregon Department of Fish and Wildlife (ODFW) has determined screens and/or fishways are not necessary. The required screens and fishways are to be in place, functional, and approved by ODFW before diversion of any water.
- no id yet** The stream and its adjacent riparian area shall be fenced to exclude livestock.
- blv** Water must be diverted to a trough or tank through an enclosed water delivery system. The delivery system must be equipped with an automatic shutoff or limiting flow control mechanism or include a means for returning water to the stream source through an enclosed delivery system. The use of water shall not exceed 0.10 cubic feet per second per 1000 head of livestock.

WATER AVAILABILITY TABLE

Water Availability as of 4/17/2003 for
BRIDGE CR > ISLAND BR SILVER CR - AT MARSH

Watershed ID #: 31300514 Basin: GOOSE AND SUMMER LAKE Exceedance Level: 50
Time: 15:19 Date: 04/17/2003

Select an Item Number for More Details

Item #	Watershed ID #	Jan	Feb	Mar	Apr	May	Jun	Jul	Aug	Sep	Oct	Nov	Dec	Sto
1	31300514	YES	YES	YES	YES	YES	YES	YES	YES	YES	YES	YES	YES	YES

STREAM NAMES

BRIDGE CR > ISLAND BR SILVER CR - AT MARSH

Watershed ID #: 31300514 Basin: GOOSE AND SUMMER LAKE Exceedance Level: 50
Time: 15:19 Date: 04/17/2003

Item Watershed ID Stream Name

1	31300514	BRIDGE CR > ISLAND BR SILVER CR - AT MARSH
---	----------	--

LIMITING WATERSHEDS

BRIDGE CR > ISLAND BR SILVER CR - AT MARSH

Watershed ID #: 31300514 Basin: GOOSE AND SUMMER LAKE Exceedance Level: 50
Time: 15:19 Date: 04/17/2003

Mnth	Limiting Watershed	Stream Name	Water Avail?	Net Water Available
1	31300514	BRIDGE CR > ISLAND BR SILVER CR - AT MARSH	YES	2.0
2	31300514	BRIDGE CR > ISLAND BR SILVER CR - AT MARSH	YES	2.4
3	31300514	BRIDGE CR > ISLAND BR SILVER CR - AT MARSH	YES	4.1
4	31300514	BRIDGE CR > ISLAND BR SILVER CR - AT MARSH	YES	6.6
5	31300514	BRIDGE CR > ISLAND BR SILVER CR - AT MARSH	YES	18.9
6	31300514	BRIDGE CR > ISLAND BR SILVER CR - AT MARSH	YES	17.9
7	31300514	BRIDGE CR > ISLAND BR SILVER CR - AT MARSH	YES	4.3
8	31300514	BRIDGE CR > ISLAND BR SILVER CR - AT MARSH	YES	1.4
9	31300514	BRIDGE CR > ISLAND BR SILVER CR - AT MARSH	YES	1.1
10	31300514	BRIDGE CR > ISLAND BR SILVER CR - AT MARSH	YES	1.6
11	31300514	BRIDGE CR > ISLAND BR SILVER CR - AT MARSH	YES	1.7
12	31300514	BRIDGE CR > ISLAND BR SILVER CR - AT MARSH	YES	1.5
Stor	31300514	BRIDGE CR > ISLAND BR SILVER CR - AT MARSH	YES	3830.0

Analysis for Application: R85522

Location: 28S-13E-35-NESW

Uses: MP P

Basins

BASIN_NUM	BASIN_NAME
13	Goose & Summer Lakes

Records Found: 1

WaterMaster Districts

WATERDIST	REGION	ACRES	SQ_MILES	WMASTER	ADDRESS	CITY	ZIP	PHONE	EXT	F
12	SC	5099367	7967	Vacant	513 Center St	Lakeview	97630	541-947-6038		5

Records Found: 1

WAB

BASIN	WID	LINK1	LINK2
13	31300514	Water Availability: 50% 80%	Flood Frequency Analysis

Records Found: 1

County

COUNTY	FIPS
Lake	41037

Records Found: 1

Groundwater Restricted

NAME1	NAME2	SUB_AREA	STATUS	SQ_MI
FORT ROCK			CLAS	2163.26

Records Found: 1

Divison 33 Area

DIV33
In a Div33 area

Records Found: 1

Rule 4D Records Found: 0

303D Streams Records Found: 0

303D Lakes Records Found: 0

Location: 28S-13E-35-NWSW

Uses: MP P

Basins

BASIN_NUM	BASIN_NAME
13	Goose & Summer Lakes

Records Found: 1

WaterMaster Districts

WATERDIST	REGION	ACRES	SQ_MILES	WMASTER	ADDRESS	CITY	ZIP	PHONE	EXT	F
12	SC	5099367	7967	Vacant	513 Center St	Lakeview	97630	541-947-6038		5

Records Found: 1

WAB

BASIN	WID	LINK1	LINK2
13	31300514	Water Availability: 50% 80%	Flood Frequency Analysis

Records Found: 1

County

COUNTY	FIPS
Lake	41037

Records Found: 1

Groundwater Restricted

NAME1	NAME2	SUB_AREA	STATUS	SQ_MI
FORT ROCK			CLAS	2163.26

Records Found: 1

Divison 33 Area

DIV33
In a Div33 area

Records Found: 1

Rule 4D Records Found: 0

303D Streams Records Found: 0

303D Lakes Records Found: 0

Location: 28S-13E-35-SESW

Uses: MP P

Basins

BASIN_NUM	BASIN_NAME
13	Goose & Summer Lakes

Records Found: 1

WaterMaster Districts

WATERDIST	REGION	ACRES	SQ_MILES	WMASTER	ADDRESS	CITY	ZIP	PHONE	EXT	F
12	SC	5099367	7967	Vacant	513 Center St	Lakeview	97630	541-947-6038		5

Records Found: 1

WAB

BASIN	WID	LINK1	LINK2
13	31300514	Water Availability: 50% 80%	Flood Frequency Analysis

Records Found: 1

County

COUNTY	FIPS
Lake	41037

Records Found: 1

Groundwater Restricted

NAME1	NAME2	SUB_AREA	STATUS	SQ_MI
FORT ROCK			CLAS	2163.26

Records Found: 1

Divison 33 Area

DIV33
In a Div33 area

Records Found: 1

Rule 4D Records Found: 0

303D Streams Records Found: 0

303D Lakes Records Found: 0

Location: 28S-13E-35-SWSW

Uses: MP P

Basins

BASIN_NUM	BASIN_NAME
13	Goose & Summer Lakes

Records Found: 1

WaterMaster Districts

WATERDIST	REGION	ACRES	SQ_MILES	WMASTER	ADDRESS	CITY	ZIP	PHONE	EXT	F
12	SC	5099367	7967	Vacant	513 Center St	Lakeview	97630	541-947-6038		5

Records Found: 1

WAB

BASIN	WID	LINK1	LINK2
13	31300514	Water Availability: 50% 80%	Flood Frequency Analysis

Records Found: 1

County

COUNTY	FIPS
Lake	41037

Records Found: 1

Groundwater Restricted

NAME1	NAME2	SUB_AREA	STATUS	SQ_MI
FORT ROCK			CLAS	2163.26

Records Found: 1

Divison 33 Area

DIV33
In a Div33 area

Records Found: 1

Rule 4D Records Found: 0

303D Streams Records Found: 0

303D Lakes Records Found: 0

Location: 29S-13E-2-NWNW

Uses: MP P

Basins

BASIN_NUM	BASIN_NAME
13	Goose & Summer Lakes

Records Found: 1

WaterMaster Districts

WATERDIST	REGION	ACRES	SQ_MILES	WMASTER	ADDRESS	CITY	ZIP	PHONE	EXT	F
12	SC	5099367	7967	Vacant	513 Center St	Lakeview	97630	541-947-6038		5

Records Found: 1

WAB

BASIN	WID	LINK1	LINK2
13	31300514	Water Availability: 50% 80%	Flood Frequency Analysis

Records Found: 1

County

COUNTY	FIPS
Lake	41037

Records Found: 1

Groundwater Restricted

NAME1	NAME2	SUB_AREA	STATUS	SQ_MI
FORT ROCK			CLAS	2163.26

Records Found: 1

Divison 33 Area

DIV33
In a Div33 area

Records Found: 1

Rule 4D Records Found: 0

303D Streams Records Found: 0

303D Lakes Records Found: 0

Location: 29S-13E-3-NENE

Uses: MP P

Basins

BASIN_NUM	BASIN_NAME
13	Goose & Summer Lakes

Records Found: 1

WaterMaster Districts

WATERDIST	REGION	ACRES	SQ_MILES	WMASTER	ADDRESS	CITY	ZIP	PHONE	EXT	F
12	SC	5099367	7967	Vacant	513 Center St	Lakeview	97630	541-947-6038		54

Records Found: 1

WAB

BASIN	WID	LINK1	LINK2
13	31300514	Water Availability: 50% 80%	Flood Frequency Analysis

Records Found: 1

County

COUNTY	FIPS
Lake	41037

Records Found: 1

Groundwater Restricted

NAME1	NAME2	SUB_AREA	STATUS	SQ_MI
FORT ROCK			CLAS	2163.26

Records Found: 1

Divison 33 Area

DIV33
In a Div33 area

Records Found: 1

Rule 4D Records Found: 0

303D Streams Records Found: 0

303D Lakes Records Found: 0

Location: 29S-13E-3-NWNE

Uses: MP P

Basins

BASIN_NUM	BASIN_NAME
13	Goose & Summer Lakes

Records Found: 1

WaterMaster Districts

WATERDIST	REGION	ACRES	SQ_MILES	WMASTER	ADDRESS	CITY	ZIP	PHONE	EXT	F
12	SC	5099367	7967	Vacant	513 Center St	Lakeview	97630	541-947-6038		5

Records Found: 1

WAB

BASIN	WID	LINK1	LINK2
13	31300514	Water Availability: 50% 80%	Flood Frequency Analysis

Records Found: 1

County

COUNTY	FIPS
Lake	41037

Records Found: 1

Groundwater Restricted

NAME1	NAME2	SUB_AREA	STATUS	SQ_MI
FORT ROCK			CLAS	2163.26

Records Found: 1

Divison 33 Area

DIV33
In a Div33 area

Records Found: 1

Rule 4D Records Found: 0

303D Streams Records Found: 0

303D Lakes Records Found: 0

Mailing List for FO Copies

Application #R-85522

Print Date : July 3, 2003

Original mailed to Applicant WITH CLAIM OF BENEFICIAL USE FORM:
STEVE SPHAR, PO BOX 182, SILVER LAKE, OR 97638

NOTE TO SUPPORT: Please include a Claim of Beneficial Use form with the permit to the applicant.

Copies sent to:

1. WRD - File # R-85522
2. WRD - Water Availability: Ken Stahr (WAB= 13-31300514)



FO, Map, and Fact Sheet Copies sent to:

3. WRD - Data Center
4. WRD - Watermaster #12

Copies sent to Other Interested Persons (*CWRE, Agent, Commenter, etc.*)

5. _____

"\$10 LETTER" sent to Interested Persons who have not protested or paid for copies

1. _____

2. _____

3. _____

CASEWORKER : gaineyjw

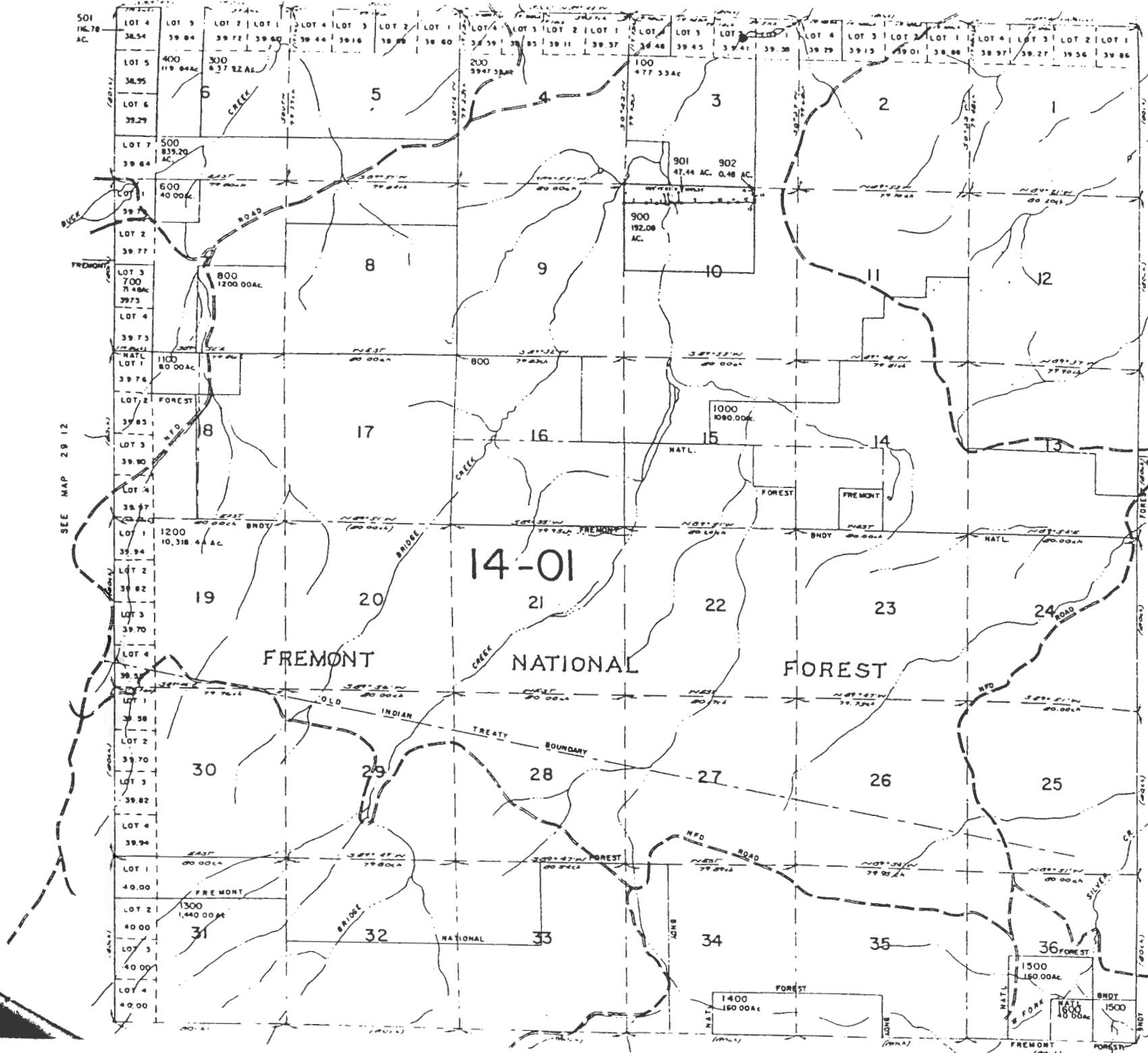

29 13
 - Pod
 - RESERVOIR
 LAKE

PARCEL 901

1.	387' x 174'	66,438
2.	387' x 174'	66,438
3.	387' x 174'	66,438
4.	387' x 174'	66,438
5.	387' x 174'	66,438
6.	387' x 174'	66,438
7.	387' x 174'	66,438
8.	387' x 174'	66,438
9.	387' x 174'	66,438
10.	387' x 174'	66,438
11.	387' x 174'	66,438
12.	387' x 174'	66,438
13.	387' x 174'	66,438
14.	387' x 174'	66,438
15.	387' x 174'	66,438
16.	387' x 174'	66,438
17.	387' x 174'	66,438
18.	387' x 174'	66,438
19.	387' x 174'	66,438
20.	387' x 174'	66,438
21.	387' x 174'	66,438
22.	387' x 174'	66,438
23.	387' x 174'	66,438
24.	387' x 174'	66,438
25.	387' x 174'	66,438
26.	387' x 174'	66,438
27.	387' x 174'	66,438
28.	387' x 174'	66,438
29.	387' x 174'	66,438
30.	387' x 174'	66,438
31.	387' x 174'	66,438
32.	387' x 174'	66,438
33.	387' x 174'	66,438
34.	387' x 174'	66,438
35.	387' x 174'	66,438
36.	387' x 174'	66,438

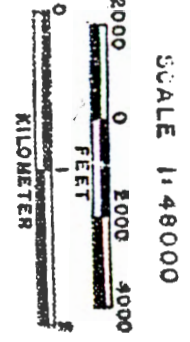

SEE MAP 29 12

app # R-85522
 Permit #

RECEIVED
 APR 01 2003

WATER RESOURCES DEPT.
 SALEM, OREGON

RECEIVED

JAN 08 2003
 WATER RESOURCES DEPT.
 SALEM, OREGON

RECEIVED

JAN 08 2003

WATER RESOURCES DEPT.
SALEM, OREGON

RECEIVED

APR 01 2003

WATER RESOURCES DEPT.
SALEM, OREGON

Creek Channel

Approx 380'
From Rim Rock
To Rim Rock.

Water
12" Deep
20' Wide.

Willows.

Grass

Silt caught over
years.

app # R-8558
Permit #

200'

Water
24" Deep
20' Wide.

Water Approx
3' Deep

3' Deep

3' Deep

155'

129'

Dam 10' high.

Rim Rock

Rim R...

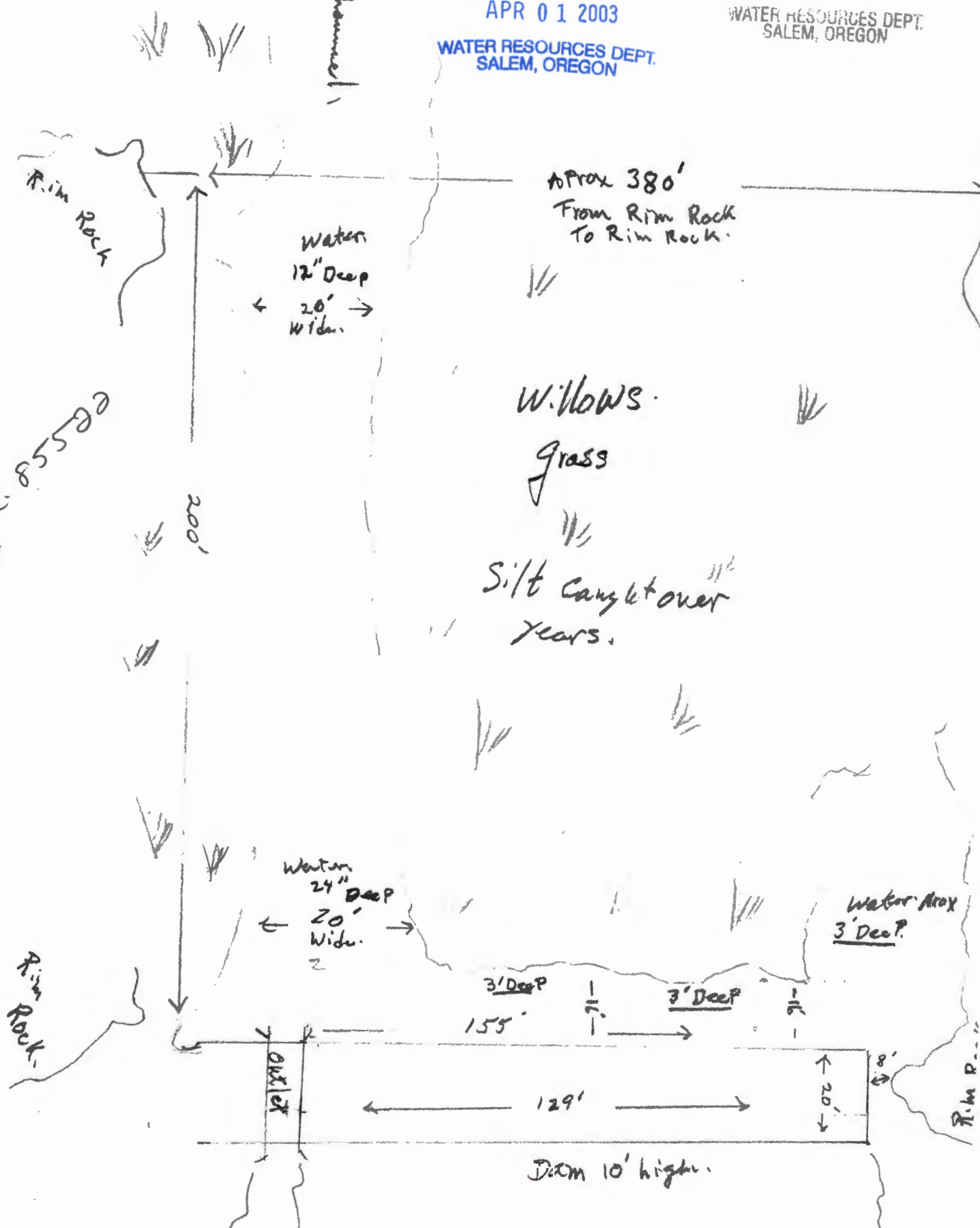

RECEIVED

APR 01 2003

WATER RESOURCES DEPT.
SALEM, OREGON

Water Resources Department
Commerce Building
158 12th St. NE
Salem Ore 97301-4172

Dear Mr. Wright,

I am very sorry about
this not getting to you sooner.

I did mail this off in Feb
but apparently it did not get
to you.

I am glad that I photo copied
all the forms for my records.

The water master informed
us that you didn't get this
permit. I was not very happy
to see us using the water.
Our water rights allow us to
use flood water. Apparently
there is some confusion about
when the level of the banks
are considered ~~the~~ flood level.

app # 85522

RECEIVED

APR 01 2003

WATER RESOURCES DEPT.
SALEM, OREGON

Please if you could help us with, how can we exactly know what the rules and regulations are that we are to follow. beside what Mr Poe the water master dictates to use Steve will call you as soon as I get my return receipt on this permit.

Thank you
Steve & Cathie Spher
541-576-3548

P.S. Please note the change on height of dam

RECEIVED

APR 01 2003

WATER RESOURCES DEPT.
SALEM, OREGON

For Local Government Use Only

The following section must be completed by a planning official from each county and city listed unless your project will be located entirely within the city limits. In this case, only the city planning agency must complete this form. Please request additional forms as needed or feel free to copy.

A. Allowed Use

Check the appropriate box below and provide requested information.

- Land uses to be served by proposed water uses (including proposed construction) are allowed outright or are not regulated by your comprehensive plan. Cite applicable ordinance section(s); 2.01A. Go to section B "Approval" below
- Land uses to be served by proposed water uses (including proposed construction) involve discretionary land use approvals as listed in the table below.

Type of Land Use Approval Needed (e.g. plan amendments, rezones, conditional use permits, etc.)	Cite Most Significant, Applicable Plan Policies & Ordinance Section References	Check the item that applies: Land Use Approval:	
		<input type="checkbox"/> Obtained <input type="checkbox"/> Denied	<input type="checkbox"/> Being pursued <input type="checkbox"/> Not being pursued
		<input type="checkbox"/> Obtained <input type="checkbox"/> Denied	<input type="checkbox"/> Being pursued <input type="checkbox"/> Not being pursued
		<input type="checkbox"/> Obtained <input type="checkbox"/> Denied	<input type="checkbox"/> Being pursued <input type="checkbox"/> Not being pursued
		<input type="checkbox"/> Obtained <input type="checkbox"/> Denied	<input type="checkbox"/> Being pursued <input type="checkbox"/> Not being pursued

Note: Please attach documentation of applicable local land use approvals which have already been obtained. (Record of Action plus accompanying findings is sufficient.)

B. Approval

Please provide printed name and written signature.

Name: Ray Simms Date: 1-31-03
 Title: Director Phone: 541-947-6032
 Signature: Ray Simms

C. Additional Comments

Local governments are invited to express special land use concerns or make recommendations to the Department regarding this proposed use of water below, or on a separate sheet.

Note: If this form cannot be completed while the applicant waits, sign and detach the receipt stub as instructed below. You will have 30 days from the Water Resources Department's notice date to return the completed Land Use Information Form or WRD will presume the land use associated with the proposed water right is compatible with local comprehensive plans. (See attached letter.)

Receipt for Request for Land Use Information

Name of water right applicant: _____

This receipt must be signed by a local government representative and returned to the applicant at the time they present this form. This receipt must be included in the application for a water right permit if the local government cannot provide the requested land use information while the applicant waits.

City or County: _____

Staff contact: _____ Phone: _____

Signature: _____ Date: _____

app # R-85522

RECEIVED

APR 01 2003

WATER RESOURCES DEPT.
SALEM, OREGON



Oregon Water Resources Department Land Use Information Form

This information is needed to determine compatibility with local comprehensive plans as required by ORS 197.180. The Water Resources Department will use this and other information to evaluate the water use application. DO NOT fill out this form if water is to be diverted, conveyed, or used only on federal lands.

To Be Completed By Applicant

The following section includes information about proposed water use. This section must be completed by the individual or group that is filing an application for a water right with the Water Resources Department.

A. Applicant

Name: Steve J. Sphar
 Address: PO Box 182
 City: Silverlake State: OR Zip: 97638 Day Phone: 541-576-3048

B. Land and Location

Please provide information as requested below for all tax lots on or through which water will be diverted, conveyed, or used. Check "diverted" if water is diverted (taken) from its source on tax lot, "conveyed" if water is conveyed (transported) on tax lot, and "used" if water will be put to beneficial use on tax lot. More than one box may be checked. (Attach extra sheets as necessary.) Applicants for municipal use, or irrigation uses within irrigation districts, may substitute existing and proposed service area boundaries for the tax lot information requested below.

Tax Lot I.D.	Plan Designation (e.g. Rural Residential/RR-5)	Water to be: (check all that apply)		
<u>Acres 1.234</u> <u>lots 1,2,3,4</u>	<u>RR5</u>	<input type="checkbox"/> Diverted	<input type="checkbox"/> Conveyed	<input checked="" type="checkbox"/> Used
		<input type="checkbox"/> Diverted	<input type="checkbox"/> Conveyed	<input type="checkbox"/> Used
		<input type="checkbox"/> Diverted	<input type="checkbox"/> Conveyed	<input type="checkbox"/> Used

List counties and cities where water is proposed to be diverted, conveyed, or used. Lake County

C. Description of Water Use

Indicate what the water will be used for. Include the beneficial use (found in the instruction booklet for your water right application) and use the space below to describe the key characteristics of the project.

Beneficial Use(s): Improve the land
 Briefly describe: Water will be used to keep existing meadows growing and water for grazing livestock

D. Source

Indicate the source for the proposed water use:

Reservoir/Pond Ground Water Surface Water _____ (source)

E. Quantity

Indicate the estimated quantity of water the use will require:

9.0 CFS GPM Acre-Feet

Receipt for Request for Land Use Information

State of Oregon
 Water Resources Department
 Commerce Bldg.
 158 12th St. NE
 Salem, OR 97310-0210
 (503)378-8455

RECEIVED
 APR 01 2003
 WATER RESOURCES DEPT.
 SALEM, OREGON

**ALTERNATE REVIEW PROCESS
FOR RESERVOIRS STORING LESS THAN 9.2 ACRE-FEET*
OR WITH A DAM LESS THAN 10 FEET HIGH
R-85522**

The alternate Review Process was created so that final order approving or denying a permit to store water is issued approximately 180 days after the application has been accepted by the Department. **This process applies only to the application to store water.**

To apply under the Alternate Review Process the following information must be completed.

- OK Landowner name, mailing address and telephone number.
- OK The source of water to be stored. If the source is to be a well, you cannot apply under the Alternate Review Process.
- OK Reservoir location, by Township, Range and Section, Quarter-quarter section and Tax Lot. You must indicate if the Township is North or South and Range East or West.
- OK Dam height. If an excavated pond, indicate excavated.
- OK Quantity of water to be stored in a single storage period. List the quantity in acre-feet. **One is equal to an area one acre in size, one foot deep. One acre-foot is equal to 325,851 gallons or 43,560 cubic feet.**
- OK The use of the water. Note: if any water is to be pumped or released from the reservoir, a secondary surface water application is required. File the secondary application concurrently with the application to store water.
- OK The Environmental Impact section. Please circle in-stream or off channel on Section 5A.
- OK **Sign the application in ink.**

Only one pond, reservoir or other storage method per application. Multiple ponds on a single property require multiple applications.

- OK **A legible map showing the Township, Range, Section, Quarter-quarter section and Tax lot number with the location of the reservoir indicated must be submitted with the application.**

The map must follow the criteria set forth under OAR 690-310-050. A copy of an assessors plat map is a very good map to use as it shows most all map requirements.

The Department will not accept aerial photos, U.S.G.S. Quad maps or title insurance company maps unless all criteria set forth under OAR 690-310-050 is applied to the map submitted.

Hand drawn maps are acceptable.

OK The map must be drawn in ink. Do not use highlighter pens or multiple colors of ink. If the map is larger than 11"X 17", four copies should be submitted, or it must be drawn on tracing linen, tracing velum or mylar.

OK The North directional symbol must be indicated on the map.

OK The location of each diversion point or dam must be referenced to a recognized public land survey corner; do not measure from property line unless they are part of the public land survey lines. The locations may be shown by distance and bearing or by coordinates (EX: "400 feet south and 350 feet west of the Northeast corner of section 27").

OK The location of the reservoir identified by tax lot, township, range, section and nearest quarter-quarter section. Please show tax lot boundaries.

OK A completed Land-Use Information Form OR signed receipt by the local planning department must also be submitted with the application.

OK The fee for the Alternate Review Process is based upon the quantity of water to be stored. Fees are \$10.00 per acre foot up to a maximum of \$100.00. For example, for a pond storing 4.5 acre-feet, the fee would be \$45.00. If the total storage for a single reservoir is greater than 10 acre-feet, the maximum fee is \$100.00.

For more information about the application process and water rights, please call the Water Rights Information Group at (503)378-8455 extension 201.

*** One acre-foot is equal to an area one acre in size, one foot deep.**

COMPLETED BY: ROGER WRIGHT

DATE: 4/1/03

Based on information received, the use of live flow for filling (one time) the alternate reservoir:

- water availability YEAR-ROUND
- other restrictions: YEAR-ROUND

Will be limited to: YEAR-ROUND

Application for a Permit to Store Water

Alternate Review Process (ORS 537.409)

You may use this form for any reservoir storing less than 9.2 acre-feet or with a dam less than 10 feet high.

Use a separate form for each reservoir

Please type or print in dark ink. If your application is found to be incomplete or inaccurate, we will return it to you. If any requested information does not apply, insert "n/a"

1. APPLICANT INFORMATION

Landowner: Steve J. SPAR
First Last

RECEIVED

APR 01 2003

Authorizing Agent: _____

WATER RESOURCES DEPT.
SALEM, OREGON

Mailing Address: P.O. Box 182

Silver Lake Ore. 97638
City State Zip

Phone: 541-576-3048 Home
Work Other

*Fax: _____ *E-Mail Address: _____

*Optional Information

2. LOCATION AND SOURCE

A. Reservoir Name: _____

B. Source: Provide the name of the water body or other source from which water will be diverted, and the name of the stream or lake it flows into. Indicate if source is run-off, seepage, or an unnamed stream or spring.

Source: Bridge Creek Tributary to: Silver ~~Lake~~ Creek

C. Reservoir Location

Township (N or S)	Range (E or W)	Section	quarter/quarter	tax lot number
<u>28-29-S</u>	<u>13 E</u>	<u>3</u>	<u>NW-NE</u>	<u>ACCT# 18339 lots 1,2,3,4</u>

D. County of use: Lake

E. Dam: Maximum height of dam: 9.0 feet. If excavated, write "excavated" or "0 feet".

F. Quantity: Amount of water to be stored in the reservoir at maximum capacity. List quantity in Acre-Feet: 9.0 Acre Ft.

app # R-85582

change to 9.0 ft.

RECEIVED

IAN 08 2003

WATER RESOURCES DEPT.
SALEM, OREGON

App. No. _____

For Department Use

Permit No. _____

Date _____

3. WATER USE

Indicate the proposed use(s) of the stored water. NOTE: You may wish to consider filing for "Multipurpose use" for your reservoir. Multipurpose use does not limit the types of future uses for the stored water. Multipurpose covers all uses including: stockwater, fish and wildlife, aesthetics, domestic, irrigation, agriculture, fire protection and pollution abatement. If any use will be out of reservoir use, regardless of the type of storage listed, a secondary application must be filed to appropriate the stored water.

MULTIPURPOSE

RECEIVED

APR 01 2003

WATER RESOURCES DEPT.
SALEM, OREGON

4. PROPERTY OWNERSHIP

Do you own all the land where you propose to divert, transport, and use water?

- Yes (Skip to section 5)
- No Please check the appropriate box below.
 - I have a recorded easement or written authorization permitting access.
 - I do not currently have written authorization or an easement permitting access to lands not under my ownership.

List the names and mailing addresses of all affected landowners*:

* If more than 25 landowners are involved, a list is not required. Alternative notice may be made.

5. ENVIRONMENTAL IMPACT

- A. Channel: Is the reservoir in stream or off channel ?
 - B. Wetland: Is the project in a wetland? Yes No Don't know
 - C. Existing: Is this an existing reservoir? Yes No If yes, how long has it been in place? 50 years.
 - D. Fish Habitat: Is there fish habitat upstream of the proposed structure? Yes No Don't know. If yes, how much? _____ miles.
 - E. Partnerships: Have you been working with other agencies? Yes No
- Indicate agency, staff and phone numbers of those involved. Also indicate any agencies that are cost sharing in this project.

6. SIGNATURE

I attest that all statements made and information provided in this application are true and correct to the best of my knowledge.

Steve J. Spina
Landowner/Authorized Agent

Nov. 1 - 02
Date

Before you submit your application be sure you have:

- Answered each question completely.
- Included a legible map which includes Township, Range, Section, quarter-quarter and tax lot number. The map must meet map requirements to be accepted.
- Included a land use form or receipt stub signed by a local planning official.
- Included a check payable to Oregon Water Resources Department for the appropriate amount.

FEE STRUCTURE: The fee is based on the number of acre-feet proposed to be stored. The fee is \$10 per Acre-Foot. Example: 0.3 AF = \$3.00; 1.5 AF = \$15.00; 20.0 AF = \$100 Maximum fee is \$100 for any reservoir storing more than 10 Acre-Feet

app # R 85522



RECEIVED

APR 01 2003

WATER RESOURCES DEPT.
SALEM, OREGON

R13E

RECEIVED

IAN 08 2003

WATER RESOURCES DEPT.
SALEM, OREGON

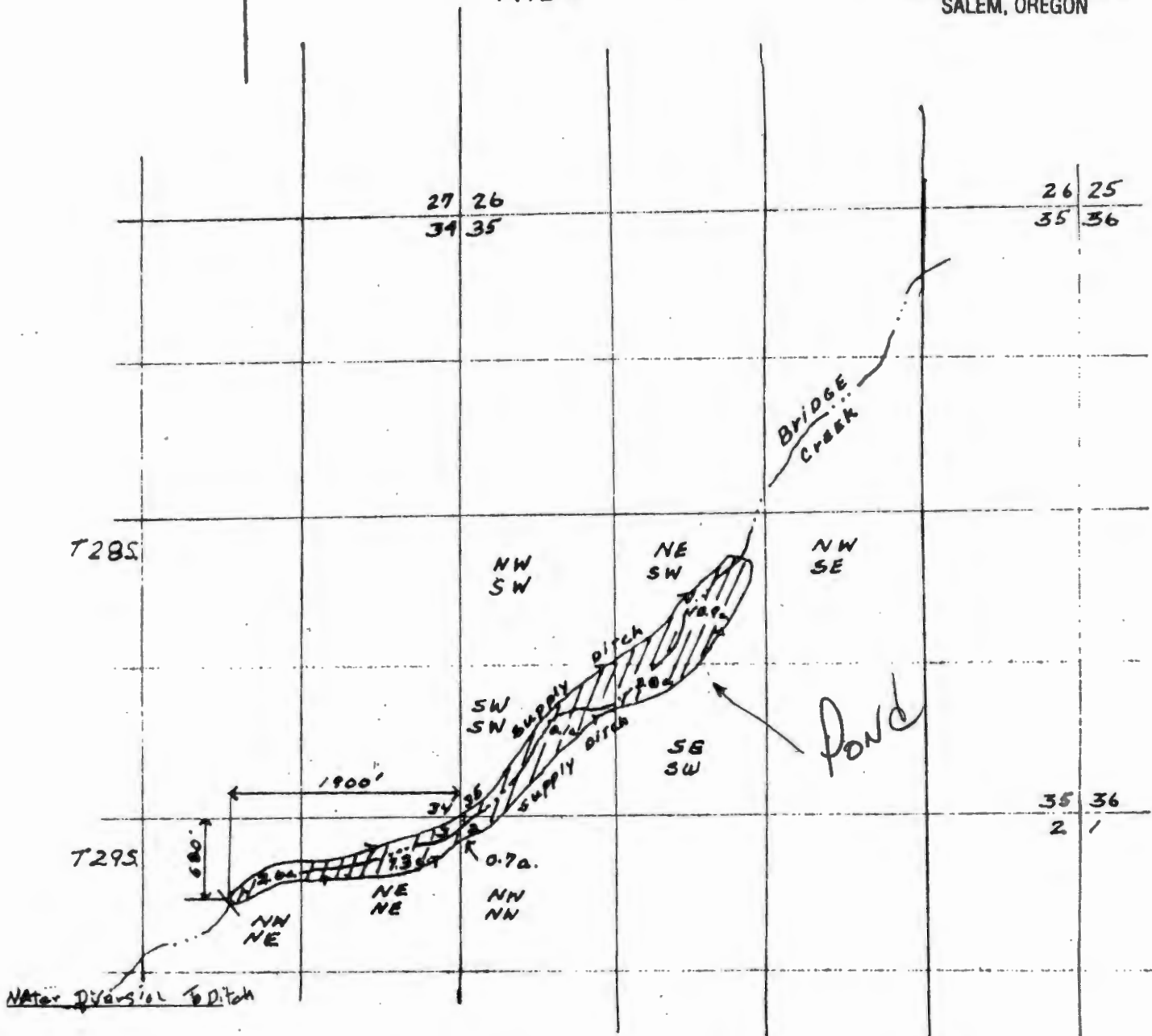

T 28S R13E SEC.35	
SW 1/4 SW 1/4	10.1 Acres
SE 1/4 SW 1/4	3.8 "
NE 1/4 SW 1/4	10.9 "
T 29S R13E SEC.3	
NW 1/4 NE 1/4	2.6 "
NE 1/4 NE 1/4	7.3 "
T 29S. R13E SEC.2	
NW 1/4 NW 1/4	0.7 "

Total 35.4 ac.

App # R. 85522
Permit #

JAMES SPHAR

BRIDGE CREEK MEADOW

EXISTING IRRIGATION SYSTEM

SCALE 1" = 1 MILE

DATA PLOTTED ON AERIAL

WATER AVAILABILITY TABLE

Water Availability as of 4/17/2003 for
BRIDGE CR > ISLAND BR SILVER CR - AT MARSH

Watershed ID #: 31300514 Basin: GOOSE AND SUMMER LAKE Exceedance Level: 50
Time: 15:19 Date: 04/17/2003

Select an Item Number for More Details

Item #	Watershed ID #	Jan	Feb	Mar	Apr	May	Jun	Jul	Aug	Sep	Oct	Nov	Dec	Sto
1	31300514	YES	YES	YES	YES	YES	YES	YES	YES	YES	YES	YES	YES	YES

STREAM NAMES

BRIDGE CR > ISLAND BR SILVER CR - AT MARSH

Watershed ID #: 31300514 Basin: GOOSE AND SUMMER LAKE Exceedance Level: 50
Time: 15:19 Date: 04/17/2003

Item Watershed ID Stream Name

1	31300514	BRIDGE CR > ISLAND BR SILVER CR - AT MARSH
---	----------	--

LIMITING WATERSHEDS

BRIDGE CR > ISLAND BR SILVER CR - AT MARSH

Watershed ID #: 31300514 Basin: GOOSE AND SUMMER LAKE Exceedance Level: 50
Time: 15:19 Date: 04/17/2003

Mnth	Limiting Watershed	Stream Name	Water Avail?	Net Water Available
1	31300514	BRIDGE CR > ISLAND BR SILVER CR - AT MARSH	YES	2.0
2	31300514	BRIDGE CR > ISLAND BR SILVER CR - AT MARSH	YES	2.4
3	31300514	BRIDGE CR > ISLAND BR SILVER CR - AT MARSH	YES	4.1
4	31300514	BRIDGE CR > ISLAND BR SILVER CR - AT MARSH	YES	6.6
5	31300514	BRIDGE CR > ISLAND BR SILVER CR - AT MARSH	YES	18.9
6	31300514	BRIDGE CR > ISLAND BR SILVER CR - AT MARSH	YES	17.9
7	31300514	BRIDGE CR > ISLAND BR SILVER CR - AT MARSH	YES	4.3
8	31300514	BRIDGE CR > ISLAND BR SILVER CR - AT MARSH	YES	1.4
9	31300514	BRIDGE CR > ISLAND BR SILVER CR - AT MARSH	YES	1.1
10	31300514	BRIDGE CR > ISLAND BR SILVER CR - AT MARSH	YES	1.6
11	31300514	BRIDGE CR > ISLAND BR SILVER CR - AT MARSH	YES	1.7
12	31300514	BRIDGE CR > ISLAND BR SILVER CR - AT MARSH	YES	1.5
Stor	31300514	BRIDGE CR > ISLAND BR SILVER CR - AT MARSH	YES	3830.0

Analysis for Application: R85522

Location: 28S-13E-35-NESW

Uses: MP P

Basins

BASIN_NUM	BASIN_NAME
13	Goose & Summer Lakes

Records Found: 1

WaterMaster Districts

WATERDIST	REGION	ACRES	SQ_MILES	WMASTER	ADDRESS	CITY	ZIP	PHONE	EXT	F
12	SC	5099367	7967	Vacant	513 Center St	Lakeview	97630	541-947-6038		5

Records Found: 1

WAB

BASIN	WID	LINK1	LINK2
13	31300514	Water Availability: 50% 80%	Flood Frequency Analysis

Records Found: 1

County

COUNTY	FIPS
Lake	41037

Records Found: 1

Groundwater Restricted

NAME1	NAME2	SUB_AREA	STATUS	SQ_MI
FORT ROCK			CLAS	2163.26

Records Found: 1

Divison 33 Area

DIV33
In a Div33 area

Records Found: 1

Rule 4D Records Found: 0

303D Streams Records Found: 0

303D Lakes Records Found: 0

Sphan

PO. BOX 182

Silverlake OR
97638

Water Resources to
Commerce Building
158 12th St. NE
Salem Ore. 97301-

Att: Roger Wright

**STATE OF OREGON
WATER RESOURCES DEPARTMENT**

725 Summer St. N.E. Ste. A
SALEM, OR 97301-4172

(503) 986-0900 / (503) 986-0904 (fax)

RECEIPT # **117359**

INVOICE # _____

RECEIVED FROM: Steve Spahr;
BY: Cathie E Spahr

APPLICATION	R-85522
PERMIT	
TRANSFER	

CASH: CHECK # 1255 OTHER: (IDENTIFY)

TOTAL REC'D \$ 175.00

1083 TREASURY 4170 WRD MISC CASH ACCT

0407 COPIES \$ _____
OTHER: (IDENTIFY) \$ _____

0243 I/S Lease _____ 0244 Muni Water Mgmt. Plan _____ 0245 Cons. Water _____

4270 WRD OPERATING ACCT

MISCELLANEOUS **46111**

0407 COPY & TAPE FEES \$ _____
0410 RESEARCH FEES \$ _____
0408 MISC REVENUE: (IDENTIFY) _____ \$ _____
TC162 DEPOSIT LIAB. (IDENTIFY) _____ \$ _____
0240 EXTENSION OF TIME \$ _____

WATER RIGHTS:

EXAM FEE
\$ _____
\$ _____
\$ _____

0201 SURFACE WATER 0202 \$ _____
0203 GROUND WATER 0204 \$ _____
0205 TRANSFER \$ _____

WELL CONSTRUCTION

EXAM FEE
\$ _____

0218 WELL DRILL CONSTRUCTOR 0219 \$ _____
LANDOWNER'S PERMIT 0220 \$ _____

0200 OTHER (IDENTIFY) Claim of Beneficial Use \$175.00

0536 TREASURY 0437 WELL CONST. START FEE

0211 WELL CONST START FEE \$ _____ CARD # _____
0210 MONITORING WELLS \$ _____ CARD # _____
OTHER (IDENTIFY) _____

0607 TREASURY 0467 HYDRO ACTIVITY LIC NUMBER

0233 POWER LICENSE FEE (FWWRD) \$ _____
0231 HYDRO LICENSE FEE (FWWRD) \$ _____
HYDRO APPLICATION \$ _____

_____ TREASURY OTHER / RDX

FUND _____ TITLE _____
OBJ. CODE _____ VENDOR # _____
DESCRIPTION _____ \$ _____

RECEIPT: **117359**

DATED: 9/10/15 BY: [Signature]

**STATE OF OREGON
WATER RESOURCES DEPARTMENT**

158 12TH ST. N.E.

SALEM, OR 97301-4172
378-8455 / 378-8130 (FAX)

RECEIPT # **59071**

INVOICE # _____

RECEIVED FROM: Steve Sphar

APPLICATION R85322

BY: _____

PERMIT _____

TRANSFER _____

CASH: CHECK:# 3726 OTHER: (IDENTIFY)

TOTAL REC'D \$ 92.00

0401 TREASURY 0417 WRD MISC CASH ACCT

0407	COPIES		\$
_____	OTHER: (IDENTIFY)	_____	\$
_____	OTHER: (IDENTIFY)	_____	\$

0427 WRD OPERATING ACCT

MISCELLANEOUS

0407	COPY & TAPE FEES		\$
0410	RESEARCH FEES		\$
0408	MISC REVENUE: (IDENTIFY)	_____	\$
TC162	DEPOSIT LIAB. (IDENTIFY)	_____	\$
0240	EXTENSION OF TIME		\$

WATER RIGHTS:

0201	SURFACE WATER		\$
0203	GROUND WATER		\$
0205	TRANSFER		\$

EXAM FEE	
\$	<u>92.00</u>
\$	
\$	
EXAM FEE	
\$	

RECORD FEE	
\$	
\$	

WELL CONSTRUCTION

0218	WELL DRILL CONSTRUCTOR	0219	\$
	LANDOWNER'S PERMIT	0220	\$
_____	OTHER (IDENTIFY)	_____	

LICENSE FEE	
\$	
\$	

0536 TREASURY 0437 WELL CONST. START FEE

0211	WELL CONST START FEE	\$	CARD # _____
0210	MONITORING WELLS	\$	CARD # _____
_____	OTHER (IDENTIFY)	_____	

0607 TREASURY 0467 HYDRO ACTIVITY LIC NUMBER

0233	POWER LICENSE FEE (FW/WRD)		\$
0231	HYDRO LICENSE FEE (FW/WRD)		\$
_____	HYDRO APPLICATION		\$

TREASURY OTHER / RDX

FUND _____	TITLE _____	
OBJ. CODE _____	VENDOR # _____	
DESCRIPTION _____		\$ _____

RECEIPT: **59071**

DATED: 4/1/03 BY: Connie Dance

**STATE OF OREGON
WATER RESOURCES DEPARTMENT**

158 12TH ST. N.E.
SALEM, OR 97301-4172
378-8455 / 378-8130 (FAX)

RECEIPT # **59071**

INVOICE # _____

RECEIVED FROM: Steve Sphar

APPLICATION R85522

BY: _____

PERMIT _____

TRANSFER _____

CASH: CHECK:# _____ OTHER: (IDENTIFY) _____

TOTAL REC'D \$ 92.00

3726

0401 TREASURY 0417 WRD MISC CASH ACCT

0407 COPIES \$
 _____ OTHER: (IDENTIFY) \$
 _____ OTHER: (IDENTIFY) \$

0427 WRD OPERATING ACCT

MISCELLANEOUS

0407 COPY & TAPE FEES \$
 0410 RESEARCH FEES \$
 0408 MISC REVENUE: (IDENTIFY) \$
 TC162 DEPOSIT LIAB. (IDENTIFY) \$
 0240 EXTENSION OF TIME \$

WATER RIGHTS:

0201 SURFACE WATER EXAM FEE \$ 92.00 0202 \$
 0203 GROUND WATER \$ 0204 \$
 0205 TRANSFER \$

WELL CONSTRUCTION

0218 WELL DRILL CONSTRUCTOR EXAM FEE \$ 0219 \$
 LANDOWNER'S PERMIT 0220 \$
 _____ OTHER (IDENTIFY) _____

0536 TREASURY 0437 WELL CONST. START FEE

0211 WELL CONST START FEE \$ CARD # _____
 0210 MONITORING WELLS \$ CARD # _____
 _____ OTHER (IDENTIFY) _____

0607 TREASURY 0467 HYDRO ACTIVITY LIC NUMBER

0233 POWER LICENSE FEE (FW/WRD) \$
 0231 HYDRO LICENSE FEE (FW/WRD) \$
 _____ HYDRO APPLICATION \$

TREASURY OTHER / RDX

FUND _____ TITLE _____
 OBJ. CODE _____ VENDOR # _____
 DESCRIPTION _____ \$

RECEIPT: **59071**

DATED: 4/1/03 BY: Connie Vance



* EU 9 7 5 3 6 9 5 8 4 U S *

HOW TO USE:



UNITED STATES POSTAL SERVICE®

Addressee Copy

Label 11-B September 2002

Post Office To Addressee

ORIGIN (POSTAL USE ONLY)			
PO ZIP Code 41	Day of Delivery <input type="checkbox"/> Next <input type="checkbox"/> Second <input checked="" type="checkbox"/> Third	Flat Rate Envelope <input type="checkbox"/>	
Date In Mo. Day Year 1 3 2002	<input type="checkbox"/> 12 Noon <input type="checkbox"/> 3 PM	Postage \$ 12.69	
Time In <input checked="" type="checkbox"/> AM <input type="checkbox"/> PM	Military <input type="checkbox"/> 2nd Day <input type="checkbox"/> 3rd Day	Return Receipt Fee	
Weight lbs. 3 ozs.	Int'l Alpha Country Code	COD Fee \$	Insurance Fee
No Delivery <input type="checkbox"/> Weekend <input type="checkbox"/> Holiday	Acceptance Clerk Initials YAC	Total Postage & Fees \$ 13.65	

FROM: (PLEASE PRINT) _____ **PHONE (** _____ **)** _____

2000
3-13
Phyllis
9-03

FOR PICKUP OR TRACKING CALL 1-800-222-1811

www.usps.com



PRESS HARD. You are making 3 copies.

DELIVERY (POSTAL USE ONLY)		
Delivery Attempt Mo. Day 1 3	Time <input type="checkbox"/> AM <input type="checkbox"/> PM	Employee Signature
Delivery Attempt	Time <input type="checkbox"/> AM <input type="checkbox"/> PM	Employee Signature
Delivery Date Mo. Day 1 3	Time <input type="checkbox"/> AM <input type="checkbox"/> PM	Employee Signature

CUSTOMER USE ONLY

PAYMENT BY ACCOUNT
Express Mail Corporate Acct. No. _____

WAIVER OF SIGNATURE (Domestic Only)
Additional merchandise insurance is void if waiver of signature is requested.
I wish delivery to be made without obtaining signature of addressee or addressee's agent (if delivery employee judges that article can be left in secure location) and I authorize that delivery employee's signature constitutes valid proof of delivery.

Federal Agency Acct. No. or Postal Service Acct. No. _____

NO DELIVERY
 Weekend Holiday

Customer Signature _____

TO: (PLEASE PRINT) _____ **PHONE (** _____ **)** _____

15013 St. NW
Silverdale, OR 97131

ZIP + 4
[] [] [] [] [] + [] [] [] [] []

Tyvek®/25% Post Content

EP-13C JANUARY 1995

ALTERNATE POND ROUTE SLIP

RECEIPTING
POST CARD SENT
DATA CENTER *n.a.*

WATER RIGHTS SUPPORT

ATT: WATER RIGHTS
SUPPORT...>>>>

Mark contents of Application File;
Update Powerbuilder with
caseworker, etc.;



Route to filing cabinet.

ANITA HUFFMAN EXT. 229

CORY ENGEL EXT. 324

JERRY GAINEY EXT. 458

KERRY LEFEVER EXT. 276

RUSS KLASSEN EXT. 266

**“NOTE: IF RELATED FILE IS GROUND WATER,
ROUTE TO GROUND WATER, BUT ROUTE ALT-
RESERVOIR TO WATER RIGHTS DIVISION.”**

8/17

SENDER: COMPLETE THIS SECTION

- Complete items 1, 2, and 3.
- Print your name and address on the reverse so that we can return the card to you.
- Attach this card to the back of the mailpiece, or on the front if space permits.

1. Article Addressed to:

R-85522

STEVE J. SPHAR
PO BOX 182
SILVER LAKE, OR 97638



9590 9403 0447 5169 4822 34

2. Article Number (Transfer from service label)

7008 1830 0004 45950817

COMPLETE THIS SECTION ON DELIVERY

A. Signature Agent
 Addressee

X *Cathy Epha*

B. Received by (Printed Name) C. Date of Delivery

D. Is delivery address different from item 1? Yes
If YES, enter delivery address below: No

RECEIVED

SEP 01 2015

OWRD

3. Service Type

<input type="checkbox"/> Adult Signature	<input type="checkbox"/> Priority Mail Express®
<input type="checkbox"/> Adult Signature Restricted Delivery	<input type="checkbox"/> Registered Mail™
<input type="checkbox"/> Certified Mail®	<input type="checkbox"/> Registered Mail Restricted Delivery
<input type="checkbox"/> Certified Mail Restricted Delivery	<input type="checkbox"/> Return Receipt for Merchandise
<input type="checkbox"/> Collect on Delivery	<input type="checkbox"/> Signature Confirmation™
<input type="checkbox"/> Collect on Delivery Restricted Delivery	<input type="checkbox"/> Signature Confirmation Restricted Delivery
<input type="checkbox"/> Insured Mail	
<input type="checkbox"/> Insured Mail Restricted Delivery (over \$500)	

UNITED STATES POSTAL SERVICE



First-Class Mail
Postage & Fees Paid
USPS
Permit No. G-10

- Sender: Please print your name, address, and ZIP+4® in this box•

Oregon Water Resources Department
Attention: Kate Fitzgerald
725 Summer St. NE, Suite A
Salem, OR 97301

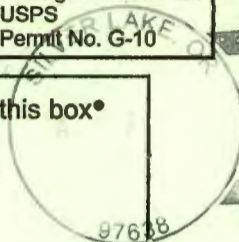

USPS TRACKING#



9590 9403 0447 5169 4822 34