

ATTACHMENT 1B
Claim of Beneficial Use Application
Place of Use Map - City of Wilsonville

Application: G - 10842 / Permit: G - 9957
 T3S, R1W & T3S, R1E

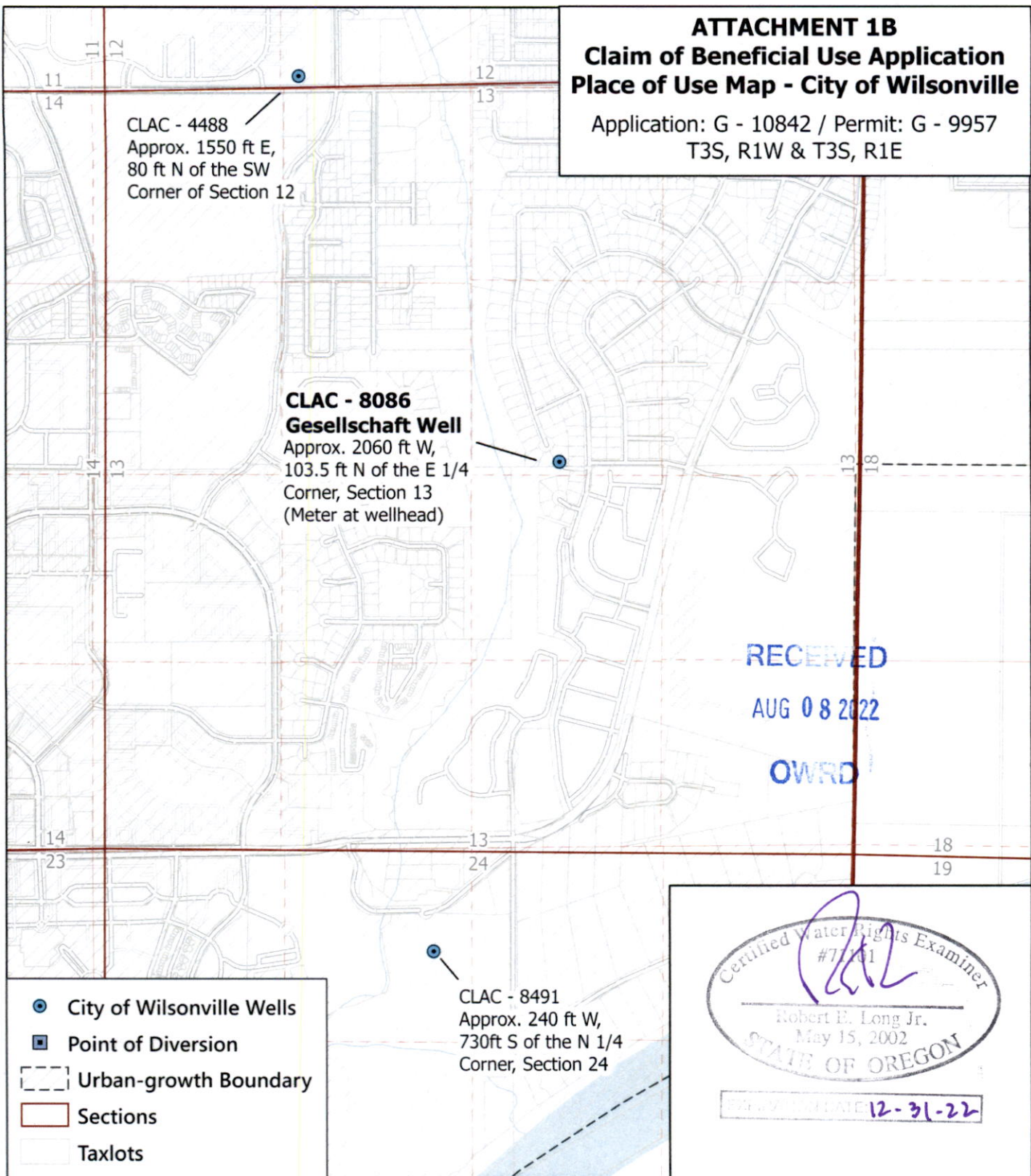

Certified Water Rights Examiner
 #77101
 Robert E. Long Jr.
 May 15, 2002
 STATE OF OREGON
 EXPIRES DATE 12-31-22



1319 SE MLK, Jr. Blvd, Suite 204
 Portland, Oregon 97214
 (503) 954-1326

This map is not intended to provide legal dimensions or locations of property ownership lines.

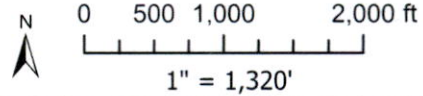

No.	Date	By	Revisions
1			DRAFT
1	10/27/20	IAG	DRAFT 1
2	05/19/21	IAG	FINAL

Proj#: 1707002
 City of Wilsonville
 City of Wilsonville
 30000 SW Town Center Loop E
 Wilsonville, OR 97070

ATTACHMENT 1A
Claim of Beneficial Use Application
Place of Use Map - City of Wilsonville

Application: G - 10842 / Permit: G - 9957
 T3S, R1W & T3S, R1E

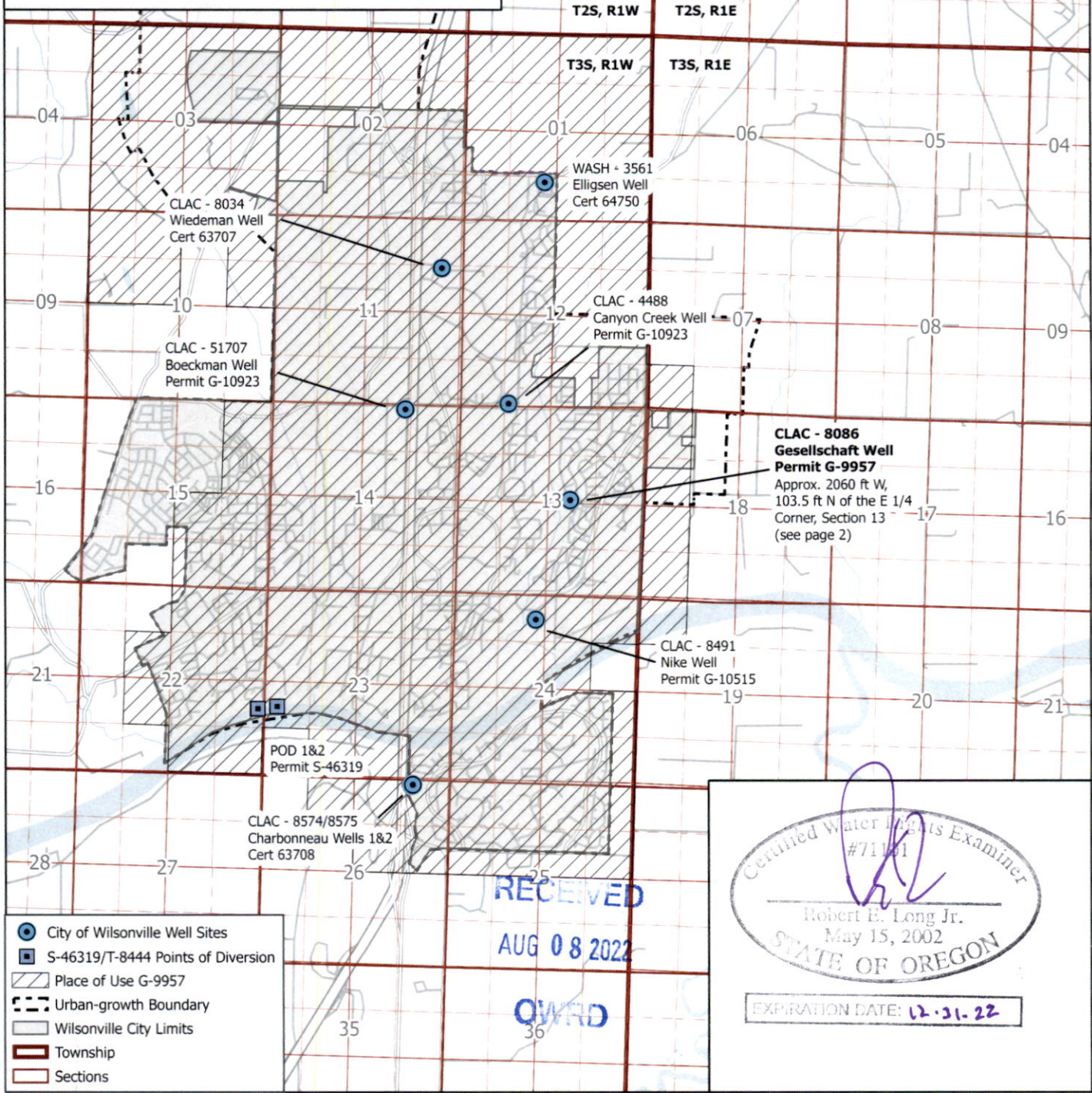

Certified Water Rights Examiner
 #71101
 Robert E. Long Jr.
 May 15, 2002
 STATE OF OREGON
 EXPIRATION DATE: 12-31-22



1319 SE MLK, Jr. Blvd, Suite 204
 Portland, Oregon 97214
 (503) 954-1326

This map is not intended to provide legal dimensions or locations of property ownership lines.

No.	Date	By	Revisions
1	10/27/20	IAG	DRAFT 1
2	05/19/21	IAG	FINAL

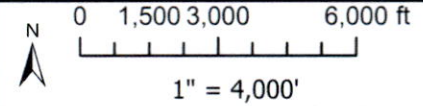

Proj#: 1707002
 City of Wilsonville
 City of Wilsonville
 30000 SW Town Center Loop E
 Wilsonville, OR 97070