

Application No. G G 4178
Permit No. G G 3927
Certificate No. 39065

Stream Index, Page No. 5-45
12/12-15 c (2 wells)

Name OREGON STATE PARKS AND RECREATION
By Div. of Oregon Highway Commission
Address 300 State Highway Bldg.
Salem, Oregon

Date filed January 12, 1968
Priority January 12, 1968

Action suspended until OK Cert

Returned to applicant
Date of approval July 22, 1968

CONSTRUCTION

Date for beginning July 22, 1969
Date for completion October 1, 1969

Extended to

Date for application of water October 1, 1970

Extended to

PROSECUTION OF WORK

Form "A" filed
Form "B" filed
Form "C" filed Completed

FINAL PROOF

Blank mailed FEB 21 1973
Proof received
Date certificate issued MAR 20 1973

FEES PAID

Date	Amount	Receipt No.
<u>1-12-68</u>	<u>30.00</u>	<u>7309</u>
<u>3-2-73</u>	<u>1.50</u>	<u>32649</u>
	\$1 Cert. Fee	

FEES REFUNDED

Date	Amount	Check No.

ASSIGNMENTS

Date	To Whom	Address	Volume	Page

REMARKS

0.16 cfs from two wells being 0.08 cfs from each well (Lake Chinook) (Deschutes River) for domestic use in Cove Palisades Park and irrigation of 6.5 acres being 0.09 cfs for domestic and 0.07 cfs for irrigation

Probable hydrologic connection w/ surface water of Lake Champlain.
April 1/17/68

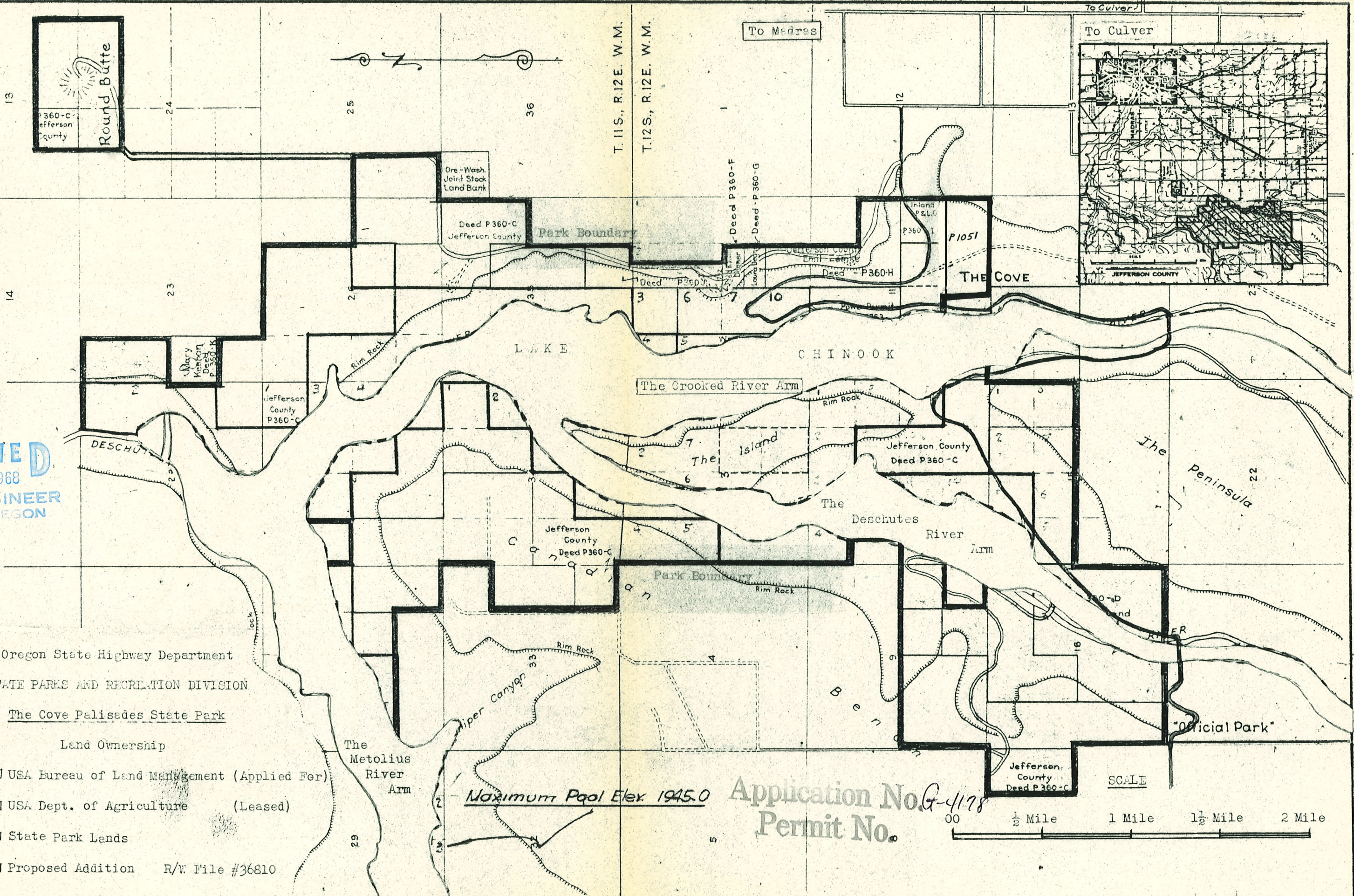
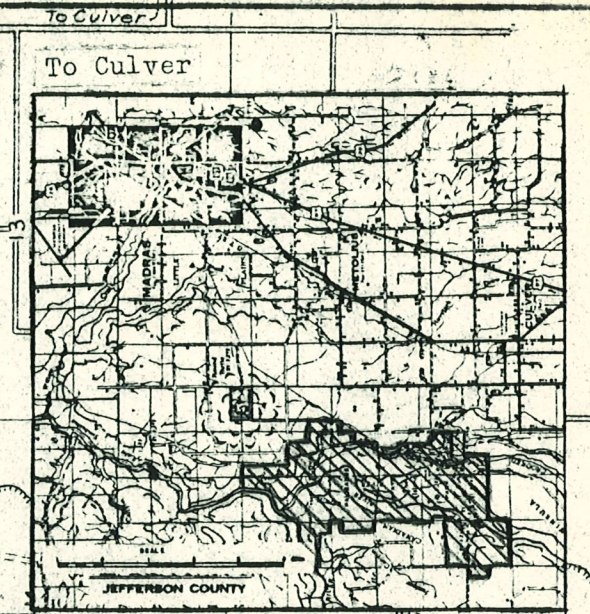
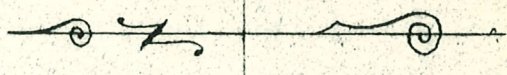
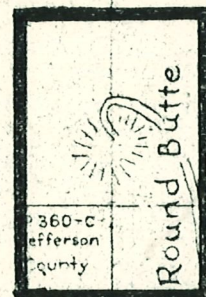

RECEIVED
JAN 2 1968
STATE ENGINEER
SALEM OREGON

Oregon State Highway Department
STATE PARKS AND RECREATION DIVISION
The Cove Palisades State Park

- Land Ownership
- USA Bureau of Land Management (Applied For)
 - USA Dept. of Agriculture (Leased)
 - State Park Lands
 - Proposed Addition R/W File #36810

Maximum Pool Elev. 1945.0

Application No. G-4178
Permit No.

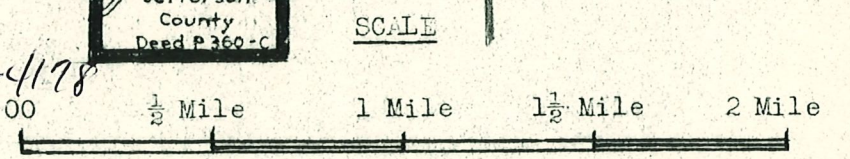

Form C

IMPORTANT—This form is a notice to the State Engineer that permittee is ready to make final proof to the extent to which the water has actually been applied to the intended use under the terms of the permit. Permittee is cautioned that Certificate of Water Right will be issued based on the extent of the quantity and use as determined by the final proof inspection and survey which will be made in response to the filing of this Form C.

NOTE: In the case of an irrigation permit, this Form C should not be mailed to the State Engineer until all of the land described in the permit, which it is intended to irrigate under this permit at any time, has actually been irrigated. Fill out, detach and mail to the State Engineer, Salem, Oregon, when all of the water has been applied.

Application No.

NOTICE OF COMPLETE APPLICATION OF WATER TO A BENEFICIAL USE

Hwy. Comm.

I, Oregon State Parks & Recreation Div. of the Oregon, the holder of Permit No.

to appropriate the public waters of the state of Oregon, completely applied the waters to a beneficial use in accordance with the terms of said permit, on the 1st day of June, 1965

Remarks:

IN WITNESS WHEREOF, I have hereunto set my hand this 8 day of Jan, 1968

W Gaskell (Signature of Applicant)

oregon state Highway Bldg Rm 316 (Address) Salem

Form B

Application No.

NOTICE OF COMPLETION OF CONSTRUCTION

Hwy. Comm.

I, Oregon State Parks & Recreation Div. of the Oregon, the holder of Permit No.

to appropriate the public waters of the state of Oregon, completed the construction of the works described therein on the 1st day of July, 1964

Remarks:

If the works have less capacity than described in the permit, or you have definitely abandoned part of the proposed development, you

should so state in order that our records may not be unnecessarily encumbered.

IN WITNESS WHEREOF, I have hereunto set my hand this 8 day of Jan, 1968

W Gaskell (Signature of Applicant)

oregon state Highway Bldg Rm 316 (Address) Salem

Fill out, detach, and mail to the State Engineer, Salem, Oregon, when construction work is completed.

Form A

Application No.

NOTICE OF BEGINNING OF CONSTRUCTION

Hwy. Comm.

I, Oregon State Parks & Recreation Div. of the Oregon, the holder of Permit No.

to appropriate the public waters of the state of Oregon, began the actual construction of the works described therein on the 1st day of November, 1963

Remarks: by contract

The appropriator should state the manner of beginning construction work, number of men employed, the amount of work completed

up to the date of this statement, and any additional information which may tend to show the beginning of work in good faith.

IN WITNESS WHEREOF, I have hereunto set my hand this 8 day of Jan, 1968

W Gaskell (Signature of Applicant)

oregon state Highway Bldg Rm 316 (Address) Salem

Fill out, detach, and mail to the State Engineer, Salem, Oregon, when construction work is begun.

RECEIVED JAN 1 1968 STATE ENGINEER SALEM OREGON

THE COVE PALISADES STATE PARK
WATER RIGHT APPLICATION

JEFFERSON COUNTY
T. 12 S., R. 12 E., W.M.

1" = 800'

12-20-67

RECEIVED
JAN 12 1968
STATE ENGINEER
SALEM OREGON

Application No. G-4178
Permit No.

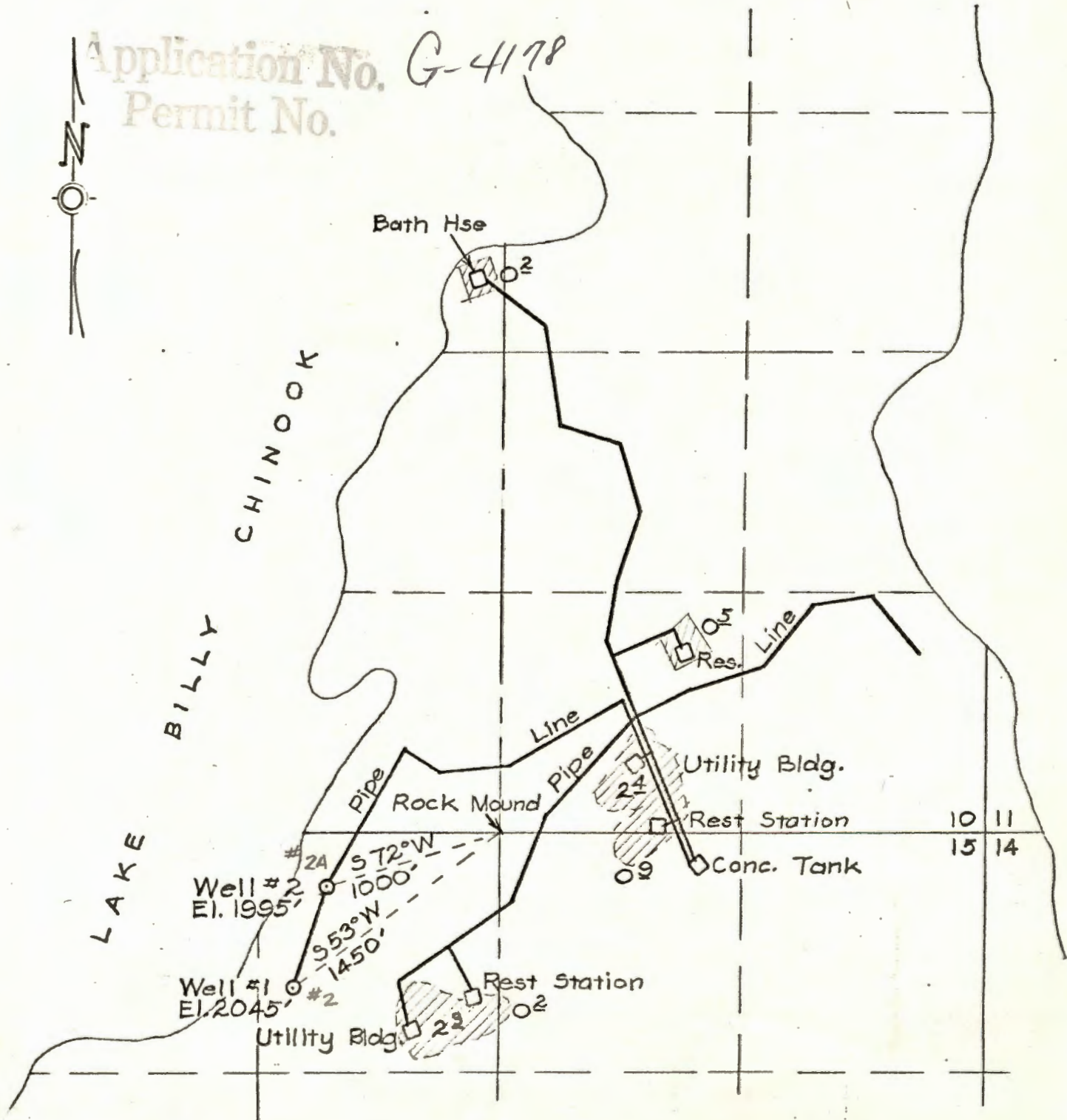

RECEIVED
MAR 2 1973
STATE ENGINEER
SALEM, OREGON

STATE OF OREGON

COUNTY OF JEFFERSON

Proof of Appropriation of Water

OREGON STATE PARKS & RECREATION DIVISION
Oregon Highway Commission

of 300 State Highway Bldg., Salem, State of Oregon,
has applied beneficially the waters of
two wells

a tributary of Deschutes River for the purpose of
domestic use in Cove Palisades Park and irrigation of 6.5 acres

under Permit No. G-3927 of the State Engineer, and that the use of said waters has been
completed under the terms of said permit; that the priority of the
right dates from January 12, 1968

that the amount of water for the purposes aforesaid, has been actually beneficially used in the
amount of 0.16 cubic foot per second, being 0.09 cubic foot per second for domestic and
0.07 cubic foot per second for irrigation, being 0.045 cubic foot per second from
each well for domestic and 0.035 cubic foot per second from each well for irrigation
or its equivalent in case of rotation, measured at the point of diversion from the stream.

The point of diversion is located in the NE 1/4 NW 1/4, Section 15, T. 12 S., R. 12 E., W. M.
Wells located: #1 - South 72 deg. West 1000 feet; #2 - South 53 deg. West 1450
feet from N 1/4 Corner, Section 15.

The amount of water used for irrigation, together with the amount secured under any other
right existing for the same lands, shall be limited to one-eightieth of one cubic foot per second
per acre, or its equivalent for each acre irrigated and shall be further limited
to a diversion of not to exceed 3 acre feet per acre for each acre irrigated
during the irrigation season of each year,

and shall conform to such reasonable rotation system as may be ordered by the proper state officer.

A description of the place of use under the right, and to which such right is appurtenant, is
as follows:

0.2 acre SE 1/4 NW 1/4
2.9 acres SW 1/4 SE 1/4
Section 10

1.1 acres NW 1/4 NE 1/4
2.3 acres NE 1/4 NW 1/4
Section 15

T. 12 S., R. 12 E., W. M.

I have read the above and foregoing proof of appropriation of water; I know the contents
thereof, and that the facts therein stated are true.

IN WITNESS WHEREOF, I have hereunto set my hand this 28 day of Feb

1973

W. Gaskill

RECEIVED
FEB 21 1973
STATE PARKS
SECTION

[Faint, mostly illegible text from a document bleed-through, including fragments like "SECTION 12", "STATE PARKS", and "RECEIVED"]



**OREGON STATE
HIGHWAY DIVISION**

RECEIVED
MAR 2 1973
**STATE ENGINEER
SALEM, OREGON**

HIGHWAY BUILDING • SALEM, OREGON • 97310

TOM McCALL
GOVERNOR

February 28, 1973

GEORGE M. BALDWIN
Administrator of Highways

Mr. Chris L. Wheeler
1178 Chemeketa Street N.E.
Salem, OR 97310

File No. G-4178
The Cove Palisades State Park

Dear Mr. Wheeler:

Enclosed is check No. 222742 in the amount of \$1.50 for the recording fee and the executed Proof of Appropriation of Water for file No. G-4178.

Very truly yours,

David G. Talbot
State Parks Superintendent

By

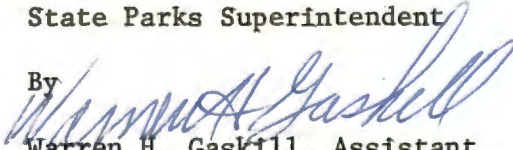
Warren H. Gaskill, Assistant
State Parks Superintendent

Enclosure

February 21, 1973

Oregon State Parks & Recreation Div.
Oregon Highway Commission
300 State Highway Bldg.
Salem, OR

File No. G-4178

Gentlemen:

Enclosed is the final proof in connection with the incomplete water right represented by your permit number ~~G-3927~~.

The data contained in the proof, which is based on an inspection and survey of your project made by a representative of this department, defines the extent to which your water right has been completed within the terms of your permit. The proof should be dated and signed by you and returned to this office.

Upon receipt of the proof, properly executed and accompanied by the statutory recording fee of \$1.50, a certificate of water right will be issued confirming the right thereunder and, after being recorded in the county records, will be forwarded to you.

Very truly yours,

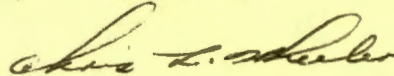

CHRIS L. WHEELER
State Engineer

Form 117

Enclosure
gkd

G-4178

G-4179

August 6, 1968

Oregon State Parks and Recreation
Div. of Oregon Highway Commission
300 State Highway Building
Salem, Oregon

G-4178, permit No. G-3927, application
No. G-4179, permit No. G-3928 with blueprints.

February 7, 1968

Oregon State Parks & Recreation
Div. of Oregon Highway Commission
300 State Highway Building
Salem, Oregon

ATTENTION John Bradfield

Gentlemen:

This will acknowledge your returned application No. G-4178 with Items No. 2 and 3 corrected to specify the quantity of water for each use from each well and a transparency map.

This application is now in satisfactory form for approval by issuance of a permit.

Very truly yours,

CHRIS L. WHEELER
State Engineer

By
Larry W. Jebousek
Assistant

LW:shs

ONERS
KSON, CHAIRMAN
B. SIMPSON, MEMBER
PORTLAND
FRED W. HILL, MEMBER
HELIX



STATE OF OREGON
STATE HIGHWAY DEPARTMENT
SALEM 97310
January 31, 1968

RECEIVED
JAN 31 1968
STATE ENGINEER
SALEM, OREGON

Mr. Chris L. Wheeler, State Engineer
516 Public Service Building
Salem, Oregon 97310

Attention: Larry W. Jebousek, Assistant

Gentlemen:

Re: File No. G-4178

Attached is the corrected application and transparency for subject file, which we trust are in proper form.

Very truly yours,

John Bradfield
Parks Design Supervisor

JB:bt

Encl.

G-4179
G-4178

January 29, 1968

Oregon State Parks and Recreation
Div. of Oregon Highway Commission
300 Highway Bldg.
Salem, Oregon

Attention: John Bradfield, Parks Design Supervisor

Gentlemen:

This will acknowledge receipt of an application for a permit to appropriate 70 gallons of water per minute from two wells for domestic use and lawn irrigation of 6.5 acres, a map with prints and the fee of \$30 for which our receipt No. 7309 is enclosed. This application has been filed and numbered G-4178.

Also acknowledged is receipt of an application for a permit to appropriate 0.04 cubic foot of water per second for domestic use in a public campground and 0.16 cubic foot of water per second for the irrigation of 13 acres, a map with prints and the fee of \$30 for which our receipt No. 7310 is enclosed.

This application, which has been filed and numbered G-4179, is in satisfactory form for approval by issuance of a permit.

Item No. 2 on application No. G-4178 indicates that 70 gallons of water per minute is to be appropriated. Item No. 3 further specifies 0.17 cubic foot of water per second for domestic use and 0.08 cubic foot of water per second for irrigation. The 0.25 cubic foot of water per second is equal to 112 gallons of water per minute. Item No. 2 on the application must also specify the quantity of water to be appropriated from each of the two wells, and be in agreement with that quantity shown in item No. 3.

Item No. 3 on the application should then show the quantity of water to be appropriated for each use from each well.

January 29, 1968

It is felt that the domestic use should be further clarified as being domestic use for a specific number of residences, utility buildings, campgrounds, drinking water, restrooms, and picnic areas.

I am returning application No. G-4178 and the transparency for correction. The application is endorsed so that in order to retain its date of priority, it must be returned on or before March 29, 1968.

Very truly yours,

CHRIS L. WHEELER
State Engineer

By
Larry W. Jebousek
Assistant

LWJ:dlw
Enclosures

MEMBERS
SON, CHAIRMAN
FRIDLEY, MEMBER
SIMPSON, MEMBER
PORTLAND



STATE OF OREGON
STATE HIGHWAY DEPARTMENT
SALEM 97310

January 11, 1968

RECEIVED
JAN 12 1968
STATE ENGINEER
SALEM OREGON

Mr. Chris L. Wheeler, State Engineer
516 Public Service Building
Salem, Oregon 97310

Dear Mr. Wheeler:

Attached are applications to appropriate the ground waters of the State of Oregon for park purposes in The Cove Palisades State Park in Jefferson County and Lapine State Recreation Area in Deschutes County, together with a tracing, three prints and a boundary map for each park.

Construction is completed at both parks and water is completely applied to beneficial use at The Cove Palisades Park, so we are enclosing forms "A", "B", and "C" as applicable.

Also enclosed is State Check No. A091068 in the amount of \$60.00 to cover filing fees.

Very truly yours,

John Bradfield

John Bradfield
Parks Design Supervisor

JB:bt

Encl.

New filing on 2 new wells?

Abstract of Permit No. G-3927

Application No. G-4,178 Certificate No.

Name Oregon State Parks & Recreation Division
 Address Oregon Highway Commission
 300 State Highway Bldg.
 Source of water supply Salem, Oregon
 Two wells (Deschutes R.)
 Use Domestic use in Cove Palisades Park and irrigation of 6⁵ acres
 Point of diversion #2- S. 72° W. 1000'; #2- S. 53° W. 1450' from NE cor. Sec. 15, being within NE 1/4 NW 1/4, Sec. 15, T. 12 S., R. 12 E., W.M., county of Jefferson
 Number of acres ~~6.5~~

DESCRIPTION OF LAND TO BE IRRIGATED OR PLACE OF USE

Twp.	Range	Sec.	NE 1/4				NW 1/4				SW 1/4				SE 1/4			
			NE 1/4	NW 1/4	SW 1/4	SE 1/4	NE 1/4	NW 1/4	SW 1/4	SE 1/4	NE 1/4	NW 1/4	SW 1/4	SE 1/4	NE 1/4	NW 1/4	SW 1/4	SE 1/4
12S	12E	10																
		10			1.1				2.3									2.9
		10	SE 1/4 NW 1/4		0.7 ac													0.2
		10	SW 1/4 SE 1/4		5.1 ac													2.9
		15	NW 1/4 NE 1/4		1.3 ac													1.1
		15	NE 1/4 NW 1/4		4.1 ac													2.3
																		(6.5)

Priority date January 12, 1968
 Amount of water 0.16 c.f.s., being 0.09 c.f.s. for domestic and 0.07 c.f.s. for irrigation, being 0.035 from each well for domestic & 0.035 from each well for irrigation
 Time limit to begin construction July 22, 1969
 Time limit to complete construction 10-1-69 extended to extended to
 Time limit to completely apply water 10-1-70 extended to extended to

Remarks: This appropriation shall be limited to 1/80th of one cubic foot per second or its equivalent for each acre irrigated and shall be further limited to a diversion of not to exceed 3 acre feet per acre for each acre irrigated during the irrigation season of each year; and shall be subject to such reasonable rotation system as may be ordered by the proper state officer.

Inspection
June 18, 1971
L. E. Gould

WOF

Basin 5, Vol. _____

75% COTTON FIBER

no. dlc's on lots - BD

Info: Lawrence Copley

Well #1 6" Casing approx. 80' Deep.

Pump: 5 H.P. Jacuzzi Submersible 1½" Disch.

Pipe: 4" Iron approx. 1 mile (To Res.)
1½" " " 200' (Pump to Atain) 4"

Res: 22,000 gal. concrete tank.

Use: Emergency Domestic use & irrigation

Well #2 6" Casing approx. 80' Deep.

Pump: 7½ H.P. Berkeley Submersible 1½" Disch.

Pipe: 1½" Iron approx. 800' (Pump to 4")
4" " " " 1 mile (To Res.)

Use: Emergency Domestic Use & Irrigation

Note: Mr. Copley said that 2 New wells have been drilled and that each has a 10 H.P. Pump and now supply most of the water. The 2 wells in This App. are used for Emergency Use only.

June 18, 1971, R. E. Gould
Field Engineer

THE COVE PALISADES STATE PARK

WATER RIGHT APPLICATION

JEFFERSON COUNTY

T. 12 S., R. 12 E., W.M.

1" = 800'

12-20-67

