

Application No. 19216

Permit No. 14809

Certificate No. ~~14341~~

~~16616~~ 27741 74211 76185

Stream Index, Page No. 15-78

Ch. Pt. of Div. Sp. Or. Vol. 10, p. 334 (N-21)  
Ch. Place of Use Sp. Or. Vol. 12, p. 68 (O-36)

Sec T 2624, 5, 6, 7

FEES PAID

Date	Amount	Receipt No.
3/19/41	10.00	27348

Total		
4/28/42	\$1 Cert. Fee	28690
3/19/41	0.10 B.P.	27348

FEES REFUNDED

Date	Amount	Check No.
------	--------	-----------

Name Geo. L. Jantzer Lumber Co.  
By E. W. Pease, Secy-Treas. Inc.  
Address Prospect, Oregon

Date filed March 19, 1941

Priority March 19, 1941

Action suspended until

Returned to applicant

Date of approval May 12, 1941

CONSTRUCTION

Date for beginning May 12, 1942

Date for completion October 1, 1943

Extended to

Date for application of water October 1, 1944

Extended to

PROSECUTION OF WORK

Form "A" filed April 13, 1942

Form "B" filed April 13, 1942

Form "C" filed April 13, 1942

FINAL PROOF

Blank mailed 4-14-42 WM

Proof received

Date certificate issued June 22, 1942

ASSIGNMENTS

Date	To Whom	Address	Volume	Page
------	---------	---------	--------	------

REMARKS

1.0 S.f. from Mill Creek (N. Fork Rogue) for Steam Boiler & Mill Pond, being 0.60 S.f. for steam boiler & 0.40 S.f. for Mill Pond.

Cert. # 16616 supercedes Cert. # 14341 and confirms a change in use by Sp. Or. Vol. 4, p. 520 <sup>Sec (5-8)</sup> 0.11 cfs for domestic use, reduces Mill Pond use to 0.29 cfs.

See T-2624, 2626

NOTICE OF COMPLETE APPLICATION OF WATER TO A BENEFICIAL USE

I, E. W. Pease, Secy-Treas. for the Geo. L. Jantzer Lbr. Co., Inc., the holder of Permit No. 14809 to appropriate the public waters of the state of Oregon, completely applied the waters to a beneficial use in accordance with the terms of said permit, on the 20th day of May, 1941.

Remarks: If all of the water granted in the permit has not been fully applied to beneficial use, you should so state.

IN WITNESS WHEREOF, I have hereunto set my hand this 10th day of April, 1942.

Signature of Witness: Dorothy Fairchild

Signature of Applicant: E. W. Pease

Prospect, Ore. (Address)

Prospect, Ore. (Address)

NOTE: In the case of an irrigation permit, this Form C should not be mailed to the State Engineer until all of the land described in the permit, which it is intended to irrigate under this permit at any time, has actually been irrigated.

Fill out, detach and mail to the State Engineer, Salem, Oregon, when all of the water has been applied.

NOTICE OF COMPLETION OF CONSTRUCTION

I, E. W. Pease, Secy-Treas. for the Geo. L. Jantzer Lbr. Co., Inc., the holder of Permit No. 14809 to appropriate the public waters of the state of Oregon, completed the construction of the works described therein on the 20th day of May, 1941.

Remarks: If the works have less capacity than described in the permit, or you have definitely abandoned part of the proposed development, you should so state in order that our records may not be unnecessarily encumbered.

IN WITNESS WHEREOF, I have hereunto set my hand this 10th day of April, 1942.

Signature of Witness: Dorothy Fairchild

Signature of Applicant: E. W. Pease

Prospect, Ore. (Address)

Prospect, Ore. (Address)

Fill out, detach, and mail to the State Engineer, Salem, Oregon, when construction work is completed.

NOTICE OF BEGINNING OF CONSTRUCTION

I, E. W. Pease, Secy-Treas. for the Geo. L. Jantzer Lbr. Co., Inc., the holder of Permit No. 14809 to appropriate the public waters of the state of Oregon, began the actual construction of the works described therein on the 13th day of May, 1941.

Remarks: Old open ditch and flume repaired for satisfactory transportation of water. The appropriator should state the manner of beginning construction work, number of men employed, the amount of work completed up to the date of this statement, and any additional information which may tend to show the beginning of work in good faith.

IN WITNESS WHEREOF, I have hereunto set my hand this 10th day of April, 1942.

Signature of Witness: Dorothy Fairchild

Signature of Applicant: E. W. Pease

Prospect, Ore. (Address)

Prospect, Ore. (Address)

Fill out, detach, and mail to the State Engineer, Salem, Oregon, when construction work is begun.

SECTION

10

TOWNSHIP 33 S, RANGE 2 E, W. M.

North

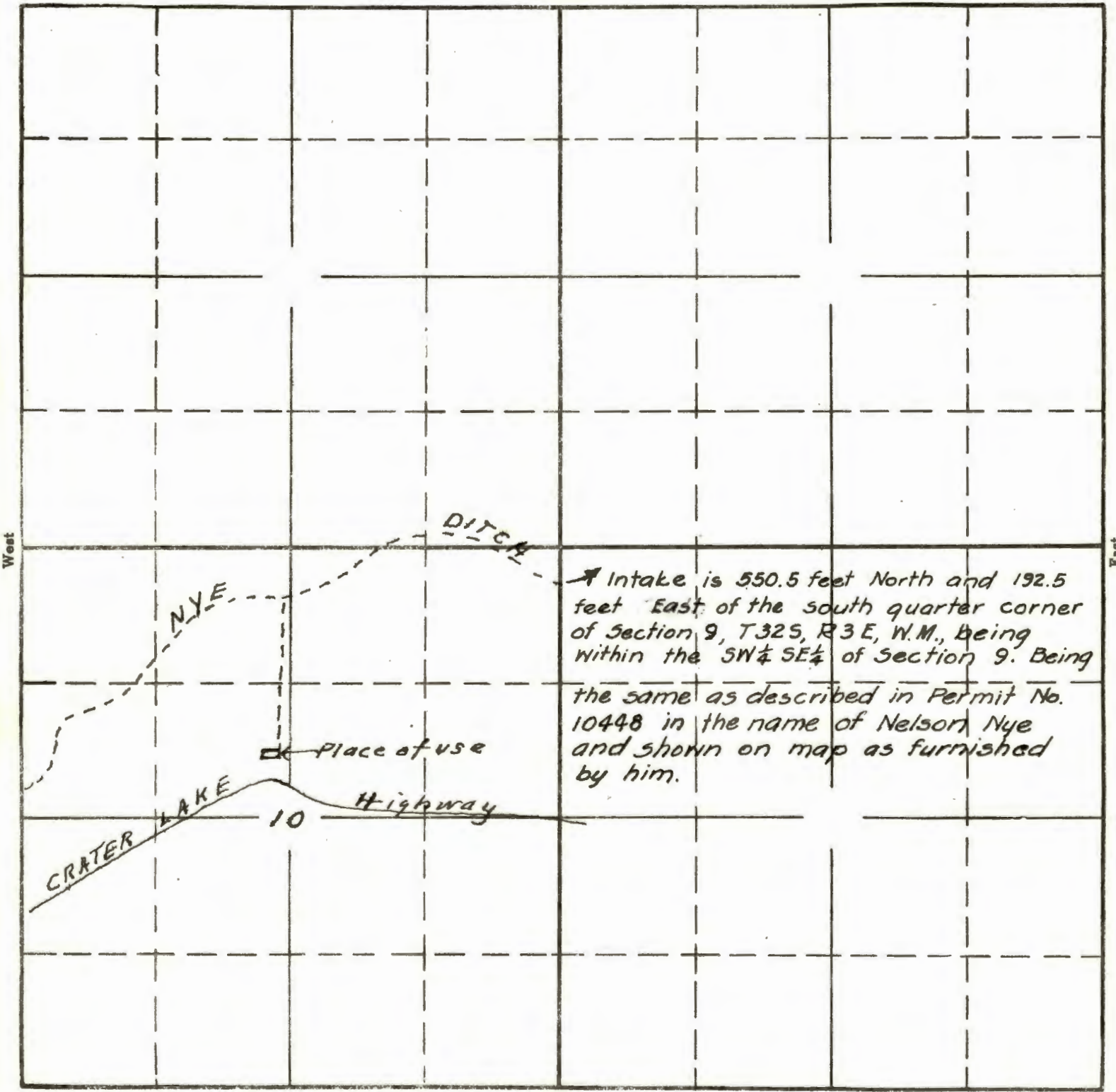

Intake is 550.5 feet North and 192.5 feet East of the south quarter corner of Section 9, T32S, R3E, W.M., being within the SW $\frac{1}{4}$  SE $\frac{1}{4}$  of Section 9. Being the same as described in Permit No. 10448 in the name of Nelson Nye and shown on map as furnished by him.

South

To accompany application of George L. Jantzer Corp. to appropriate waters of Mill Creek for manufacturing purposes (Mill pond and steam boiler)

19216 au  
15-78  
APPLICATION No. 19216  
PERMIT No. 14809

This office 3/12/41

C.A. Smith, Watermaster, Dist #15

T. 32 S., R. 3 E., W.M.

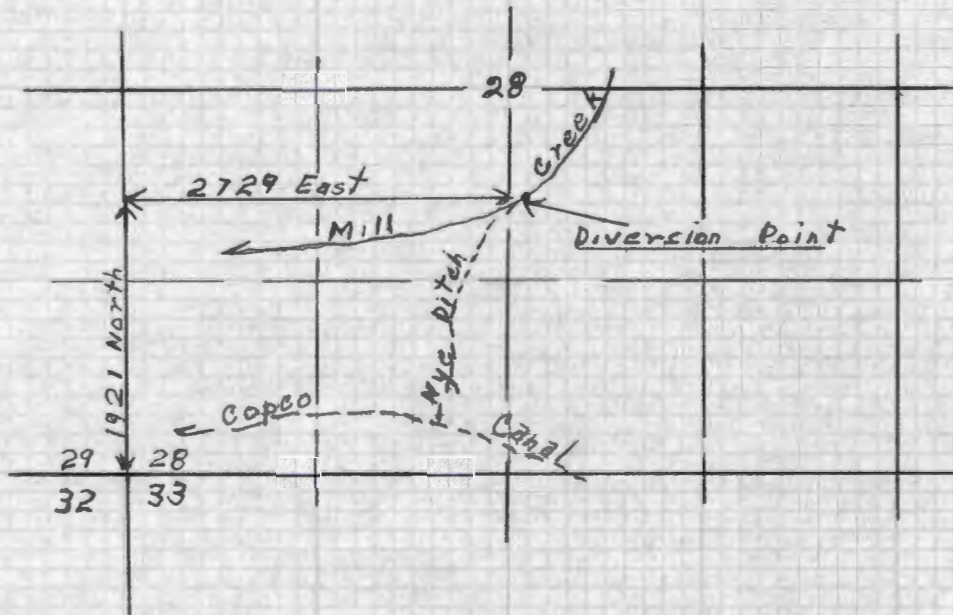

Scale 4" = 1 mile

Point of Diversion

Cont # 27741

(New POD Under C#27741 resulting from Tr# N-21)

BEFORE THE STATE ENGINEER OF OREGON

Jackson County

IN THE MATTER OF THE APPLICATION )  
OF OLSON-LAWYER LUMBER, INC. FOR )  
THE APPROVAL OF A CHANGE IN PLACE )  
OF USE OF WATER FROM MILL CREEK )  
- - - - -

ORDER

APPROVING APPLICATION

On May 23, 1962, Olson-Lawyer Lumber, Inc. of Medford, Oregon filed an application in the office of the State Engineer for the approval of a change in place of use of water from Mill Creek, pursuant to the provisions of ORS 540.510 to 540.530.

Certificate of water right issued to Ross Lumber Company and recorded at page 27741, Volume 19, State Record of Water Right Certificates, confirms a right under Permit No. 14809 to the use of 1.0 cubic foot per second of the waters of Mill Creek, being 0.6 cubic foot per second for steam boiler, 0.29 cubic foot per second for mill pond and 0.11 cubic foot per second for domestic purposes for 10 families within the SE $\frac{1}{4}$  NW $\frac{1}{4}$ , Section 10, Township 33 South, Range 2 East, W. M., with a date of priority of March 19, 1941.

The applicant herein, owner of the water right above described, proposes to change the place of use for domestic supply for 7 families located within the SE $\frac{1}{4}$  NW $\frac{1}{4}$ , Section 10, Township 33 South, Range 2 East, W. M., without loss of priority to domestic use of 3 families located within the NE $\frac{1}{4}$  SW $\frac{1}{4}$ , said Section 10, and 2 families located partially within the SE $\frac{1}{4}$  NW $\frac{1}{4}$  and partially within the NE $\frac{1}{4}$  SW $\frac{1}{4}$ , said Section 10.

Notice by publication as provided by ORS 540.520 was not given in connection with this application for the reason said section provides notice is not required on an application for a change in place of use of water only.

Mr. David C. Mendrix, Watermaster of District No. 13, has filed a report to the effect that the proposed change in place of use may be made without injury to existing rights.

No objections having been filed and it appearing that the proposed change in place of use may be made without injury to existing rights, the application should be approved.

NOW, THEREFORE, it hereby is ORDERED that the proposed change in place of use of water be and the same is approved and that the water right hereinbefore described as being for the domestic use of 7 families in the SE $\frac{1}{4}$  NW $\frac{1}{4}$ , Section 10, Township 33 South, Range 2 East, W. M., with a date of priority of March 19, 1941, be severed therefrom and simultaneously and without loss of priority transferred to the domestic use of 5 families located within the NE $\frac{1}{4}$  SW $\frac{1}{4}$ , said Section 10, and 2 families located partially within the SE $\frac{1}{4}$  NW $\frac{1}{4}$  and partially within the NE $\frac{1}{4}$  SW $\frac{1}{4}$ , said Section 10.

It is FURTHER ORDERED that the change in place of use shall be completed on or before October 1, 1963, or within such extension of time as may be granted by the State Engineer for good cause shown.

It is FURTHER ORDERED that upon receipt of proof satisfactory to the State Engineer of the complete application of water to beneficial use on the lands to which the water is transferred hereby, certificate of water right shall be issued to Olson-Lawyer Lumber, Inc. to the extent to which the water has been applied beneficially and the certificate of water right heretofore issued to Ross Lumber Company and recorded at page 27741, Volume 19, State Record of Water Right Certificates, shall be canceled.

Dated at Salem, Oregon, this 2nd day of July, 1962.

/s/ CHRIS L. WHEELER  
State Engineer



DESCRIPTION OF WORKS

9. (a) If a dam has been constructed, give description: Height, 5 ft.; length on top, 25 ft.; length on bottom 20 ft.; material used and character of construction, poles, rock & dirt. This is dam on Mill Creek.

(b) Give description of headgate: Width, 5 ft.; depth, 3 ft.; material used and character of construction, lumber

(c) Size of canal: Width on top (at waterline) 5 ft.; width on bottom, 3.5 ft.; depth of water, 1.5 ft.; grade, 3 ft. fall per 1,000 ft. Actual capacity, sec.-ft. Give general description: This is Nye Ditch which carries water for irrigation under several permits.

(d) Pipe line: Description of intake, Length of pipe, 350 ft.; size at intake, 3 in.; size at 350 ft. from intake, 3 in.; size at place of use, 3 in. Difference in elevation between intake and place of use, 15 ft. Is grade uniform? No Actual capacity of pipe line, sec.-ft. Give general description: This pipe runs from a 3600 gal. wooden service tank to boiler; all wrought iron. (Material: Steel, wrought, cast iron, wood stave, etc.)

(e) Pumping plant: Give size and type of pump, injection pump at boiler. Suction lift, ft.; discharge lift, ft. Type of motor used Horse power rating, H. P. Actual capacity of pump, sec.-ft.

10. During what months is water beneficially used? Entire year.

11. State character of soil Kind of crops raised

12. Does the accompanying map, filed with your application, show correctly the point of diversion, area of land irrigated, or place of use? Yes

13. If not, wherein is such map in error? O.K.

14. Domestic use: Give number of families actually using water at this time

15. If for power, mining, municipal, manufacturing, storage or any other purpose than irrigation, give extent and method of such use



**AFFIDAVIT OF APPROPRIATOR**

STATE OF OREGON,

County of Jackson

} ss.

I, E. W. Pease, Sec'y-Treas. for the Geo. L. Jantzer Lbr. Co. Inc., being first duly sworn, deposit and say that I have read the above and foregoing proof of appropriation of water; that I know the contents thereof, and that the facts therein stated are true.

IN WITNESS WHEREOF, I have hereunto set my hand this \_\_\_\_\_ day of \_\_\_\_\_, 194\_\_\_\_\_

E. W. Pease

Subscribed and sworn to before me this 25 day of April, 1942

D. B. Newman

Notary Public for Oregon

My commission expires 3/4/45

[Notarial Seal]

**AFFIDAVIT OF WITNESSES**

STATE OF OREGON,

County of Jackson

} ss.

We, Howard W. Mather, and Dorothy Fairchild

of Prospect, being first duly sworn, depose and say that

we are well acquainted with the facts and conditions set forth in the foregoing statement relative to proof of appropriation of water under Permit No. 14809; that we and each of us have been over and upon each tract described in said proof, and from such personal inspection have knowledge that all necessary ditches, dams and other diversion and distributing works have been constructed, and water used as stated therein; that we have carefully read such proof of appropriation, and that each and every statement contained therein is true to the best of our knowledge and belief.

x Howard W. Mather

x Dorothy Fairchild

Subscribed and sworn to before me this 25 day of April, 1942

D. B. Newman

Notary Public for Oregon

My commission expires 3/4/45

[Notarial Seal]

**REPORT OF PERSON MAKING INSPECTION**

(For use by representative of State Engineer)

I, *Arthur L. Smith*, do hereby certify that I have made an inspection of the works described herein and in Permit No. 14809, on the 21 day of Apr, 1942, and found the foregoing statements and descriptions of works to be accurate. In my opinion the appropriation has been completed to the extent of 1.00 c.f.s. and I recommend the issuance of water right certificate for this amount.

(Quantity of water in second-feet or acre-feet)

**NOTICE TO INSPECTORS**

If conditions do not justify the above report by you, please return the proof without your signature, with a full report by letter.

*Arthur L. Smith*  
(Name)  
Water Master Dist 15  
(Title)

**PROOF OF APPROPRIATION**

Permit No. ....

Recording fee paid

Receipt No. ....

**RECEIVED**  
APR 27 1942  
STATE ENGINEER  
SALEM, OREGON



STATE PRINTING DEPT.

10

TOWNSHIP 33 S, RANGE 2 E, W. M.

North

West

East

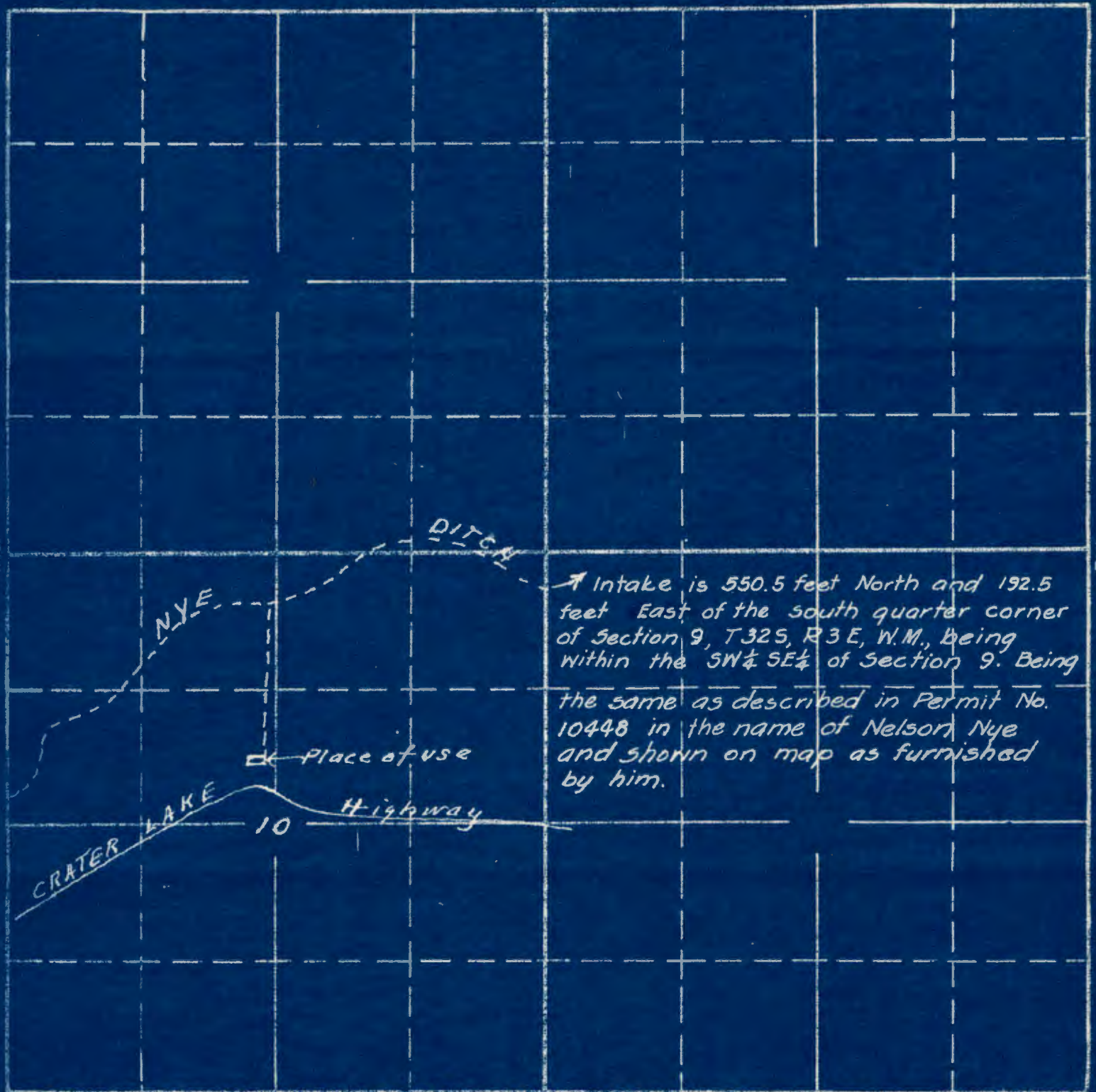

Intake is 550.5 feet North and 192.5 feet East of the south quarter corner of Section 9, T32S, R3E, W.M., being within the SW $\frac{1}{4}$  SE $\frac{1}{4}$  of Section 9. Being the same as described in Permit No. 10448 in the name of Nelson Nye and shown on map as furnished by him.

Place of use

CRATER LAKE  
10 Highway

South

To accompany application of George L. Jantzer Corp. to appropriate waters of Mill Creek for manufacturing purposes (Mill pond and steam boiler)

19216 00  
15-78  
APPLICATION No. 19216  
PERMIT No. 14899

This office 3/12/41

C.A. Smith, Watermaster, Dist #15

9/21/11 - 10/1/11  
500  
500

Could you get me  
the return - 10/1/11

Fine print on  
but double in 10/1/11



RECEIVED  
MAY 11 1942  
STATE ENGINEER  
SALEM, OREGON

STATE OF OREGON  
COUNTY OF JACKSON

ABSTRACT OF CERTIFICATE OF WATER RIGHT NO. 14350<sup>41</sup>

GEO. L. JANTZER LUMBER CO., INC. of Prospect,  
State of Oregon, has made proof to the satisfaction of  
the State Engineer of Oregon, of a right to the use of the waters of  
Mill Creek, tributary of North Fork Rogue River,  
a tributary of Rogue River, for the purpose of  
Steam Boiler and Mill Pond  
under Permit No. 14809 of the State Engineer, and that said right to the use  
of said waters has been perfected in accordance with the laws of Oregon;  
that the priority of the right hereby confirmed dates from  
March 19, 1941  
that the amount of water to which such right is entitled and hereby con-  
firmed, for the purposes aforesaid, is limited to an amount actually bene-  
ficially used for said purposes, and shall not exceed  
1.0 c.f.s., being 0.60 c.f.s. for steam boiler and 0.40 c.f.s. for mill pond,  
or its equivalent in case of rotation . . .  
The point of diversion is located in the  
SW $\frac{1}{4}$  SE $\frac{1}{4}$ , Sec. 9, T. 32 S., R. 3 E., W. M.

The amount of water used for irrigation, together with the amount  
secured under any other right existing for the same lands shall be limited  
to of one cubic foot per second per acre,

and shall conform to such reasonable rotation system as may be ordered by  
the proper state officer.

A description of the place of use under the right hereby confirmed,  
and to which such right is appurtenant, is as follows:

SE $\frac{1}{4}$  NW $\frac{1}{4}$ , Section 10,  
T. 33 S., R. 2 E., W. M.

The right to the use of water for the purposes aforesaid is  
restricted to the lands or place of use herein described.

REMARKS:

*Ok.*

*Clinton A. Smith*  
Watermaster

(Make any further remarks on reverse side)

February 8, 1960

Mr. Paul <sup>W.</sup> Doe, Manager  
Ross Lumber Company, Inc.  
P. O. Box 847  
Medford, Oregon

Dear Mr. Doe:

With reference to your letter of February 3, 1960, a search of our records reveals that there is no reservoir right in the area described. There is a secondary permit which has since been certified for the George L. Jantzer Lumber Co. to appropriate water from Mill Creek for the maintenance of a log pond and for domestic flow. At the time the Jantzer Lumber Co. perfected their right this office did not require a reservoir permit for certain log ponds and industrial dams.

In the event you enlarge your log pond a filing for that log pond will be necessary as well as a secondary application for the use of the excess storage. For your convenience I enclose a copy of the Rules and Regulations of the State Engineer pertaining to surface water, an application for the appropriation of the waters of Oregon, and an application for the construction of a reservoir.

Very truly yours,

LEWIS A. STANLEY  
State Engineer

By  
A. M. Petaka  
Engineer

AMP:mb  
enc

WATER RESOURCES DEPARTMENT  
STATE OF OREGON  
OFFICE OF  
WATER DISTRICT NO. 15  
MEDFORD, OREGON

Apr 22, 1942

RECEIVED  
MAY 1 1942  
STATE ENGINEER  
SALEM, OREGON

Mr. Charles E. Stricklin  
State Engineer  
Salem, Oregon

Dear Sir:

I have this date, Apr 21, 1942, examined the land and water right of George L. Santzer Co. Inc. of Jackson County, Oregon, under Application No. 19216 Permit No. 14809, to the waters of Mill Creek Trib N. Fork, Rogue River for final proof, and find the same correct as to the use of water, description of lands, and number of acres irrigated, as noted by me on the final proof papers.

Sent to Geol Santzer Co. Inc.

Address Prospect Ore Date 4/22/42

Very truly yours,

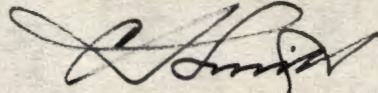

CLINTON A. SMITH  
Watermaster, Dist. No. 15



April 14, 1942

Mr. Clinton A. Smith  
Watermaster District No. 15  
Medford, Oregon

Dear Mr. Smith:

I am enclosing a blank for making final proof  
under Permit No. 14809 in the name of Geo. J. Jantser  
Lumber Co., Inc.

You are requested to make your usual inspection  
at your convenience and submit the proof to this office  
with the \$1.00 certificate recording fee.

Very truly yours,

CHAS. E. STRICKLIN  
State Engineer

By

Ed K. Humphrey, Assistant

LD  
Enc.

April 14, 1942

Geo. L. Jantzer Lumber Co., Inc.  
Prospect, Oregon

ATTENTION: Mr. E. W. Pease, Sec.-Treas.

Gentlemen:

This acknowledges receipt of Forms A, B and C, being notices of beginning and completion of construction and complete application of water under your Permit No. 14809.

Pursuant to your reports, and in line with the general practice of this office, a survey will be made at a later date for the purpose of checking the amount of water used as described in the permit. After this survey, proof may be made by you and certificate issued covering the actual use of water as found by the inspector.

In the meantime, the permit which you hold will be valid and sufficient evidence of your water right.

Very truly yours,

CHAS. E. STRICKLIN  
State Engineer

By

Ed K. Humphrey, Assistant

LD

19216

May 12, 1941

Geo. L. Jantzer Lumber Co., Inc.  
Prospect, Oregon

ATTENTION: Mr. E. W. Pease, Sec.-Treas.

Gentlemen:

Herewith you will find Application No. 19216, Permit No. 14809, together with blue print.

The application has been approved and recorded in this office.

March 25, 1941

Mr. E. W. Pease, Sec'y-Treas.  
Geo. L. Jantzer Lumber Company  
Prospect, Oregon

Dear Mr. Pease:

This acknowledges receipt of your application for a permit to appropriate 1 second-foot of water from Mill Creek for use in steam boiler and mill pond, together with your remittance in the amount of \$10.10 for which Receipt No. 27348 is enclosed.

The application, which has been checked over, has been filed and given No. 19216. It appears to be in satisfactory form and is being placed in line for approval and issuance of a permit.

Very truly yours,

CHAS. E. STRICKLIN  
State Engineer

By

Ed K. Humphrey, Assistant

RE  
enc.1