

T.9S. R.6W. W.M.

POLK COUNTY

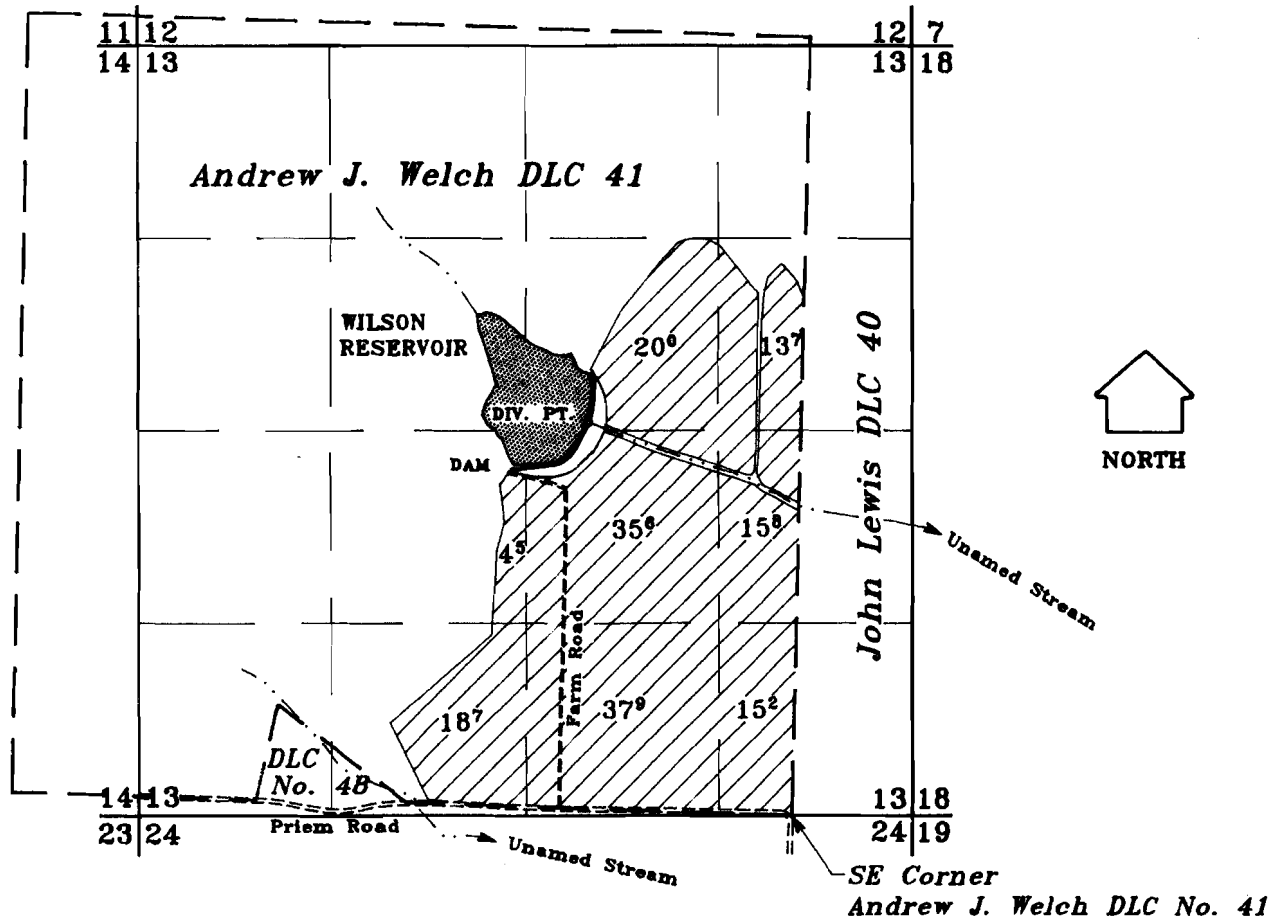

Diversion Point: 2696' North and 1388' West of  
SE Corner Andrew J. Welch DLC No. 41.

R-73432	R-11493
S-73433	S-51528
R-74221	R-11702
Application No. <u>S-74220</u>	Permit No. <u>S-52023</u>

# FINAL PROOF SURVEY

**RECEIVED**

IN NAME OF

Peter Dinsdale

OCT 02 1998

SEPTEMBER 24, 1998

WATER RESOURCES DEPT.  
SALEM, OREGON

SCALE 1" = 1320'

NOTE: This map is for the purpose of identifying the location of water rights and has not intent to dimension or locate property ownership lines.

