

Appendix A

Diversion Map

and

Pipeline Conduit Map

S 22, T6N, R38E, WM, OREGON

1"=500'

DATE OF SURVEY: 7-30-01

NORTHWEST SECTION CORNER
FOUND 3" BLM BRASSCAP

POINT OF BEGINNING
NORTH 1/4 CORNER
FOUND 3" BLM BRASSCAP

ANGLE POINT

16 15

15
WEST
199'

21 22

POINT OF DIVERSION
LOCATED IN THE
NE1/4 OF THE NW1/4
15 199' WEST AND
470' SOUTH OF THE
POINT OF BEGINNING

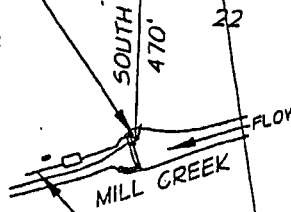

CONVEYANCE: 3' DIA. PIPE

NW1/4-NW1/4
SEC. 22

TAX LOT# 200
NE1/4-NW1/4
SEC. 22



SW1/4-NW1/4
SEC. 22

SE1/4-NW1/4
SEC. 22

WEST 1/4 CORNER
FOUND 3" BLM BRASSCAP

21 22

PLACE OF USE: CITY OF WALLA WALLA
URBAN GROWTH BOUNDARY.

THE PURPOSE OF THIS MAP IS TO
IDENTIFY THE LOCATION OF THE
WATER RIGHT. IT IS NOT INTENDED
TO PROVIDE INFORMATION RELATIVE
TO THE LOCATION OF PROPERTY
OWNERSHIP BOUNDARY LINES.

APPLICATION FILE # 5-84679

RECEIVED

OCT 05 2001

WATER RESOURCES DEPT.
SALEM, OREGON

PERMIT #

anderson
perry
associates, inc.

CITY OF
WALLA WALLA
MILL CREEK WATER DIVERSION POINT
STATE OF OREGON SURFACE WATER RIGHT
APPLICATION MAP

FIGURE

1

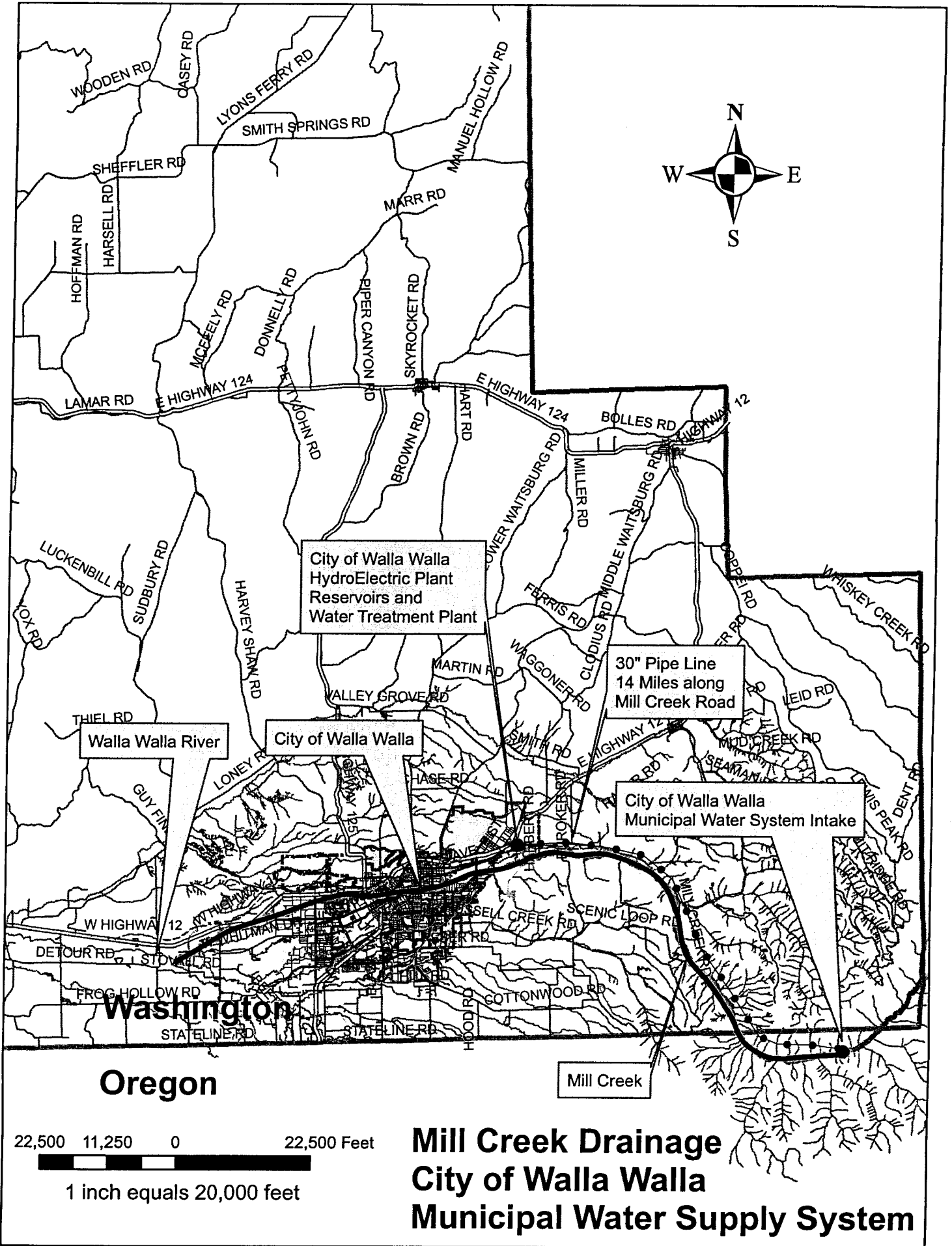
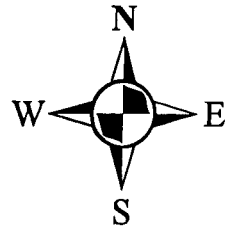

Mill Creek Drainage City of Walla Walla Municipal Water Supply System