

JACK CRIDER PORT OF TILLAMOOK BAY  
RACCOON CR, A TRIBUTARY OF TILLAMOOK R

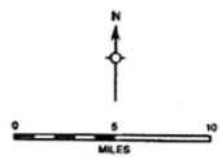
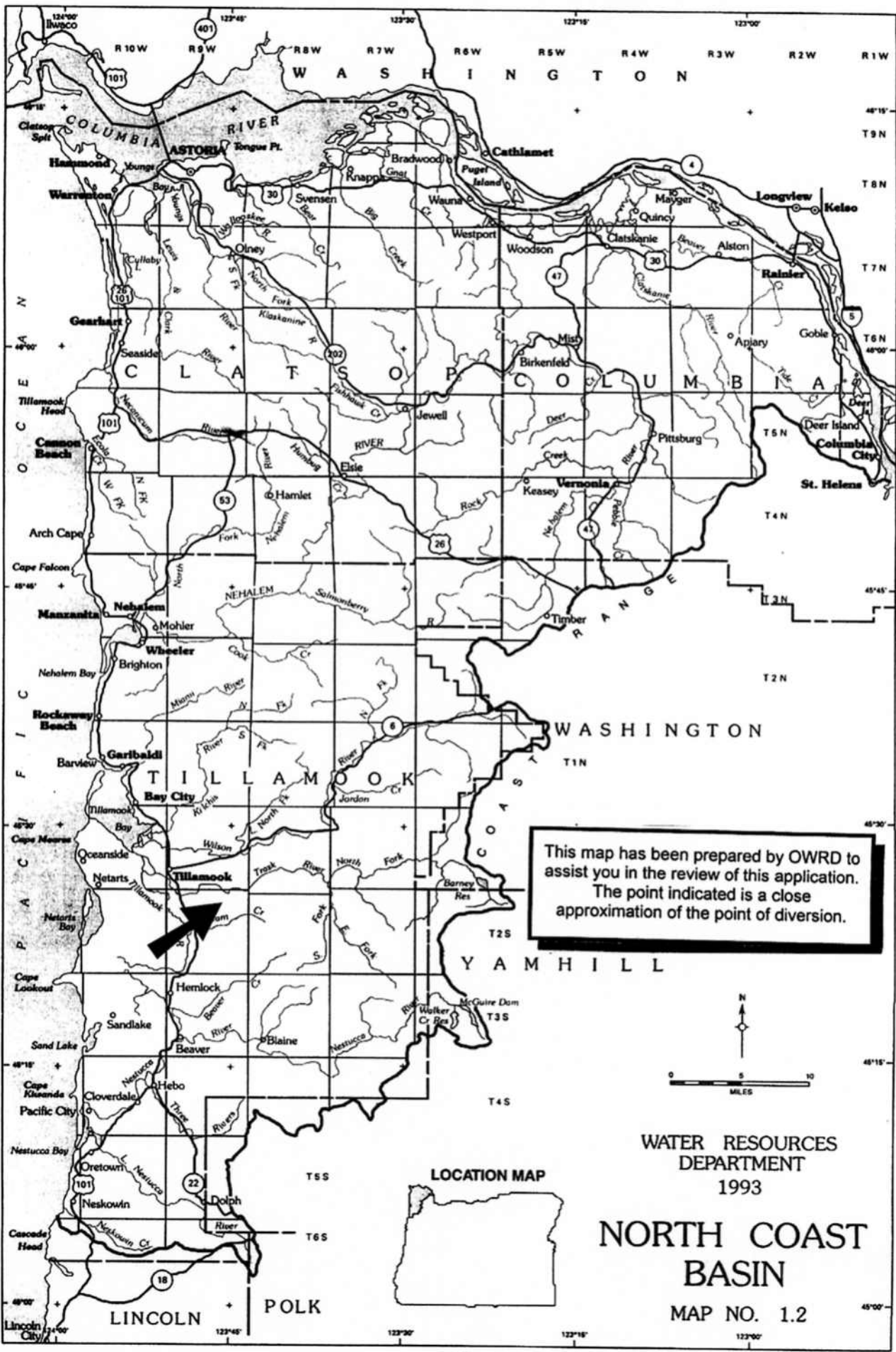

WATER RESOURCES  
DEPARTMENT  
1993

NORTH COAST  
BASIN

MAP NO. 1.2

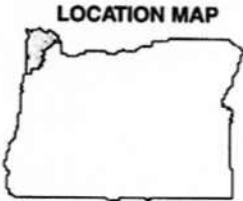

**RESERVOIR APPLICATION MAP**  
 FOR THE PORT OF TILLAMOOK BAY  
 LOCATED IN SECTIONS 4, 5, 8, 9, 16 & 17,  
 TOWNSHIP 2 SOUTH, RANGE 9 WEST  
 TILLAMOOK COUNTY, OREGON  
 JULY 5, 2005



**RECEIVED**  
 JUL 07 2005  
 WATER RESOURCES DEPT  
 SALEM, OREGON

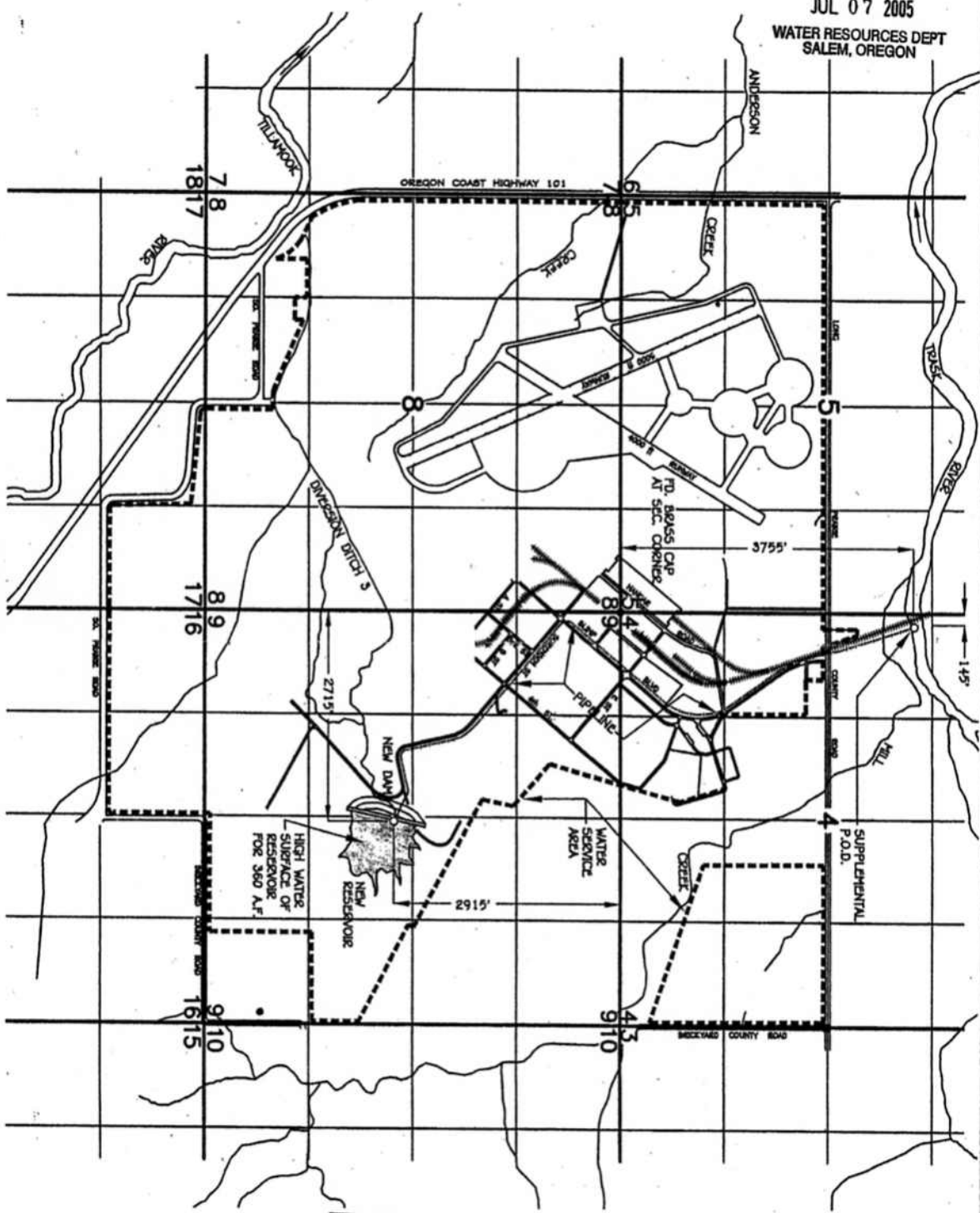

**RECEIVED**  
 JUL 14 2005  
 WATER RESOURCES DEPT  
 SALEM, OREGON

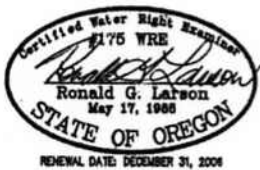

THE PURPOSE OF THIS MAP IS TO IDENTIFY THE LOCATION OF THE WATER RIGHT. IT IS NOT INTENDED TO PROVIDE INFORMATION RELATIVE TO THE LOCATION OF PROPERTY OWNERSHIP BOUNDARY LINES.

M050066-01-03.DWG

**HLB & Associates**  
**INCORPORATED**  
 Surveying • Civil Engineering • Planning • Water Rights • Wetlands Consulting

CLATSOP COUNTY	PACIFIC COUNTY	TILLAMOOK COUNTY
4253-A HWY 101 N. GRESHAM, OR 97130	1715-S N. PACIFIC AVE. LONG BEACH, WA 98631	180 LANEDA AVE. MANZANITA, OR 97130
(503) 736-3425	(360) 842-4454	(503) 368-3344
FAX: (503) 736-7495	FAX: (360) 842-4054	FAX: (503) 368-3047

WWW.HLBINC.COM

appro B 86378 permit no