

STATE OF OREGON
GEOTECHNICAL HOLE REPORT
 (as required by OAR 690-240-035)

(1) OWNER/PROJECT: Hole Number GP-02-08
 Name Oregon Department of Transportation
 Address 3012 Island Ave.
 City La Grande State OR Zip 97850

(2) TYPE OF WORK
 New Deepening Alteration (repair/recondition) Abandonment

(3) CONSTRUCTION:
 Rotary Air Hand Auger Hollow Stem Auger
 Rotary Mud Cable Tool Push Probe Other _____

(4) TYPE OF HOLE:
 Uncased Temporary Cased Permanent
 Uncased Permanent Slope Stability Other _____

(5) USE OF HOLE: HazMat Investigation

(6) BORE HOLE CONSTRUCTION:
 Special Construction approval Yes No Depth of Completed Hole 4.0 ft.

HOLE			SEAL			
Diameter	From	To	Material	From	To	Sacks or pounds
2.5"	0.0'	4.0'				

Backfill placed from 0 ft. to 4.0 ft. Material Bentonite chips
 Filter Pack placed from _____ ft. to _____ ft. Size of pack _____

(7) CASING/SCREEN:

	Diameter			Gauge	Steel			Plastic			Welded			Threaded		
	From	To														
Casing:					<input type="checkbox"/>	<input type="checkbox"/>	<input type="checkbox"/>	<input type="checkbox"/>	<input type="checkbox"/>	<input type="checkbox"/>	<input type="checkbox"/>	<input type="checkbox"/>	<input type="checkbox"/>	<input type="checkbox"/>	<input type="checkbox"/>	<input type="checkbox"/>
Screen:					<input type="checkbox"/>	<input type="checkbox"/>	<input type="checkbox"/>	<input type="checkbox"/>	<input type="checkbox"/>	<input type="checkbox"/>	<input type="checkbox"/>	<input type="checkbox"/>	<input type="checkbox"/>	<input type="checkbox"/>	<input type="checkbox"/>	<input type="checkbox"/>

Slot size: _____

(8) WELL TEST:
 Pump Bailer Air Flowing Artesian
 Permeability _____ Yield _____ GPM _____
 Conductivity _____ PH _____
 Temperature of water _____ °F/C Depth artesian flow found _____ ft.
 Was water analysis done? Yes No

By whom? _____
 Depth of strata analyzed. From _____ ft. to _____ ft.
 Remarks: _____

(9) LOCATION OF HOLE by legal description:
 County Baker Latitude _____ Longitude _____
 Township 9 S N or S Range 40 E E or W WM.
 Section 20 NE 1/4 _____ 1/4
 Tax Lot _____ Lot _____ Block _____ Subdivision _____
 Street Address of Well (or nearest address) _____

Map with location identified must be attached

(10) STATIC WATER LEVEL:
 n/a _____ ft. below land surface. Date _____
 Artesian pressure _____ lb. per square inch. Date _____

(11) SUBSURFACE LOG:
 Ground Elevation _____

Material Description	From	To	SWL
Silty Gravel (Fill)	0.0'	1.6	
Silty Sand	1.6	4.0'	

Date Started 10/22/02 Date Completed 10/22/02

(12) ABANDONMENT LOG:

Material Description	From	To	Sacks or Pounds
Asphalt Cap	0.0'	0.3'	
Bentonite	0.3'	4.0'	10 lbs.
RECEIVED			
NOV 04 2002			
WATER RESOURCES DEPT. SALEM, OREGON			

Date started 10/22/02 Date Completed 10/22/02

Professional Certification
 (to be signed by a licensed water supply or monitoring well constructor, or registered geologist or civil engineer).

I accept responsibility for the construction, alteration, or abandonment work performed during the construction dates reported above. All work performed during this time is in compliance with Oregon's geotechnical hole construction standards. This report is true to the best of my knowledge and belief

Signed Jay Van Houten License or Registration Number CEG014
 Date 10/29/02
 Affiliation OR Dept. of Transportation

ADVANCE COPY
PROJECT TO CHANGE
DATE: 11/04/2002

Sec. 20, T. 9 S., R. 40 E., W.M.
BAKER CITY

Geoprobe Boring Locations
GP-02-01 Through GP-02-09

RECEIVED
NOV 04 2002
WATER RESOURCES DEPT
SALEM, OREGON

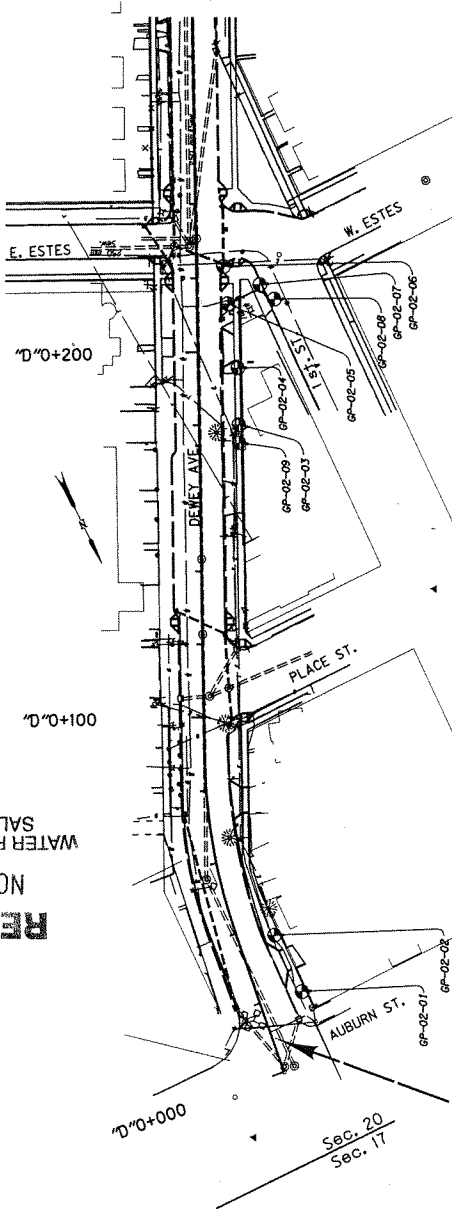

BEGINNING OF PROJECT
STA. 7D0+010

Sec. 20
Sec. 17

All Dimensions Are In Feet (m)
Unless Otherwise Noted.

OREGON DEPARTMENT OF TRANSPORTATION
ROADWAY ENGINEERING SECTION

DEWEY AVE. (BAKER CITY) SEC.
WHITNEY & LA GRANDE - BAKER CITY HIGHWAYS
BUSH COUNTY

Design Team Leader - Thomas G. Wallace
Designed By - Richard W. Thompson
Drafted By - Robert P. Kuchler

DATE: 11/04/2002

VIEW 1

29-OCT-2002 15:12
11/04/2002 15:12