

STATE OF OREGON
WATER SUPPLY WELL REPORT
(as required by ORS 537.765 & OAR 690-205-0210)

APR 14 2014

SALEM, OR

WELL LABEL # L 107450

START CARD # 1021143

(1) LAND OWNER Owner Well I.D. _____

First Name David Last Name Blatchford
Company Blatchford Farms Inc.
Address 44857 Brown rd
City Baker City State OR Zip 97814

(2) TYPE OF WORK New Well Deepening Conversion
 Alteration (repair/recondition) Abandonment

(3) DRILL METHOD
 Rotary Air Rotary Mud Cable Auger Cable Mud
 Reverse Rotary Other _____

(4) PROPOSED USE Domestic Irrigation Community
 Industrial/ Commercial Livestock Dewatering
 Thermal Injection Other _____

(5) BORE HOLE CONSTRUCTION Special Standard Attach copy) Depth of Completed Well 600 ft.

BORE HOLE			SEAL			Amt	sacks/ lbs
Dia	From	To	Material	From	To		
17.5	0	604	Bentonite	0	3	6	
12.25	604	650	Cement	3	240	190	S

How was seal placed: Method A B C D E
 Other _____

Backfill placed from 604 ft. to 605 ft. Material cuttings
Filter pack from 240 ft. to 600 ft. Material Pea gravel Size pea gravel
Explosives used: Yes Type _____ Amount _____

(6) CASING/LINER

Casing	Liner	Dia	+	From	To	Gauge	Stl	Plstc	Wld	Thrd
<input checked="" type="checkbox"/>	<input checked="" type="checkbox"/>	12		1	250	.375	<input checked="" type="checkbox"/>	<input checked="" type="checkbox"/>	<input checked="" type="checkbox"/>	<input type="checkbox"/>
<input type="checkbox"/>	<input type="checkbox"/>	12		290	298	.375	<input type="checkbox"/>	<input type="checkbox"/>	<input checked="" type="checkbox"/>	<input type="checkbox"/>
<input type="checkbox"/>	<input type="checkbox"/>	12		350	448	.375	<input type="checkbox"/>	<input type="checkbox"/>	<input checked="" type="checkbox"/>	<input type="checkbox"/>
<input type="checkbox"/>	<input type="checkbox"/>	12		520	540	.375	<input type="checkbox"/>	<input type="checkbox"/>	<input checked="" type="checkbox"/>	<input type="checkbox"/>
<input type="checkbox"/>	<input type="checkbox"/>	12		580	600	.375	<input type="checkbox"/>	<input type="checkbox"/>	<input checked="" type="checkbox"/>	<input type="checkbox"/>

Shoe Inside Outside Other Location of shoe(s) _____
Temp casing Yes Dia _____ From _____ To _____

(7) PERFORATIONS/SCREENS

Perforations Method _____
Screens Type wire wrap Material 304SS

Perf/S	Casing/Screen	Liner	Dia	From	To	Sern/slot width	Slot length	# of slots	Tele/pipe size
Screen	Liner	12	250	290	100				12
Screen	Liner	12	298	350	100				12
Screen	Liner	12	448	520	100				12
Screen	Liner	12	540	580	100				12

(8) WELL TESTS: Minimum testing time is 1 hour

<input checked="" type="radio"/> Pump	<input type="radio"/> Bailer	<input type="radio"/> Air	<input type="radio"/> Flowing Artesian
Yield gal/min	Drawdown	Drill stem/Pump depth	Duration (hr)
975	240	250	1
950	242	250	2
900	244	250	4

Temperature 57 °F Lab analysis Yes By _____
Water quality concerns? Yes (describe below)

From	To	Description	Amount	Units

(9) LOCATION OF WELL (legal description)

County BAKER Twp 8 S N/S Range 39 E E/W WM
Sec 17 NE 1/4 of the SE 1/4 Tax Lot 300
Tax Map Number _____ Lot _____
Lat _____ " or 44.868385 DMS or DD
Long _____ " or 117.954086 DMS or DD
 Street address of well Nearest address

1/8 mile west of the intersection of Brown rd and Poleline rd.

(10) STATIC WATER LEVEL

Existing Well / Predeepening	Date	SWL(psi)	+ SWL(ft)
Completed Well	<u>02-12-2014</u>		<u>78</u>

Flowing Artesian? Dry Hole?

WATER BEARING ZONES

Depth water was first found 250

SWL Date	From	To	Est Flow	SWL(psi)	+ SWL(ft)
<u>02-12-2014</u>	<u>250</u>	<u>370</u>	<u>450</u>		<u>78</u>
<u>02-12-2014</u>	<u>444</u>	<u>580</u>	<u>450</u>		<u>78</u>

(11) WELL LOG

Ground Elevation 3,441

Material	From	To
Top soil	0	4
Clay bound gravels and cobbles	4	12
Brown clay with some gravels	12	109
Sand and gravel with some clay seams	109	350
Brown clay with some gravels	350	446
Sand gravels with small clay seams	446	526
Grey clay	526	544
Gravels with small clay seams	544	578
Grey clay	578	650

Date Started 10-18-2013 Completed 02-12-2014

(unbonded) Water Well Constructor Certification

I certify that the work I performed on the construction, deepening, alteration, or abandonment of this well is in compliance with Oregon water supply well construction standards. Materials used and information reported above are true to the best of my knowledge and belief.

License Number _____ Date _____
Password : (if filing electronically) _____
Signed _____

(bonded) Water Well Constructor Certification

I accept responsibility for the construction, deepening, alteration, or abandonment work performed on this well during the construction dates reported above. All work performed during this time is in compliance with Oregon water supply well construction standards. This report is true to the best of my knowledge and belief.

License Number 1937 Date 04-10-2014
Password : (if filing electronically) _____
Signed [Signature]
Contact Info (optional) 509-773-4085

(5) BORE HOLE CONSTRUCTION

BORE HOLE

Dia	From	To	Material	SEAL	From	To	Amt	sacks/ lbs

FILTER PACK

From	To	Material	Size
240	600	Pea Gravel	pea gravel

(6) CASING/LINER

Casing	Liner	Dia	+	From	To	Gauge	Stl	Plstc	Wld	Thrd

(7) PERFORATIONS/SCREENS

Perf/S	Casing/	Screen	From	To	Scrn/slot	Slot	# of	Tele/
creen	Liner	Dia			width	length	slots	pipe size

(8) WELL TESTS: Minimum testing time is 1 hour

Yield gal/min	Drawdown	Drill stem/Pump depth	Duration (hr)

Water Quality Concerns

From	To	Description	Amount	Units

(10) STATIC WATER LEVEL

Water Bearing Zones

SWL Date	From	To	Est Flow	SWL(psi)	+	SWL(ft)

(11) WELL LOG

Material	From	To

Comments/Remarks

Note: Bottom of borehole was filled with cuttings during reaming. We then pumped cement and formed a plug inside the liner from 598' to 604'.

Map of well

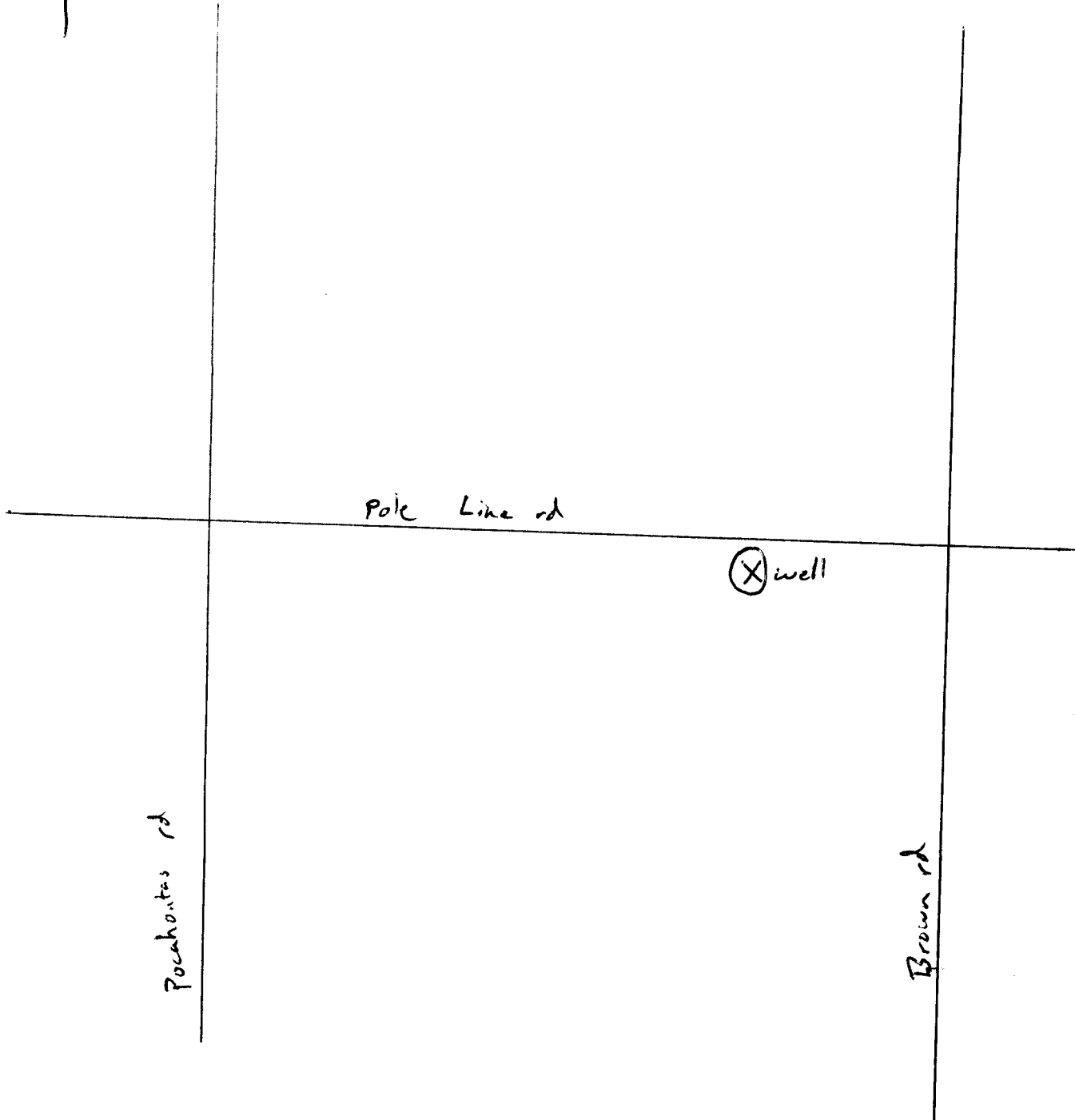

RECEIVED BY OWRD

APR 14 2014

SALEM, OR