

STATE ENGINEER  
Salem, Oregon

*Bent  
1651*

# Well Record

STATE WELL NO. 10/3W-32L  
COUNTY Benton  
APPLICATION NO. GR-1344

GR- 1300

OWNER: Urie E. Kenagy

MAILING ADDRESS: Rt. 4, Box 600

LOCATION OF WELL: Owner's No. #2

CITY AND STATE: Albany, Oregon

NE 1/4 SW 1/4 Sec. 32 T. 10 S., R. 3 W., W.M.

Bearing and distance from section or subdivision corner 600' E. & 2000' N. from SW cor. Sec. 32.

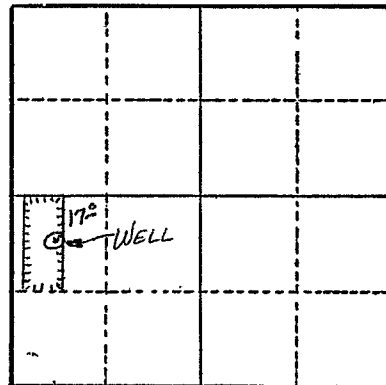

Section 32

Altitude at well 185 ft.

TYPE OF WELL: Dug Date Constructed 1938

Depth drilled 18 ft. Depth cased 18 ft.

### CASING RECORD:

2 1/2 x 2 1/2 ft. wood

### FINISH:

### AQUIFERS:

### WATER LEVEL:

10 ft.

PUMPING EQUIPMENT: Type Pacific 2 in. Cent. H.P. 7 1/2

Capacity 168 G.P.M.

### WELL TESTS:

Drawdown 8 ft. after 168 hours G.P.M.

Drawdown ft. after hours G.P.M.

USE OF WATER Irrigation Temp. °F. 19

SOURCE OF INFORMATION G. R. Record

DRILLER or DIGGER

### ADDITIONAL DATA:

Log N.A. Water Level Measurements Chemical Analysis Aquifer Test

### REMARKS:

Irrigation of 17 acres.