

(1) OWNER:  
Name City of Milwaukie  
Address Milwaukie, Oregon

(2) LOCATION OF WELL:  
County Clackamas Owner's number, if any— 4  
1/4 Section T. R. W.M.  
Bearing and distance from section or subdivision corner

TYPE OF WORK (check):  
New Well  Deepening  Reconditioning  Abandon   
If abandonment, describe material and procedure in Item 11.

(4) PROPOSED USE (check): (5) TYPE OF WELL:  
Domestic  Industrial  Municipal  Rotary  Driven   
Irrigation  Test Well  Other  Cable  Jetted   
Dug  Bored

(6) CASING INSTALLED:  
16 " Diam. from surface ft. to 304 ft. Gage 3/8" wall  
Threaded  Welded

(7) PERFORATIONS:  
Type of perforator used Star Perforated?  Yes  No  
SIZE of perforations 3/8 in. by 1 1/2 in.  
360 perforations from 283 ft. to 289 ft.  
330 perforations from 276 ft. to 281.5 ft.  
320 perforations from 185 ft. to 198 ft.

SCREENS:  
Well screen installed  Yes  No  
Manufacturer's Name \_\_\_\_\_ Type \_\_\_\_\_ Model No. \_\_\_\_\_  
Diam. \_\_\_\_\_ Slot size \_\_\_\_\_ Set from \_\_\_\_\_ ft. to \_\_\_\_\_ ft.  
In. \_\_\_\_\_ Slot size \_\_\_\_\_ Set from \_\_\_\_\_ ft. to \_\_\_\_\_ ft.

CONSTRUCTION:  
Was well gravel packed?  Yes  No Size of gravel: \_\_\_\_\_  
Gravel placed from \_\_\_\_\_ ft. to \_\_\_\_\_ ft. 93  
Was a surface seal provided?  Yes  No To what depth? \_\_\_\_\_ ft.  
Material used in seal— cement grout  
Did any strata contain unusable water?  Yes  No 26 ft to 46 ft.  
Type of water? \_\_\_\_\_ Depth of strata \_\_\_\_\_  
Method of sealing strata off 20" hole to 93 ft. cemented back to 83 ft.

(10) WATER LEVELS:  
Static level 23 ft. below land surface Date May 12, 1960  
Artesian pressure \_\_\_\_\_ lbs. per square inch Date \_\_\_\_\_

Log Accepted by:  
[Signed] Earl M. Calay Date \_\_\_\_\_, 19\_\_\_\_  
(Owner)

(11) WELL TESTS: Drawdown is amount water level is lowered below static level  
Was a pump test made?  Yes  No If yes, by whom? Strasser Co.  
Yield: 620 gal./min. with 249 ft. drawdown after 8 hrs.  
" 608 " 245 " 8 "  
" 440 " 137 " "  
Ballor test gal./min. with \_\_\_\_\_ ft. drawdown after \_\_\_\_\_ hrs.  
Artesian flow g.p.m. Date \_\_\_\_\_  
Temperature of water 63° Was a chemical analysis made?  Yes  No

(12) WELL LOG: Diameter of well 16 inches.  
Depth drilled 304 ft. Depth of completed well 304 ft.  
Formation: Describe by color, character, size of material and structure, and show thickness of aquifers and the kind and nature of the material in each stratum penetrated, with at least one entry for each change of formation.

MATERIAL	FROM	TO
Topsoil	Surf	3
Gravel and clay	3	26
Loose gravel and sand (water)	26	46
Gravel-clay binder	46	61
Cemented gravel	61	93
Loose gravel	93	96
Cemented gravel	96	130
Gravel with clay binder	130	169
Cemented gravel	169	173
Sandy clay	173	181
Loose gravel and sand (water)	181	195
Cemented gravel	195	274
Loose gravel and sand (water)	274	283
Cemented gravel	283	289
Blue and brown clay	289	294
Pea gravel	294	298
Blue clay	298	304

Work started March 19 1960. Completed May 28 1960

(13) PUMP:  
Manufacturer's Name \_\_\_\_\_  
Type: \_\_\_\_\_ H.P. \_\_\_\_\_

Well Driller's Statement:  
This well was drilled under my jurisdiction and this report is true to the best of my knowledge and belief.  
NAME R. J. Strasser Drilling Co.  
(Person, firm, or corporation) (Type or print)  
Address 8110 SE Sunset Lane, Portland 6, Oregon  
Driller's well number 4018  
[Signed] Robert L. Strasser  
(Well Driller) License No. 10 Date May 28, 1960

CITY OF MILWAUKIE  
LOCATION OF WELL # 4  
JUNE 10 1960  
LEONARD MULLAN CITY-MGR

RECEIVED  
JUN 14 1960  
STATE ENGINEER  
SALEM, OREGON

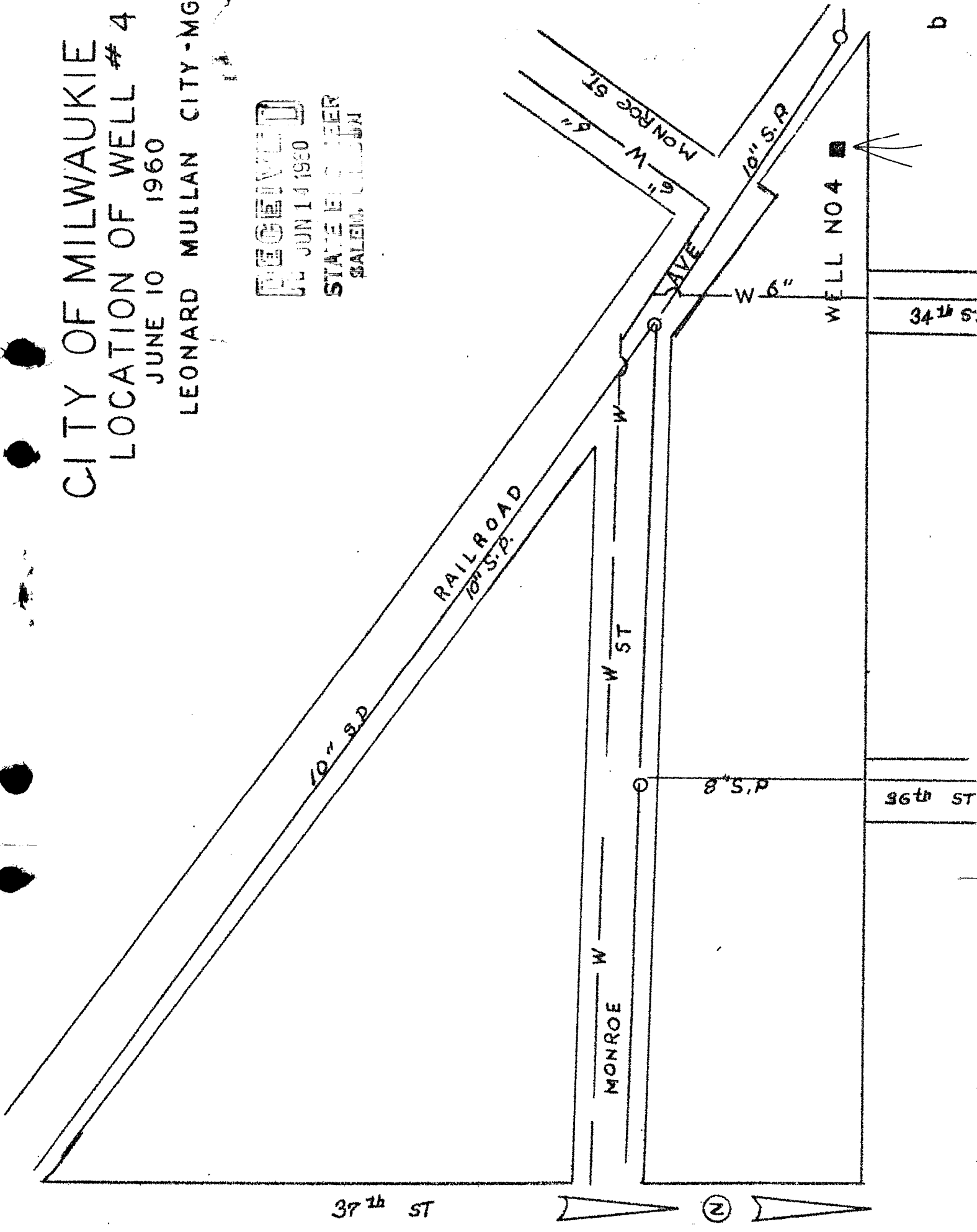

ST FOR WATER BACTERIOLOGICAL EXAMINATION

NAME OF OWNER: **MILW. WATER DEPT.**  
 NAME OF WATER SUPPLY: **MILW. WATER DEPT.**

ADDRESS OF WATER OWNER: **922 MAIN ST. MILW.**  
 DATE COLLECTED: **5/26/60 9:30** HOUR:  A.M.  P.M.

NAME OF COLLECTOR: **KEN RYMAN**

SAMPLING POINT: **WELL** SOURCE: **WELL** COUNTY: **CLATSOP**

CHLORINATED  UNCHLORINATED  MUNICIPAL OR COMMUNITY  PRIVATE  SEMI-PUBLIC

SWIMMING POOL AND BATHING PLACES:  ARTIFICIAL POOL  NATURAL BATHING PLACE

**R.S. SUTHERLAND DRILLING CO.**  
**2110 SE SUNSET BLVD.**  
**PORTLAND OREGON**

PUBLIC HEALTH LABORATORY  
 OREGON STATE BOARD OF HEALTH  
 P. O. Box 231  
 PORTLAND 7, OREGON

LAB. NO. **9619**  
 DATE RECEIVED **5-26-60** DATE REPORTED **5-28-60**  
 SEE BACK OF 1st COPY FOR ADDL. INFO.

VOL.-ML	1	10	10	10	10	10	MPN
24 HOURS							
48 HOURS							

VOL.-ML	10	10	1	1	1	1	1	1	MPN
24 HOURS									
48 HOURS									

CON-FIRMATION:  THIS WATER DOES  CONFORM WITH ACCEPTED STANDARDS OF PURITY.

CHECKED BY: **[Signature]**

FOR USE OF LABORATORY ONLY