

# WATER WELL REPORT

STATE ENGINEER, SALEM, OREGON 97310  
 within 30 days from the date  
 of well completion.

STATE OF OREGON  
 (Please type or print)  
 (Do not write above this line)

State Well No. \_\_\_\_\_  
 State Permit No. \_\_\_\_\_  
 14-11-17?

DESC  
 52898

**(1) OWNER:**  
 Name FRED B. RAMSEY  
 Address SISTERS, ORE.

**(2) TYPE OF WORK (check):**  
 New Well  Deepening  Reconditioning  Abandon   
 If abandonment, describe material and procedure in Item 12.

**(3) TYPE OF WELL:**  
 Rotary  Driven   
 Cable  Jetted   
 Dug  Bored

**(4) PROPOSED USE (check):**  
 Domestic  Industrial  Municipal   
 Irrigation  Test Well  Other

**(5) CASING INSTALLED:**  
 \_\_\_\_\_" Diam. from \_\_\_\_\_ ft. to \_\_\_\_\_ ft. Threaded  Welded   
 6.75" Diam. from 0 ft. to 5.75 ft. Gage \_\_\_\_\_  
 \_\_\_\_\_" Diam. from \_\_\_\_\_ ft. to \_\_\_\_\_ ft. Gage \_\_\_\_\_

**(6) PERFORATIONS:**  
 Type of perforator used \_\_\_\_\_ Perforated?  Yes  No.  
 Size of perforations \_\_\_\_\_ in. by \_\_\_\_\_ in.  
 60 perforations from 5.70 ft. to 5.80 ft.  
 \_\_\_\_\_ perforations from \_\_\_\_\_ ft. to \_\_\_\_\_ ft.  
 \_\_\_\_\_ perforations from \_\_\_\_\_ ft. to \_\_\_\_\_ ft.

**(7) SCREENS:**  
 Well screen installed?  Yes  No  
 Manufacturer's Name \_\_\_\_\_  
 Type \_\_\_\_\_ Model No. \_\_\_\_\_  
 Diam. \_\_\_\_\_ Slot size \_\_\_\_\_ Set from \_\_\_\_\_ ft. to \_\_\_\_\_ ft.  
 Diam. \_\_\_\_\_ Slot size \_\_\_\_\_ Set from \_\_\_\_\_ ft. to \_\_\_\_\_ ft.

**(8) WELL TESTS:**  
 Drawdown is amount water level is lowered below static level  
 Was a pump test made?  Yes  No If yes, by whom? DM  
 Yield: 35 gal./min. with 6" ft. drawdown after 1 hrs.  
 " " " " " " " " " " "  
 " " " " " " " " " " "  
 Bailer test \_\_\_\_\_ gal./min. with \_\_\_\_\_ ft. drawdown after \_\_\_\_\_ hrs.  
 Artesian flow \_\_\_\_\_ g.p.m.  
 Temperature of water 54 Depth artesian flow encountered \_\_\_\_\_ ft.

**(9) CONSTRUCTION:**  
 Well seal—Material used concrete & bentonite  
 Well sealed from land surface to \_\_\_\_\_ ft.  
 Diameter of well bore to bottom of seal \_\_\_\_\_ in.  
 Diameter of well bore below seal \_\_\_\_\_ in.  
 Number of sacks of cement used in well seal \_\_\_\_\_ sacks  
 Number of sacks of bentonite used in well seal \_\_\_\_\_ sacks  
 Kind and name of bentonite \_\_\_\_\_  
 Number of pounds of bentonite per 100 gallons of water \_\_\_\_\_  
 \_\_\_\_\_ lbs./100 gals.  
 Drive shoe used?  Yes  No Plugs \_\_\_\_\_ Size: location \_\_\_\_\_ ft.  
 Do any strata contain unusable water?  Yes  No  
 Name of water? \_\_\_\_\_ depth of strata \_\_\_\_\_  
 Method of sealing strata off \_\_\_\_\_  
 Well gravel packed?  Yes  No Size of gravel: \_\_\_\_\_  
 Gravel placed from \_\_\_\_\_ ft. to \_\_\_\_\_ ft.

**(10) LOCATION OF WELL:**  
 County \_\_\_\_\_ Driller's well number \_\_\_\_\_  
 Section \_\_\_\_\_ T. 14S R. 11E W.M.  
 Bearing and distance from section or subdivision corner \_\_\_\_\_

**(11) WATER LEVEL: Completed well.**  
 Depth at which water was first found 575 ft.  
 Static level \_\_\_\_\_ ft. below land surface. Date \_\_\_\_\_  
 Artesian pressure \_\_\_\_\_ lbs. per square inch. Date \_\_\_\_\_

**(12) WELL LOG:**  
 Diameter of well below casing \_\_\_\_\_ ft.  
 Depth drilled \_\_\_\_\_ ft. Depth of completed well 575 ft.

Formation: Describe color, texture, grain size and structure of materials; and show thickness and nature of each stratum and aquifer penetrated, with at least one entry for each change of formation. Report each change in position of Static Water Level and indicate principal water-bearing strata.

MATERIAL	From	To	SWL
_____ BENTONITE	0	60	
_____ SANDSTONE	60	300	
_____ SANDSTONE	300	375	
_____ SANDSTONE	375	400	310
_____ SANDSTONE	400	492	
_____ SANDSTONE	492	575	
_____ SANDSTONE	575	590	370
_____ SANDSTONE			
_____ SANDSTONE			
_____ SANDSTONE			

Work started 7-15 1967 Completed 7-25 1967  
 Date well drilling machine moved off of well 7-25 1967

**Drilling Machine Operator's Certification:**  
 This well was constructed under my direct supervision. Materials used \_\_\_\_\_ reported above are true to my best knowledge and belief.  
 [Signed] \_\_\_\_\_ Date \_\_\_\_\_, 19\_\_\_\_\_  
 (Drilling Machine Operator)  
 Drilling Machine Operator's License No. \_\_\_\_\_  
 WATER RESOURCES DEPT.  
 SALEM, OREGON

**Water Well Contractor's Certification:**  
 This well was drilled under my jurisdiction and this report is true to the best of my knowledge and belief.  
 Name \_\_\_\_\_ (Type or print)  
 Address \_\_\_\_\_ (Person, firm or corporation)  
 [Signed] \_\_\_\_\_  
 Contractor's License No. \_\_\_\_\_ Date 7-25

RECEIVED

APR 03 2000

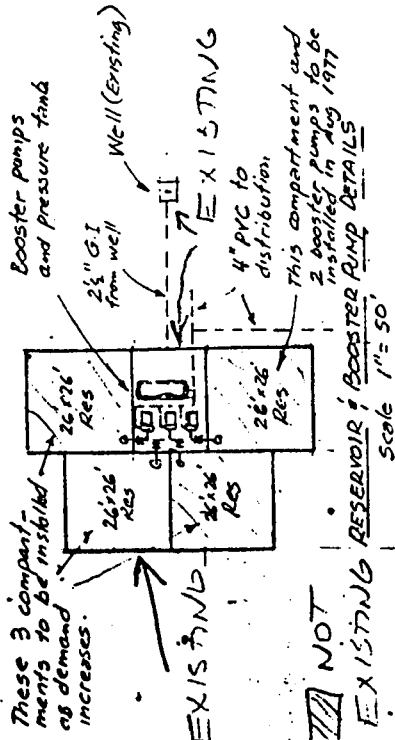

Ground level reservoir

4 compartments, ea 26 x 26 x 7' deep

Each 40,450 gal, total: 161,800 gal

3 booster pumps in adjacent vault

# 1: PACO 1270-1, 15 gpm @ 207', 5 hp

# 2: PACO 1270-5, 85 " @ 185', 12.5 hp

# 3: PACO 250-5, 200 " @ 162', 15 hp

Floor of vault at same level as bottom of res.

Gasoline-engine-driven emergency pump.

30 gpm @ 150 ft.

550-gal pressure tank, steel, 3' x 10'

Well, 590' deep

Drilled July 1967

Reworked Apr 1972

Perforations 570', 590'

Tested 35 gpm w/ 6" DI, 36 ft

Static Water level 870', 200'

3 hp submers 20 gpm @ 310'

Master meter on...

Proposed water lines for First Addition (Approx 130 more lots)

Extent of property owned by Ronald Remund, H & R Construction Co. PO Box 467, Sisters 97154

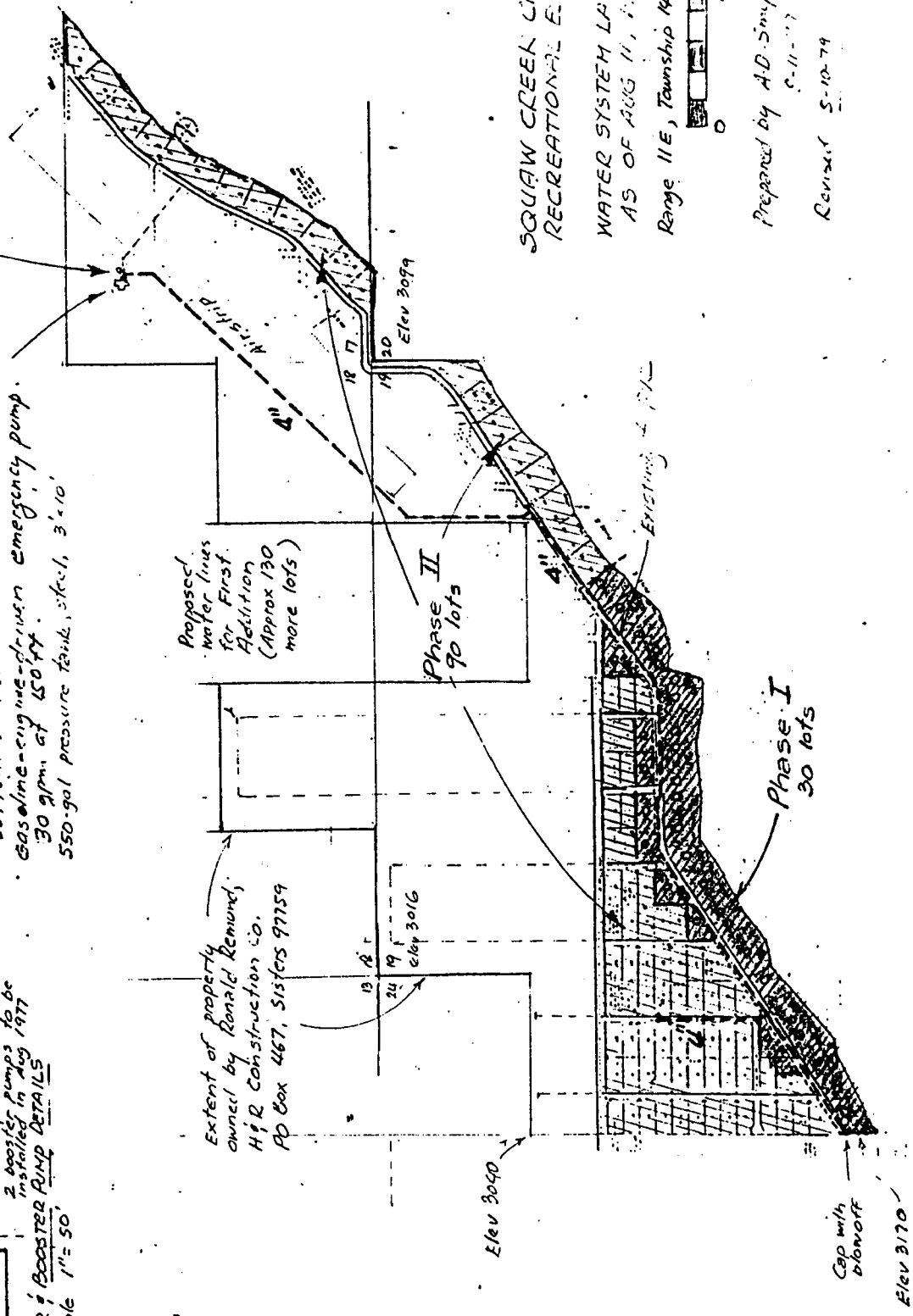

26 11 77

30 30