

Crooked River Ranch Water Co.
PO Box 1388
Crooked River Ranch, OR 97760

JEFF
488

13S/12E/24 bbc
13S/12E/24 bbc

Application G-12579
Permit G-11376

480 V

Well #2
Community Supply

GRR WELL LOG Jefferson County

Total Depth = 429 ft.
Completed Depth = 429 ft.
Date Drilled ?

WELL NO. 2
NOT TO SCALE

AUTO
TRANSFORM
START

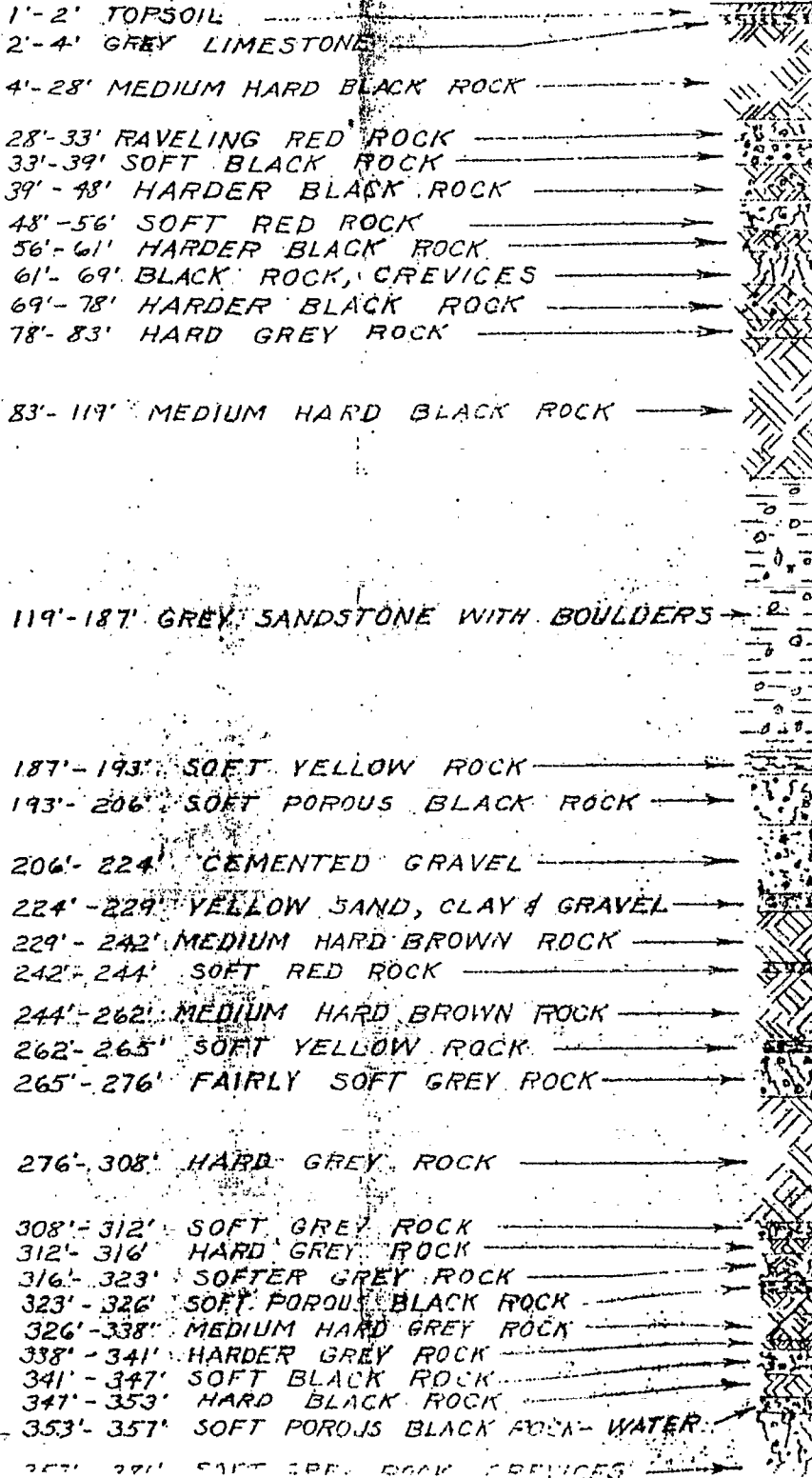

S
N07

* Data from water right application file G-12579.
Well located by USGS in 1994 as part of Middle
Deschutes Groundwater study.
Karl L. Wozniak

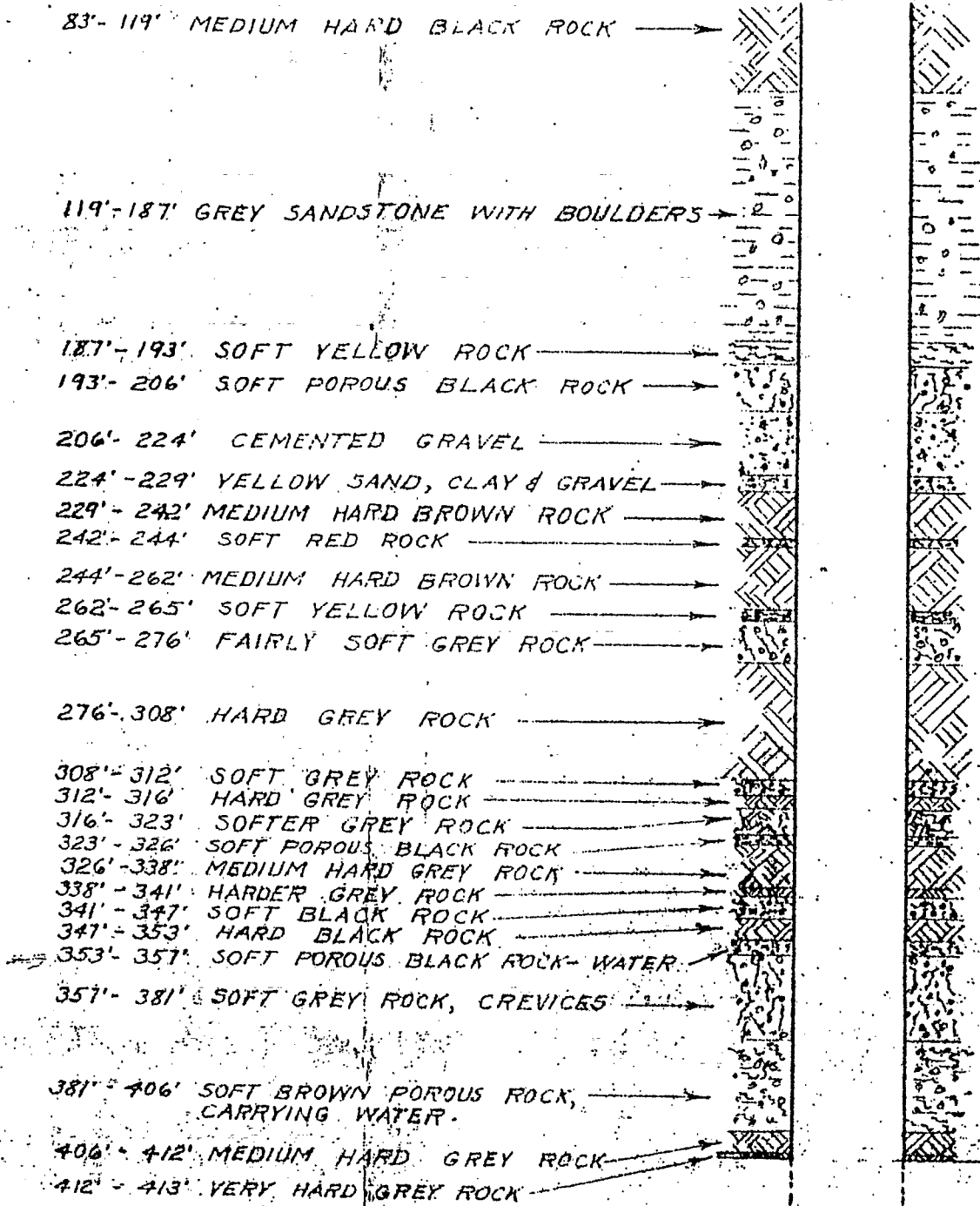

NOTES.

1. REMOVE EXISTING 2" CONCRETE SLAB. INSTALL 6" CONCRETE SLAB WIT WIRE MESH REINFORCING.
2. EXTEND 16" Ø CASING 18" TO 21" TO PROVIDE 24" FROM TOP OF CASING FINISHED FLOOR SLAB, FULL DEPTH WELD.
3. INSTALL 2" Ø WELL VENT WITH SCREENED RETURN BEND. WELD 2" Ø PIPE TO PLACEMENT OF NEW CONCRETE SUPPORT. (22)
4. INSTALL AIR LINE TO 320 FT. LEVEL. MOUNT DEPTH GAGE (READING IN FT. CF.
5. DRILL EXISTING CONG. SUPPORT & SET 8- 3/4" x 12" STL. DOWELS WITH EPOXY.
6. INSTALL 3" STL. RETURN LINE FROM PRESSURE RELIEF VALVE TO 13

Application No. 6-12579

Permit No.
SANITARY SURVEY REPORT
OREGON HEALTH DIVISION
DRINKING WATER PROGRAM
COMMUNITY WATER SYSTEMS

SUPPLY NAME: CROOKED RIVER RANCH
ID NUMBER : 4100862
COUNTY : JEFFERSON
SURVEYED BY: JOHN STRAUGHAN
DATE : 1/24/90

RECEIVED
JUN 18 1991
WATER RESOURCES DEPT.
SALEM, OREGON

Sheets Attached:

- | | |
|--|--|
| <input type="checkbox"/> Narrative Summary/Recommendations | <input type="checkbox"/> Storage/Distribution |
| <input type="checkbox"/> Inventory Master Data | <input type="checkbox"/> Booster Pumps/Production Data |
| <input type="checkbox"/> Water System Schematic | <input type="checkbox"/> Certification |
| <input type="checkbox"/> Location Map(s) | <input type="checkbox"/> Monitoring/Water Quality |

Additional Attachments:

WELL LOGS, CODE SHEETS

Narrative Summary:

Crooked River Ranch is a community system in Jefferson county bounded by the Deschutes River, the Crooked River and Deschutes county. The water system relies on an 800 gpm well for their source and the golf course well as an emergency source. There are two reservoirs which have a combined volume of 800,000 gallons. The water system was started as a development about 1973, Therefore system is relatively new and in good repair.

Requirements/Recommendations:

REQUIREMENTS:

1. Prepare a sampling plan for the water system.
2. Complete monitoring for radiological contaminates, sodium and corrosivity as per monitoring section.

RECOMMENDATIONS:

1. Seal holes in well pump bases.
2. Contact a professional engineer to prepare a master plan for the water system.

INVENTORY MASTER INFORMATION

SUPPLY NAME: CROOKED RIVER RANCH
ID NUMBER : 4100862

Date of Last Survey:	(MM/DD/YY)	7/30/86
System Type:		C
Ownership of System:	(1,2,3,4,5)	2
Population Served:	(Total Number)	1200
Number of Connections:	(Total Number)	600
Twelve-Month Period:		T
Year-Round Residents		Y
Primary Service Characteristic:	(R,T,S,O)	R
Secondary Service Characteristic:	(1,2,3,4,5,6,9)	4
Number of Sources:	(Total Number)	2
Counties Served (Refer to Codes):	(___/___/___)	16
Emergency Systems Available (Name & ID Number):		
PWS _____	(41_____)	-
PWS _____	(41_____)	-
PWS _____	(41_____)	-
Percent Ground:	(%)	100
Percent Surface:	(%)	-
Percent Purchased Ground:	(%)	-
Percent Purchased Surface:	(%)	-
Active:	(Y/N)	Y
Activate Date	(MM/DD/YY)	-
Deactivate Date	(MM/DD/YY)	-
Deactivate Reason:	(A,C,D,M,N,O,P,R,S,U,O)	-
Number of Tanks in Supply:	(Total Number)	2
Number of Gallons in Storage:	(Total Number)	800,000

Mailing Address	PO BOX 1388
City/State/Zip	CROOKED RIVER RANCH, OR 97760
Contact Name/Phone	KEN WOLF 923 1041
Comments	OPERATOR

Legal (Owner) Address	PO BOX 1388
City/State/Zip	CROOKED RIVER RANCH, OR 97760
Contact Name/Phone	DICK BROWNLEY
Comments	CHAIRMAN WATER ASSOCIATION

Supply Address	SAME
City/State/Zip	
Contact Name/Phone	
Comments	

SOURCE DATA (Sources for Individual Compliance Monitoring)

Source ID	Source Name	Type	Seller	Status	VOC	SOC	SWI
A	WELL #2	G	41	P	Y	-	N
B	WELL #3	G	41	E	Y	-	N
C			41				
D			41				

* (S)urface/(G)round/(P)urchased Surface/(W)urchased Ground
 ** (P)ermanent/(S)easonal/(E)mergency/(O)ther/(I)nterim
 *** Vulnerability to Contamination - (Y)es/(N)o
 VOCs/SOCs/Surface Water Influence

SOURCE OF SUPPLY - WELL

SUPPLY NAME: CROOKED RIVER RANCH
ID NUMBER : 4100862

Source ID/Detail ID - Well Detail Name

A	A	WELL #2
B	A	WELL #3

Well Data:

Source ID Letter:		A	B		
Detail ID Letter:		A	A		
Well/Spring/Stream:		W	W		
Source/Detail Status:	(P/S/E/O/I)	P	E		
Treatment Objective/Process:	()	A	A		
Treatment Objective/Process:	()	-	-		
Treatment Objective/Process:	()	-	-		
Treatment Objective/Process:	()	-	-		
Capacity:	(GPM)	3000	2500		
Latitude: Degrees	()	44	44		
Minutes	()	26	25		
Seconds	()	05	20		
Longitude: Degrees	()	123	123		
Minutes	()	14	14		
Seconds	()	48	10		
Location Map Included (USGS):	(Y/N)	Y	Y		
Well Log Attached:	(Y/N)	Y	N		
Depth of Well:	(FT.)	429	494		
Year of Installation:	(19)	-	49		
Casing Diameter:	(IN.)	16	16		
Grout Seal:	(Y/N)	Y	Y		
Gravel Pack:	(Y/N)	N	N		
Openings - Screens/Slots/Torch:	(S/L/T)	-	-		
Length of Open Interval:	(FT.)	28	35		
Depth to Top of Intake:	(FT.)	353	307		
Water Level Device:	(Y/N)	Y	Y		
Static Water Level:	(FT.)	280	286		
Pumping Water Level:	(FT.)	282	288		
Comments:					

Pump Data:

Pump Type:	(VT, SU, CE, SJ, DJ, OT)	VT	VT		
Pump Setting:	(FT.)	319	380		
Capacity:	(GPM)	800	475		
At TDH:	(FT.)	580	570		
Discharge Pressure:	(PSI)	105	80		
Horsepower:	(HP)	150	100		
Date Pump Pulled:	(19)	-	-		
Bearing Lubrication - (Oil/Water):	(O/W)	W	W		
Pump Base Sealed:	(Y/N)	Y	Y		
Comments:					

WATER SYSTEM OVERALL SCHEMATIC

SUPPLY NAME: CROOKED RIVER RANCH
ID NUMBER : 4100862

I F R S P
10 11 12

USA
B L M

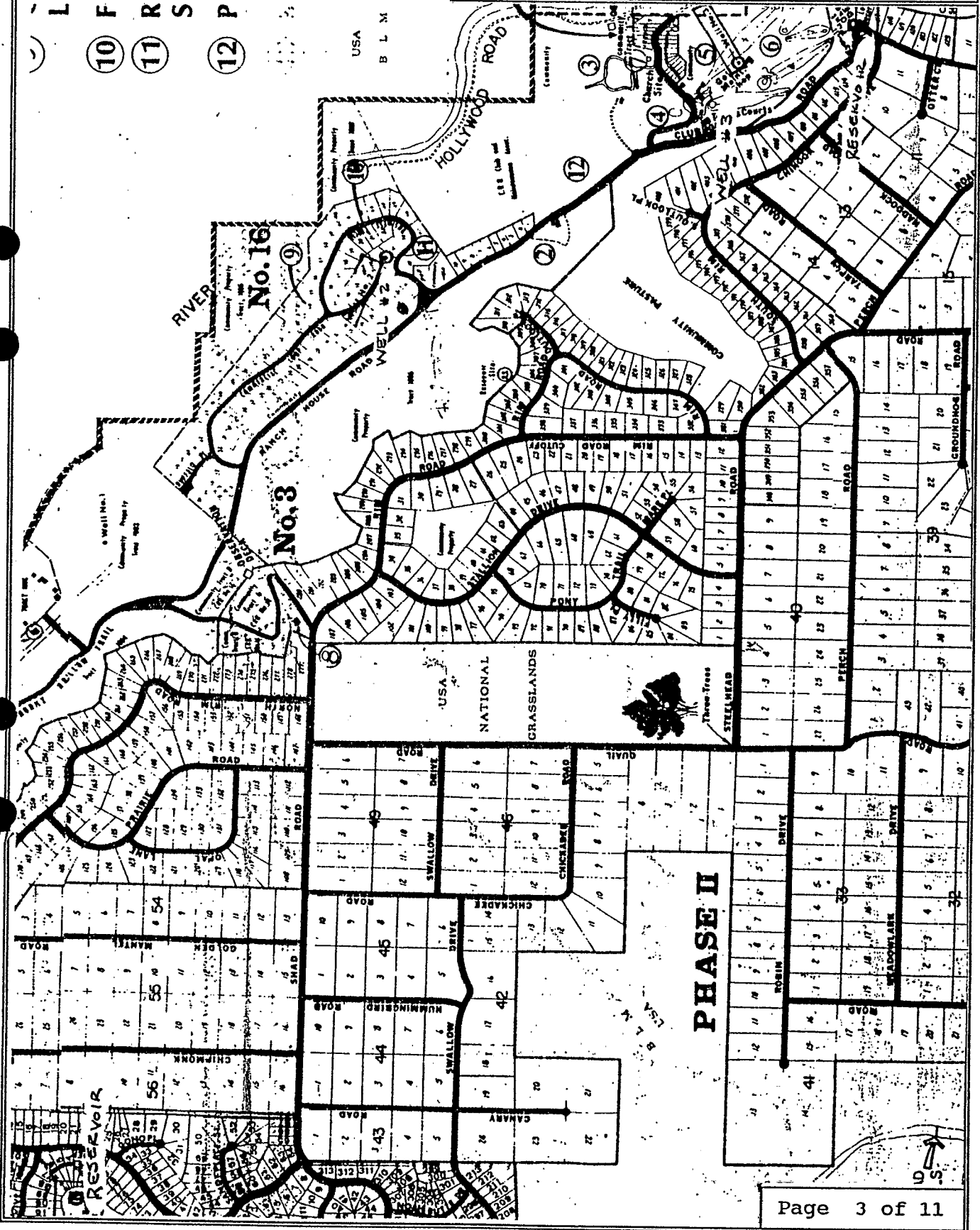

LOCATION MAP (USGS QUAD SHEET)

SUPPLY NAME: CROOKED RIVER RANCH
ID NUMBER : 4100862

Quadrangle Map

USGS Map Name - OPAL CITY, OREG
USGS Map Number - 44121-D2-TF-024

STEELHEAD FALLS, OREG
44121-D3-TF-024

