

STATE ENGINEER
Salem, Oregon

JOSE
19445

Well Record

GR- 1114

STATE WELL NO. 86/5W-6L(1)
COUNTY Josephine
APPLICATION NO. GR- 994

OWNER: Florence Rossow MAILING ADDRESS: 2300 Highland Ave.

LOCATION OF WELL: Owner's No. CITY AND STATE: Grants Pass, Oregon

NE 1/4 SW 1/4 Sec. 6 T. 36 S. R. 5 W., W.M.

Bearing and distance from section or subdivision
corner 133' S. & 433' E. from NW cor. of NE 1/4 SW 1/4
of Section 6.

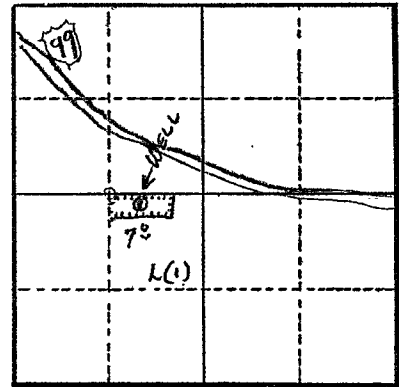

Altitude at well 1200 ft.

TYPE OF WELL: Drilled Date Constructed 1953

Depth drilled 92 ft. Depth cased 91 ft.

Section 6

CASING RECORD:

8 inch from 1 to 92 ft.

FINISH:

2 perforations per ft. (1/4" slot 2" to 3") from 10 to 91 ft.

AQUIFERS:

WATER LEVEL:

30 ft.

PUMPING EQUIPMENT: Type Dorward 2" jet H.P. 2

Capacity 49 G.P.M.

WELL TESTS:

Drawdown 1 ft. after 45 hours 45 G.P.M.

Drawdown 80 ft. after 75 hours 75 G.P.M.

USE OF WATER Irrigation Temp. 19 °F.

SOURCE OF INFORMATION G. R. Record

DRILLER or DIGGER

ADDITIONAL DATA:

Log Water Level Measurements Chemical Analysis Aquifer Test

REMARKS:

Log: Granite & loam 0 to 30 ft.
Granite 30 to 80 ft.
Gravel & granite (water) 80 to 90 ft.
Gravel (water) 90 to 92 ft.

Irrigation of 7 acres.