

STATE ENGINEER
Salem, Oregon

LANE
60144

Well Record

STATE WELL NO. 15/WL-19N(2)
COUNTY Lane
APPLICATION NO. GR-1192

GR- 1153

OWNER: Ross A. Wagner

MAILING ADDRESS: Rt. 3

LOCATION OF WELL: Owner's No. #1

CITY AND STATE: Junction City, Oregon

SW 1/4 SW 1/4 Sec. 19 T. 15 S., R. 4 W., W.M.

Bearing and distance from section or subdivision corner 1056' N. & 1290' E. from SW cor. Sec. 19.

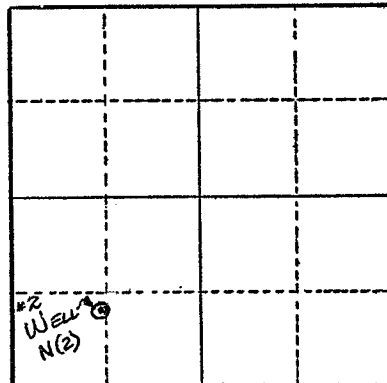

Section 19

Altitude at well 305 ft.

TYPE OF WELL: Driven Date Constructed 1950

Depth drilled 20 ft. Depth cased 20 ft.

CASING RECORD:

4 inch

FINISH:

Slotted perforations (3 x 3 in.) from 17 to 20 ft.

AQUIFERS:

WATER LEVEL:

10 ft.

PUMPING EQUIPMENT: Type F. M. 2 x 3 in. Cent. H.P. 13
Capacity 200 G.P.M.

WELL TESTS:

Drawdown 6 ft. after hours 250 G.P.M.
Drawdown ft. after hours G.P.M.

USE OF WATER Irrigation Temp. °F. , 19

SOURCE OF INFORMATION G. R. Record

DRILLER or DIGGER

ADDITIONAL DATA:

Log Water Level Measurements Chemical Analysis Aquifer Test

REMARKS:

Log: Gravel from surface to bottom.

Irrigation of 30.1 acres.