

STATE ENGINEER
Salem, Oregon

LANE
7958

Well Record

STATE WELL NO. 16/4W-14E(1)
COUNTY Lane
APPLICATION NO. GR-1237

GR- 1196

OWNER: Vincent Glover

MAILING

ADDRESS: 1550 Maple Dr.

LOCATION OF WELL: Owner's No. _____

CITY AND

STATE: Junction City, Oregon

SE 1/4 SW 1/4 Sec. 14 T. 16 S., R. 4 W., W.M.

Bearing and distance from section or subdivision

corner N73°25'E, 2440' from SW cor. Sec. 14.

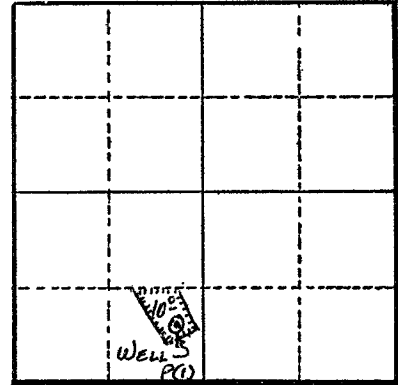

Section 14

Altitude at well 345 ft.

TYPE OF WELL: Driven Date Constructed 1944

Depth drilled 20 ft. Depth cased 20 ft.

CASING RECORD:

2 - 3in. pipes driven 6 ft. apart.

FINISH:

12 - 1/4 in. slots from 17 to 20 ft.

AQUIFERS:

WATER LEVEL:

8 ft.

PUMPING EQUIPMENT: Type F. M. 2 in. Cent. H.P. 40

Capacity 200 G.P.M.

WELL TESTS:

Drawdown _____ ft. after _____ hours _____ G.P.M.

Drawdown _____ ft. after _____ hours _____ G.P.M.

USE OF WATER Irrigation Temp. _____ °F., 19_____

SOURCE OF INFORMATION G. R. Record

DRILLER or DIGGER _____

ADDITIONAL DATA:

Log _____ Water Level Measurements _____ Chemical Analysis _____ Aquifer Test _____

REMARKS:

Log: Sandy loam 0 to 10 ft.
Sand & gravel 10 to 20 ft.

Irrigation of 10 acres.