

2

RECEIVED

145/1w/15db

STATE OF OREGON
MONITORING WELL REPORT
(as required by ORS 537.765 & OAR 690-240-095)

LINN
2112

JAN 25 1994

Start Card # 62024

(1) OWNER/PROJECT: WELL NO. W.R.P. #1 SALEM, OREGON
Name Linda Dodge
Address 40190 Hwy 228
City Sweethome State OR Zip 97386

(6) LOCATION OF WELL By legal description
Well Location: County Linn
Township 14 (N or S) Range 1 (E or W) Section 15
1. NW 1/4 of SE 1/4 of above section.
2. Street address of well location 40190 Hwy 228
Sweethome, OR
3. Tax lot number of well location None
4. ATTACH MAP WITH LOCATION IDENTIFIED.

(2) TYPE OF WORK:
 New construction Repair Recondition
 Conversion Deepening Abandonment

(3) DRILLING METHOD
 Rotary Air Rotary Mud Cable
 Hollow Stem Auger Other

(7) STATIC WATER LEVEL:
8' Ft. below land surface. Date 12-23-93
Artesian Pressure lb/sq. in. Date

(4) BORE HOLE CONSTRUCTION
Special Standards Yes No Depth of completed well 15.5' ft.

(8) WATER BEARING ZONES:
Depth at which water was first found 8'

From	To	Est. Flow Rate	SWL
8'	155'	7	8'

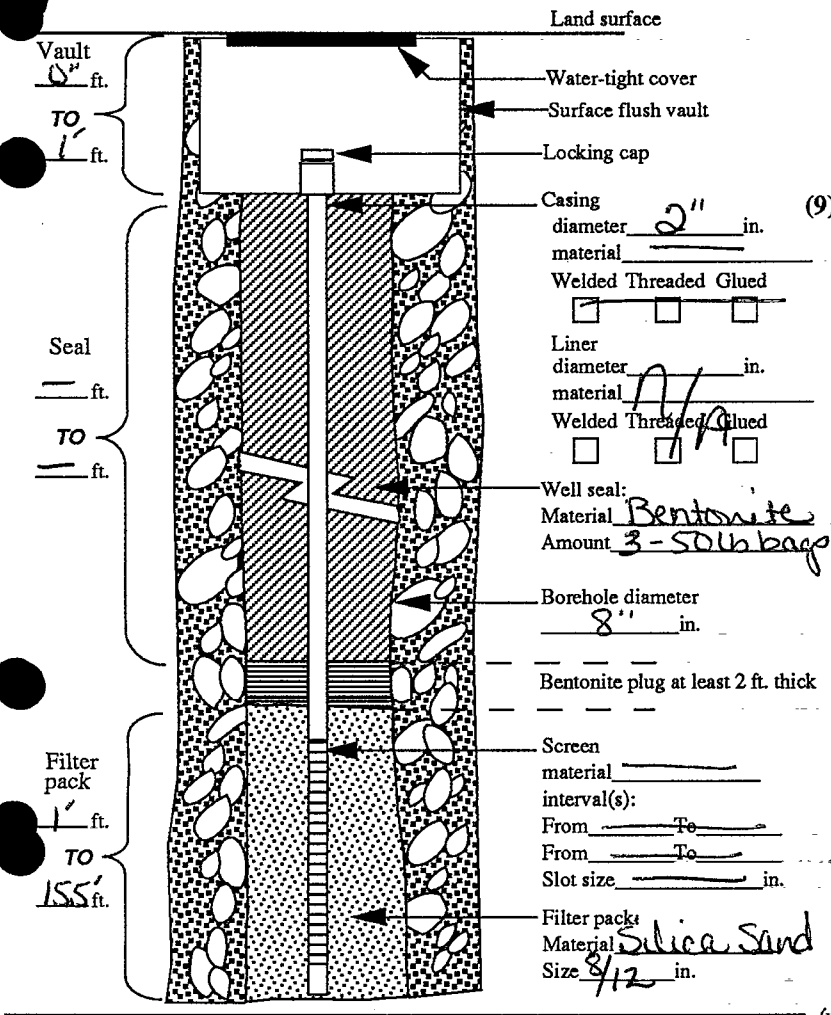

(9) WELL LOG: Ground elevation

Material	From	To	SWL
Backfill gravel to 3lbs.	0'	5'	
Light gray clay w/ dense, slight hydrocarbon odor.	5'	10'	8'
Light gray clay at 10' grading to very poorly sorted 1/2" gravel mixed with some sand. Slight green on split spoon	10'	15'	
Very hard light gray to greenish bedrock.	15'	155'	

Date started 12-23-94 Completed 12-23-94

(5) WELL TEST:
 Pump Bailer Air Flowing Artesian
Permeability Yield GPM
Conductivity PH
Temperature of water 14°C °F/C Depth artesian flow found ft.
Was water analysis done? Yes No
By whom? C.P.E.
Depth of strata to be analyzed. From 8' ft. to 15.5' ft.
Remarks:

(unbonded) Monitor Well Constructor Certification:
I certify that the work I performed on the construction, alteration, or abandonment of this well is in compliance with Oregon well construction standards. Materials used and information reported above are true to the best knowledge and belief.
Signed MWC Number
Date

(bonded) Monitor Well Constructor Certification:
I accept responsibility for the construction, alteration, or abandonment work performed on this well during the construction dates reported above. All work performed during this time is in compliance with Oregon well construction standards. This report is true to the best of my knowledge and belief.
Signed Randy J. Cisman MWC Number 10013
Date 1-14-94

Name of supervising Geologist/Engineer Pete Zeager

RECEIVED

JAN 25 1994

WATER RESOURCES DEPT.
SALEM, OREGON Hwy 212/228
Center Line

Twp. #1 62023
Twp. #2 62024

Legend

- ⊕ Proposed boring
- Proposed soil sample

Road Shoulder

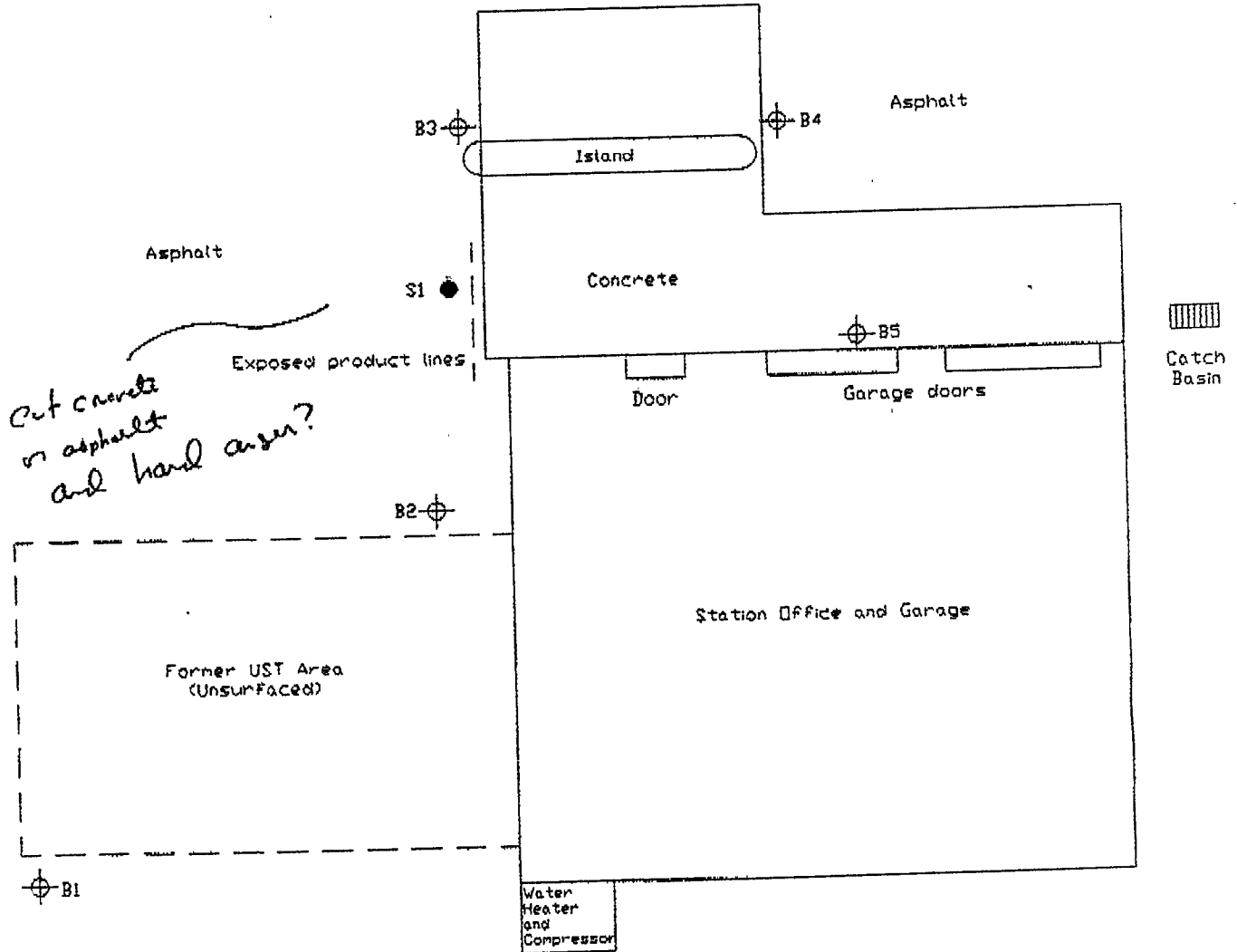

*cut concrete
in asphalt
and hard core?*

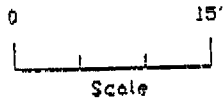

Figure 2 Site Plan		
40190 Highway 228		
Scale: 1" = 15'	Date: 12/7/93	Revised:
Design:	Cascade Pacific Engineering, Inc. 1925 Bailey Hill Road, Suite A Eugene, Oregon 97405 Phone (503) 687-0965	Job: 000280193
Drawn:		Sheet
Checked:		

