

LINN
4814

Well Record

GR- 1486

STATE WELL NO. 10/3W-16N
COUNTY Linn
APPLICATION NO. GR- 1543

OWNER: Wilbur Turnidge

MAILING ADDRESS: Rt. Box 288C

LOCATION OF WELL: Owner's No.

CITY AND STATE: Albany, Oregon

SW 1/4 SW 1/4 Sec. 16 T. 10 S. R. 3 W., W.M.

Bearing and distance from section or subdivision
corner 1915' W. & 462' S. from NE cor. DLC # 59

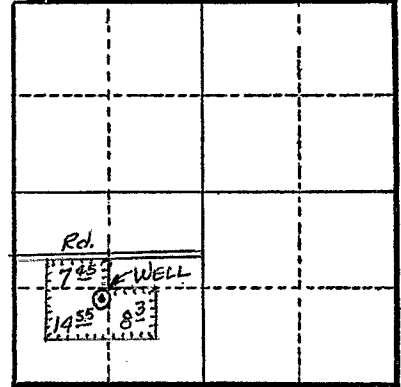

Section 16

Altitude at well

TYPE OF WELL: Drilled Date Constructed 1950

Depth drilled 30' Depth cased 30'

CASING RECORD:

~~XX~~

10"

FINISH:

Slot perforated from 22' to 30'

AQUIFERS:

WATER LEVEL:

8'

PUMPING EQUIPMENT: Type Goulds Cent. H.P. 5

Capacity 85 G.P.M.

WELL TESTS:

Drawdown ft. after hours G.P.M.

Drawdown ft. after hours G.P.M.

USE OF WATER Irrigation Temp. °F., 19

SOURCE OF INFORMATION GR Record

DRILLER or DIGGER Bill Hamilton

ADDITIONAL DATA:

Log N.A. Water Level Measurements Chemical Analysis Aquifer Test

REMARKS:

Irrigation of 30 acres.