

STATE ENGINEER
Salem, Oregon

MARI. 2027

Well Record

STATE WELL NO. 5/1W-27C
COUNTY Marion
APPLICATION NO. G-1926

OWNER: Roy Dempsey

MAILING ADDRESS: Rt. 2, Box 53

LOCATION OF WELL: Owner's No.

CITY AND STATE: Woodburn, Oregon

NE 1/4 NW 1/4 Sec. 27 T. 5 S., R. 1 W., W.M.

Bearing and distance from section or subdivision
corner 373' W. & 2114.28' N. from Center Sec. 27

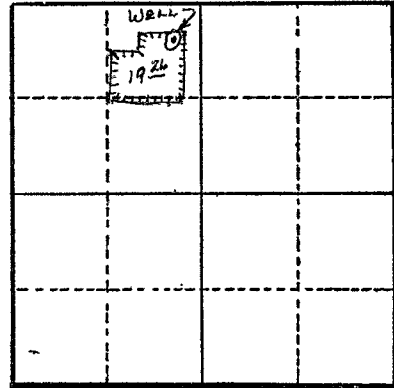

Section 27

Altitude at well

TYPE OF WELL: Drilled Date Constructed 1959?

Depth drilled 85' Depth cased 85'

CASING RECORD:

6"

FINISH:

?

AQUIFERS:

WATER LEVEL:

?

PUMPING EQUIPMENT: Type _____ H.P.
Capacity _____ G.P.M.

WELL TESTS:

Drawdown _____ ft. after _____ hours _____ G.P.M.
Drawdown _____ ft. after _____ hours _____ G.P.M.

USE OF WATER Irrigation Temp. _____ °F., 19

SOURCE OF INFORMATION Application #G-1926

DRILLER or DIGGER

ADDITIONAL DATA:

Log N.A. Water Level Measurements _____ Chemical Analysis _____ Aquifer Test _____

REMARKS:

Irrigation of 19.51 acres