

STATE ENGINEER
Salem, Oregon

MAR 27 1960

Well Record

GR- 1240

STATE WELL NO. 5/2W-32J
COUNTY Marion
APPLICATION NO. GR- 1283

OWNER: William H. Trindle

MAILING
ADDRESS:

LOCATION OF WELL: Owner's No.

CITY AND
STATE: Gervais, Oregon

NE 1/4 SE 1/4 Sec. 32 T. 5 S., R. 2 W., W.M.

Bearing and distance from section or subdivision

corner 2750' S. & 700' W. from NE cor. Sec. 32.

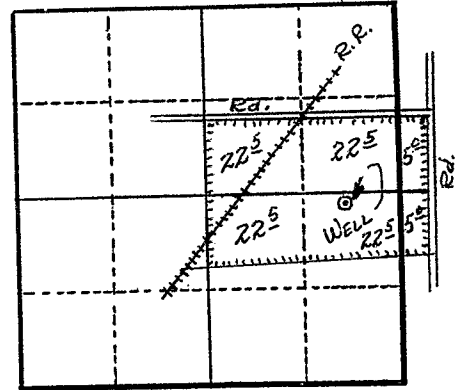

Section 32

Altitude at well 150 ft.

TYPE OF WELL: Drilled Date Constructed 1954

Depth drilled 191 ft. Depth cased 180 ft.

CASING RECORD:

12 inch

FINISH:

Perforated: 2 x 1/4 in. - 14 per ft. from 118 to 180 ft.

AQUIFERS:

WATER LEVEL:

10 ft.

PUMPING EQUIPMENT: Type F. M. turbine

H.P. 35

Capacity 1100 G.P.M.

WELL TESTS:

Drawdown 49 ft. after 1000 hours G.P.M.

Drawdown ft. after hours G.P.M.

USE OF WATER Irrigation Temp. °F. 19.

SOURCE OF INFORMATION G. R. Record

DRILLER or DIGGER Irving Sears

ADDITIONAL DATA:

Log Water Level Measurements Chemical Analysis Aquifer Test

REMARKS:

Log: Dirt 0 to 8 ft.
Hardpan 8 to 14 ft.
Clay (water 60') 14 to 115 ft.
Cement gravel (water) 115 to 140 ft.
Sand & clay 140 to 180 ft.
Gravel & clay (water) 180 to 182 ft.
Shale 182 to 191 ft.

Irrigation of 100 acres.